

Washington County, Oregon **2011-018326**  
03/03/2011 03:38:11 PM  
D-E Cnt=1 Stn=29 RECORDS1  
\$20.00 \$5.00 \$11.00 \$15.00 - Total = \$51.00



01678619201100183280040044

I, Richard Hobernicht, Director of Assessment and Taxation and Ex-Officio County Clerk for Washington County, Oregon, do hereby certify that the within instrument of writing was received and recorded in the book of records of said county.



*Richard Hobernicht*  
Richard Hobernicht, Director of Assessment and Taxation, Ex-Officio County Clerk

*please send tax statements to:*  
**After recording, please return to:**  
City of Sherwood  
Engineering Department  
22560 SW Pine Street  
Sherwood, OR 97140

### DEDICATION DEED

ST. FRANCIS CATHOLIC CHURCH, SHERWOOD, OREGON, an Oregon non-profit corporation, (hereinafter GRANTOR), does on behalf of itself, its heirs, successors and assigns hereby grant, convey and dedicate to the CITY OF SHERWOOD, an Oregon municipal corporation (hereinafter GRANTEE), a perpetual right-of-way dedication across, on and below certain real property situated in the City of Sherwood as described in Exhibit "A" (Legal Description) and Exhibit "B" (Location Map), attached hereto and by this reference incorporated herein.

The true consideration for this conveyance is \$ 32670.00.

GRANTOR hereby covenants to and with GRANTEE that it is the owner of said property, which is free to the best of GRANTOR'S knowledge from all encumbrances (except for easements, conditions and restrictions of record).

GRANTEE (and other public or private entities or persons GRANTEE deems in its reasonable discretion as appropriate) shall have the perpetual right to construct, improve, operate and maintain a public right-of-way (and such other uses deemed by the GRANTEE to not be incompatible therewith) across and on and below the property described on Exhibit "A" and shown on Exhibit "B".

// //

// //

// //

IN WITNESS WHEREOF, the above named Grantor has caused this instrument to be signed.

DATED this \_\_\_ day of February, 2011.

Thomas McCarthy, SJ  
Rev. Thomas McCarthy, SJ, Pastor

STATE OF OREGON            )  
  ) ss.  
County of Washington    )

This instrument was acknowledged before me this 18<sup>th</sup> day of February, 2011, by Rev. Thomas McCarthy, SJ who, being sworn, stated that he is the pastor of The ST. FRANCIS CATHOLIC CHURCH, SHERWOOD, OREGON, an Oregon domestic non-profit corporation, and this instrument was voluntarily signed on behalf of the corporation by authority of its Board of Directors. Before Me:

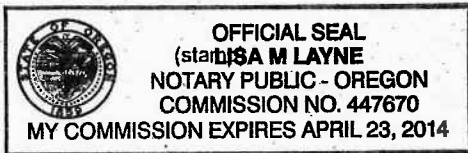

Lisa M. Layne  
Notary Public (Signature)

Accepted on behalf of the City of Sherwood, Oregon,

By: [Signature]

Title: City Manager

Dated this 18 day of Feb., 2011



**Exhibit "A"**

SW Adams Avenue/SW Oregon Street  
Right-of-way Acquisition Parcel - St. Francis Catholic Church

Right-of-way Acquisition Parcel

Being a strip of land located in the Northwest One-Quarter of Section 32, Township 2 South, Range 1 West, Willamette Meridian, City of Sherwood, Washington County, Oregon and being a portion of that property conveyed to St. Francis Catholic Church, by Deed Document Number 2008-051869 in the Washington County Deed Records, said parcel being more particularly described as follows:

Commencing at a Brass Cap marking the North One-Quarter Corner of Section 32, Township 2 South, Range 1 West, Willamette Meridian;

Thence along the Center line of said section, South  $00^{\circ}35'26''$  East, 457.99 feet to an angle point;

Thence leaving said Center line South  $89^{\circ}24'34''$  West, 43.00 feet, when measured at right angle to said centerline, to the Westerly Right-of-Way line of S.W. Adams Avenue as described in Deed Document Number 2003-182230, recorded in the Washington County Deed Records, and the True Point of Beginning;

Thence leaving said Westerly Right-of-Way line, South  $10^{\circ}46'58''$  West, 108.12 feet to an angle point;

Thence South  $47^{\circ}13'52''$  West, 224.30 feet to the Northeasterly line of that tract described in Deed Document Number 2006-037140, recorded in the Washington County Deed Records;

Thence along said Northeasterly line, South  $44^{\circ}55'03''$  East, 5.00 feet to the Northwestern Right-of-Way line of SW Oregon St. as described in said Deed Document Number 2003-182230;

Thence along said Northwestern Right-of-Way line, North  $47^{\circ}13'52''$  East, 248.35 feet to the Westerly Right-of-Way line of said S.W. Adams Avenue;

Thence along said Westerly Right-of-Way line, North  $00^{\circ}35'26''$  West, 93.42 feet to the True Point of Beginning Containing 2,178 square feet more or less.

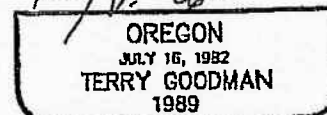
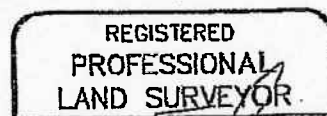

RENEWAL DATE: 7-01-11

# EXHIBIT "B"

LOCATED IN THE NW 1/4 OF SECTION 32,  
TOWNSHIP 2 SOUTH, RANGE 1 WEST,  
WILLAMETTE MERIDIAN, WASHINGTON  
COUNTY, OR

ST. FRANCIS CATHOLIC CHURCH  
DEED #2008-051869

LINE TABLE		
LINE	LENGTH	BEARING
L1	457.99'	S00°35'26"E
L2	43.00'	S89°24'34"W
L3	108.12'	S10°46'58"W
L4	224.30'	S47°13'52"W
L5	5.00'	S44°55'03"E
L6	248.35'	N47°13'52"E
L7	93.42'	N00°35'26"W

FEE ACQUIRED  
ROW AREA



= 2,178 SQ. FT.

REGISTERED  
PROFESSIONAL  
LAND SURVEYOR

OREGON  
JULY 16, 1982  
TERRY GOODMAN  
1989

RENEWAL DATE: 7-01-11



**HDI** PLLC  
**DESIGN GROUP**  
engineers landscape architects planners surveyors

300 W 15th Street  
Vancouver, WA 98660-2927  
360/695-3488  
503/924-4005  
360/695-8767 fax

DRAWN BY: MCW	SCALE: 1"=100'	DATE: 08/02/2010
CHECKED BY: TLG	JOB NO.: 2336-00	SHEET 1 OF 1

29  
32

SW ADAMS AVENUE

43' 27'

DEED #2006-037140

SW OREGON STREET

PACIFIC RAILROAD

L1

L2

L3

L4

L6

L5

L7