

Please send tax statements to:
After recording, please return to:

25 City of Sherwood
31 Engineering Department
22560 SW Pine Street
Sherwood, OR 97140

Washington County, Oregon **2010-101820**
12/17/2010 08:42:42 AM
D-DD Cnt=1 Stn=7 K GRUNEWALD
\$25.00 \$5.00 \$11.00 \$15.00 - Total = \$56.00



01553934201001018200050052
I, Richard Hobernicht, Director of Assessment and Taxation and Ex-Officio County Clerk for Washington County, Oregon, do hereby certify that the within instrument of writing was received and recorded in the book of records of said county.

Richard Hobernicht
Richard Hobernicht, Director of Assessment and Taxation, Ex-Officio County Clerk



DEDICATION DEED

Steven D. Gregg, Thomas M. Gregg and Washington Trust Bank, as Co-Trustees of the Trust No. CT 2-14-77, also referred to as the trust agreement dated February 14, 1977, GRANTOR, do dedicate to the CITY OF SHERWOOD, a political subdivision of the State of Oregon, GRANTEE, a perpetual right-of-way easement across, on and below certain real property situated in the City of Sherwood as described in Exhibit "A" (Legal Description) and Exhibit "B" (Location Map), attached hereto and by this reference incorporated herein.

The true consideration for this conveyance is \$3,250.00.

GRANTOR hereby covenants to and with GRANTEE that they are the owner of said property, which is free from all encumbrances, except for easements, conditions and restrictions of record, and will warrant and defend the easement rights herein granted from all lawful claims whatsoever, except as stated herein.

GRANTEE (and other public or private entities or persons GRANTEE deems in its sole discretion as appropriate) shall have the perpetual right to construct, improve, operate and maintain a public right-of-way (and such other uses deemed by the GRANTEE to not be incompatible therewith) across and on and below the property as described on Exhibits "A" and "B" provided it is used for vehicular (be they motorized or otherwise), pedestrian, bicycle or other public road, street, highway and/or similar or complementary public purposes.

// //

// //

// //

IN WITNESS WHEREOF, the above named Grantors, have caused this instrument to be signed.

DATED this 18th day of November, 2010.

Washington Trust Bank as nominee on behalf
of Steven D. Gregg, Co-Trustee
By M. Castano (Maria VP, STO)
Steven D. Gregg, Trustee

STATE OF OREGON)
County of Multnomah) ss

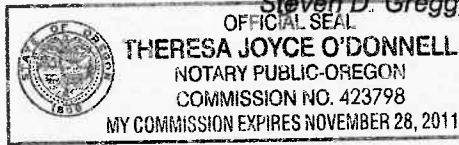

This instrument was acknowledged before me this 18th day of November, 2010, by
Steven D. Gregg as co-Trustee of Trust No. CT 2-14-77, also referred to as the trust agreement dated February 14, 1977

Theresa Joyce O'Donnell
Notary Public (Signature)

STATE OF OREGON)
County of Multnomah) ss

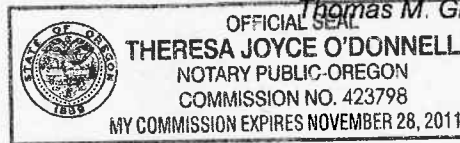

Thomas M. Gregg
Thomas M. Gregg, Trustee

This instrument was acknowledged before me this 18th day of November, 2010 by
Thomas M. Gregg as Co-Trustee of Trust No. CT 2-14-77, also referred to as the trust agreement dated February 14, 1977.

Theresa Joyce O'Donnell
Notary Public (Signature)

Washington Trust Bank

by M. Castano Garcia VP, STU

STATE OF OREGON)
County of Multnomah) ss.

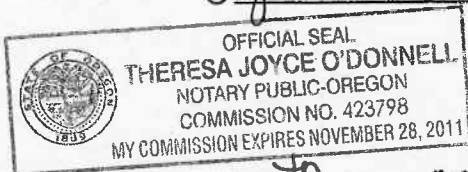

This instrument was acknowledged before me this 18th day of November, 2010, by Michelle Castano Garcia on behalf of Washington Trust Bank as Co-Trustee of Trust No CT 2-14-77, also referred to as the trust agreement dated February 14, 1977

Theresa O'Donnell
Notary Public (Signature)

Accepted on behalf of the City of Sherwood, Oregon,

Approved As To Form:
Per email sent by City legal
counsel on 10/6/10 (0955hrs)

By: [Signature]
Title: City Manager

Dated this 9 day of Dec., 2010

James A. Patterson
City Manager
Sherwood, Oregon 97140



Exhibit "A"
SW Oregon Street
Right-of-way Acquisition Parcel – Glenn H. Gregg Trustee

Right-of-way Acquisition Parcel

Being a strip of land located in the Northwest One-Quarter of Section 32, Township 2 South, Range 1 West, Willamette Meridian, City of Sherwood, Washington County, Oregon and being a portion of that property conveyed to "Glenn H. Gregg Trustee", by Deed Document Number 2001-095212 in the Washington County Deed Records, said parcel being more particularly described as follows:

Beginning at the Southeast Corner of Tract 2, as shown on "Smock Addition to Sherwood", recorded in Washington County Plat Records, and the Westerly line of that Right-of-Way Dedication described in Deed Document Number 2003-182230;

Thence along said Westerly Right-of-Way Dedication line, North $00^{\circ}05'38''$ West, 10.42 feet to an angle point;

Thence leaving said Westerly Right-of-Way Dedication line, South $48^{\circ}11'13''$ West, 8.07 feet to an angle point;

Thence South $66^{\circ}58'44''$ West, 10.83 feet to the Westerly line of said parcel described in Deed Document Number 2001-095212;

Thence along said Westerly line, South $00^{\circ}05'38''$ East, 7.60 feet to the Northwesterly Right-of-Way line of SW Oregon St.;

Thence along the Northwesterly Right-of-Way line, North $66^{\circ}58'44''$ East, 17.37 feet to the True Point of Beginning.

Containing 130 square feet more or less

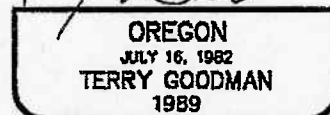
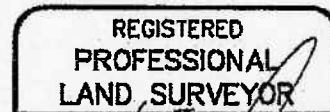

RENEWAL DATE: 7-01-11

EXHIBIT "B"

LOCATED IN THE NW 1/4 OF SECTION 32,
TOWNSHIP 2 SOUTH, RANGE 1 WEST,
WILLAMETTE MERIDIAN, WASHINGTON
COUNTY, OR

GLENN H. GREGG TRUSTEE
DEED NO. 2001-095212

LINE TABLE		
LINE	LENGTH	BEARING
L1	10.42	N00°05'38"W
L2	8.07	S48°11'13"W
L3	10.83	S86°58'44"W
L4	7.60	S00°05'38"E
L5	17.37	N66°58'44"E

P.O.B.
SE COR.
TRACT 2
SMOCK ADD.
TO SHERWOOD

SW OREGON STREET

FEE ACQUIRED
ROW AREA

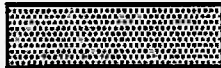

= 130 SQ. FT.±

REGISTERED
PROFESSIONAL
LAND SURVEYOR

OREGON
JULY 16, 1982
TERRY GOODMAN
1989

RENEWAL DATE: 7-01-11



HDJ
DESIGN GROUP

engineers landscape architects planners surveyors

300 W 15th Street
Vancouver, WA 98660-2927
360/695-3488
503/924-4005
360/695-8767 fax

DRAWN BY: MCW

SCALE: 1"=20'

DATE: 08/05/2010

CHECKED BY: TLG

JOB NO.: 2336-00

SHEET 1 OF 1