

CITY OF SHERWOOD, OREGON

ORDINANCE NO. 624

AN ORDINANCE RATIFYING, CONFIRMING AND RECORDING CHANGE IN THE BOUNDARIES OF THE CITY OF SHERWOOD BY THE BOUNDARY COMMISSION INVOLVING LANDS OF RICHARD OWINGS, ET UX, IN SECTION 32, TOWNSHIP 2 SOUTH, RANGE 1 WEST OF THE WILLAMETTE MERIDIAN, WASHINGTON COUNTY, OREGON, RECORDING EFFECTIVE DATE, AND DECLARING AN EMERGENCY.

WHEREAS, the Boundary Commission established pursuant to Chapter 494, Oregon Laws of 1969 for the Portland Metropolitan Area, by its final order dated February 9, 1972, approved the hereinafter described change in the boundaries of the City of Sherwood, and a copy of said final order has been filed with the City Recorder,

NOW, THEREFORE, THE CITY OF SHERWOOD DOES ORDAIN AS FOLLOWS:

Section 1: That the final order of the Boundary Commission adopted on the 9th day of February, 1972, as filed with the City Recorder on the 9th day of February, 1972, a copy whereof is hereto attached and by this reference made a part hereof, be, and the same is hereby ratified, confirmed and adopted by reference to the same legal force and effect as if set forth herein in full.

Section 2: That the boundaries of the City of Sherwood be, and they are hereby, changed to include the lands as described in the within order of the Boundary Commission, and the corporate limits of the City of Sherwood are hereby changed in conformity therewith.

Section 3: That the Recorder of the City of Sherwood be, and she is hereby, directed to forthwith file a copy of this ordinance, including a copy of said Order, in the following offices:

- (a) Secretary of State
- (b) Department of Revenue & Taxation, Washington County
- (c) Department of Records & Elections, Washington County
- (d) Department of Public Works, Att: Surveyor, Washington County.

Section 4: That the City Planning Commission be, and it is hereby, authorized and directed to conduct such proceedings as may be necessary to conform the authorized zoning and land use of the described premises to the requirements of the City's Zoning Map and Code.

Section 5: Inasmuch as it is necessary for the peace, health and safety of the people of the City of Sherwood that the foregoing change in the boundaries of the City become a permanent part of the City's records, an emergency is hereby declared to exist, and this ordinance shall be effective upon its passage by the Council, and approval by the Mayor.

PASSED: by the Council by Unanimous vote of all Council Members present, after being read by caption three times and in body once, this 12th day of April, 1972.

Marjorie Stewart
Recorder - City of Sherwood

APPROVED: By the Mayor, this 12th day of April, 1972.

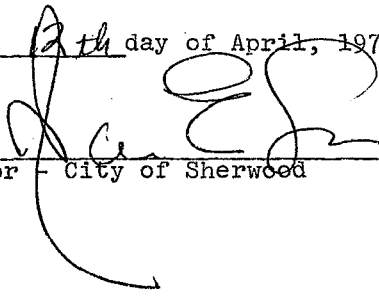

Mayor - City of Sherwood

FINAL ORDER

RE: BOUNDARY CHANGE PROPOSAL NO. 387 - Annexation of the following territory to the City of Sherwood

Legal Description

Beginning at the Northeast corner of the tract of land deeded to Kenneth Allen Swenson and Rose M. Swenson by deed recorded in Deed Book 184, page 529; being the northeast corner of Lot 7, Block 5, Sherwood Acres, thence East to re-entrant corner of the West line of Lot 1, Block 4, SHERWOOD ACRES; thence North 10 feet; thence East 100 feet; thence South 110 feet; thence West to the East line of Lot 7, Block 5, SHERWOOD ACRES; thence North 100 feet to the point of beginning, being a part of Lot 1, Block 4, SHERWOOD ACRES, and a part of tract adjoining same in Section 32, Township 2 South, Range 1 West of the Willamette Meridian, Washington County, Oregon, Parcel 2;

Beginning at the Southwest corner of the Teal tract as described in Deed Book 373, page 178; running thence East along the South line of said Teal tract 110 feet to the Southeast corner thereof; thence South 10 feet to the Northeast corner of that tract conveyed to V.C. Cochran, et ux, by deed book 376, page 456, thence West along the North line of said Cochran tract 110 feet to the Northwest corner thereof; thence North 10 feet to the place of beginning.

A part of Section 32, Township 2 South, Range 1 West of the Willamette Meridian, Washington County, Oregon.

Proceedings on Proposal No. 387 commenced upon receipt by the Boundary Commission of a resolution from the City Council on December 17, 1971 requesting that the property described above be annexed to the City. The petition meets the requirements for initiating a proposal set forth in ORS 222.750 and paragraph (a) Section (3) of ORS 199.490.

Upon receipt of the petition the Boundary Commission published and posted notice of the public hearing in accordance with ORS 199.520 and conducted a public hearing on the proposal on February 9, 1972. The Commission also caused a study to be made on this proposal which considered economic, demographic and sociological trends and projections and physical development of the land.

On the basis of the public hearing and the study, the Boundary Commission made a number of findings:

- a) the territory to be annexed is an unincorporated "island" area completely surrounded by the City's boundary;
- b) the territory contains .31 acres, one single family dwelling and an estimated population of 3 persons;
- c) the City initiated the boundary change since the property is receiving all City services, including water, sewer and police protection; and
- d) the boundary change will eliminate a confusing jurisdictional situation between the City and Washington County.

On the basis of the findings listed above, the Boundary Commission approved BOUNDARY CHANGE PROPOSAL NO. 387 on February 9, 1972.

NOW THEREFORE IT IS ORDERED THAT the territory described above be annexed to the City of Sherwood as of this date.

PORTLAND METROPOLITAN AREA LOCAL GOVERNMENT
BOUNDARY COMMISSION

DATE: February 9, 1972

By: Ronald C. Cease
Ronald C. Cease
Chairman

Attest: Donald E. Carlson

<p>Certified to be a true and exact copy of the original</p> <p><u>Feb 9, 1972</u></p> <p>Portland Metropolitan Area Local Government</p> <p><u>W. L. Loeber</u> Secretary of Commission</p>

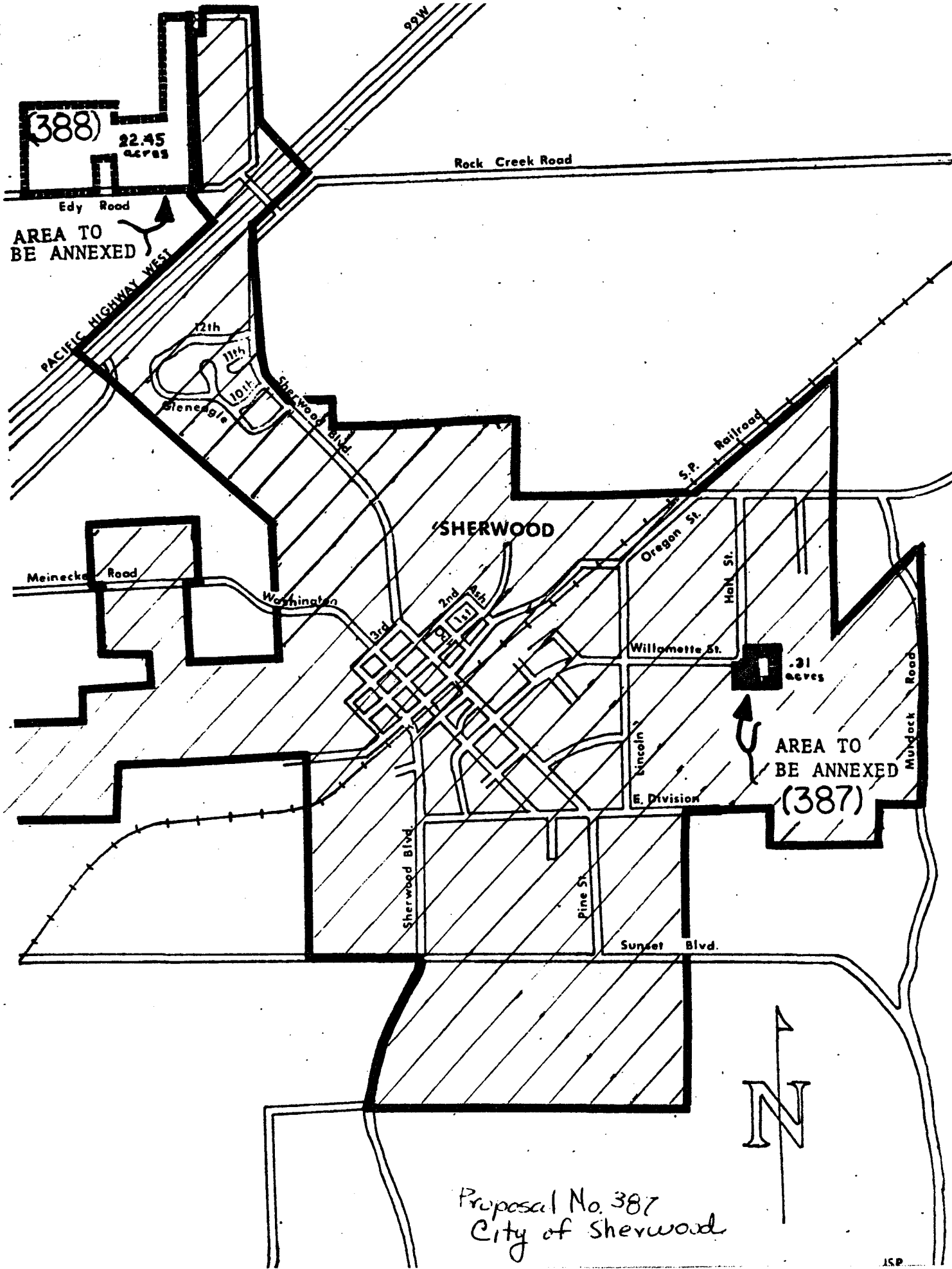

Proposal No. 387
City of Sherwood