



COPY

Resolution No. 2001-954

A RESOLUTION INITIATING ACTION TO TRANSFER JURISDICTION OF CERTAIN COUNTY ROADS WITHIN THE CITY TO THE CITY, AND ESTABLISHING AN EFFECTIVE DATE

WHEREAS, ORS.373.270(6) provides a mechanism to transfer jurisdiction of County Roads within a City to a City; and,

WHEREAS, the City of Sherwood has determined it necessary, expedient and for the best interests of the City to acquire jurisdiction over certain county roads or part thereof to the same extent as it has over other public streets and alleys of the City.

NOW, THEREFORE, THE CITY OF SHERWOOD RESOLVES AS FOLLOWS:

Section 1. Transfer Request: The City Council hereby requests that the Commissioners of Washington County, Oregon transfer jurisdiction of those County Roads, described and depicted in Exhibits "A" and "B" attached hereto, to the City of Sherwood: said request to be granted or denied within one year of the execution of this Resolution.

Section 2. Effective Date: This Resolution shall become effective upon approval and adoption.

The City Recorder is hereby instructed to deliver a certified copy of the foregoing Resolution to the Board of County Commissioners of Washington County.

Duly passed by the City Council this 22 day of May, 2001.

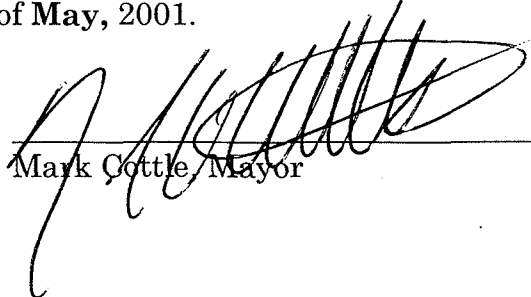

Mark Cottle, Mayor

ATTEST:

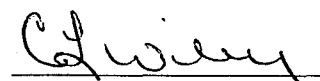

C.L. Wiley, Recorder

EXHIBIT "A"

**SURRENDER OF JURISDICTION
FROM WASHINGTON COUNTY TO THE CITY OF SHERWOOD**

**A PORTION OF SW EDY ROAD AND A PORTION OF SW BORCHERS DRIVE
FROM A POINT ± 122 ft. WEST OF SW TERRAPIN DRIVE TO SW PACIFIC
HIGHWAY**

All that portion of County Road No. 1459 lying between the beginning point of said road and the southerly extension of the west boundary of Dorothy Meadows, a subdivision of record in Washington County. Said road being situated in the Northeast one quarter of Section 30, T2S, R1W, W.M.

Resolution 2001-954
May 22, 2001
Exhibit A (1 pg)

PROPOSED TRANSFER

TO THE CITY OF SHERWOOD
PORTIONS OF
SW EDY ROAD AND SW BORCHERS DRIVE

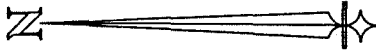

NOT TO SCALE

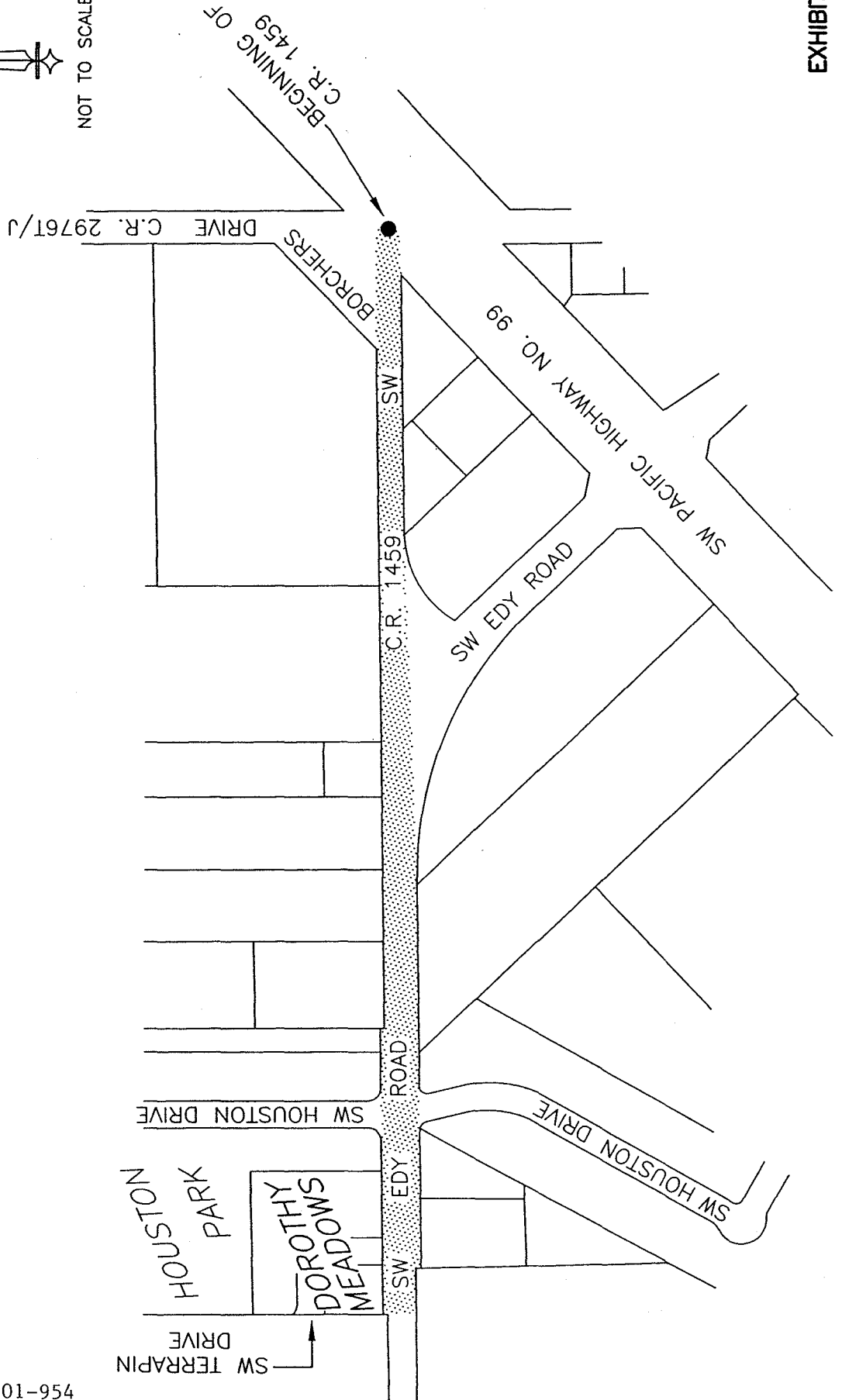



WASHINGTON COUNTY
OREGON

April 4, 2001

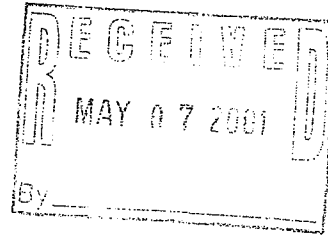

City of Sherwood
Attn. Michael Moore, Senior Project Manager
20 N W Washington Street
Sherwood, Oregon 97140

Dear Mr. Moore,

I have prepared the descriptions and maps to be used in the transfer of jurisdiction of the roads that we have discussed. I am including an example of a Resolution that has been used in the past to initiate this process. The Resolution references the descriptions and maps as "Exhibit A" and "Exhibit B". Following the format of these documents will facilitate the smooth progression of the formalities in this procedure.

When your Council has acted on this matter please send me a certified copy, of their Resolution, and I will proceed with the steps to complete the transfer of these roads. The proceedings can be completed within approximately two months after receipt of the copy of your Resolution. When we have completed this process I will send you a certified copy of the final Resolution and Order from the Board of County Commissioners.

If you have any questions or if I can be of any help please call me at (503) 846-7925.

Sincerely,

James H. Elam, P.L.S.
Survey Specialist

c: file