

RLD:pf  
1/14/87

Resolution No. 88-412

SPECIAL CITY ALLOTMENT

R E S O L U T I O N

WHEREAS, under the provisions of ORS 366.800 and 366.805, there has been withdrawn from state highway funds appropriated for allocation to the several cities of the State of Oregon the sum of Five Hundred Thousand and No/100 (\$500,000.00) Dollars, and said sum having been set up in a separate account to be administered by the Oregon Transportation Commission and to be allotted each year by said Commission to be spent, within cities, upon streets not a part of the state highway system, which are receiving excessive wear through sudden increases in population in the area or heavy and unusual traffic; and

WHEREAS, the City of Sherwood is an incorporated city of the State of Oregon and has a population of less than 5,000 as given by the latest official federal census; and

WHEREAS, the following streets of said City, \_\_\_\_\_

South Sherwood Blvd.

\_\_\_\_\_

\_\_\_\_\_

\_\_\_\_\_

are not a part or parts of the state highway system, but are streets under the jurisdiction and control of said City which are "receiving excessive wear through sudden increases in population in the area or heavy and unusual traffic"; and

WHEREAS, said streets are and each of them is in need of repair, reconditioning, and other major improvement.

NOW, THEREFORE, the members of the City Council, in regular or special session assembled, do hereby find, declare, and resolve:

1. That the aforementioned named streets of said City are in need of repair, reconditioning, and other major improvement.
2. That said streets are in their present state and condition of disrepair by reason of excessive wear through sudden increases in population in the area, or by heavy and unusual traffic.
3. That the Oregon Transportation Commission hereby is respectfully

DRAFT  
RLD:pf  
1/21/87

SPECIAL CITY ALLOTMENT (SCA) APPLICATION

CITY OF Sherwood Date May 27, 1988

Street Name South Sherwood Blvd. (From Division St to Sunset Ct.)  
(Locate on map)

Project Length 900' AVERAGE DAILY TRAFFIC Cars 1600 Trucks 500

Estimated project cost \$51,400.00

| STREET SECTION: |          | Shldr | Travel Lane | Travel Lane | Shldr    |
|-----------------|----------|-------|-------------|-------------|----------|
| Existing width: | <u>0</u> |       | <u>10</u>   | <u>10</u>   | <u>0</u> |
| Proposed width: | <u>0</u> |       | <u>14</u>   | <u>14</u>   | <u>0</u> |



PAVEMENT: Type (Gravel, Oil Mat, A.C. or P.C.C.) Extg A.C. Proposed A.C. Thkn 3

CURBS: Extg - Proposed: Length 1800 Type roll curb (Curb, Curb & Gutter, Other)

SIDEWALK: Extg - Proposed: Width - Length -

STORM SEWER: Extg - Proposed: Adjust - New, Inlets 2 Pipe (dia. 12" length 400')

BRIDGE: Name - No. - Length - Width -

Name of Stream - Type of Structure -

Sufficiency Rating No. - Will street work also be done? -

RIGHT OF WAY: Width 50' Adequate or City to acquire additional? adequate

Remarks: This project will complete improvements to South Sherwood Blvd., 750'  
of which was reconstructed in 1986 utilizing S.C.A. funds.

By Norma Jan Opler  
Mayor

By Polly Blankenbaker  
City Recorder

By Jane Ray  
City Administrator

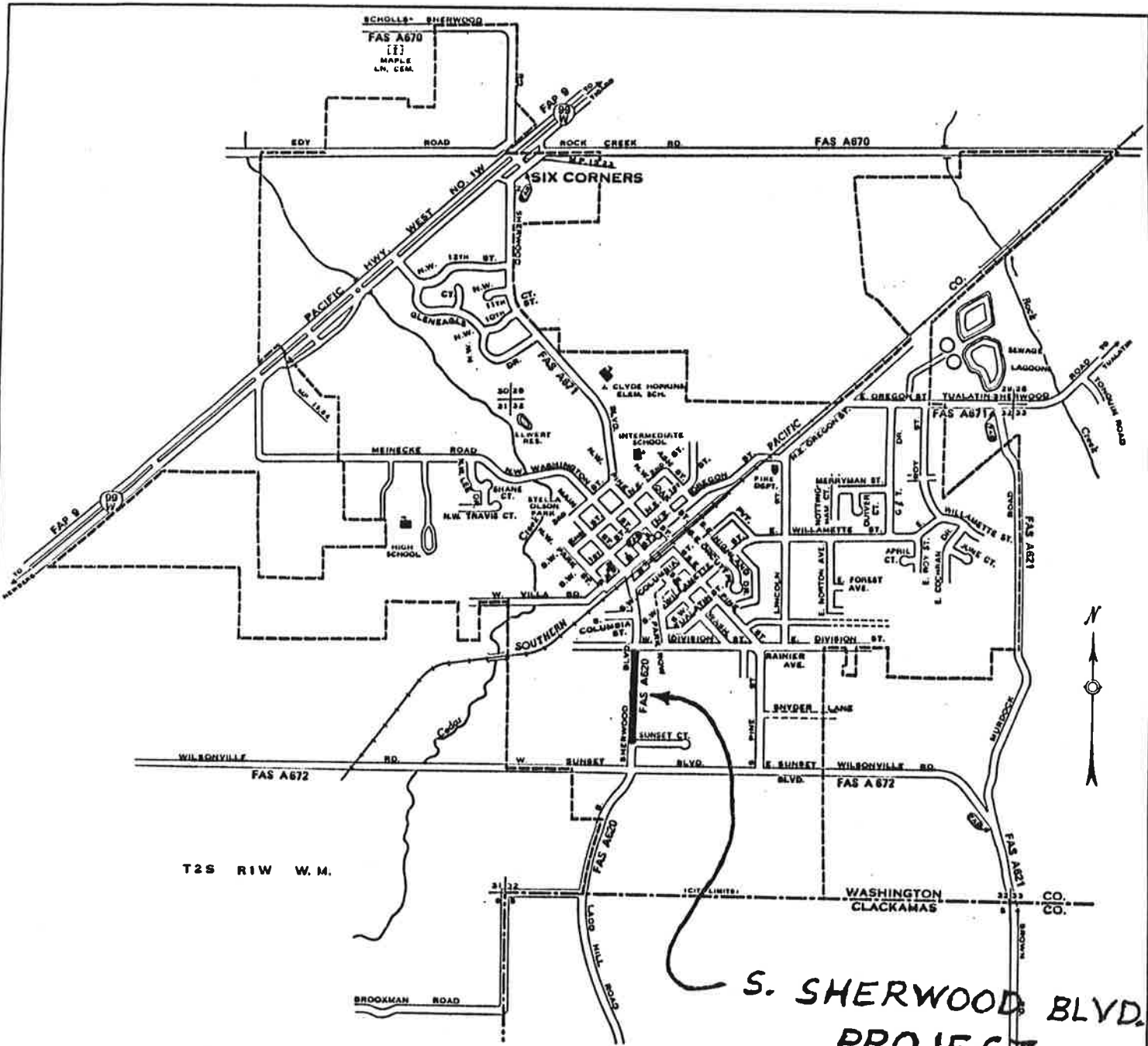

T2S R1W W.M.

S. SHERWOOD BLVD.  
PROJECT

LEGEND

- INTERSTATE NUMBERED ROUTE
- U.S. NUMBERED ROUTE
- STATE NUMBERED ROUTE
- TERMINATION OF PA SYSTEM
- DIVIDED HIGHWAY
- STREET OPEN FOR TRAVEL
- POST OFFICE
- SCHOOL
- CITY CENTER
- CITY LIMITS
- PUBLIC AREA
- PUBLIC BUILDING
- COURT HOUSE
- CITY HALL
- ARMORY
- LIBRARY

**SHERWOOD**  
WASHINGTON COUNTY, OREGON

PREPARED BY THE  
OREGON STATE HIGHWAY DIVISION  
IN COOPERATION WITH  
U.S. DEPARTMENT OF TRANSPORTATION  
FEDERAL HIGHWAY ADMINISTRATION

POP. 2060

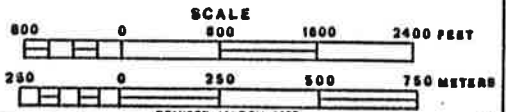

REVISED MARCH 1977

Copies of this map are available at nominal cost from Oregon State Highway Division, Salem, Oregon, 97310