

RESOLUTION

WHEREAS, under the provisions of ORS 366.800 and 366.805 there has been withdrawn from state highway funds appropriated for allocation to the several cities of the State of Oregon the sum of Two Hundred Fifty Thousand and No/100 (\$250,000) Dollars, and said sum has been set up in a separate account to be administered by the Oregon Transportation Commission and to be spent each year by said Commission upon streets not a part of the state highway system, within cities which are receiving excessive wear through sudden increases in population in the area or heavy and unusual traffic; and

WHEREAS, the City of Sherwood is an incorporated city of the State of Oregon and has a population of 1,750 as given by the latest official census; and

WHEREAS, the following streets of said city, _____

South Washington Street

are not a part or parts of the state highway system, but are streets under the jurisdiction and control of said city which are "receiving excessive wear through sudden increase in population in the area or heavy and unusual traffic," and

WHEREAS, said streets are and each of them is in need of repair, reconditioning, and other major improvement,

NOW, THEREFORE, the members of the City Council, in regular or special session assembled, do hereby find, declare, and resolve:

1. That the aforesaid named streets of said city are in need of repair, reconditioning, and other major improvement.

2. That said streets are in their present state and condition of disrepair by reason of excessive wear through sudden increases in population in the area, or by heavy and unusual traffic.

3. That the Oregon Transportation Commission hereby is respectfully requested to consider and declare said streets as qualified for reconditioning, repair, and other improvement out of funds allocated and made available by and through the said \$250,000 appropriation of state highway revenues which is to be administered and spent by the Transportation Commission.

4. That the City of Sherwood does hereby offer to Transportation Commission and does hereby pledge complete cooperation and assistance to the end that said city may share and participate in the use and benefit of said special fund and appropriation; and therefore does designate Tad L. Milburn as the official representative of the city in all negotiations resulting from this request.

Passed and approved this 12 day of May, 1976

There is attached hereto and made a part hereof, a city map on which is indicated the street, streets, road, or roads described in this resolution.

* * * * *

I hereby certify that the foregoing resolution was passed and approved by the City Council of the City of Sherwood at a regular or special meeting of said Council, held on the 12 day of May, 1976, and the above copy is a true and correct copy of the original and of the whole thereof.

Dated this 12th day of May, 1976.

Polly Blankenbaker
City Recorder

PROJECT DATA. CITY OF SHERWOOD Date April 26, 1976

To be financed by Special City Allotment Fund and necessary city funds.

Street name South Washington St.
(Locate project on attached map.)

Project length 490'

DESIRED STREET SECTION:

Standard roadway; width of travel way: 24 feet, width of shoulders: 9 feet

Curbed section; width curb to curb: 42 feet

Remarks _____

Surface now in place: Oil X Paving _____ Gravel X

Present surface width: 20 feet

RIGHT-OF-WAY: (City shall, without cost to State, provide all right-of-way required)

Width of present right-of-way: 60 feet

Additional right-of-way required? Yes _____ No X

State to furnish right-of-way descriptions? Yes _____ No X

Give width of intersecting streets: 60' R/W 20' Travel Way

Are intersecting streets curbed? Yes _____ No X

Remarks _____

CONCRETE CURBS:

Now in place? Yes _____ No X

Width between present curbs: _____ feet

City to construct curbs? Yes _____ No X

To be constructed as part of project? Yes X No _____

Length of desired radius on curb returns: 15 feet

Does city desire special type of curbs? Yes _____ No X

Explain: _____

SIDEWALKS

Are sidewalks now in place? Yes X No ___

Present sidewalks, Length: 100 feet; Width: 4 feet

Distance between present sidewalks: - feet

Are sidewalks to be constructed as part of project? Yes X No ___

Width of sidewalks to be constructed: 4 feet

Are sidewalks to be constructed only on one side of street? Yes X No ___

Are sidewalks to be constructed on both sides of street? Yes ___ No X

Give: Length to be constructed and On which side of street

377 feet N. ___ S. ___ E. X W. ___
 feet N. ___ S. ___ E. ___ W. ___

Should sidewalks be placed against curbs? Yes ___ No X

Is utility strip required? Yes ___ No X; Width: feet

Remarks Continue existing sidewalk to end of project

STORM SEWERS - - - - -

Now in place?. Yes X No ___

If yes, are they adequate for increased flow? Yes ___ No X

Indicate depth of main lines from present surface: 3 feet

To be constructed by City? Yes X No ___

To be constructed as part of project? Yes ___ No X

[Show location of outfall on city map.]

SANITARY SEWERS - - - - -

Now in place? Yes X No ___ [NOTE: City to adjust if required.]

If yes, indicate depth of sewers from present surface: 6 feet

Remarks _____

WATER MAINS: (City to adjust if required.)

Now in place? Yes X No

If yes, how deep from present surface? 3 feet

Remarks _____

DRIVEWAYS:

To be constructed as part of project? Yes X No

Asphaltic concrete? Yes No X

Portland cement? Yes X No

How many? 7

Must driveways be Portland cement to comply with city code? Yes X No

Is there a city ordinance specifying width and number of driveways permitted?
Yes No X (If yes, please include copy of ordinance.)

Remarks 3 residential driveways and 4 commercial

FRANCHISED UTILITIES: (City is to arrange for any required adjustment.)

Gas lines? Yes X No

Electric poles? Yes X No

Which company? Northwest Natural Gas & Portland General Electric
(NOTE: If city-owned, city to adjust.)

Telephone poles? Yes X No

Which company? General Telephone

Railroad tracks? Yes No X

Which company? _____

Is crossing presently protected by automatic railroad signals?

Yes No

Remarks _____

WORK TO BE DONE BY CITY AS PART OF PROJECT:

Grading? Yes No

Clearing? Yes No

Base rock? Yes No

Concrete curbs? Yes No

Driveways? Yes No

Remarks _____

GENERAL INFORMATION:

Are city finances available? Yes No

When available? Date July 1, 1976

Has city established grade on street? Yes No
(If yes, please include copy of data.)

Please indicate site for disposal of excess excavated material: City

Park Site - Approximately 1/2 mile haul

General remarks: City must approve any grades set for Street

By _____ Mayor

By _____ City Recorder or City Manager

By _____ City Engineer

1 2 3 4 5 6 7

A
B
C
D
E
F
G

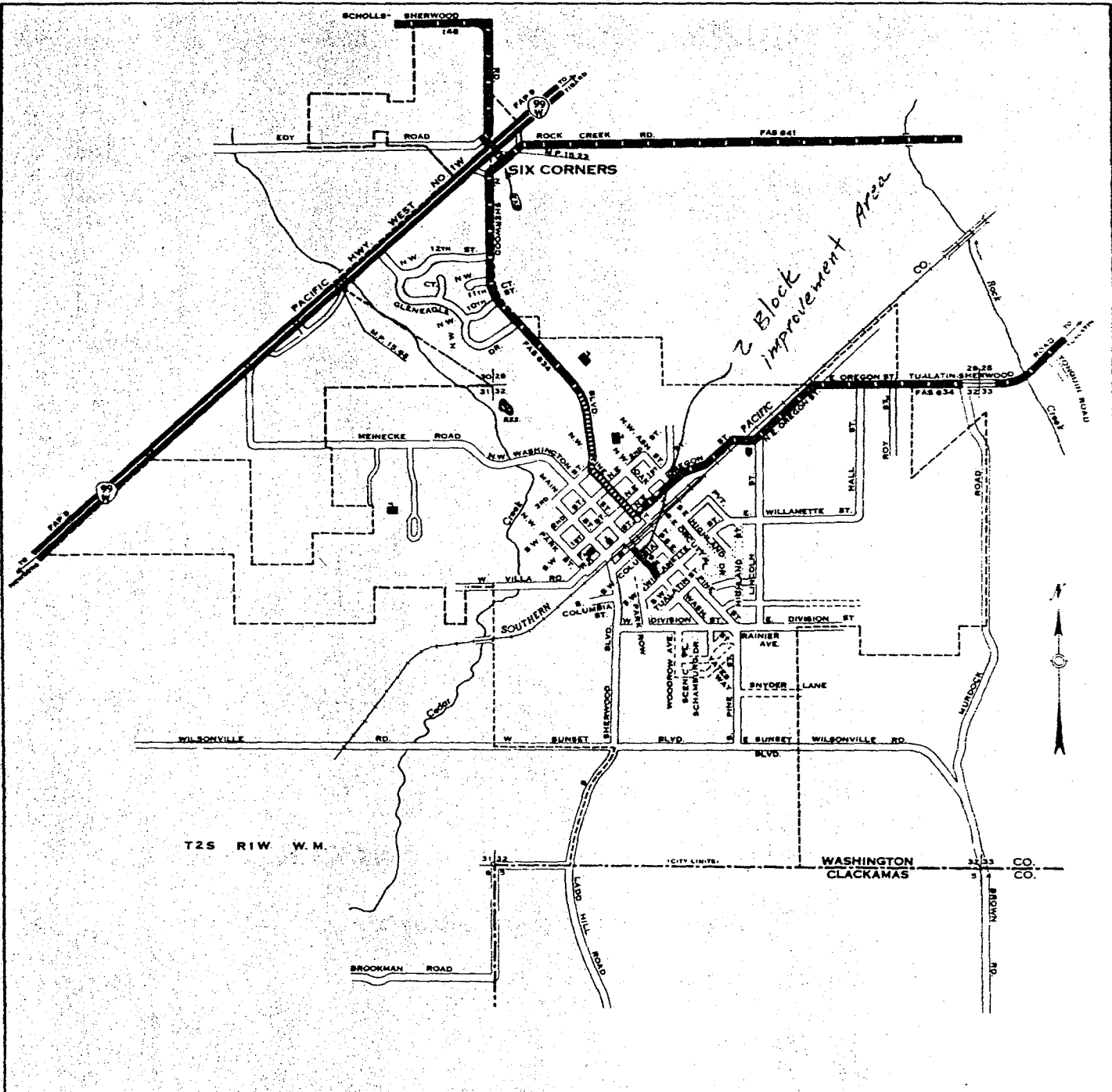

- LEGEND**
- | | |
|---------------------------------------|---------------------------------|
| FEDERAL AID INTERSTATE SYSTEM | INTERSTATE NUMBERED ROUTE (FAI) |
| FEDERAL AID PRIMARY SYSTEM | U.S. NUMBERED ROUTE |
| FEDERAL AID SECONDARY SYSTEM - STATE | STATE NUMBERED ROUTE |
| FEDERAL AID SECONDARY SYSTEM - COUNTY | POST OFFICE |
| OTHER FEDERAL AID SECONDARY - LOCAL | SCHOOL |
| TERMINATION OF FA SYSTEM | CITY CENTER |
| DIVIDED HIGHWAY | R.R. DEPOT |
| UNDIVIDED HIGHWAY - NO. OF LANES | CITY LIMITS |
| STREET OPEN FOR TRAVEL | PUBLIC BLDG. |
| STREET DEDICATED BUT NOT OPEN | CITY HALL |
| | COURT HOUSE |
| | ARMORY |
| | LIBRARY |

SHERWOOD
WASHINGTON COUNTY, OREGON

OREGON STATE HIGHWAY DIVISION

U.S. DEPARTMENT OF TRANSPORTATION
FEDERAL HIGHWAY ADMINISTRATION

Population 1,490

Scale in Feet

Revised November 1972