

City of Sherwood, Oregon

Resolution No. 95-623

A RESOLUTION DIRECTING A PUBLIC HEARING BE HELD ON THE PROPOSED VACATION OF A PORTION OF COUNTY ROAD NO. 1426 (OLD PACIFIC HIGHWAY) AND A PORTION OF COUNTY ROAD NO. 441 (S.W. SUNSET BOULEVARD) IN THE CITY OF SHERWOOD, AND DIRECTING THE CITY RECORDER TO GIVE NOTICE THEREBY BY PUBLICATION AND POSTING OF NOTICE.

WHEREAS, portions of County Road No. 1426 and County Road No. 441 are dedicated public rights-of-way, giving the public rights over the land for street and utility improvements; and

WHEREAS, the purpose for this vacation is to vacate portions of County Road No. 1426 and County Road No. 441 that are no longer needed for public use and because alternate access is being created; and

WHEREAS, 100% of the vestees of the adjacent land are not opposed to this vacation; and

WHEREAS, all affected service providers, including utility companies and emergency services, have reviewed this vacation proposal and either have no objections or have recommended specific conditions of approval which have been incorporated into this resolution; and

WHEREAS, the City Council having considered the request on October 10, 1995, finds that it is in the public interest to approve the request to vacate certain portions of public street rights-of-way for County Road No. 1426 and County Road No. 441 because the public interest will not be prejudiced by this vacation as provided by ORS 271.120.

NOW, THEREFORE, THE CITY RESOLVES AS FOLLOWS:

That a public hearing be held on the proposed vacation on Tuesday, November 14, 1995, at 7:30 p.m. at the Council meeting in Stewart Community/Senior Center, and that the Recorder be and is hereby authorized and directed to give notice thereof, substantially in the following form, by publication once each week for four successive weeks prior to the hearing date and by posting within five days after the day of first publication, at or near each end of the proposed vacation, a copy of the following notice in at least two conspicuous places in the vacation area:

Notice of Street Vacation

The City Council of the City of Sherwood will hear and consider objections to the matter of a proposed street vacation at 7:30 p.m. on November 14, 1995, at its meeting in the Stewart

Community/Senior Center, 855 North Sherwood Boulevard, Sherwood, Oregon. The areas to be vacated are described as follows:

A tract of land in the southwest one-quarter of Section 31, T.2S, R.1W., W.M., Washington County, Oregon, to wit:

Beginning at the southwest corner of Tract "P" "Woodhaven"; thence N.00°12'28"E. along the westerly lines of Tract "P", Colfelt Lane and Tract "M", "Woodhaven", 532.23 feet to the point of curve right of a 1,392.59-foot radius curve; thence along the arc of said curve right through a central angle of 04°11'48", 102.00 feet (chord bears N.02°18'22"E., 101.98 feet) to the southerly end of Curve No. 72 as shown on the duly recorded plat of said "Woodhaven"; thence southwesterly along the extension of said Curve No. 72, on the arc of a 50.00-foot radius non-tangent curve right (the radius point of which bears N.31°38'49"W.) through a central angle of 11°11'27", 9.77 feet (chord bears S.63°56'54"W., 9.75 feet) to the point of curve left of an 18.00-foot radius curve; thence along the arc of said curve left through a central angle of 66°00'51", 20.74 feet (chord bears S.36°32'12"W., 19.61 feet) to the point of curve left of a 1,411.59-foot radius curve; thence along the arc of said curve left through a central angle of 03°19'19", 81.84 feet (chord bears S.01°52'08"W., 81.83 feet); thence S.00°12'28"W., 532.21 feet to a point on the westerly extension of the south line of said Tract "P"; thence S.89°43'47"E., 19.00 feet to the Point of Beginning.

Contains approximately 11,939 square feet, more or less.

A tract of land in the southwest one-quarter of Section 31, T.2S., R.1W; W.M., Washington County, Oregon, to wit:

Beginning at the northerly end of Curve No. 72 as shown on the duly recorded plat of "Woodhaven"; thence northeasterly along the westerly boundaries of Tract "M", "Woodhaven", on the arc of a 1,392.59-foot radius curve right (the radius point of which bears S.82°20'20"E.) through a central angle of 04°45'51", 115.79 feet (chord bears N. 10°02'36"E., 115.76 feet) to the northerly end of Curve No. 48 as shown on said plat; thence S.23°25'25"W., 110.42 feet to the counterclockwise extension of said Curve No. 72; thence running southeasterly along said extension, on the arc of a 50.00-foot radius curve right (the radius point of which bears S.12°31'41"W.) through a central angle of 31°11'05", 27.21 feet (chord bears S.61°52'46"E., 26.88 feet) to the Point of Beginning.

Contains approximately 1,353 square feet, more or less.

A tract of land in the southwest one-quarter of Section 31, T.2S., R.1W., W.M., Washington County, Oregon to wit:

Beginning at the southwest corner of Tract "O", "Woodhaven"; thence N. 89°39'13"E., 204.43 feet to the southeast corner of said "Tract "O"; thence southeasterly along the extension of the northeasterly line of said Tract "O", on the arc of a 765.00-foot radius non-tangent curve left (the radius point of which bears N.24°21'18"E.) through a central angle of 15°25'38", 205.98 feet (chord bears S.73°21'31"E., 205.36 feet) to the westerly end of Curve No. 172 as shown on the duly recorded plat of said "Woodhaven"; thence S.89°39'13"W. along the northerly lines of Tracts "R" and "I", "Woodhaven"; 509.80 feet to the northerly end of Curve No. 175 as shown on said "Woodhaven" plat; thence northeasterly along the extension of said Curve No. 175, on the arc of a 20.00-foot radius non-tangent curve right (the radius point of which bears S.59°54'16"E.) through a central angle of 47°29'03", 16.58 feet (chord bears N. 53°50'16"E., 16.10 feet) to the southwesterly extension of Curve No. 169 as shown on said "Woodhaven" plat; thence northeasterly along said southwesterly extension, on the arc of a 200.00-foot radius curve left, through a central angle of 31°27'26", 109.81 feet (chord bears N.61°51'04"E., 108.43 feet) to the Point of Beginning.

Contains 20.074 square feet, more or less.

Said vacations are being proposed by the Sherwood City Council. Persons affected thereby who object to the proposed street vacation should file their objections in writing with the City Recorder at City Hall, 90 NW Park, Sherwood, Oregon, prior to the time set for the hearing.

Approved by the City Council this 10th day of October, 1995.

Walter Hitchcock, Mayor

Attest:



Larry D. Cole, City Manager/Recorder

PARCEL 2
WOODHAVEN ROAD VACATION
OLD HIGHWAY 99 WEST
DESCRIPTION
August 31, 1995

A tract of land in the southwest one-quarter of Section 31, T.2S., R.1W., W.M., Washington County, Oregon, to wit:

Beginning at the southwest corner of Tract 'P', "Woodhaven"; thence N.00°12'28"E. along the westerly lines of Tract 'P', Colfelt Lane and Tract 'M', "Woodhaven", 532.23 feet to the point of curve right of a 1,392.59-foot radius curve; thence along the arc of said curve right through a central angle of 04°11'48", 102.00 feet (chord bears N.02°18'22"E., 101.98 feet) to the southerly end of Curve No. 72 as shown on the duly recorded plat of said "Woodhaven"; thence southwesterly along the extension of said Curve No. 72, on the arc of a 50.00-foot radius non-tangent curve right (the radius point of which bears N.31°38'49"W.) through a central angle of 11°11'27", 9.77 feet (chord bears S.63°56'54"W., 9.75 feet) to the point of curve left of an 18.00-foot radius curve; thence along the arc of said curve left through a central angle of 66°00'51", 20.74 feet (chord bears S.36°32'12"W., 19.61 feet) to the point of curve left of a 1,411.59-foot radius curve; thence along the arc of said curve left through a central angle of 03°19'19", 81.84 feet (chord bears S.01°52'08"W., 81.83 feet); thence S.00°12'28"W., 532.21 feet to a point on the westerly extension of the south line of said Tract 'P'; thence S.89°43'47"E., 19.00 feet to the Point of Beginning.

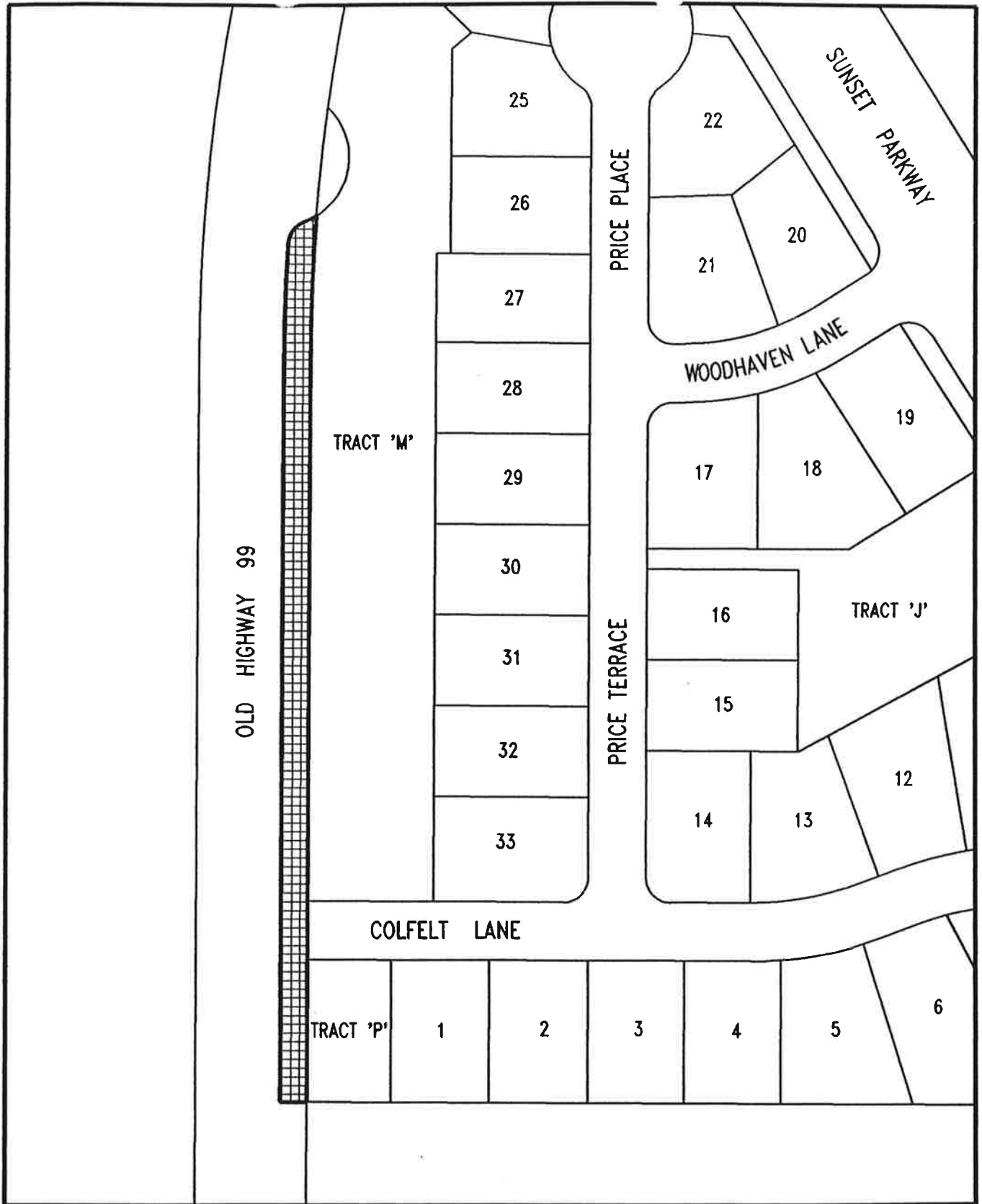
Contains 11,939 square feet, more or less.



STREET VACATION PARCEL 2 WOODHAVEN

otak
Incorporated

surveyors
engineers
planners

17355 S.W. BOONES FERRY ROAD
LAKE OSWEGO, OREGON 97035
(503)635-3618 FAX (503)635-5395

PARCEL 3
WOODHAVEN ROAD VACATION
OLD HIGHWAY 99 WEST
DESCRIPTION
Revised October 4, 1995

A tract of land in the southwest one-quarter of Section 31, T.2S., R.1W., W.M., Washington County, Oregon, to wit:

Beginning at the northerly end of Curve No. 72 as shown on the duly recorded plat of "Woodhaven"; thence northeasterly along the westerly boundaries of Tract 'M', "Woodhaven", on the arc of a 1,392.59-foot radius curve right (the radius point of which bears S.82°20'20"E.) through a central angle of 04°45'51", 115.79 feet (chord bears N.10°02'36"E., 115.76 feet) to the northerly end of Curve No. 48 as shown on said plat; thence S.23°25'25"W., 110.42 feet to the counterclockwise extension of said Curve No. 72; thence running southeasterly along said extension, on the arc of a 50.00-foot radius curve right (the radius point of which bears S.12°31'41"W.) through a central angle of 31°11'05", 27.21 feet (chord bears S.61°52'46"E., 26.88 feet) to the Point of Beginning.

Contains 1,353 square feet, more or less.

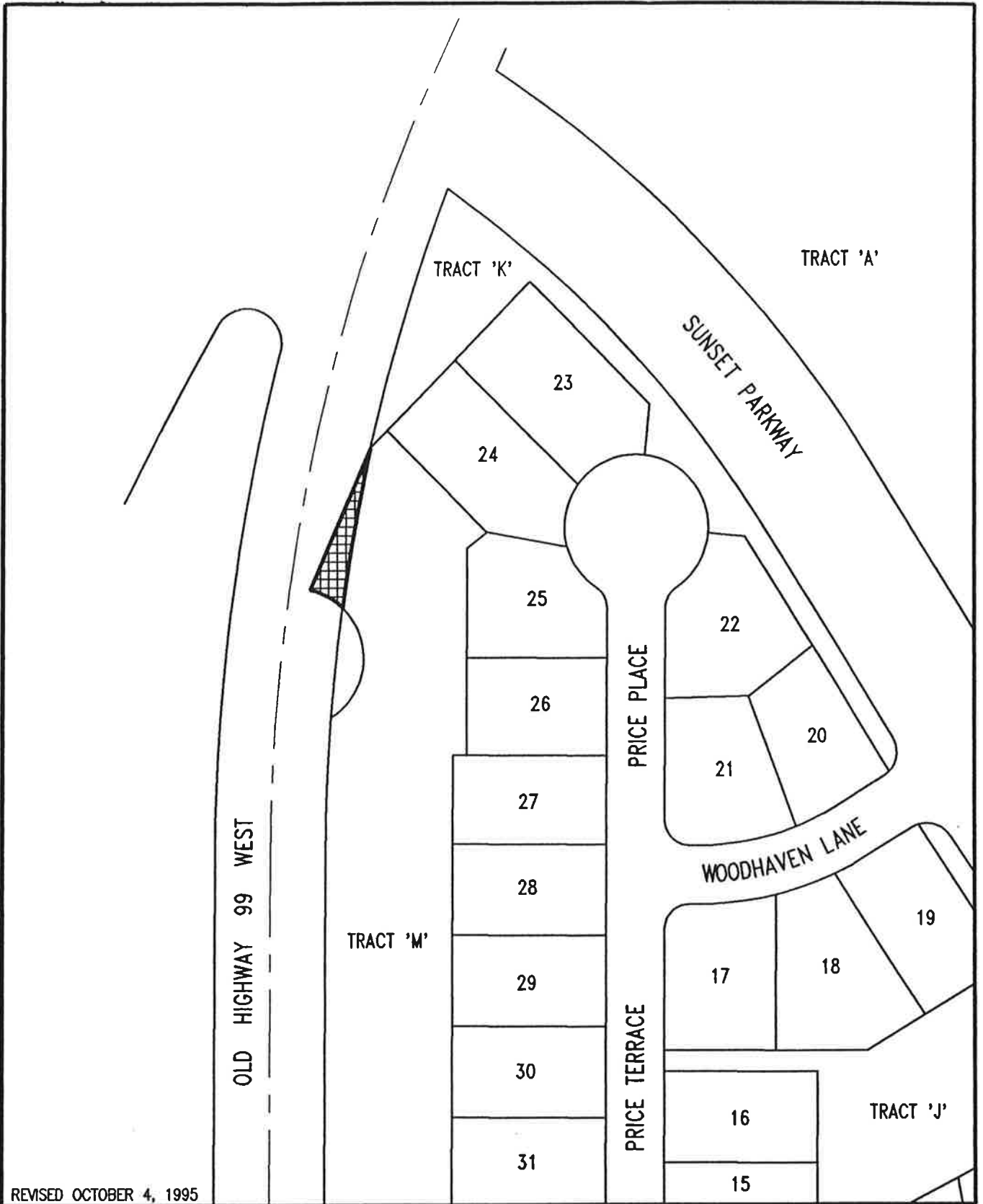

REVISED OCTOBER 4, 1995

STREET VACATION PARCEL 3 WOODHAVEN

otak
Incorporated

surveyors
engineers
planners

17355 S.W. BOONES FERRY ROAD
LAKE OSWEGO, OREGON 97035
(503)635-3618 FAX (503)635-5395

PARCEL I
WOODHAVEN ROAD VACATION
S.W. SUNSET BOULEVARD
DESCRIPTION
August 31, 1995

A tract of land in the southwest one-quarter of Section 31, T.2S., R.1W., W.M., Washington County, Oregon, to wit:

Beginning at the southwest corner of Tract 'O', "Woodhaven"; thence N.89°39'13"E., 204.43 feet to the southeast corner of said Tract 'O'; thence southeasterly along the extension of the northeasterly line of said Tract 'O', on the arc of a 765.00-foot radius non-tangent curve left (the radius point of which bears N.24°21'18"E.) through a central angle of 15°25'38", 205.98 feet (chord bears S.73°21'31"E., 205.36 feet) to the westerly end of Curve No. 172 as shown on the duly recorded plat of said "Woodhaven"; thence S.89°39'13"W. along the northerly lines of Tracts 'R' and 'I', "Woodhaven", 509.80 feet to the northerly end of Curve No. 175 as shown on said "Woodhaven" plat; thence northeasterly along the extension of said Curve No. 175, on the arc of a 20.00-foot radius non-tangent curve right (the radius point of which bears S.59°54'16"E.) through a central angle of 47°29'03", 16.58 feet (chord bears N.53°50'16"E., 16.10 feet) to the southwesterly extension of Curve No. 169 as shown on said "Woodhaven" plat; thence northeasterly along said southwesterly extension, on the arc of a 200.00-foot radius curve left, through a central angle of 31°27'26", 109.81 feet (chord bears N.61°51'04"E., 108.43 feet) to the Point of Beginning.

Contains 20,074 square feet, more or less.

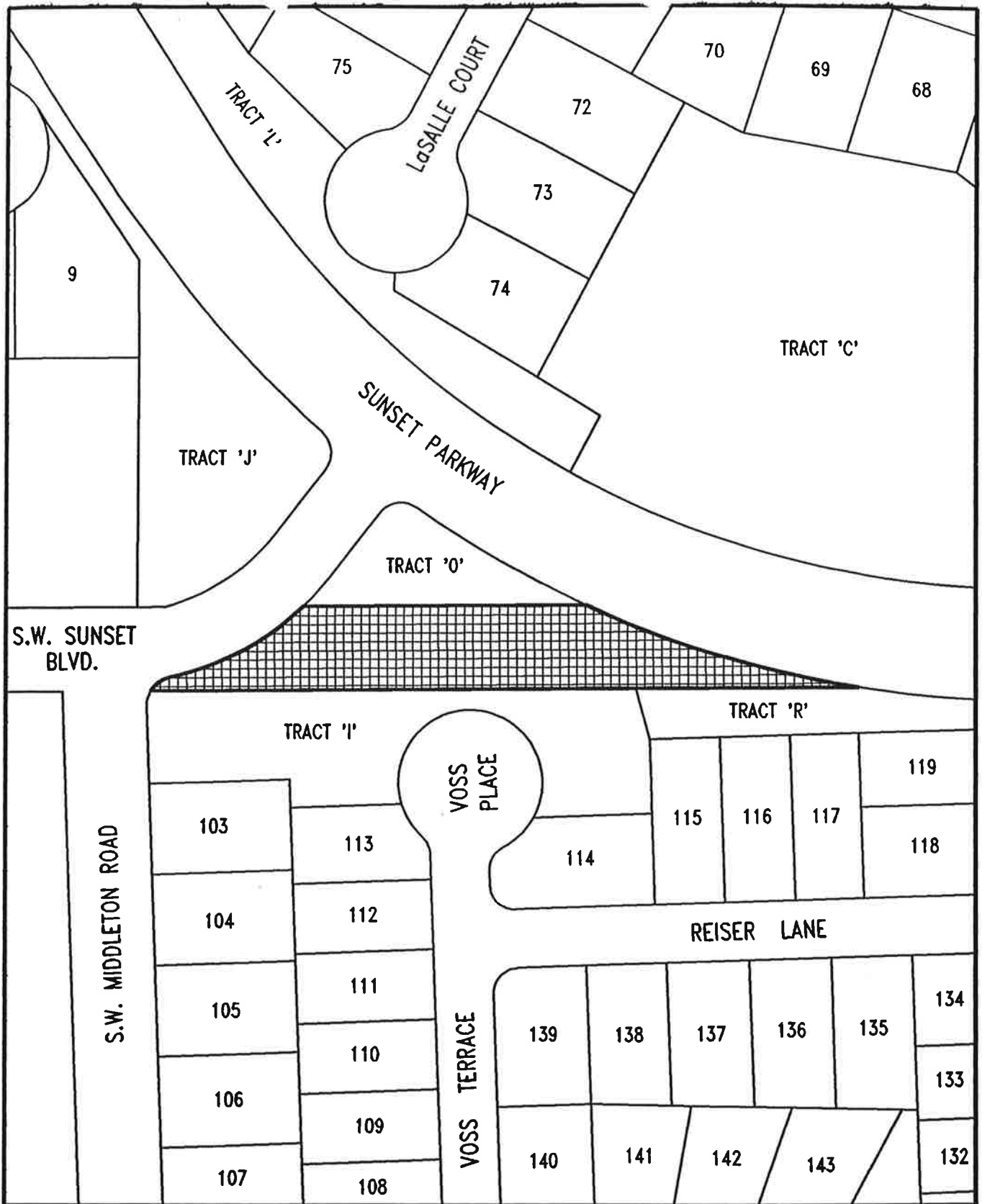

STREET VACATION PARCEL 1 WOODHAVEN

otak
Incorporated

surveyors
engineers
planners

17355 S.W. BOONES FERRY ROAD
LAKE OSWEGO, OREGON 97035
(503)635-3618 FAX (503)635-5395