

CITY OF SHERWOOD OREGON

RESOLUTION NO. 95-600

A RESOLUTION INITIATING ACTION TO TRANSFER JURISDICTION
OF CERTAIN COUNTY ROADS WITHIN THE CITY TO THE CITY.

WHEREAS, ORS 373.270(6) provides a mechanism to transfer jurisdiction of County Roads within a City to a City; and

WHEREAS, the City of Sherwood has determined it necessary, expedient and for the best interests of the city to acquire jurisdiction over certain county roads or part thereof to the same extent as it has over other public streets and alleys of the city.

NOW THEREFORE, THE CITY RESOLVES AS FOLLOWS:

Section 1. Transfer Request: The Council hereby requests that the Commissioners of Washington County, Oregon transfer jurisdiction of those County Roads, described and depicted in Exhibits "A" and "B" attached hereto, to the City of Sherwood; said request to be granted or denied within one year of the execution of this Resolution.

Section 2. Effective Date: This resolution shall become effective upon approval and adoption.

The City Recorder be and is hereby instructed to deliver a certified copy of the foregoing resolution to the Board of County Commissioners of Washington County, Oregon.

Duly passed by the City Council January 24, 1995.

Walter Hitchcock, Mayor

ATTEST:



James H. Rapp, City Manager
City Recorder

EXHIBIT "A"
DESCRIPTIONS

SEE EXHIBIT "B" ITEM "1"

A PORTION OF SUNSET BOULEVARD (COUNTY ROAD NO. 441)

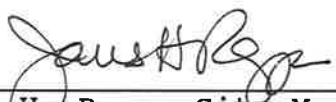
Lying between the Willamette and Pacific Railroad (formerly Southern Pacific) and the West line of Gregory Park, a record subdivision.

That portion of County Road No. 441 lying between the West right of way of the Willamette and Pacific Railroad and the East line of Section 31, T2S, R1W, W.M. Said road being situated in the Southeast one quarter of Section 31, T2S, R1W, W.M.

SEE EXHIBIT "B" ITEM "2"

A PORTION OF SUNSET BOULEVARD (COUNTY ROAD NO. A-40, 311, 341, AND 441)

Lying between Ladd Hill Road and Murdock Road.

That portion of County Road No. A-40 lying between the beginning of said County Road and that portion transferred by County Road No. 2448T/J. All of County Road No. 311 except that portion transferred by County Road No. 2448T/J. All of County Road No. 341. That portion of County Road No. 441 lying between the terminus of said County road and that portion transferred by County Road No. 2594T/J. Said road being situated in the Southwest and Southeast on quarters of Section 32, T2S, R1W, W.M.

SEE EXHIBIT "B" ITEM "3"

A PORTION OF MURDOCK ROAD (COUNTY ROAD NO. 2257)

Lying between Roy Street and Clackamas County.

That portion of County Road No. 2257 lying between the beginning point of said County Road and that portion transferred by County Road No. 2594T/J. Said road being situated in the Southeast one quarter of Section 32 and the Southwest one quarter of Section 33, T2S, R1W, W.M.

SEE EXHIBIT "B" ITEM "4"

A PORTION OF COUNTY ROAD NO. 433

Lying North of Brookman Road.

That portion of County Road No. 433 lying between the beginning point and a point 20 feet northerly from angle point number one of said County Road. Said road being situated in the Southwest one quarter of Section 32, T2S, R1W, W.M.

PROPOSED TRANSFER OF JURISDICTION

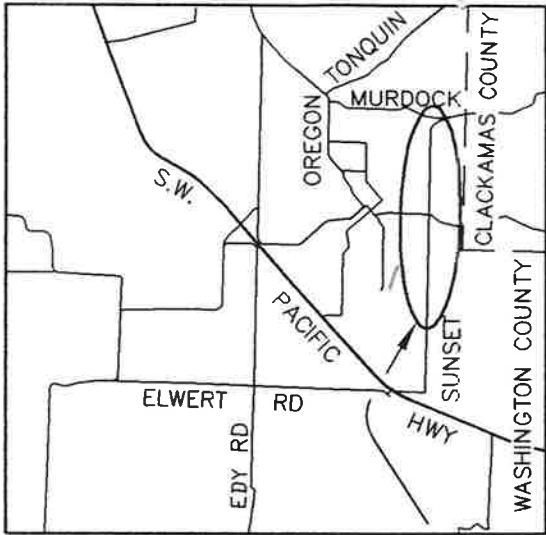

VICINITY MAP

SITE

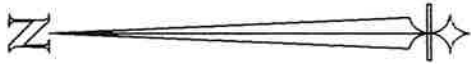

NOT TO SCALE

- ① PORTION OF C.R. 441
- ② PORTION OF C.R. A-40, C.R. 311, C.R. 341, AND C.R. 441
- ③ PORTION OF C.R. 2257
- ④ PORTION OF C.R. 433

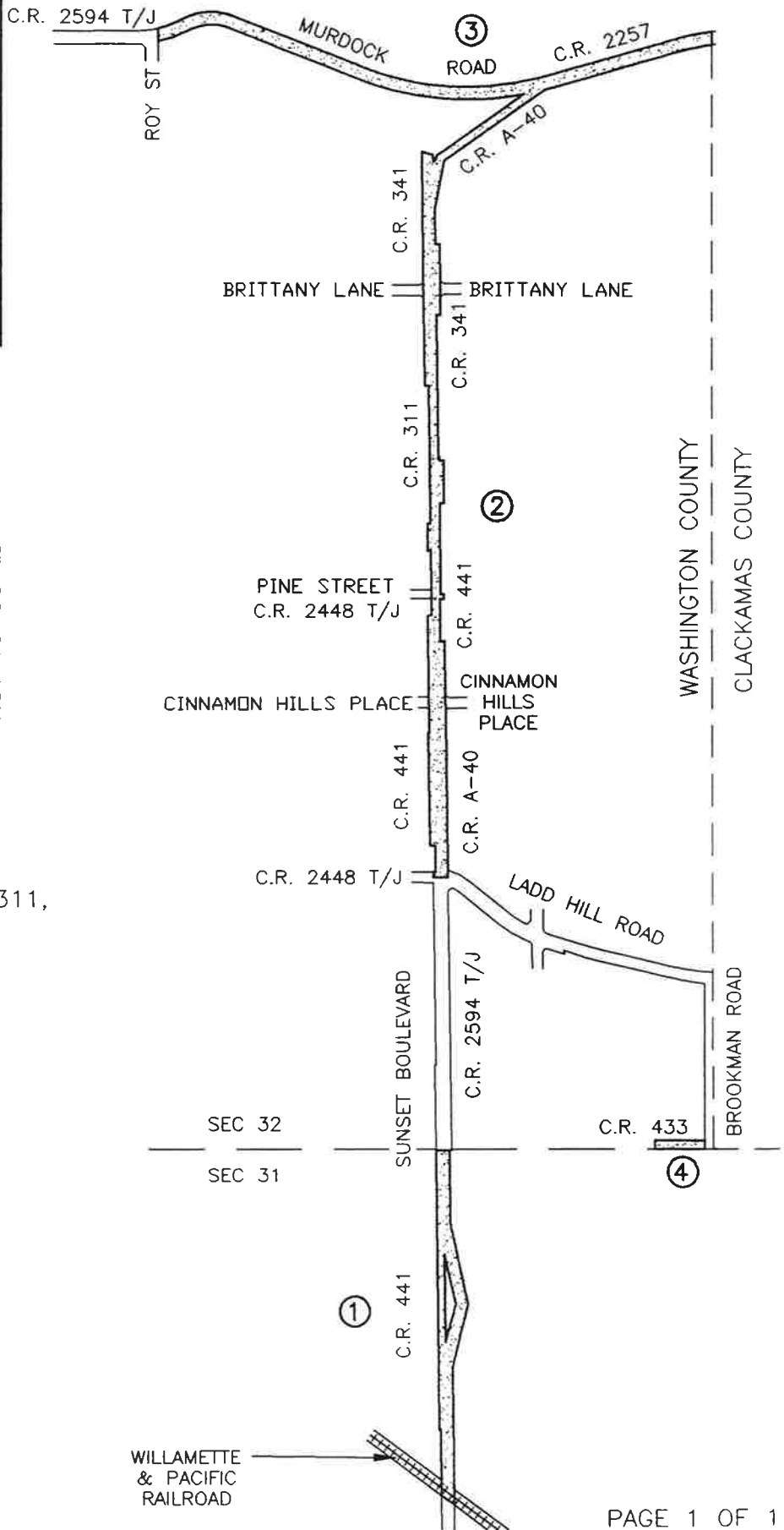



WASHINGTON
COUNTY,
OREGON

October 11, 1995

City of Sherwood
Attn. Larry Cole
90 NW Park
Sherwood, OR
97140

Dear Mr. Cole,

I am enclosing a certified copy of Washington County Resolution and Order 95-133. This copy is provided as notice of the surrender of jurisdiction of a portion of Sunset Boulevard, a portion of Murdock Road and an unnamed portion of County Road No. 433.

If you have any questions please contact me at 693-4822.

Sincerely,

A handwritten signature in blue ink, appearing to read "James H. Elam", is written over a horizontal line.

James H. Elam, P.L.S.
Survey Specialist

c: file

AGENDA

FILED

Rec LUI

WASHINGTON COUNTY BOARD OF COMMISSIONERS

OCT 04 1995

Washington County

Agenda Category Public Hearing - Land Use and Transportation CPO 5
 Agenda Title SURRENDER OF JURISDICTION - PORTIONS OF CERTAIN COUNTY ROADS TO THE CITY OF SHERWOOD (CR 2922 T/J)
 To be presented by Michael A. Borresen, Engineering/Surveying Manager *MAB*

SUMMARY (Attach Supporting Documents if Necessary)

The City of Sherwood has, by City Council action, requested the transfer of jurisdiction of portions of certain County Roads from the County to the City. The Board, by Resolution and Order No. 95-113, set October 3, 1995, the date for the public hearing on this matter. Notices were posted as required by State law, and an affidavit was filed.

The roads being proposed for transfer are roads that are not part of the county-wide transportation system. Their transfer will result in lessened maintenance costs to the county and the department supports the proposed action.

- Attachments:
1. Resolution and Order
 2. Road Descriptions - Exhibit "A"
 3. Map - Exhibit "B"

DEPARTMENT'S REQUESTED ACTION:

Approve the Resolution and Order surrendering jurisdiction of portions of certain County Roads to the City of Sherwood.

G:\WPDATA\WP51\CR2922PH.WP5\3
MAB:CP:hs
9/20/95

COUNTY ADMINISTRATOR'S RECOMMENDATION:

I concur with the department's requested action.

RO 95-133A

Agenda Item No. <u>3.a.</u>
Date: <u>Oct. 3, 1995</u>

00001

IN THE BOARD OF COUNTY COMMISSIONERS
FOR WASHINGTON COUNTY, OREGON

In the Matter of SURRENDER OF)
JURISDICTION of Portions of)
Certain County Roads to the City)
of Sherwood, Oregon.)

RESOLUTION AND ORDER
NO. RO 95-133
County Road No. 2922 T/J

This matter having come before the Board of County Commissioners at its regular meeting of October 3, 1995; and

It appearing to the Board that pursuant to ORS 373.270 the City of Sherwood, Oregon, has requested that this Board surrender jurisdiction of portions of certain County roads as described and depicted in Exhibits "A" and "B", attached and by this reference incorporated herein; and

It appearing to the Board that said roads lie within the corporate limits of the City of Sherwood and that jurisdiction over and across said roads should be transferred to the City of Sherwood; and

It appearing to the board that by Resolution and Order No. 95-113 dated August 22, 1995, it set a time and place for a public hearing on said request and required that notice of said hearing be posted pursuant to law; and

It appearing to the Board that a public hearing was held on this matter on the 3rd day of October, 1995, at 10:00 a.m. in the Auditorium of the Washington County Public Services Building, Hillsboro, Oregon; and

It appearing to the Board that the best interests of Washington County would be served by granting said request; the Board hereby

FINDS AND DETERMINES that it is necessary, expedient and in the best interests of Washington County to surrender jurisdiction to the City of Sherwood, Oregon, the roads as hereinabove described, and it is hereby

RESOLVED AND ORDERED that the jurisdiction of the County over said roads as described and depicted in Exhibits "A" and "B" and responsibility for and the full and absolute jurisdiction over said road for all purposes shall vest in the City of Sherwood, Oregon, and the City shall have the same control, power and jurisdiction of the road or portions thereof as are by its Charter and the laws of the State of Oregon given or granted over any of the public streets and alleys of said City; and it is further

RESOLVED AND ORDERED that the County Surveyor of Washington County, Oregon, hereby is ordered to amend as necessary the official records of Washington County, Oregon, to indicate the surrender of jurisdiction as herein above described; and it is further

RESOLVED AND ORDERED that the County Surveyor hereby is authorized and directed to forward a certified copy of this Resolution and Order to the City of Sherwood, Oregon, as due notice of the surrender of jurisdiction.

DATED this 3rd day of October, 1995.

BOARD OF COUNTY COMMISSIONERS
FOR WASHINGTON COUNTY, OREGON

	AYE	NAY	ABSENT
PETERS	<u>X</u>	_____	_____
CHRISTY	<u>X</u>	_____	_____
KATSION	<u>X</u>	_____	_____
DUYCK	<u>X</u>	_____	_____
ROGERS	<u>X</u>	_____	_____

Linda B. Peters
Chairman

Julia M. Swengard
Recording Secretary

Approved as to form:

/s/ Dan R. Olsen
Chief Assistant County Counsel

Date : September 12, 1995

Page 2 - R&O No. _____
Surrender of Jurisdiction C.R. #2922 T/J

EXHIBIT "A"

DESCRIPTIONS

SEE EXHIBIT "B" ITEM "1"

A PORTION OF SUNSET BOULEVARD (COUNTY ROAD NO. 441)

Lying between the Willamette and Pacific Railroad (formerly Southern Pacific) and the West line of Gregory Park, a record subdivision.

That portion of County Road No. 441 lying between the West right of way of the Willamette and Pacific Railroad and the East line of Section 31, T2S, R1W, W.M. Said road being situated in the Southeast one quarter of Section 31, T2S, R1W, W.M.

SEE EXHIBIT "B" ITEM "2"

A PORTION OF SUNSET BOULEVARD (COUNTY ROAD NO. A-40, 311, 341, AND 441)

Lying between Ladd Hill Road and Murdock Road.

That portion of County Road No. A-40 lying between the beginning of said County Road and that portion transferred by County Road No. 2448T/J. All of County Road No. 311 except that portion transferred by County Road No. 2448T/J. All of County Road No. 341. That portion of County Road No. 441 lying between the terminus of said County road and that portion transferred by County Road No. 2594T/J. Said road being situated in the Southwest and Southeast on quarters of Section 32, T2S, R1W, W.M.

SEE EXHIBIT "B" ITEM "3"

A PORTION OF MURDOCK ROAD (COUNTY ROAD NO. 2257)

Lying between Roy Street and Clackamas County.

That portion of County Road No. 2257 lying between the beginning point of said County Road and that portion transferred by County Road No. 2594T/J. Said road being situated in the Southeast one quarter of Section 32 and the Southwest one quarter of Section 33, T2S, R1W, W.M.

SEE EXHIBIT "B" ITEM "4"

A PORTION OF COUNTY ROAD NO. 433

Lying North of Brookman Road.

That portion of County Road No. 433 lying between the beginning point and a point 20 feet northerly from angle point number one of said County Road. Said road being situated in the Southwest one quarter of Section 32, T2S, R1W, W.M.

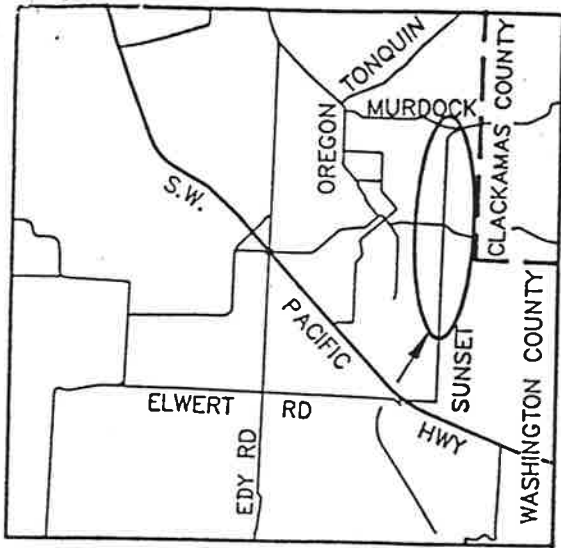

VICINITY MAP

SITE

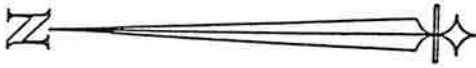

NOT TO SCALE

PROPOSED TRANSFER OF JURISDICTION

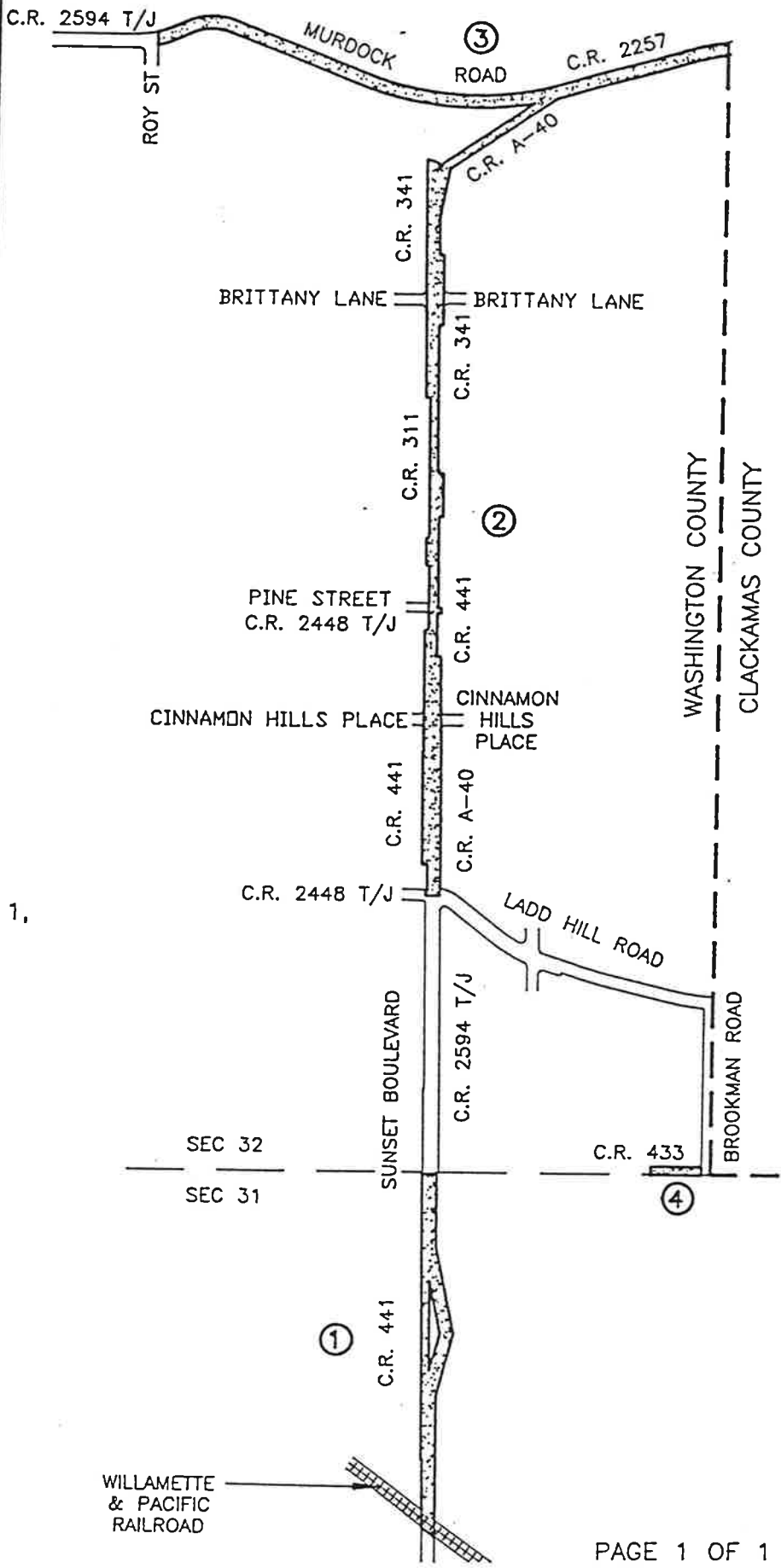

- ① PORTION OF C.R. 441
- ② PORTION OF C.R. A-40, C.R. 311, C.R. 341, AND C.R. 441
- ③ PORTION OF C.R. 2257
- ④ PORTION OF C.R. 433