

Vicinity Map

Former Mall 99 Cleaners
 976 North Pacific Highway
 Woodburn, Oregon 97301



Figure 1

Notes:

1. The locations of all features shown are approximate.
2. This drawing is for information purposes. It is intended to assist in showing features discussed in an attached document. GeoEngineers, Inc. cannot guarantee the accuracy and content of electronic files. The master file is stored by GeoEngineers, Inc. and will serve as the official record of this communication.

Data Source: ESRI
 Projection: NAD 1983 UTM Zone 10N

P:\24\24986001_GIS\24986001_Project\aprx\24986001_F01_VicinityMap Date Exported: 05/23/24 by coabrera



- Legend**
- MW-1 Monitoring Well Number
 - SV-1 Sub-Slab Soil Vapor Location
 - IA-1/OA-1 Indoor/Outdoor Air Sample Location

Approximate Property Boundary

GW investigation limited due to utilities and access to adjacent property

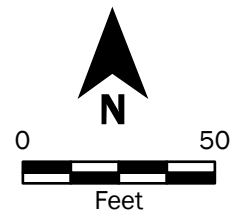

* = IA-1 was moved during the January 2025 event only

Notes:
 1. The locations of all features shown are approximate.
 2. This drawing is for information purposes. It is intended to assist in showing features discussed in an attached document. GeoEngineers, Inc. cannot guarantee the accuracy and content of electronic files. The master file is stored by GeoEngineers, Inc. and will serve as the official record of this communication.
 Data Source: ESRI Clarity, Streets from Marion County GIS.
 Contours generated by Surfer using Kriging Interpolation method.
 Projection: NAD 1983 HARN StatePlane Oregon North FIPS 3601 Feet Intl

Site Plan and Exploration Locations	
Former Mall 99 Cleaners 976 North Pacific Highway Woodburn, Oregon 97301	
	Figure 2

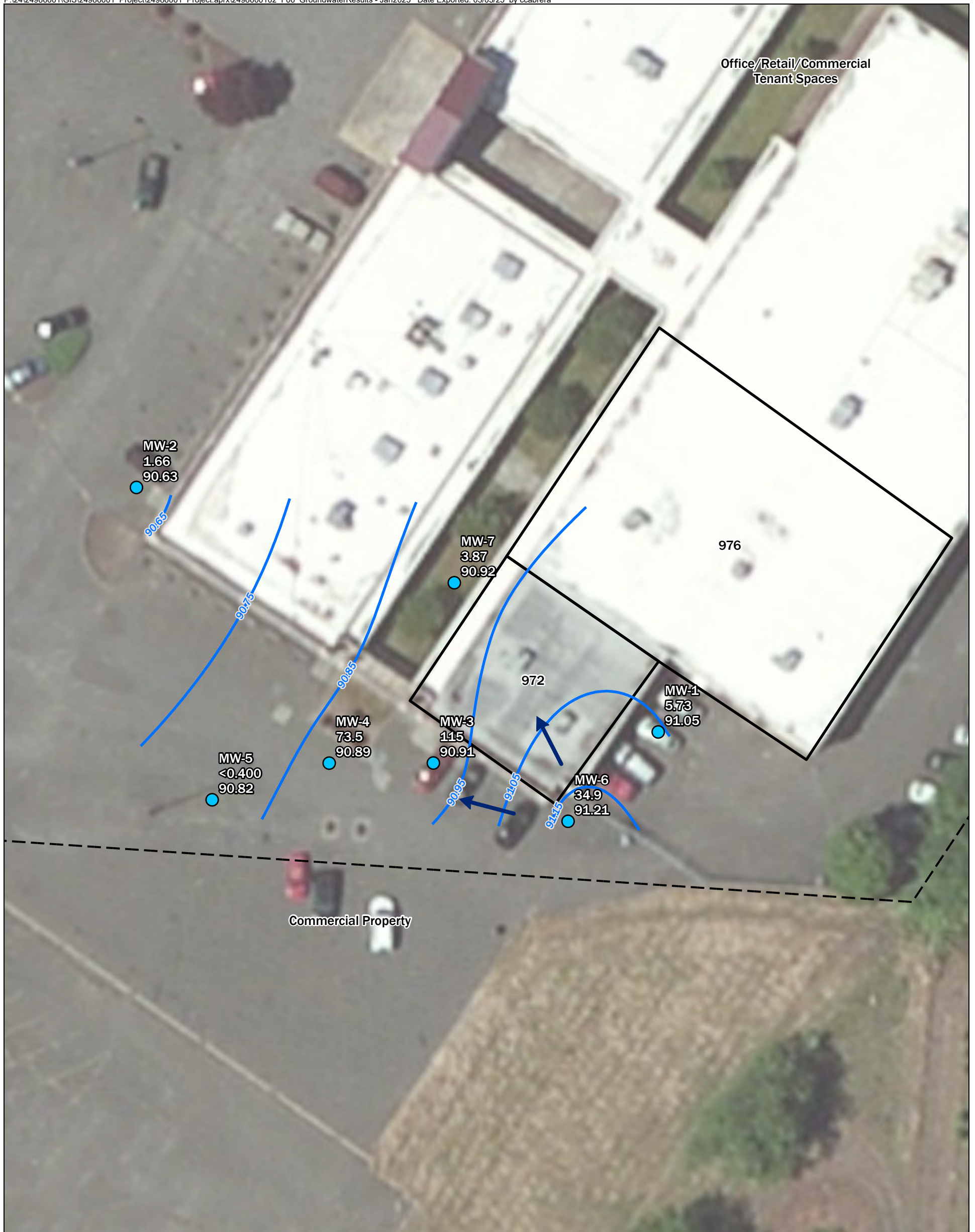

Legend

MW-1
3.80
86.39

Monitoring Well Number with PCE Concentration and Groundwater Elevation (January 2025)

- Inferred Groundwater Contour (0.10 foot)
- Groundwater Flow Direction
- Approximate Property Boundary

Tetrachloroethene (PCE) concentration in micrograms per Liter

Groundwater elevation in feet.

NM = not measured

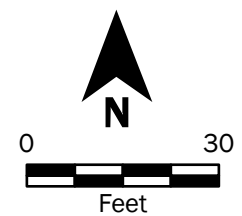

Notes:

1. The locations of all features shown are approximate.
2. This drawing is for information purposes. It is intended to assist in showing features discussed in an attached document. GeoEngineers, Inc. cannot guarantee the accuracy and content of electronic files. The master file is stored by GeoEngineers, Inc. and will serve as the official record of this communication.

Data Source: ESRI Clarity, Streets from Marion County GIS.
Contours generated by Surfer using Kriging Interpolation method.

Projection: NAD 1983 HARN StatePlane Oregon North FIPS 3601 Feet Intl

Groundwater Results - January 2025

Former Mall 99 Cleaners
976 North Pacific Highway
Woodburn, Oregon 97301



Figure 6