



City of The Dalles
Department of Public Works
1215 West First Street
The Dalles, OR 97058

November 4, 2025

-----ADDENDUM #1-----
FIRST STREET PROJECT - UNION STREET TO LAUGHLIN STREET
CONTRACT NO. 2025-014
DRAWINGS ADD SHEETS

INDEX OF SHEETS, CONT'D.	
SHEET NO.	DESCRIPTION
BA01 thru BA05	Typical Sections
BB01 thru BB05	Details
BC01 thru BC06	Curb Ramp Details
DO1A thru DO9A	General Construction
DO1B thru DO9B	Drainage And Utilities
DO1C thru DO9C	Profile
EC01 thru EC02	Traffic Control Plan
FB01	Erosion Control Plan
FB02	Erosion Control Notes
LA01 thru LA03	Permanent Signing & Striping Plan
LBO1 thru LBO2	Sign Details
LC01 thru LC02	Sign & Post Data Table

LANDSCAPE	
SHEET NO.	DESCRIPTION
RA01	Streetscape Site Legend and Notes
RB01 Thru RB09	Streetscape Site Plan
RC01	Irrigation Schedule and Notes
RC02 Thru RC10	Irrigation Plan
RD01 Thru RD06	Streetscape Site Details
RD07 Thru RD08	Irrigation Details

STRUCTURAL - WALLS	
SHEET NO.	DESCRIPTION
GB01 thru GB04	Wall A Plan and Profile
GB05 thru GB07	Wall B Plan and Profile
GB08 thru GB17	Wall Details

Illumination	
SHEET NO.	DESCRIPTION
PA01 thru PA03	Illumination Plan
PA04	Illumination Details

General Construction Notes

- Contractor is responsible to schedule and provide a UPRR flagger for any work within 25' of the nearest rail. Contractor to verify rail road requirements for flaggers.
- All survey monumentation along the project corridor shall be retained and protected, or reset by a professional land surveyor.
- Portions of the project are located within a known archeological area. Contractor to review all requirements specific to archeological excavations.
- During demolition of existing sidewalk and curb, salvage all historic stamping and metal insignias and deliver to the City.
- Water valves to be only operated by city public works crews. Contractor to call 24 hours before construction.
- City to provide concrete stamping for Old China Town district. Contractor to work with City.
- Contractor to coordinate Union Street closure with surrounding projects.
- Contractor to provide access to buildings adjacent to the project at all times to the best extent possible. Work with City, Owner, and Engineer to coordinate work schedules and accessibility.

A1

ODOT Standard Drg. Nos.

- RD348 - Manhole with Inlet
- RD417 - Midwest Guardrail System End Sections
- TM200 - Sign Installation Details
- TM201 - Miscellaneous Sign Placement Details
- TM206 - Sign Bracing Details
- TM500 - Pavement Marking Standard Detail Blocks
- TM501 - Pavement Marking Standard Detail Blocks
- TM503 - Pavement Marking Standard Detail Blocks
- TM635 - Breakway Sign and Luminaire Supports (Location Guidelines)
- TM676 - Sign Attachments
- TM677 - Sign Mounts
- TM800 - Tables, Abrupt Edge, and PCMS Detail
- TM820 - Temporary Barricades
- TM821 - Temporary Sign Support
- TM840 - Closure Details
- TM841 - Intersection Work Zone Details
- TM844 - Temporary Pedestrian Access Routing
- TM850 - 2-Lane, 2-way Roadways

City Of The Dalles (COTD) Standard Drg. Nos.

- RD250 - Thrust Blocking
- RD254 - Hydrant Installation
- RD258 - Valve Box and Operator Extension Assembly
- RD274 - Water Service Connection
- RD300 - Trench Backfill, Bedding, Pipe Zone and Multiple Installations
- RD302 - Street Cut
- RD306 - Concrete Encasement, Cradle, and Cap Details
- RD335 - Standard Storm Sewer Manhole
- RD336 - Standard Manhole Details
- RD339 - Pipe to Structure Connections
- RD342 - Shallow Manholes
- RD344 - Standard Manhole Base Section
- RD345 - Pipe to Manhole Connections
- RD356 - Manhole Covers and Frames
- RD360 - Manhole Frame Adjustment
- RD363 - Gutter Transition at Inlet
- RD364 - Concrete Inlets
- RD700 - Curb
- RD720 - Sidewalks
- RD721 - Separated Sidewalks
- RD722 - Sidewalk Joints
- RD740 - Separated Sidewalk Driveways or Alleys (Options H, I & J)
- RD745 - Curb Line Sidewalk Driveways or Alleys (Options K & L)
- RD754 - Curb Ramp and Turning Space (For Ends of Sidewalks)
- RD755 - Curb Ramp Details
- RD756 - Curb Ramp Placement Options Small Radii
- RD758 - Detectable Warning Surface Details and Placement Locations
- RD759 - Detectable Warning Surface Details and Placement Locations
- RD1010 - Inlet Protection (Type 2, 3, 6, and 7)
- RD1070 - Concrete Truck Washout

THE DALLES FIRST STREET PROJECT
THE DALLES, OREGON
WASCO COUNTY

Rev.	Comment	Date
A1	Addenda 1 - Bid Comments	11/3/25

PROJECT NUMBER

TITLE SHEET

SHEET NO.

A02

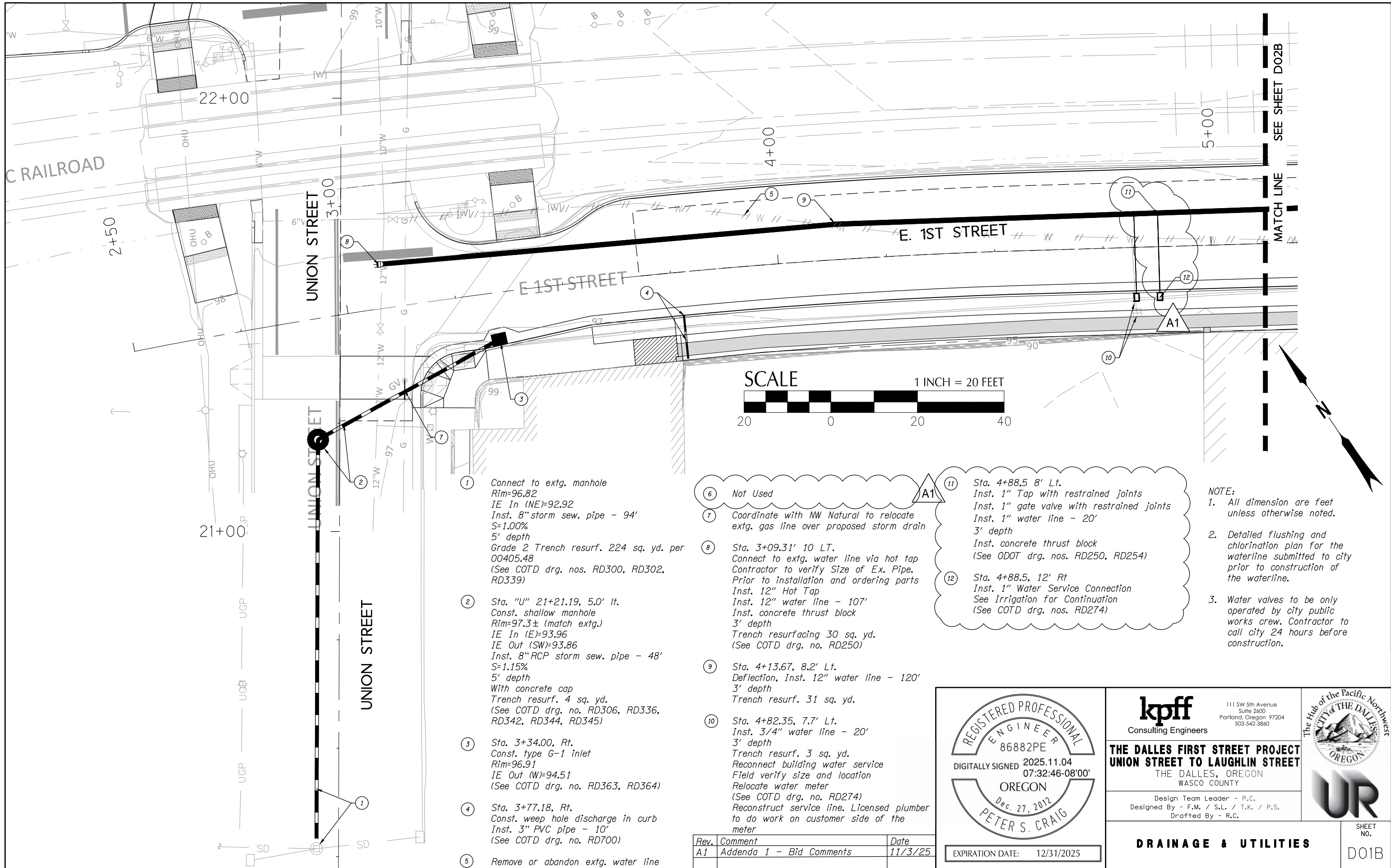

- ① Connect to extg. manhole
Rim=96.82
IE In (NE)=92.92
Inst. 8" storm sew. pipe - 94'
S=1.00%
5' depth
Grade 2 Trench resurf. 224 sq. yd. per 00405.48
(See COTD drg. nos. RD300, RD302, RD339)
- ② Sta. "U" 21+21.19, 5.0' Lt.
Const. shallow manhole
Rim=97.3± (match extg.)
IE In (E)=93.96
IE Out (SW)=93.86
Inst. 8" RCP storm sew. pipe - 48'
S=1.15%
5' depth
With concrete cap
Trench resurf. 4 sq. yd.
(See COTD drg. no. RD306, RD336, RD342, RD344, RD345)
- ③ Sta. 3+34.00, Rt.
Const. type G-1 inlet
Rim=96.91
IE Out (W)=94.51
(See COTD drg. no. RD363, RD364)
- ④ Sta. 3+77.18, Rt.
Const. weep hole discharge in curb
Inst. 3" PVC pipe - 10'
(See COTD drg. no. RD700)
- ⑤ Remove or abandon extg. water line

- ⑥ Not Used
- ⑦ Coordinate with NW Natural to relocate extg. gas line over proposed storm drain
- ⑧ Sta. 3+09.31' 10 LT.
Connect to extg. water line via hot tap
Contractor to verify Size of Ex. Pipe.
Prior to installation and ordering parts
Inst. 12" Hot Tap
Inst. 12" water line - 107'
Inst. concrete thrust block
3' depth
Trench resurfacing 30 sq. yd.
(See COTD drg. no. RD250)
- ⑨ Sta. 4+13.67, 8.2' Lt.
Deflection, Inst. 12" water line - 120'
3' depth
Trench resurf. 31 sq. yd.
- ⑩ Sta. 4+82.35, 7.7' Lt.
Inst. 3/4" water line - 20'
3' depth
Trench resurf. 3 sq. yd.
Reconnect building water service
Field verify size and location
Relocate water meter
(See COTD drg. no. RD274)
Reconstruct service line. Licensed plumber to do work on customer side of the meter

- ⑪ Sta. 4+88.5 8' Lt.
Inst. 1" Tap with restrained joints
Inst. 1" gate valve with restrained joints
Inst. 1" water line - 20'
3' depth
Inst. concrete thrust block
(See ODOT drg. nos. RD250, RD254)
- ⑫ Sta. 4+88.5, 12' Rt
Inst. 1" Water Service Connection
See Irrigation for Continuation
(See COTD drg. nos. RD274)

NOTE:

- All dimension are feet unless otherwise noted.
- Detailed flushing and chlorination plan for the waterline submitted to city prior to construction of the waterline.
- Water valves to be only operated by city public works crew. Contractor to call city 24 hours before construction.

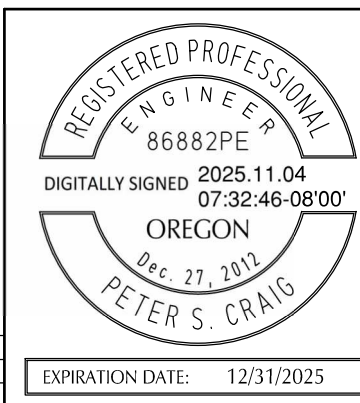
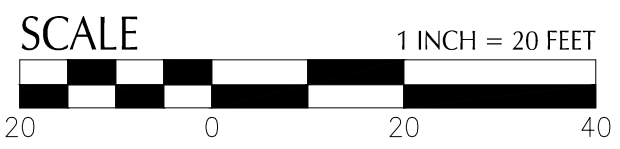

kpff
Consulting Engineers
111 SW 5th Avenue
Suite 2600
Portland, Oregon 97204
503-542-3860

**THE DALLES FIRST STREET PROJECT
UNION STREET TO LAUGHLIN STREET**
THE DALLES, OREGON
WASCO COUNTY

Design Team Leader - P.C.
Designed By - F.M. / S.L. / T.K. / P.S.
Drafted By - R.C.

The Hub of the Pacific Northwest
CITY OF THE DALLES
OREGON

SHEET NO.
D01B

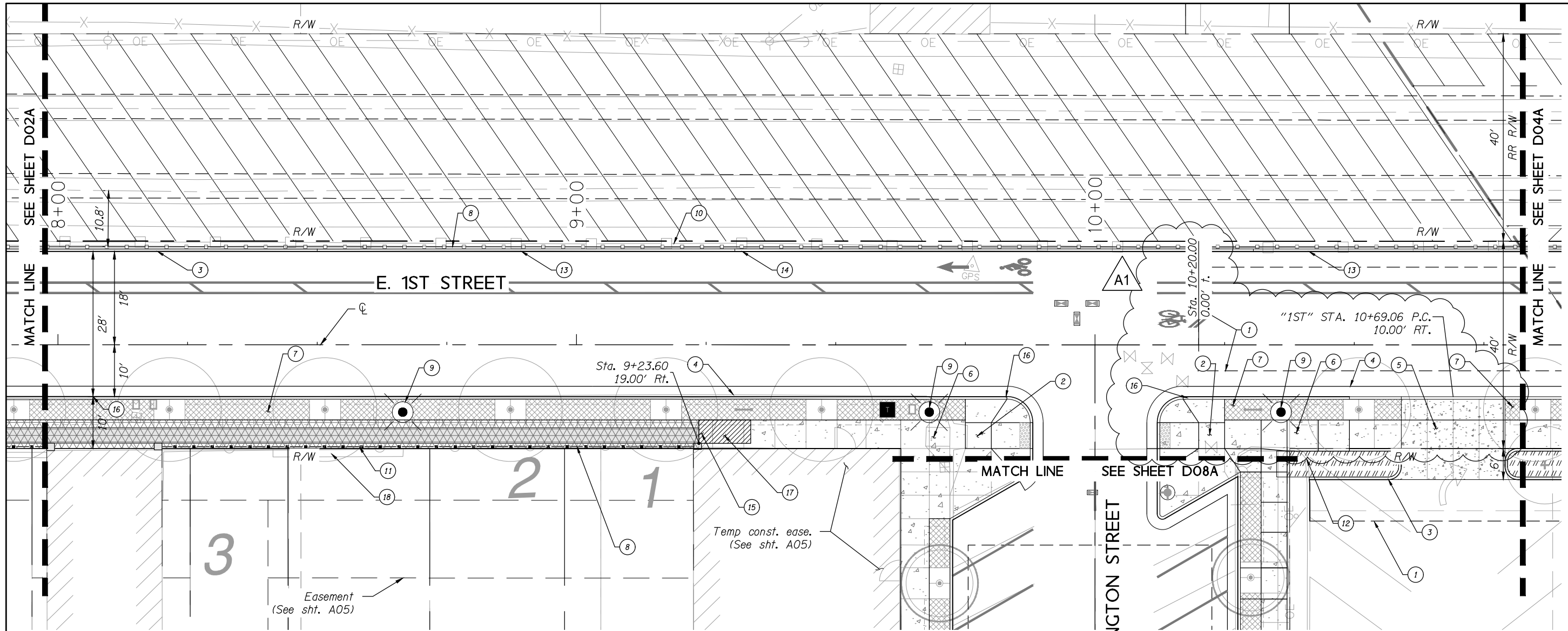

- ① Sawcut extg. pavement
- ② Const. curb ramp
(For details, see sht. BC04)
- ③ Const. standard curb
- ④ Const. curb and gutter
- ⑤ Const. Conc. dwy (commercial)
(For details, see sht. BB04)
(See COTD drg. no. RD740)
- ⑥ Remove sidewalk
Const. separated P.C. conc. sidewalk
Sidewalk scoring
(For scoring, see RB series)
(See COTD drg. no. RD721 & RD722)
- ⑦ Furnishing zone
(For details, see RB series)
- ⑧ Const. ornamental pedestrian rail
(For details, see RB series)
- ⑨ Inst. luminaire
(For locations, see RB series)
(For details, see PA series)
- ⑩ See sht. D01A, note 11
Remove extg. guardrail
- ⑪ Remove extg. railing, save black chain link
fencing, deliver to the City PW Shop - 104'
- ⑫ Remove extg. curb
- ⑬ Const. modified standard curb
Sta. 8+50 to Sta. 9+25
Sta. 10+25 to Sta. 11+75
(For details, see sht. BA01 & BA02)
- ⑭ Const. modified curb
Sta. 9+25 to Sta. 10+25
(For details and location, see sht. BA01)
- ⑮ See sht. D02A, note 14
- ⑯ Install City provided concrete stamp
- ⑰ Wall backfill at building face
(for details, see sht. BB04)
- ⑱ Protect for Historical Facade

- NOTE:
1. For horizontal geometry of curbs, see shts. BC01-BC06.
 2. Construction occurs in a known archaeological boundary. See Monitoring Plan and Treatment Plan for more information on archaeological procedures and expectations.
 3. During demolition of existing sidewalk and curb, salvage all historic stamping and metal signias and deliver to the City Public works at 1215 West First Street. Concrete panels with stamping to be delivered to the City.

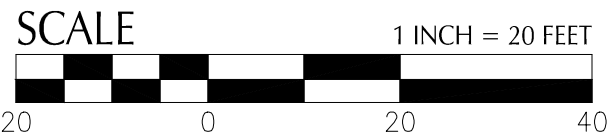

Rev.	Comment	Date
A1	Addenda 1 - Bid Comments	11/3/25

REGISTERED PROFESSIONAL
ENGINEER
86882PE
DIGITALLY SIGNED 2025.11.04
07:33:29-08'00'
OREGON
Dec. 27, 2012
PETER S. CRAIG

EXPIRATION DATE: 12/31/2025

kpff
Consulting Engineers

111 SW 5th Avenue
Suite 2600
Portland, Oregon 97204
503-542-3860

The Hub of the Pacific Northwest
CITY OF THE DALLES
OREGON

THE DALLES FIRST STREET PROJECT
UNION STREET TO LAUGHLIN STREET
THE DALLES, OREGON
WASCO COUNTY

Design Team Leader - P.C.
Designed By - F.M. / S.L. / T.K. / P.S.
Drafted By - R.C.

GENERAL CONSTRUCTION

SHEET NO.
D03A

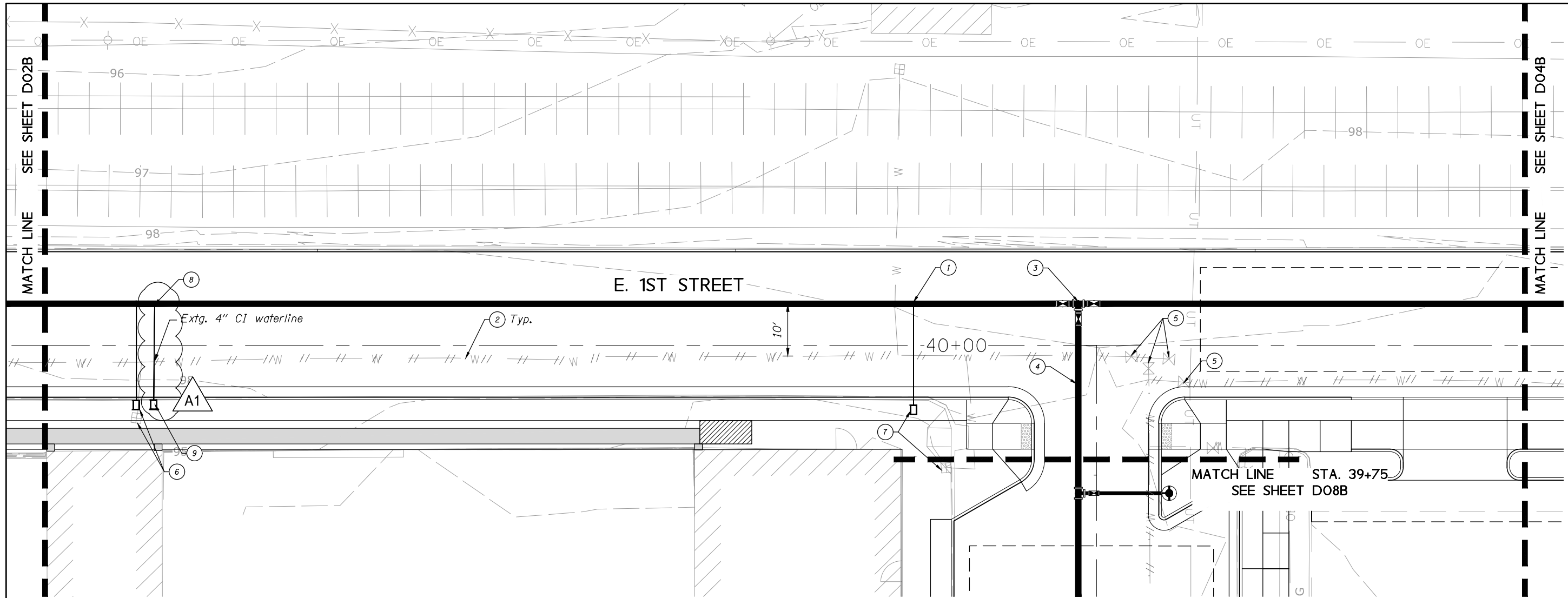

① Sta. 9+61±, 8' Lt.
Connect to extg. water service line
Field verify size and location
(See COTD drg. no. RD274)

② Remove or abandon extg. water line

③ Sta. 9+96.49, 8' Lt.
Inst. 12" tee with restrained joints
Inst. (3) 12" gate valves with restrained joints
Inst. concrete thrust block
Inst. 12" water line - 405'
3' depth
Trench resurf. 135 sq. yd.
(See COTD drg. no. RD250)

④ Inst. 12" water line - 34'
3' depth

⑤ Remove existing valve - 4

⑥ Sta. 8+15±, 14'± Rt.
Relocate water meter
Inst. 3/4" water line - 20'
3' depth
Trench resurfacing 3 sq. yd.
Field verify size and location
Reconnect building water service
(See COTD drg. no. RD274)

⑦ Sta. 9+64.76, 24' Rt.
Relocate water meter
Inst. 3/4" water line - 20'
3' depth
Trench resurfacing 3 sq. yd.
Reconnect building water service
Field verify size and location
(See COTD drg. no. RD274)

⑧ Sta. 8+18 8' Lt.
Inst. 1" Tap with restrained joints
Inst. 1" gate valve with restrained joints
Inst. 1" water line - 20'
3' depth
Inst. concrete thrust block
(See ODOT drg. nos. RD250, RD254)

⑨ Sta. 8+18, 12' Rt
Inst. 1" Water Service Connection
See Irrigation for Continuation
(See COTD drg. nos. RD274)

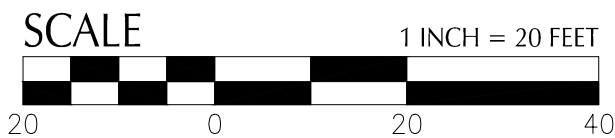

- NOTE:
- All dimension are feet unless otherwise noted.
 - Detailed flushing and chlorination plan for the waterline submitted to city prior to construction of the waterline.
 - Water valves to be only operated by city staff / personnel. Contractor to call city 24 hours before construction.

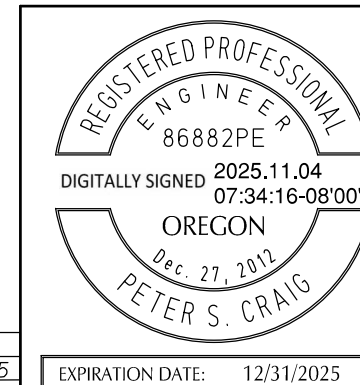

kpff
Consulting Engineers
111 SW 5th Avenue
Suite 2600
Portland, Oregon 97204
503-542-3860

THE DALLES FIRST STREET PROJECT
UNION STREET TO LAUGHLIN STREET
THE DALLES, OREGON
WASCO COUNTY

Design Team Leader - P.C.
Designed By - F.M. / S.L. / T.K. / P.S.
Drafted By - R.C.



Rev.	Comment	Date
A1	Addenda 1 - Bid Comments	11/3/25

DRAINAGE & UTILITIES

SHEET NO. D03B

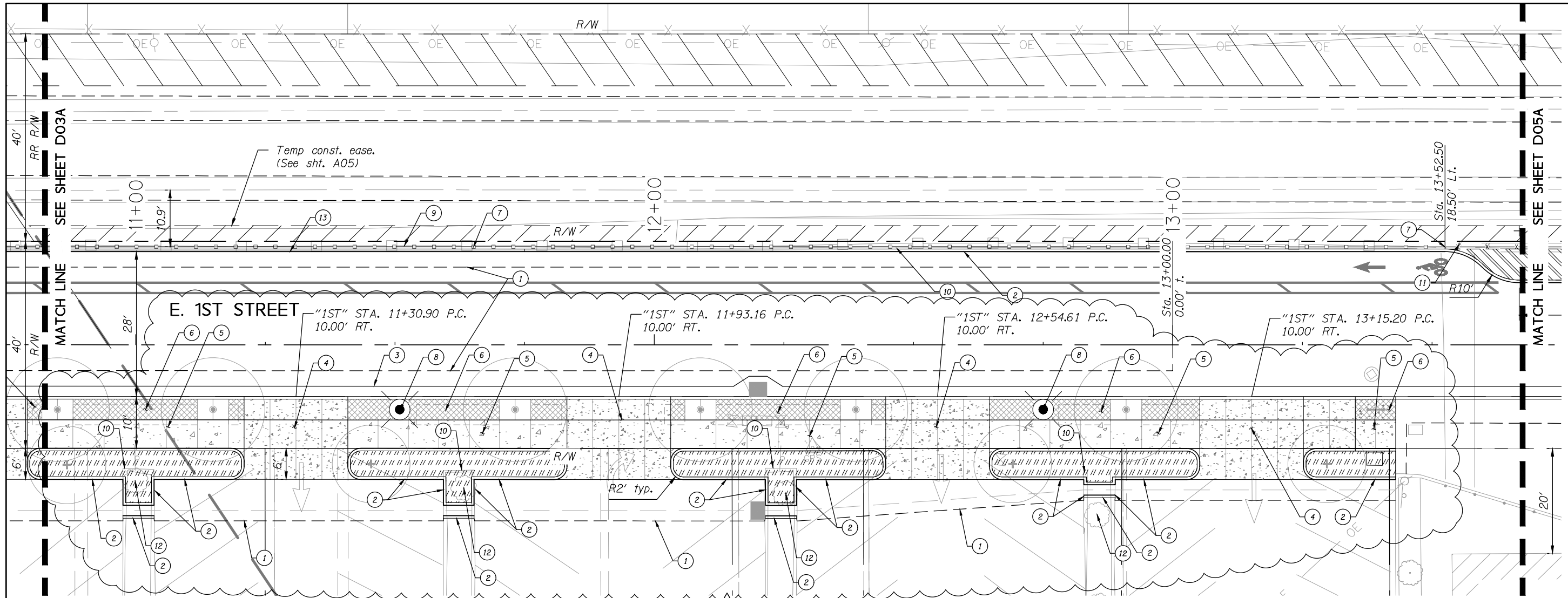

- ① Sawcut extg. pavement
- ② Const. standard curb
- ③ Const. curb and gutter, modified
(For details, see sht. BB04)
- ④ Const. Conc. dwy. (commercial)
(For details, see sht. BB04)
(See COTD drg. no. RD740)
- ⑤ Const. separated P.C. conc. sidewalk
Sidewalk scoring
(For scoring, see RB series)
(See COTD drg. no. RD721 & RD722)
- ⑥ Furnishing zone
(For details, see RB series)
- ⑦ Const. ornamental pedestrian rail
(For details, see RB series)
- ⑧ Inst. luminaire
(For locations, see RB series)
(For details, see PA series)
- ⑨ See sht. D01A, note 11
Remove extg. guardrail
- ⑩ Remove extg. curb
- ⑪ Remove extg. bollard
- ⑫ Tree
- ⑬ Sheet sht. D04A, note 13
Const. modified standard curb

A1

NOTE:

1. For horizontal geometry of curbs, see shts. BC01-BC06.
2. Construction occurs in a known archaeological boundary. See Monitoring Plan and Treatment Plan for more information on archaeological procedures and expectations.
3. During demolition of existing sidewalk and curb, salvage all historic stamping and metal insignias and deliver to the City Public works at 1215 West First Street. Concrete panels with stamping to be delivered to the City.

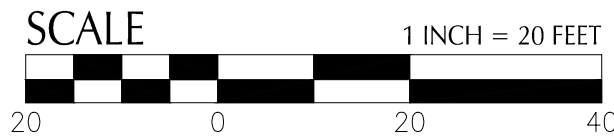

Rev.	Comment	Date
A1	Addenda 1 - Bid Comments	11/3/25

REGISTERED PROFESSIONAL
ENGINEER
86882PE
DIGITALLY SIGNED 2025.11.04
07:35:09-08'00'
OREGON
Dec. 27, 2012
PETER S. CRAIG

EXPIRATION DATE: 12/31/2025

kpff
Consulting Engineers

111 SW 5th Avenue
Suite 2600
Portland, Oregon 97204
503-542-3860

**THE DALLES FIRST STREET PROJECT
UNION STREET TO LAUGHLIN STREET**
THE DALLES, OREGON
WASCO COUNTY

Design Team Leader - P.C.
Designed By - F.M. / S.L. / T.K. / P.S.
Drafted By - R.C.

GENERAL CONSTRUCTION

SHEET NO.
D04A

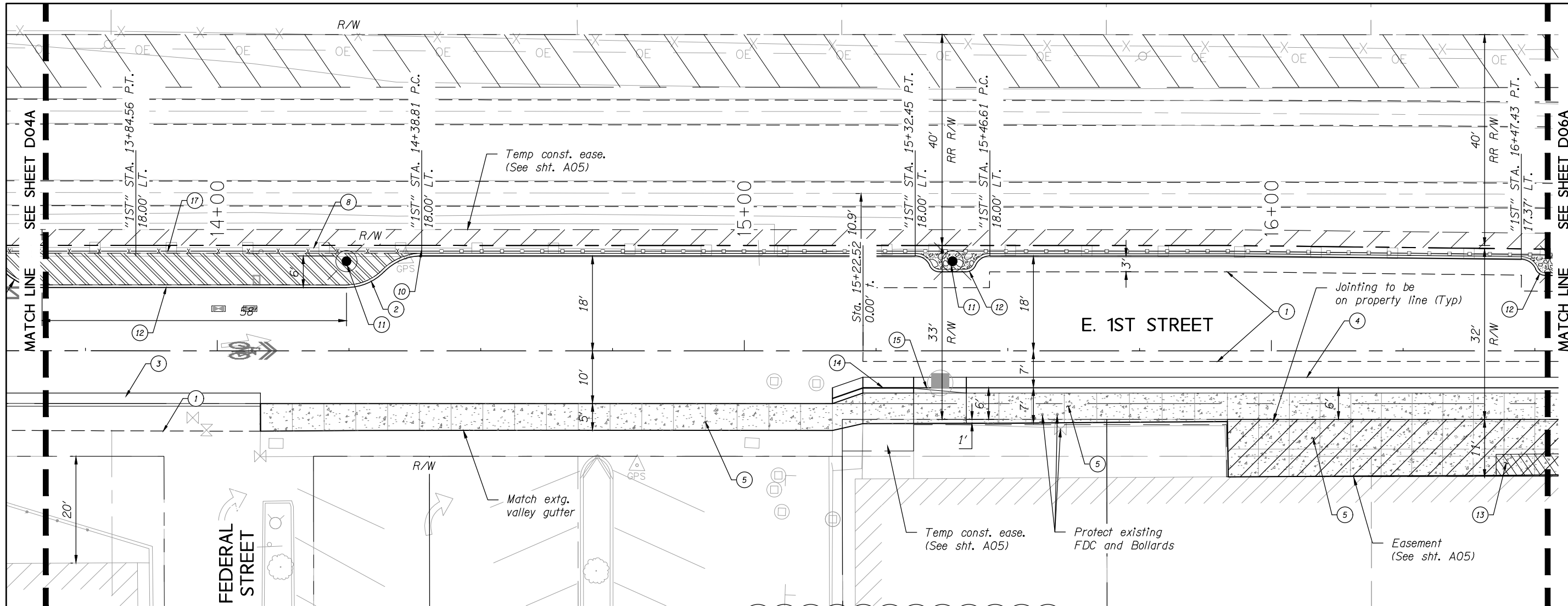

- ① Sawcut extg. pavement
- ② Const. standard curb
- ③ Const. curb and gutter
- ④ Const. low profile mountable curb and gutter (For details, see sht. BB04)
- ⑤ Const. 8 inch concrete surfacing (For details and scoring, see sht. BB04 and RB series)
- ⑥ Remove asphalt sidewalk
Const. curb line P.C. conc. sidewalk
Sidewalk scoring (For scoring, see RB series) (See COTD drg. no. RD720 & RD722)
- ⑦ Const. curb ramp (For details, see sht. BC05)
- ⑧ See sht. D01A, note 11
Remove extg. guardrail
- ⑨ Furnishing zone (For details, see RB series)
- ⑩ Const. ornamental pedestrian rail (For details, see RB series)
- ⑪ Inst. luminaire (For locations, see RB series) (For details, see PA series)

- ⑫ Const. curb extension (For details, see sht. BB04)
- ⑬ Remove extg. wood stairs
Const. wood stairs in kind per applicable standards - See Detail 1 - Provide Shop Drawing for approval prior to construction.
- ⑭ Const. curb and gutter, modified (For details, see sht. BB04)
- ⑮ Curb type transition
- ⑯ Light Pole to be installed per adjacent Federal Street Project
- ⑰ Install 6' Wrought Iron Fencing with Mesh Panels (Sta. 13+52.50 to 14.38.8) (For details, see RB series)

NOTE:

- For horizontal geometry of curbs, see shts. BC01-BC06.
- Construction occurs in a known archaeological boundary. See Monitoring Plan and Treatment Plan for more information on archaeological procedures and expectations.
- During demolition of existing sidewalk and curb, salvage all historic stamping and metal insignias and deliver to the City Public works at 1215 West First Street. Concrete panels with stamping to be delivered to the City.

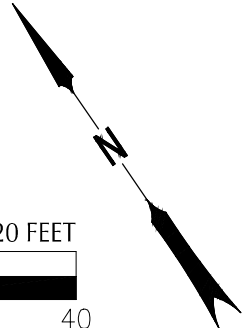
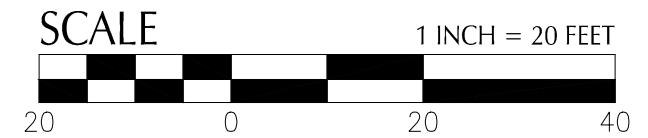

REGISTERED PROFESSIONAL ENGINEER
86882PE
DIGITALLY SIGNED 2025.11.04 17:39:37-08'00'
OREGON
Dec. 27, 2012
PETER S. CRAIG

EXPIRATION DATE: 12/31/2025

kpff
Consulting Engineers
111 SW 5th Avenue
Suite 2600
Portland, Oregon 97204
503-542-3860

**THE DALLES FIRST STREET PROJECT
UNION STREET TO LAUGHLIN STREET**
THE DALLES, OREGON
WASCO COUNTY

Design Team Leader - P.C.
Designed By - F.M. / S.L. / T.K. / P.S.
Drafted By - R.C.

The Hub of the Pacific Northwest
CITY OF THE DALLES
OREGON

Rev.	Comment	Date
A1	Addenda 1 - Bid Comments	11/3/25

GENERAL CONSTRUCTION

SHEET NO. **D05A**

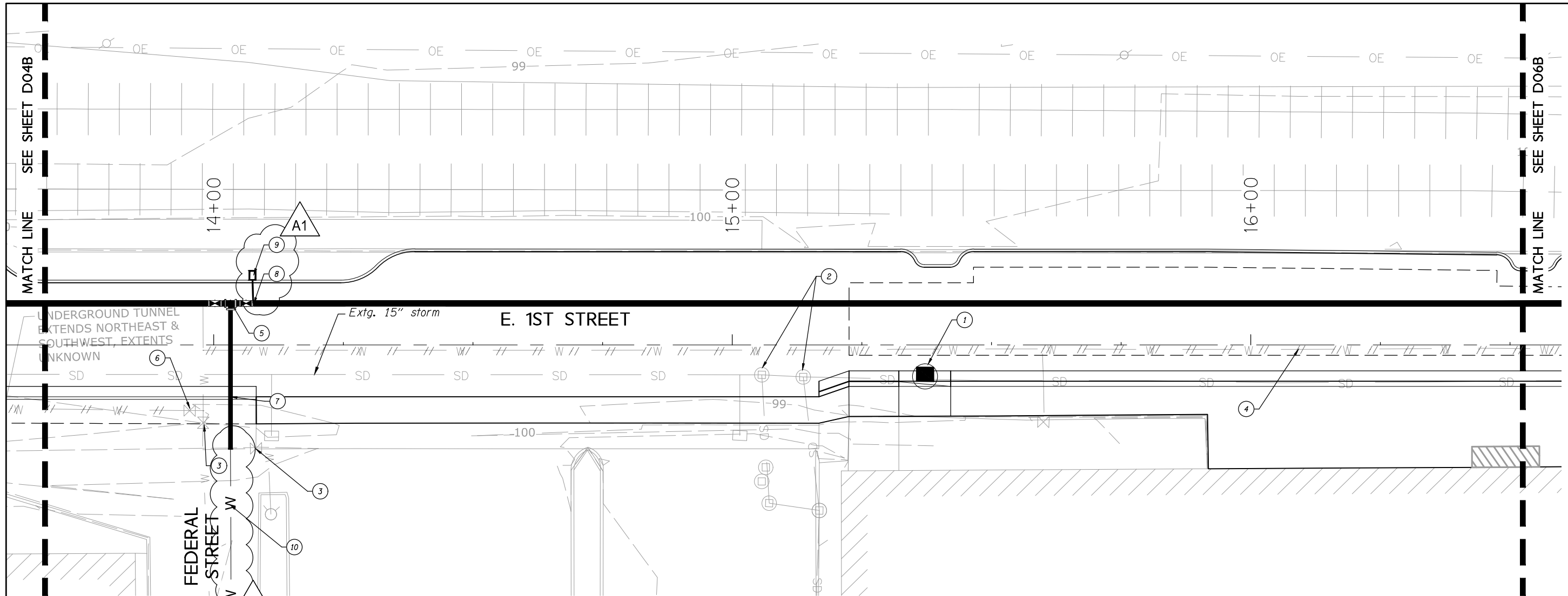

- ① Sta. 15+37.19, Rt. Const. manhole with inlet Over extg. storm sew. (See ODOT drg. no. RD348) (See COTD drg. no. RD344, RD364)
- ② Minor adjust manhole - 2
- ③ Adjust water valve
- ④ Remove or abandon extg. water line
- ⑤ Sta. 14+03.25, 8' Lt. Inst. 12"x8" tee with restrained joints. Inst. (2) 12" gate valves with restrained joints Inst. concrete thrust block Inst. 12" water line - 326' 3' depth Trench resurf. 108 sq. yd. (See COTD drg. no. RD250)
- ⑥ Remove extg. valve
- ⑦ Inst. 8" water line - 30' 3' depth Trench resurfacing 9 sq. yd. Connect to extg. water line at valve

- ⑧ Sta. 14+07.6, 8' Lt. Inst. 1.5" Tap with restrained joints Inst. 1.5" gate valve with restrained joints Inst. 1.5" water line - 5' 3' depth Inst. concrete thrust block (See ODOT drg. nos. RD250, RD254)
- ⑨ Sta. 14+07.6, 13' Lt Inst. 1.5" Water Service Connection See Irrigation for Continuation (See COTD drg. nos. RD275)
- ⑩ Proposed City installed 8" waterline

- NOTE:
1. All dimension are feet unless otherwise noted.
 2. Detailed flushing and chlorination plan for the waterline submitted to city prior to construction of the waterline.
 3. Water valves to be only operated by city staff / personnel. Contractor to call city 24 hours before construction.

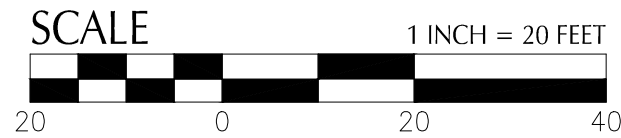
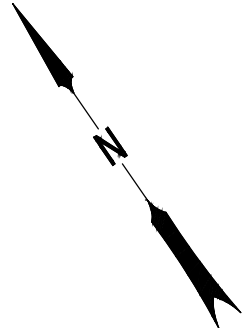

Rev.	Comment	Date
A1	Addenda 1 - Bid Comments	11/3/25

REGISTERED PROFESSIONAL
ENGINEER
86882PE
DIGITALLY SIGNED 2025.11.04 07:35:56-08'00'
OREGON
Dec. 27, 2012
PETER S. CRAIG

EXPIRATION DATE: 12/31/2025

kpff
Consulting Engineers
111 SW 5th Avenue
Suite 2600
Portland, Oregon 97204
503-542-3860

**THE DALLES FIRST STREET PROJECT
UNION STREET TO LAUGHLIN STREET**
THE DALLES, OREGON
WASCO COUNTY

Design Team Leader - P.C.
Designed By - F.M. / S.L. / T.K. / P.S.
Drafted By - R.C.

The Hub of the Pacific Northwest
CITY OF THE DALLES
OREGON

DRAINAGE & UTILITIES

SHEET NO.
D05B

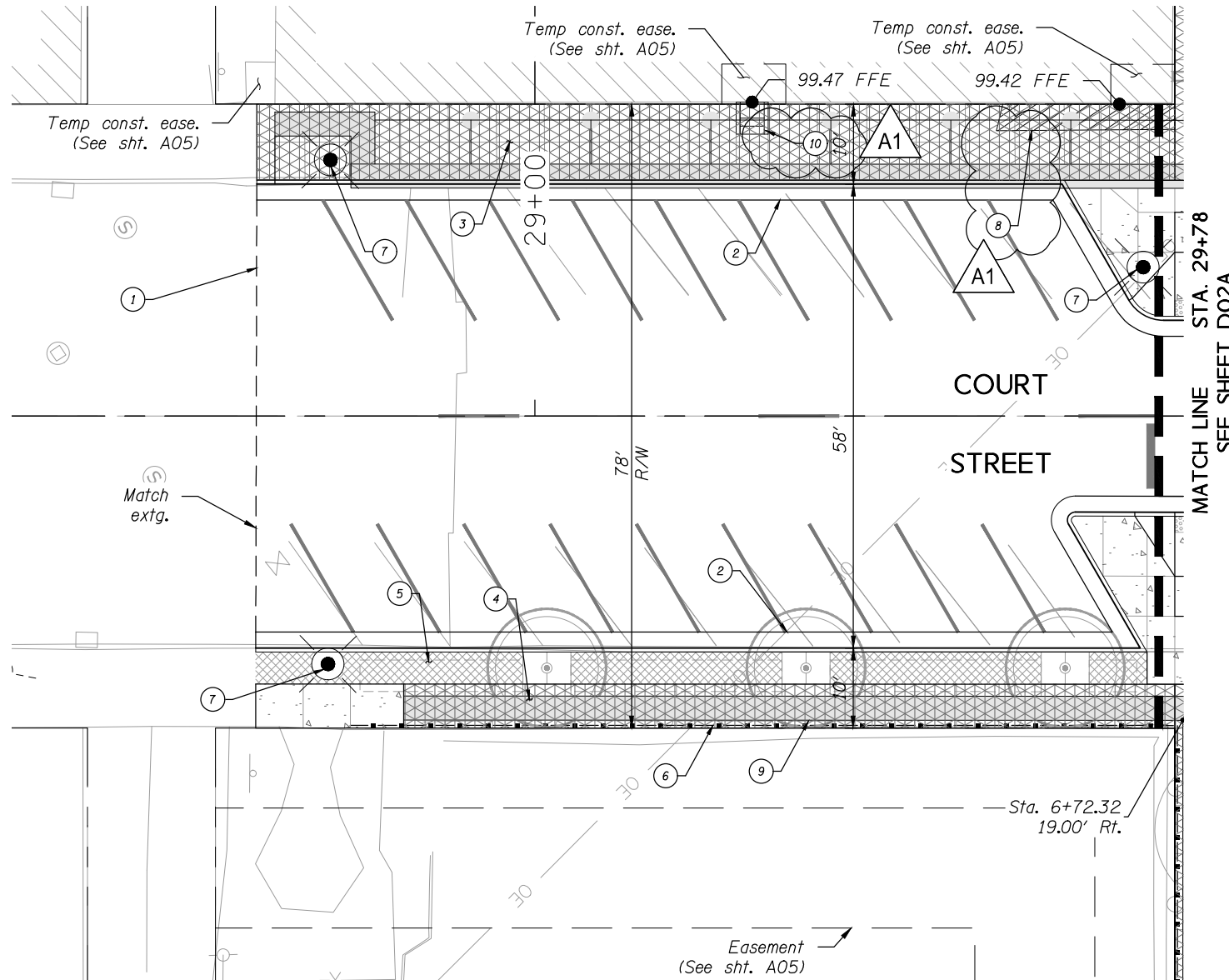

- ① Sawcut extg. pavement
- ② Const. curb and gutter
- ③ Sta. 28+67.86 to 6+04.32, Lt.
Remove sidewalk
Remove extg. basalt wall
Const. retaining wall
Const. reinforced conc. sidewalk
Sidewalk scoring
(For details, see GB series)
(For details, see RB series)
(See COTG drg. no. RD720 & RD722)
- ④ Sta. 28+65.18 to 6+73.32, Rt.
Remove sidewalk
Const. reinforced conc. sidewalk
(For details, see GB series)
(For scoring, see RB series)
(See COTG drg. no. RD722)
- ⑤ Furnishing zone
(For details, see RB series)

- ⑥ Const. ornamental pedestrian rail
(For details, see RB series)
- ⑦ Inst. luminaire
(For locations, see RB series)
(For details, see PA series)

⑧ Remove extg. wood ramp
Const. wood ramp in kind and to current standards - See Detail 1 - Provide shop drawing for approval prior to construction

⑨ Remove extg. railing, save black chain link fencing, deliver to the City PW Shop. - 95'

⑩ Remove extg. wood stairs.
Const. stairs in kind and to current standards. See Detail 2 - Provide shop drawing for approval prior to construction

NOTE:

1. For horizontal geometry of curbs, see shts. BC01-BC06.
2. Construction occurs in a known archaeological boundary. See Monitoring Plan and Treatment Plan for more information on archaeological procedures and expectations.
3. During demolition of existing sidewalk and curb, salvage all historic stamping and metal insignias and deliver to the City Public works at 1215 West First Street. Concrete panels with stamping to be delivered to the City.
4. Access to existing buildings must be maintained at all times. Contractor to coordinate schedule of work with the City, Owner, and Engineer.



Detail 1:
Ramp at the Baldwin (9/2024 - Google.com)



Detail 2:
Stairs at the Baldwin (9/2024 - Google.com)

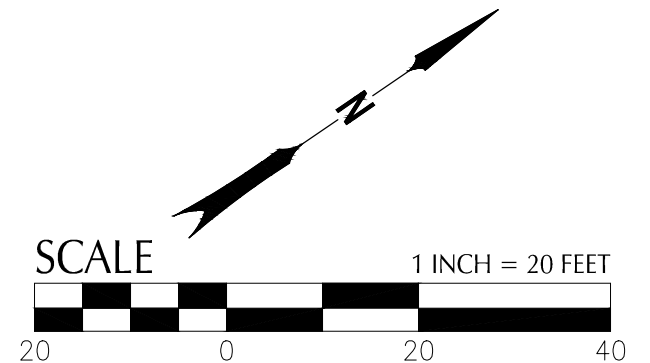

REGISTERED PROFESSIONAL
ENGINEER
86882PE
DIGITALLY SIGNED 2025.11.04
17:39:01-08'00'
OREGON
Dec. 27, 2012
PETER S. CRAIG

EXPIRATION DATE: 12/31/2025

kpff
Consulting Engineers
111 SW 5th Avenue
Suite 2600
Portland, Oregon 97204
503-542-3860

**THE DALLES FIRST STREET PROJECT
UNION STREET TO LAUGHLIN STREET**
THE DALLES, OREGON
WASCO COUNTY

Design Team Leader - P.C.
Designed By - F.M. / S.L. / T.K. / P.S.
Drafted By - R.C.

GENERAL CONSTRUCTION

The Hub of the Pacific Northwest
CITY OF THE DALLES
OREGON

UR

SHEET NO.
D07A

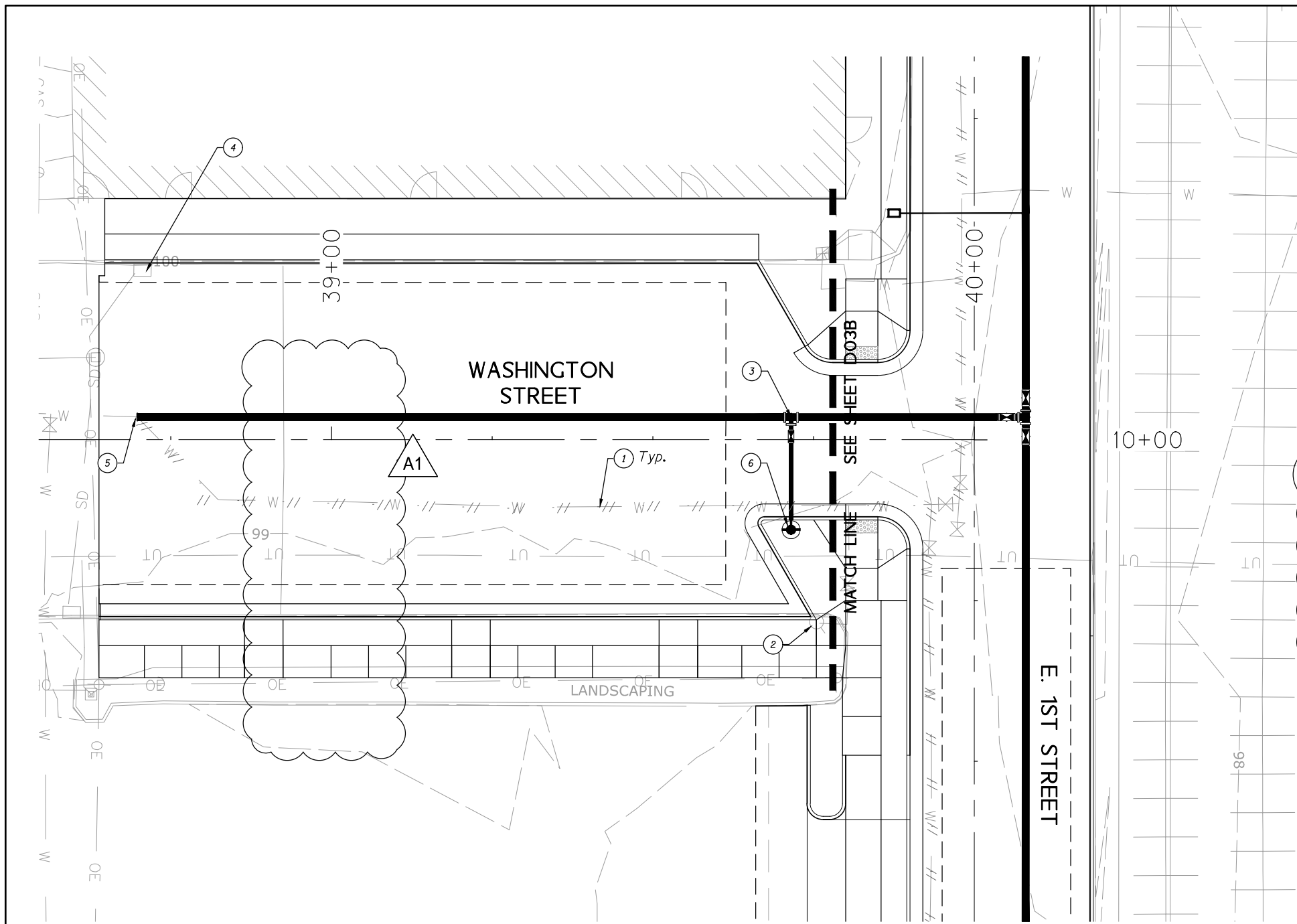

- ① Remove or abandon extg. water line
- ② Remove extg. hydrant assembly
- ③ Sta. 39+71.50, 3.5' Lt.
Inst. 12x12x6 tee with restrained joints
Inst. 6" gate valve with restrained joints
Inst. 6" water line - 18'
3' depth
Inst. concrete thrust block
(See ODOT drg. nos. RD250, RD254)

- ④ Remove extg. catch basin
Plug pipe
- ⑤ Sta. 38+69.80, 3.5' Lt.
Inst. 12" water line - 102'
3' depth
Trench resurf. 34 sq. yd.
Connect to extg. 8" water line

- ⑥ Sta. 39+71.50, 14.0' Rt
Inst. hydrant assembly

⑦ Not Used

⑧ Not Used

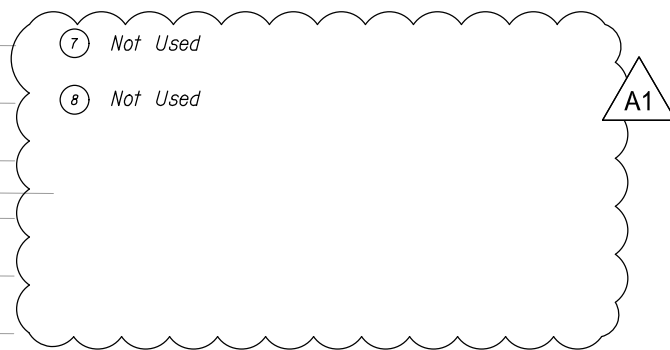

- NOTE:**
1. All dimension are feet unless otherwise noted.
 2. Detailed flushing and chlorination plan for the waterline submitted to city prior to construction of the waterline.
 3. water valves to be only operated by city staff / personnel. Contractor to call city 24 hours before construction.

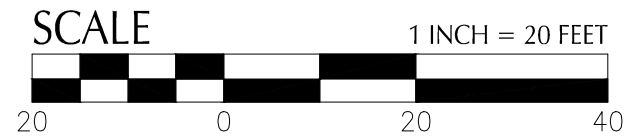
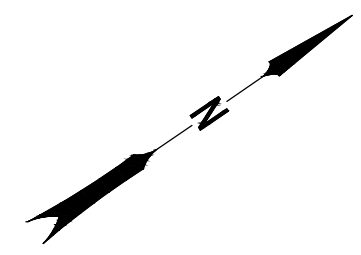

Rev.	Comment	Date
A1	Addenda 1 - Bid Comments	11/3/25

REGISTERED PROFESSIONAL ENGINEER
 86882PE
 DIGITALLY SIGNED 2025.11.04 07:36:50-08'00'
 OREGON
 Dec. 27, 2012
PETER S. CRAIG

EXPIRATION DATE: 12/31/2025

kpff
 Consulting Engineers
 111 SW 5th Avenue
 Suite 2600
 Portland, Oregon 97204
 503-542-3860

THE DALLES FIRST STREET PROJECT
UNION STREET TO LAUGHLIN STREET
 THE DALLES, OREGON
 WASCO COUNTY

Design Team Leader - P.C.
 Designed By - F.M. / S.L. / T.K. / P.S.
 Drafted By - R.C.

The Hub of the Pacific Northwest
CITY OF THE DALLES
 OREGON

DRAINAGE & UTILITIES

SHEET NO.
D08B

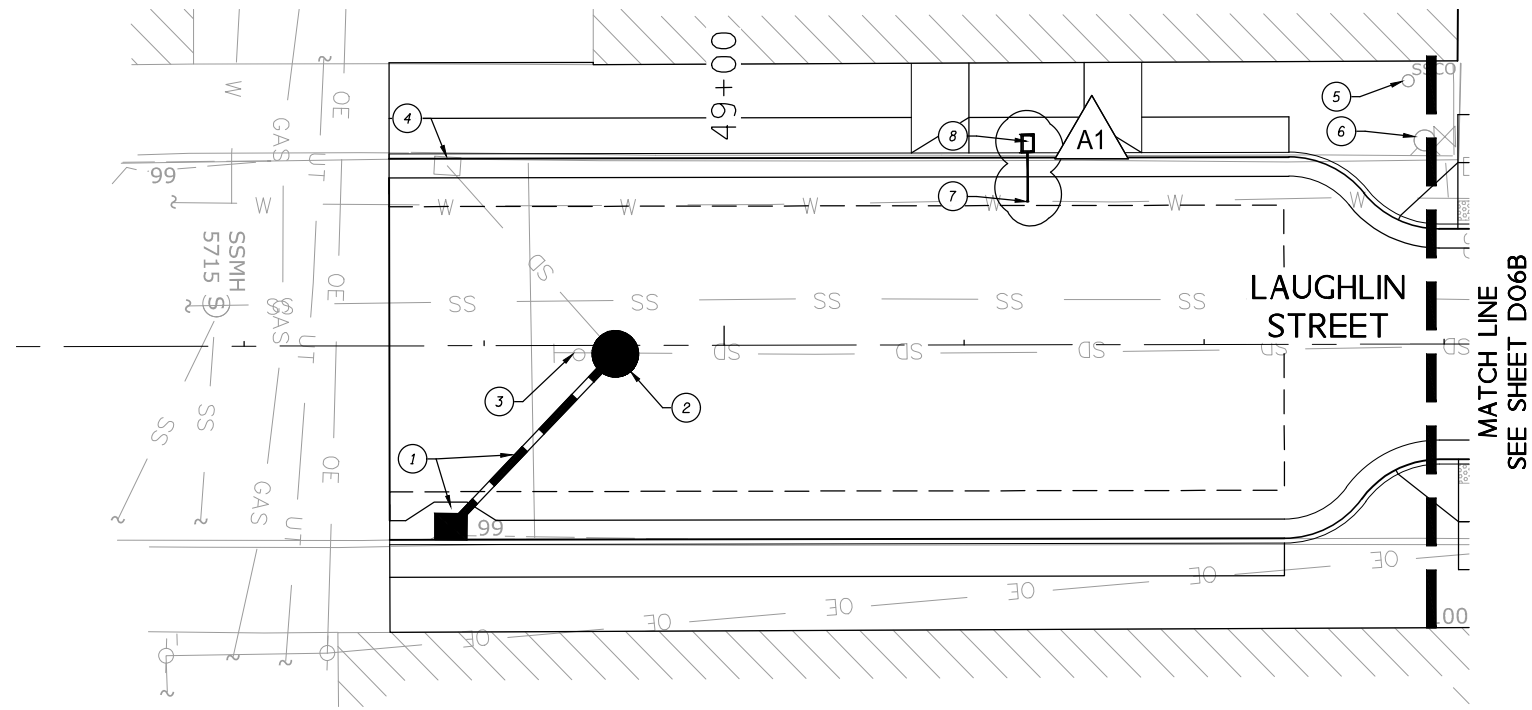

- ① Sta. 48+71.50, Rt.
Const. type G-1 inlet
Rim = 99.00
IE Out (SE) = 96.00
Inst. 8" storm sew. pipe - 25'
S=5.89%
4' depth
Trench resurf. 7 sq. yd.
(See COTD drg. no. RD363, RD364)
- ② Sta. 48+88.68, 0.88' Rt.
Const. manhole
Over extg. storm sew.
Rim = 99.53
IE 8" In (S) = 94.55
IE 8" In (W) = 94.55
IE 12" In (SW) = 94.55
IE 12" Out (NE) = 94.55
(See COTD drg. no. RD335)
- ③ Remove cleanout
- ④ Adjust existing inlet
- ⑤ Adjust cleanout
- ⑥ Protect existing hydrant and adjust to finished grade.

- ⑦ Sta. 49+31.8 14.5' Lt.
Inst. 1" Tap with restrained joints
Inst. 1" gate valve with restrained joints
Inst. 1" water line - 7'
3' depth
Inst. concrete thrust block
(See ODOT drg. nos. RD250, RD254)
 - ⑧ Sta. 49+31.8, 21' Lt.
Inst. 1" Water Service Connection
See Irrigation for Continuation
(See COTD drg. nos. RD274)

- NOTE:**
1. All dimension are feet unless otherwise noted.
 2. Detailed flushing and chlorination plan for the waterline submitted to city prior to construction of the waterline.
 3. water valves to be only operated by city staff / personnel. Contractor to call city 24 hours before construction.

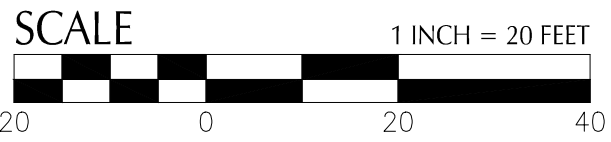

Rev.	Comment	Date
A1	Addenda 1 - Bid Comments	11/3/25

REGISTERED PROFESSIONAL ENGINEER
86882PE
DIGITALLY SIGNED 2025.11.04 07:37:31-08'00'
OREGON
Dec. 27, 2012
PETER S. CRAIG

EXPIRATION DATE: 12/31/2025

kpff
Consulting Engineers
111 SW 5th Avenue
Suite 2600
Portland, Oregon 97204
503-542-3860









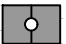
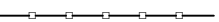
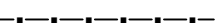

**THE DALLES FIRST STREET PROJECT
UNION STREET TO LAUGHLIN STREET**
THE DALLES, OREGON
WASCO COUNTY

Design Team Leader - P.C.
Designed By - F.M. / S.L. / T.K. / P.S.
Drafted By - R.C.

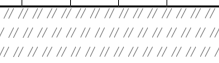
The Hub of the Pacific Northwest
CITY OF THE DALLES
OREGON

UR

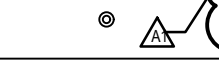
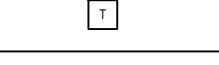
SHEET NO.
D09B

STREETSCAPE MATERIALS SCHEDULE				
Symbol	Qty	Item	Remarks	Specs
	31 ea.	Tree Grate	See "Tree Well Layout Table".	01040
	1,370 ft.	Ornamental Pedestrian Rail Type 1		01050
	486 ft.	Ornamental Pedestrian Rail Type 2		01050
	87 ft.	Ornamental Pedestrian Rail Type 3	Similar to Ornamental Pedestrian Rail Type 1.	01050
	3,700 sq. ft.	Unit Pavers	Variable color pattern according to detail on sheet RD04.	00760
	n/a	Concrete Score Joints	Score joints not indicated at curb ramp locations. Score pattern does not prescribe joint type such as contraction or expansion. Refer to Civil sheets for grade breaks and joint placement at ramps and joint types at sidewalks and crossings.	00756 / 00759
	10 cu. yd.	Cinder Mulch	Provide cinder mulch at open planting area in parking lot to match existing condition.	01040
	12 cu. yd.	Ballast Mulch	Provide at tree wells along Laughlin Street and at tree grates.	01040
	3,109 sq. ft. / 389 ea.	Tree Soil Cells	Station work point indicated does not include excavation lines or areas of backfill on sides of soil cells. Coordinate all soil cells with existing and proposed utilities. Provide shop drawing horizontal layout and details of soil cells.	01040
	45 ft.	Paver Edge Restraint	Provide at tree well edges along Laughlin St.	00760
	4 ea.	Bollard		01095
	3 ea.	Litter Receptacle	Agency-furnished, Contractor installed. Contractor shall provide and install mounting hardware and concrete pad, as required.	n/a
	8 ea.	Bicycle Rack	Agency-furnished, Contractor installed bicycle rack. Contractor shall provide and install concrete footing and fasteners.	n/a
	431 sq. ft.	Plantings (Shrubs and Groundcovers)	Agency-furnished, Contractor installed plants. Contractor shall provide and install planting soil mix and mulch.	01040

TREE WELL LAYOUT TABLE				
Key	Description	Alignment	Station	Offset
T1	Tree Well WP / Tree (ULJF)	1ST	3+81.45	12.50' Rt.
T2	Tree Well WP / Tree (ULJF)	1ST	4+09.73	12.50' Rt.
T3	Tree Well WP / Tree (ULJF)	1ST	4+40.03	12.50' Rt.
T4	Tree Well WP / Tree (ULJF)	1ST	4+70.21	12.50' Rt.
T5	Tree Well WP / Tree (ULJF)	1ST	5+06.55	12.50' Rt.
T6	Tree Well WP / Tree (ULJF)	1ST	5+36.92	12.50' Rt.
T7	Tree Well WP / Tree (ULJF)	1ST	6+86.01	12.50' Rt.
T8	Tree Well WP / Tree (ULJF)	1ST	7+16.01	12.50' Rt.
T9	Tree Well WP / Tree (ULJF)	1ST	7+46.01	12.50' Rt.
T10	Tree Well WP / Tree (ULJF)	1ST	7+91.48	12.50' Rt.
T11	Tree Well WP / Tree (ULJF)	1ST	8+21.48	12.50' Rt.
T12	Tree Well WP / Tree (ULJF)	1ST	8+51.48	12.50' Rt.
T13	Tree Well WP / Tree (ULJF)	1ST	8+87.26	12.50' Rt.
T14	Tree Well WP / Tree (ULJF)	1ST	9+17.26	12.50' Rt.
T15	Tree Well WP / Tree (ULJF)	1ST	9+47.26	12.50' Rt.
T16	Tree Well WP / Tree (ULJF)	1ST	10+50.86	12.50' Rt.
T17	Tree Well WP / Tree (ULJF)	1ST	10+84.90	12.50' Rt.
T18	Tree Well WP / Tree (ULJF)	1ST	11+14.90	12.50' Rt.
T19	Tree Well WP / Tree (ULJF)	1ST	11+73.16	12.50' Rt.
T20	Tree Well WP / Tree (ULJF)	1ST	12+08.88	12.50' Rt.
T21	Tree Well WP / Tree (ULJF)	1ST	12+38.88	12.50' Rt.
T22	Tree Well WP / Tree (ULJF)	1ST	12+91.00	12.50' Rt.

TREE WELL LAYOUT TABLE				
Key	Description	Alignment	Station	Offset
T23	Tree Well WP / Tree (MAAM)	C	29+01.51	31.50' Rt.
T24	Tree Well WP / Tree (MAAM)	C	29+33.91	31.50' Rt.
T25	Tree Well WP / Tree (MAAM)	C	29+66.31	31.50' Rt.
T26	Tree Well WP / Tree (MAAM)	W	38+89.48	29.98' Lt.
T27	Tree Well WP / Tree (MAAM)	W	39+21.73	29.97' Lt.
T28	Tree Well WP / Tree (MAAM)	W	39+53.98	29.97' Lt.
T29	Tree Well WP / Tree (MAAM)	W	38+92.34	30.02' Rt.
T30	Tree Well WP / Tree (MAAM)	W	39+23.72	30.02' Rt.
T31	Tree Well WP / Tree (MAAM)	W	39+55.10	30.03' Rt.
T32	Tree Well WP / Tree (MAAM)	L	48+82.93	21.85' Lt.
T33	Tree Well WP / Tree (MAAM)	L	49+12.93	21.85' Lt.
T34	Tree Well WP / Tree (MAAM)	L	49+51.20	21.86' Lt.
T35	Tree Well WP / Tree (MAAM)	L	48+82.95	22.4' Rt.
T36	Tree Well WP / Tree (MAAM)	L	49+12.75	22.40' Rt.
T37	Tree Well WP / Tree (MAAM)	L	49+42.93	22.40' Rt.

TREE SCHEDULE						
ID	Qty	Botanical Name	Common Name	Size & Type	Spacing	Remarks
ULJF	22	<i>Ulmus propinqua</i> 'JFS-Bieberich'	Emerald Sunshine Elm	2" cal.; B&B	As shown	6' ht. min branching
MAAM	15	<i>Maackia amurensis</i>	Amur Maackia	2" cal.; B&B	As shown	6' ht. min branching
LIST	4	<i>Liquidambar styraciflua</i> 'Rotundiloba'	Fruitless Sweetgum	2" cal.; B&B	As shown	6' ht. min branching

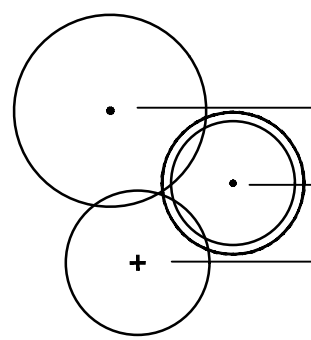

STREETSCAPE SITE NOTES

- Station points provided in RB series sheets relate to specific streetscape element layout work points. Refer to RD series sheets for layout work points of the specific streetscape details indicated.
- Verify all dimensions and project layout prior to any construction or installation of materials. If layout conflicts arise, contact the Engineer before continuing.
- See RB series sheets for concrete score joint layout and detail on sheet RD04 for construction and general layout information.

Rev.	Comment	Date
A1	Addenda 1 - Bid Comments	11/4/25

REGISTERED
 242
F. Michael Faha
 F. Michael Faha
 OREGON
 10/31/1988
 EXP. 10/31/2026
 LANDSCAPE ARCHITECT

GREEN WORKS
LANDSCAPE ARCHITECTURE • ENVIRONMENTAL DESIGN
 110 SE Main St., Suite 100, Portland, OR 97214
 PH: 503.222.8812
 Email: info@greenworkspp.com



**THE DALLES FIRST STREET PROJECT
 UNION STREET TO MADISON STREET**
 THE DALLES, OREGON
 WASCO COUNTY

Design Team Leader - P.C.
 Designed By - W.S.
 Drafted By - W.S. / C.W.

**STREETSCAPE SITE
 LEGEND AND NOTES**

SHEET NO.
RA01

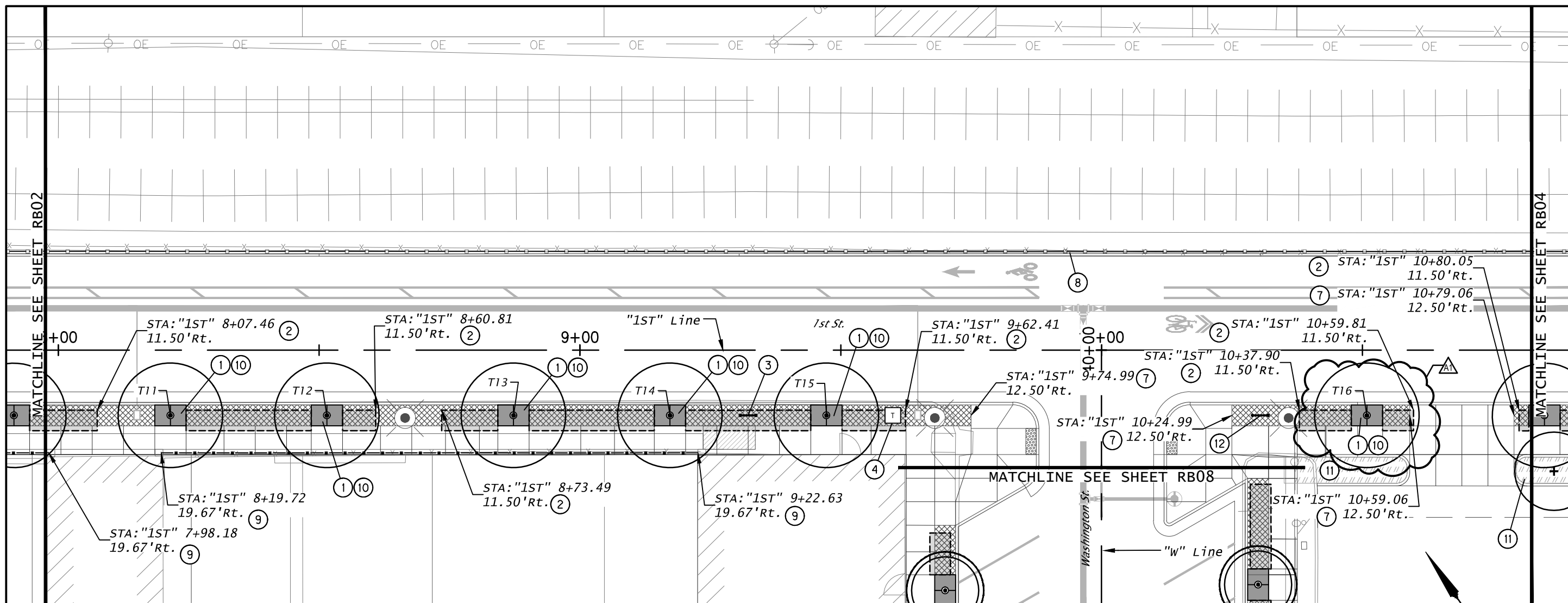

CONSTRUCTION NOTES

- ① Const. tree well and tree grate
(For details, see shts. RD01 and RD02)
(For layout table, see sht. RA01)
- ② Const. tree soil cells
(For details, see sht. RD01)
- ③ Sta. "1ST" 9+32.26, 12.50' Rt.
Const. Agency furnished, Contractor installed
bicycle rack
(For details, see sht. RD04)
- ④ Sta. "1ST" 9+59.97, 12.50' Rt.
Const. Agency furnished, Contractor installed
litter receptacle
(For details, see sht. RD04)
- ⑤ Not in use.
- ⑥ Not in use.
- ⑦ Const. unit pavers
(For details, see sht. RD04)
- ⑧ Const. ornamental pedestrian rail type 1
(For details, see sht. RD03)
- ⑨ Const. ornamental pedestrian rail type 2
(For details, see sht. RD03)
- ⑩ Plant deciduous tree at tree grate
(For details, see sht. RD05)
- ⑪ Install cinder mulch
(For details, see sht. RD05)
- ⑫ Sta. "1ST" 10+30.43, 12.50' Rt.
Const. Agency furnished, Contractor installed
bicycle rack
(For details, see sht. RD04)

LEGEND

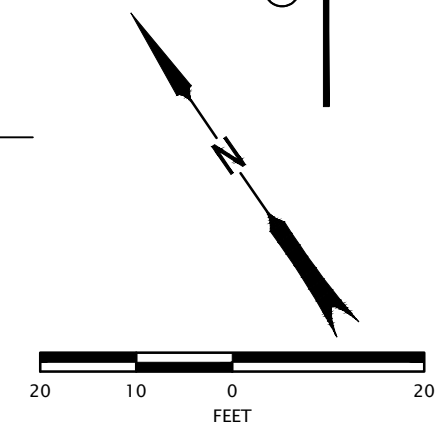
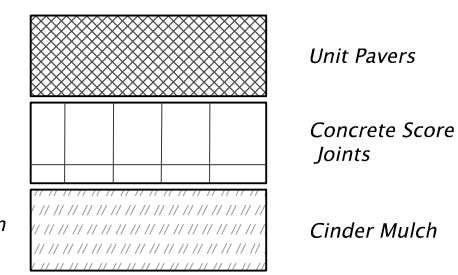
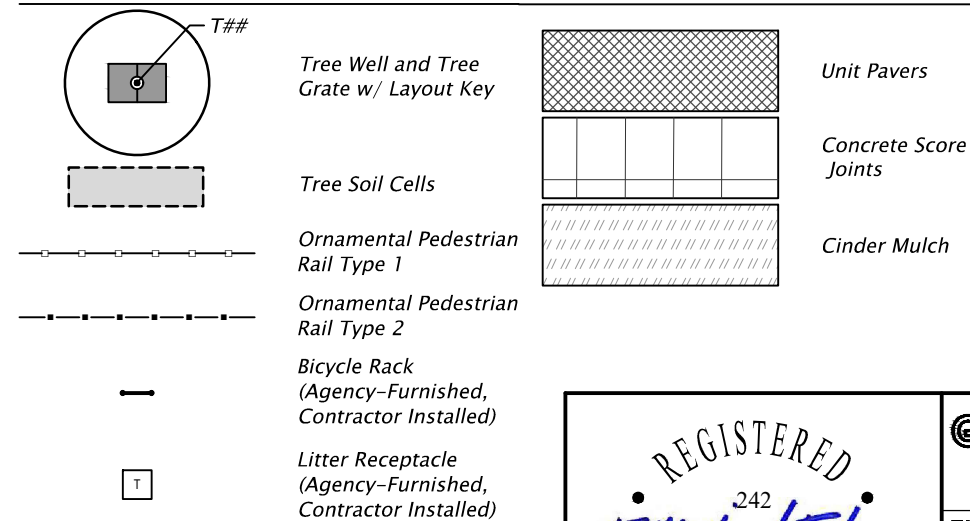

REGISTERED
242
F. Michael Faha
LANDSCAPE ARCHITECT

F. Michael Faha
OREGON
10/31/1988
EXP. 10/31/2026

GREEN WORKS
LANDSCAPE ARCHITECTURE • ENVIRONMENTAL DESIGN
110 SE Main St., Suite 100, Portland, OR 97214
PH: 503.222.8612
Email: info@greenworkspp.com

**THE DALLES FIRST STREET PROJECT
UNION STREET TO MADISON STREET**
THE DALLES, OREGON
WASCO COUNTY

Design Team Leader - P.C.
Designed By - W.S.
Drafted By - W.S. / C.W.

The Hub of the Pacific Northwest
CITY OF THE DALLES
OREGON

Rev.	Comment	Date
A1	Addenda 1 - Bid Comments	11/4/25

STREETSCAPE SITE PLAN

SHEET NO.
RB03

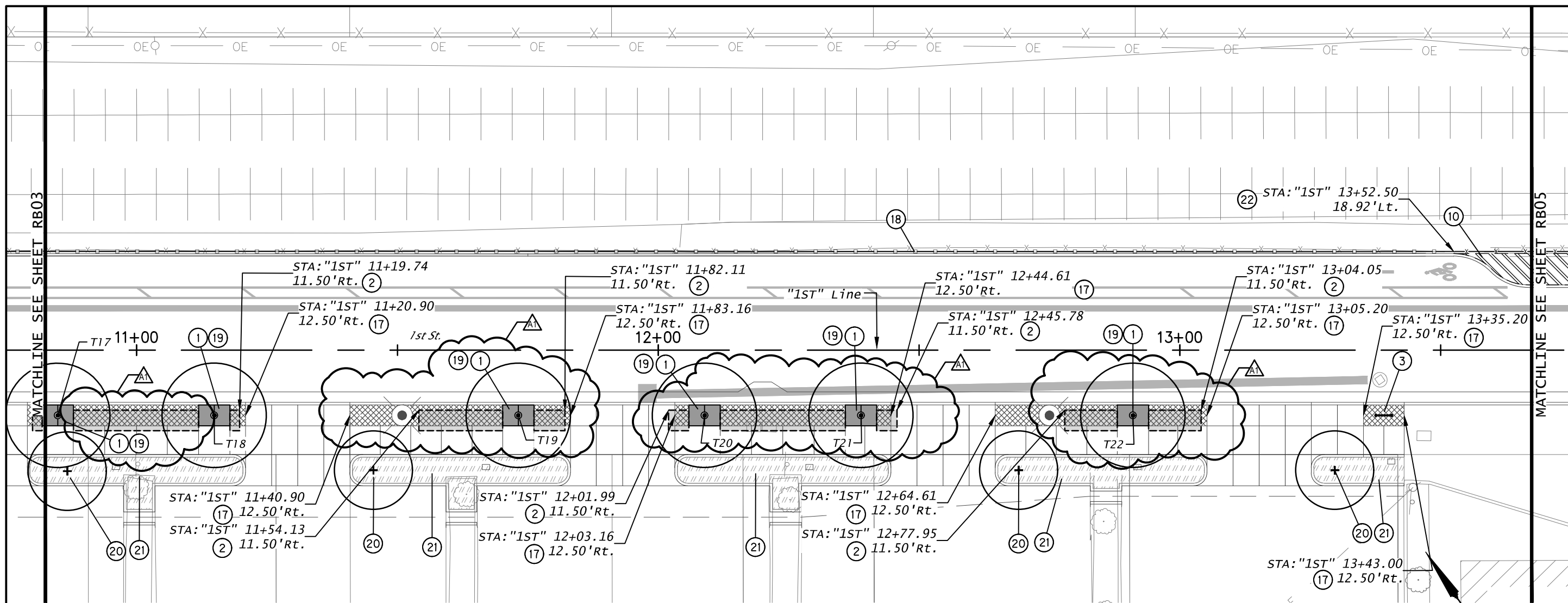

CONSTRUCTION NOTES

- ① Const. tree well and tree grate
(For details, see shts. RD01 and RD02)
(For layout table, see sht. RA01)
- ② Const. tree soil cells
(For details, see sht. RD01)
- ③ Sta. "1ST" 13+39.10, 12.50' Rt.
Const. Agency furnished, Contractor
installed bicycle rack
(For details, see sht. RD04)
- ④ Not in use.
- ⑤ Not in use.
- ⑥ Not in use.
- ⑦ Not in use.
- ⑧ Not in use.
- ⑨ Not in use.
- ⑩ Plant Agency furnished, Contractor
installed shrubs and groundcovers.
- ⑪ Not in use.
- ⑫ Not in use.
- ⑬ Not in use.
- ⑭ Not in use.
- ⑮ Not in use.
- ⑯ Not in use.
- ⑰ Const. unit pavers
(For details, see sht. RD04)
- ⑱ Plant deciduous tree at tree grate
(For details, see sht. RD05)
- ⑲ Plant deciduous tree
(For details, see sht. RD05)
- ⑳ Install cinder mulch
(For details, see sht. RD05)
- ㉑ Const. ornamental pedestrian rail type 3
(For details, see sht. RD03)
- ㉒ Const. ornamental pedestrian rail type 1
(For details, see sht. RD03)

LEGEND

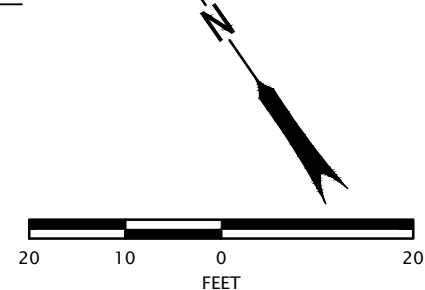
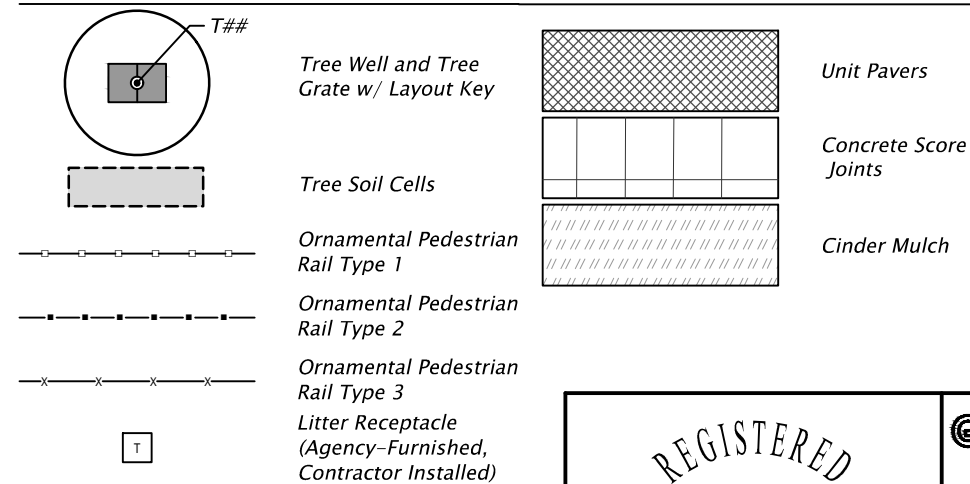

REGISTERED
242
F. Michael Faha
LANDSCAPE ARCHITECT

F. Michael Faha
OREGON
10/31/1988
EXP. 10/31/2026

GREEN WORKS
LANDSCAPE ARCHITECTURE • ENVIRONMENTAL DESIGN
110 SE Main St., Suite 100, Portland, OR 97214
PH: 503.222.8612
Email: info@greenworkspp.com

**THE DALLES FIRST STREET PROJECT
UNION STREET TO MADISON STREET**
THE DALLES, OREGON
WASCO COUNTY

Design Team Leader - P.C.
Designed By - W.S.
Drafted By - W.S. / C.W.

The Hub of the Pacific Northwest
CITY OF THE DALLES
OREGON

Rev.	Comment	Date
A1	Addenda 1 - Bid Comments	11/4/25

STREETSCAPE SITE PLAN

SHEET NO.
RB04

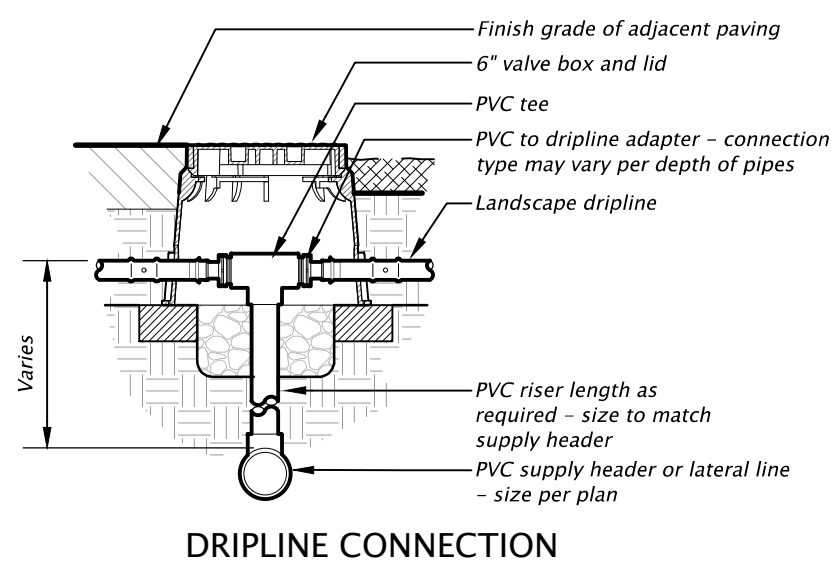

DRIPLINE CONNECTION

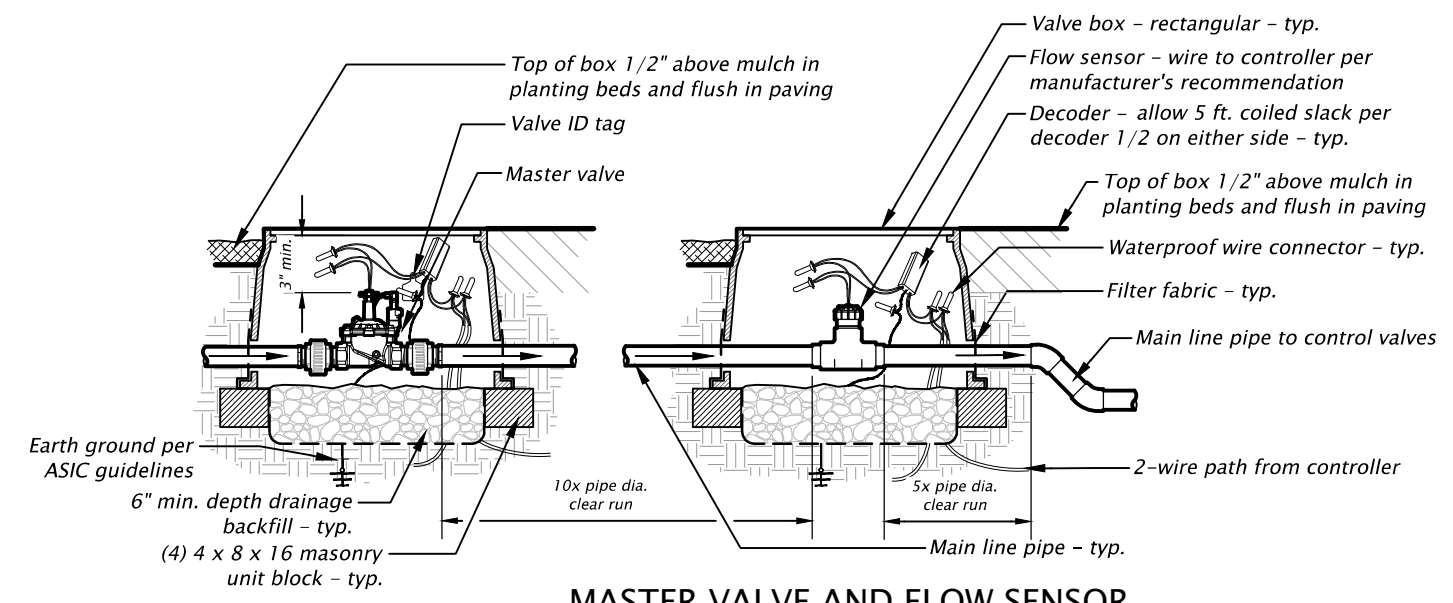

MASTER VALVE AND FLOW SENSOR

- Notes:
1. Main line pipe shall not change size or direction closer than 10 pipe diameters upstream or 5 pipe diameters downstream of the flow sensor
 2. Use 45 degree ells to achieve mainline depth on the downstream side of the flow sensor

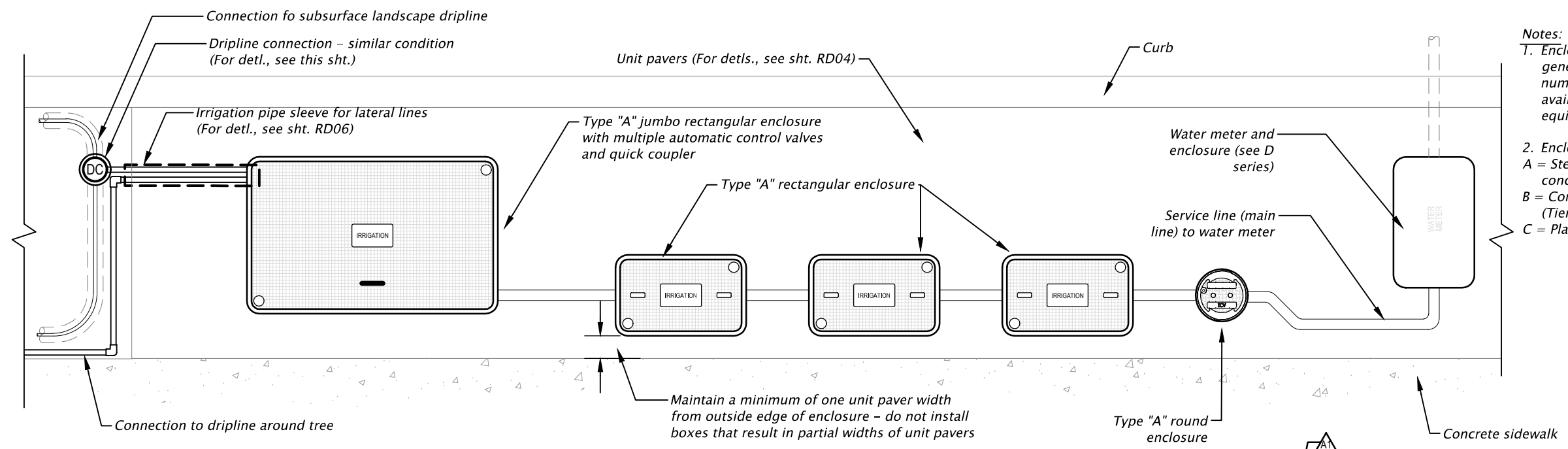

- Notes:
1. Enclosures (valve boxes) depicted are generally shown. Actual size and number may vary depending on availability of enclosures to use and equipment stored within them.
 2. Enclosure Types:
A = Steel lid (Tier 15 min.) and polymer concrete box
B = Concrete / poly conc. lid and box (Tier 15 min.)
C = Plastic lid and box

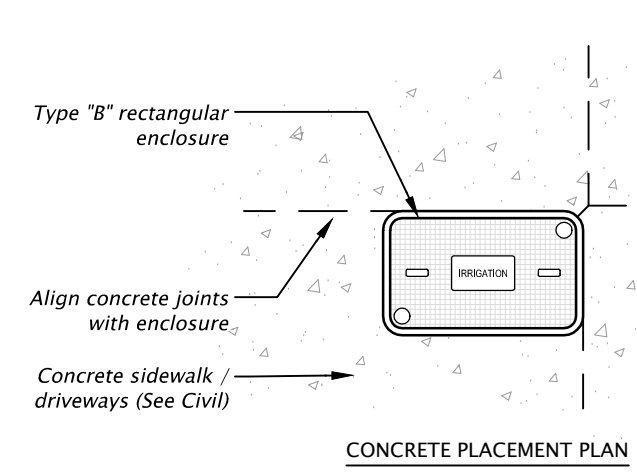

CONCRETE PLACEMENT PLAN

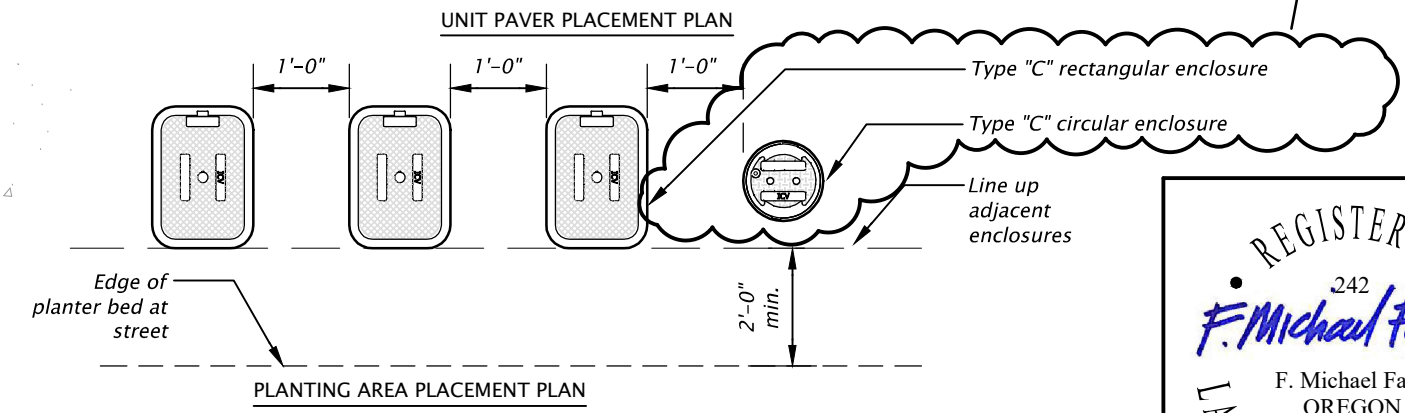

IRRIGATION ENCLOSURE TYPICAL LAYOUT

Rev.	Comment	Date
A1	Addenda 1 - Bid Comments	11/4/25

REGISTERED
242
F. Michael Faha
LANDSCAPE ARCHITECT
F. Michael Faha
OREGON
10/31/1988
EXP. 10/31/2026

GREEN WORKS
LANDSCAPE ARCHITECTURE • ENVIRONMENTAL DESIGN
110 SE Main St., Suite 100, Portland, OR 97214
PH: 503.222.8412
Email: info@greenworkspp.com

THE DALLES FIRST STREET PROJECT
UNION STREET TO MADISON STREET
THE DALLES, OREGON
WASCO COUNTY

Design Team Leader - P.C.
Designed By - W.S.
Drafted By - W.S. / C.W.

The Hub of the Pacific Northwest
CITY OF THE DALLES
OREGON

UR

IRRIGATION DETAILS

SHEET NO.
RD08