

CITY OF GRESHAM
STORM LINE - 36"

100 feet

TOUR (ppb)
2000)

Sewer Backfill Results

Sample Location	Sample Date	TCE ($\mu\text{g/L}$)	cDCE ($\mu\text{g/L}$)	PCE ($\mu\text{g/L}$)
Manhole 18	5/26/00	15	6.1	1.0
Manhole 17	5/26/00	7.3	2.6	0.5 U
Manhole 17 Dup	5/26/00	6.3	2.2	0.5 U
Trip Blank	5/26/00	0.5 U	0.5 U	0.5 U

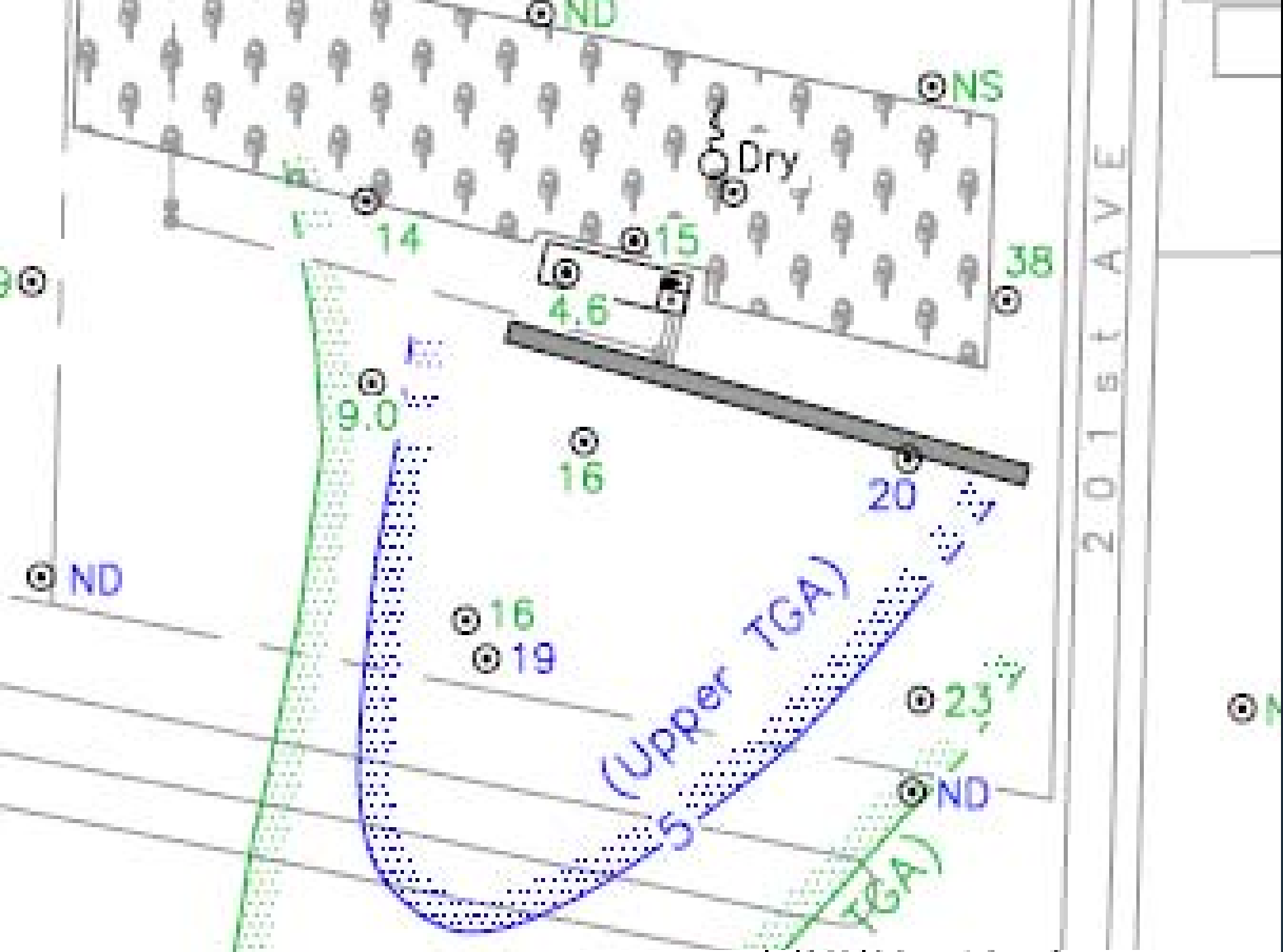
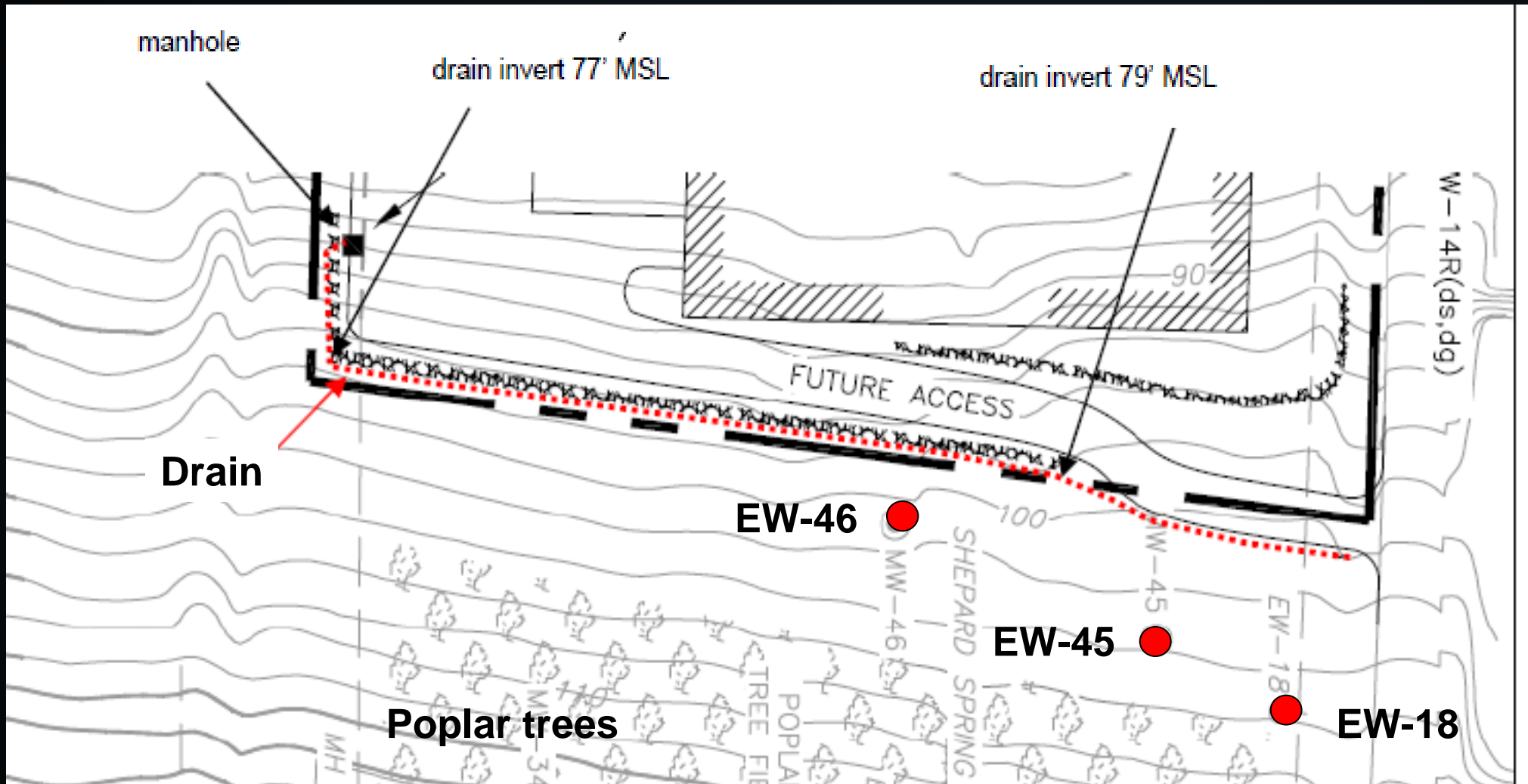

Figure 1
 TCE Concentrations
 August 2006

CUI Drain north of MW-45



Note: top of CU1 at 85' MSL at MW-45 and 87' MSL at MW-46

TCE data from Manhole

Well Name	Sample Date	Sample Collection Location	Tetrachloroethene			Trichloroethene			<i>cis</i> -1,2-Dichloroethene			Vinyl Chloride		
			(µg/L)	L	V	(µg/L)	L	V	(µg/L)	L	V	(µg/L)	L	V
Off-site Retaining (RT) Wall Drainage														
RT-INF ²	10/19/07	RT Manhole	0.5	U		4.1			0.5	U		0.5	U	
	12/2/07		0.5	U		6.1			0.57			0.5	U	
	12/6/07		0.5	U		3.4			0.5	U		0.5	U	
	12/18/07		0.5	U		11.0			1.5			0.5	U	
	12/28/07		0.5	U		2.8			0.5	U		0.5	U	
	2/7/08		0.5	U		1.2			0.5	U		0.5	U	
	5/8/08		0.5	U		0.9			0.5	U		0.5	U	
	4/7/10					0.72								
	4/8/10					0.51								
	4/9/10					0.60								