



CITY OF THE DALLES PUBLIC WORKS

1215 WEST 1st STREET
THE DALLES, OREGON 97058
(541) 296-5401

Application Fee	\$10
Expedite Fee	\$25
Event Deployment Fee	\$50
A contractor work zone is not an event.	

SIDEWALK/STREET CLOSURE APPLICATION

In accordance with The Dalles [Municipal Code 2.24.060](#), the sidewalk/street closure permit application must be submitted at least seven (7) business days prior to the proposed closure date. The Public Works Department shall have seven days to process the application. Fee(s) must be paid in full before application will be processed. **This permit will be considered a public document. All information submitted will be accessible to the public, in its entirety, on the City’s website.**

Please download and save this form before filling it out.

Date of Application:

Format: MM/DD/YYYY

Applicant First Name

Applicant Last Name

Primary First Name

Primary Last Name

Contact/Responsible Party

Email:

If the responsible party is not the applicant

Primary email address

Business Name:

Mailing Address:

Phone:

Other Phone:

On-call emergency phone number

Daytime phone number

For sidewalk closures a temporary pedestrian accessible route plan (TPARP) must be selected.

- View the TPARP advisory memorandum [here](#).
- View the TPARP options [here](#) and then select the type you will use.

Type of Closure:

- ☐ Street (TCP Required)
- ☐ Sidewalk (TPARP Required)
- ☐ City-Owned Parking Lot (TCP Required)
- ☐ Dumpster placed in the right-of-way
- ☐ Other (Describe below)

For sidewalk closures, select a type of Temporary Pedestrian Accessible Route Plan (TPARP):

- ☐ 1.a. Sidewalk diversion - Within roadway
- ☐ 1.b. Sidewalk diversion - Additional right-of-way
- ☐ 2. Sidewalk closure - Mid-block
- ☐ 3. Sidewalk closure - Corner

Please describe other type of right-of-way closure

Location(s) of closure

Reason for closure (e.g. event, construction, etc.)

Please write the addresses or sections of sidewalk/street for the requested closure.

Please describe the project or event for the requested closure.

Closure begin date

Time

Closure end date

Time

Format: MM/DD/YYYY

Format: MM/DD/YYYY

Sidewalk/Street Closure Fees

Fee(s) must be paid in full before application will be processed.

- 1. Application Fee: \$10.00
- 2. Expedited Fee (when application is turned in less than 5 days prior to the event): \$25.00
- 3. Event Deployment Fee (on for profit events which require use of City signs and barricades that staff deliver to event): \$50.00
A contractor work zone is not an event.

To pay by credit card, call the Public Works Department at (541) 296-5401.

To pay with a check or cash, mail or deliver to the City of The Dalles Public Works Department, 1215 West 1st Street, The Dalles, 97058 during business hours, weekdays 7:00 a.m. to 4:00 p.m.

Required Attachments

The applicant may be required to email one or more items to complete this application:

- 1. For street closures, applicants must attach a written and drawn **traffic control plan** that shows the safe and efficient movement of public traffic through or around a work/closure zone while protecting workers, incident responders, and equipment. The traffic control plan will be reviewed per the [Oregon Temporary Traffic Control Handbook](#).
- 2. Applicants for street or City-owned parking lot closures for events or construction work must provide a **Certificate of General Liability Insurance** with a minimum of \$1,000,000 coverage, with stated purpose of on the Certificate for the event and listing The City of The Dalles, 313 Court St. The Dalles, OR 97058 as a co-insured. Insurance is in addition to acknowledgement of responsibility and cannot be cancelled without prior notice to the City.

View the City's policy for insurance requirements [here](#). Read The Dalles Municipal Code 2.24.060 [here](#).

Acknowledgment of Applicant Responsibility

☐ I, the Applicant, agree to comply with the provisions of the City Charter, The Dalles Municipal Code (including TDMC 2.24.060), Resolutions, City policies connected with sidewalk and street closures, and with the requirements listed in this Application.

I, the Applicant, agree to indemnify, defend, and hold harmless the City of The Dalles and its officers, agents, and employees, from and against all liability, loss, and costs (of whatever form or nature, including property damage, pedestrian accessibility, personal injury, and death) arising from or relating in any way to actions, suits, claims, or demands attributable in whole or in part to my (including my officers, agents, and employees) acts or omissions in the performance of activities connected with this Permit.

I, the Applicant, certify I or the Responsible Party listed in this Application will notify adjacent property or business owners 72 hours prior to any closures authorized by this Permit.

I, the Applicant, certify I or the Responsible Party listed in this Application shall remain on-site or be available for on-call emergencies for the duration of the Permitted event and closure.

I, the Applicant, certify I or the Responsible Party listed in this Application will notify City Public Works Central Dispatch at the times of both closure and reopening by calling (541) 298-5507.

Failure of the applicant to meet the requirements of this permit, including following of the Traffic Control Plan and/or Temporary Pedestrian Accessible Route Plan, will result in a Stop Work Order and possible revocation of the permit.

By clicking submit and pasting or typing your name/signature in the signature line, you confirm you have read, understood, and affirmatively agree to be bound by the terms and conditions described.

Applicant Signature

Please save the form after signing. Then click to email the form to publicworks@ci.the-dalles.or.us

Receipt of Required Items

City Use Only

TCP for Street/Parking Lot Closure:	Attached	Not Required
TPARP for Sidewalk Closure:	Attached	Not Required
Certificate of General Liability:	Attached	Not Required
Payment Received:	Check Cash	Credit Card

Record of Approvals

Americans with Disabilities Act
Coordinator

Transportation Division
Manager

Permit Expiration Date

Laundry Renovation Site Logistics: 8/5/25-10/29/25

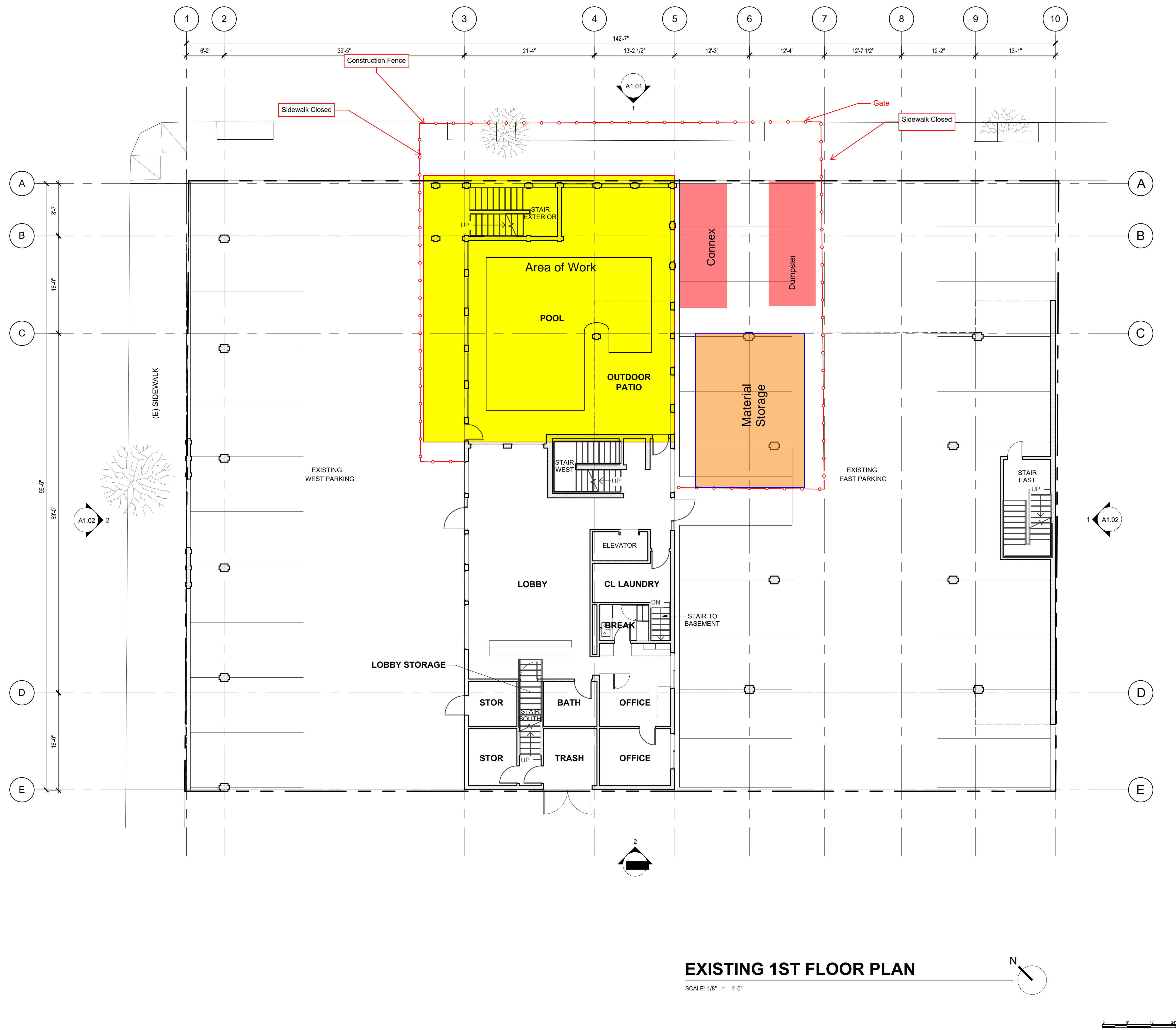

EXISTING 1ST FLOOR PLAN

SCALE: 1/8" = 1'-0"

REGISTERED ARCHITECT
MICHAEL SCOTT ABBOTT
SEATTLE, WA
STATE OF OREGON

ABBOTT
ARCHITECTURE

Woodinville, WA
P 206.778.7008

RAYLAND

RAYLAND HOTEL

HOTEL LOBBY ADDITION

The Dalles • Oregon • USA

112 W 2ND STREET
THE DALLES, OREGON
97058

DATE
11/14/24

PROJECT
2302

DRAWN BY
LAYOUT NAME
LEVEL ONE - EXISTING
PLAN

A201

BID SET ONLY - NOT FOR CONSTRUCTION

30

ousing &
nnex...

205

Liberty St

The Dalles Inn
3.9 ★ (552)
3-star hotel

Rayland Hotel

United States
Postal Service

AmeriTitle
102

W 3rd St

Wasco Masonic
Lodge No. 15

Union St

Pedestrian Accommodation, Mid-Block**Diagram 5-7**

The sidewalk should be closed at the nearest intersection on each side of the work area when a safe, ADA-compliant path through the work area is not available.

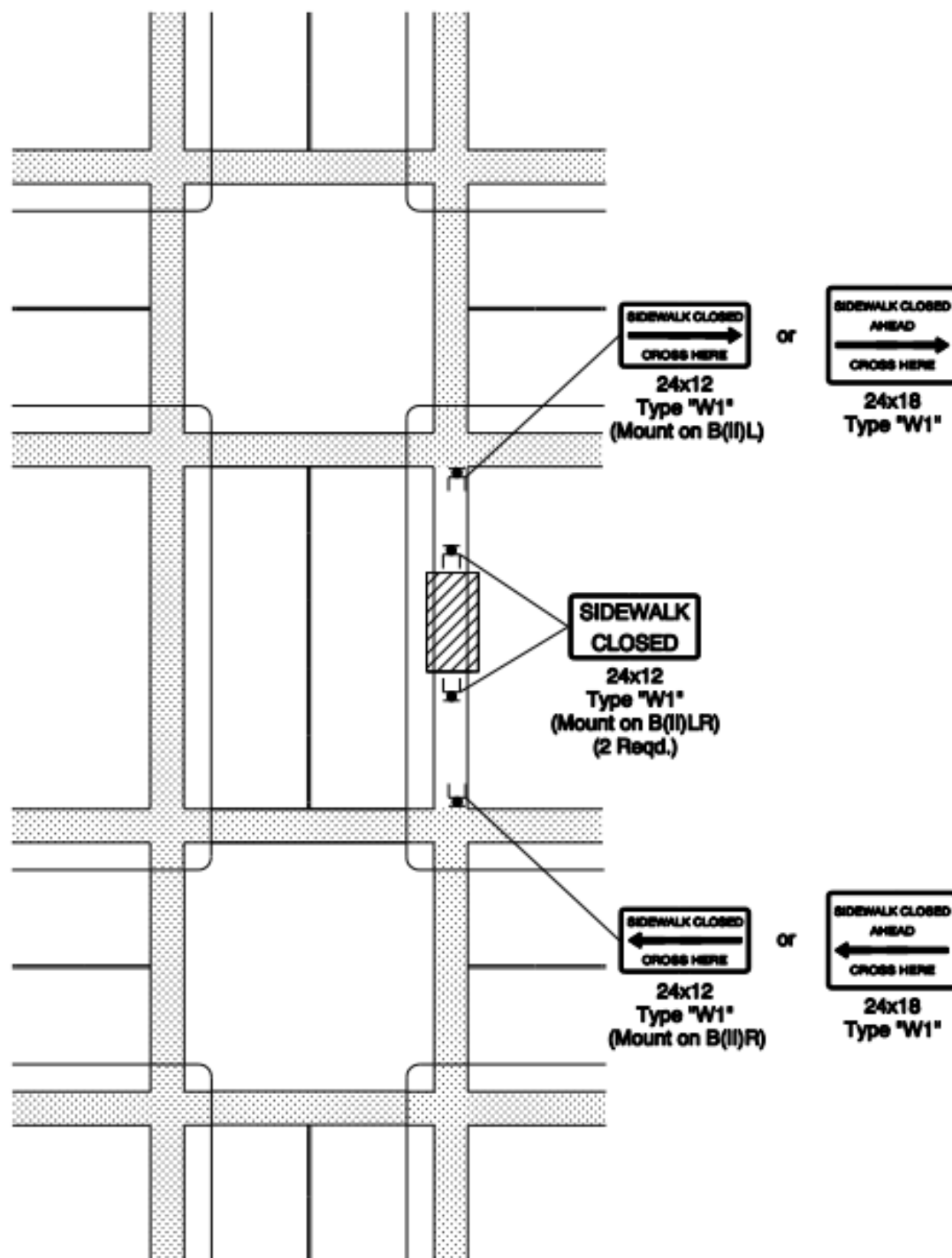

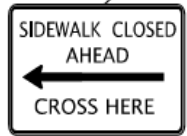

R9-11
24x18
(Mount on B(II)R)



M4-9b
30x24
(Mount on B(II)R)



M4-9b
30x24
(Mount on B(II)R)



R9-9
24x12
(Mount on PCD)
(2 Req'd.)



M4-9b
30x24
(Mount on B(II)R)

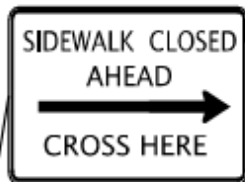

R9-11
24x18
(Mount on B(II)R)



M4-9b
30x24
(Mount on B(II)R)

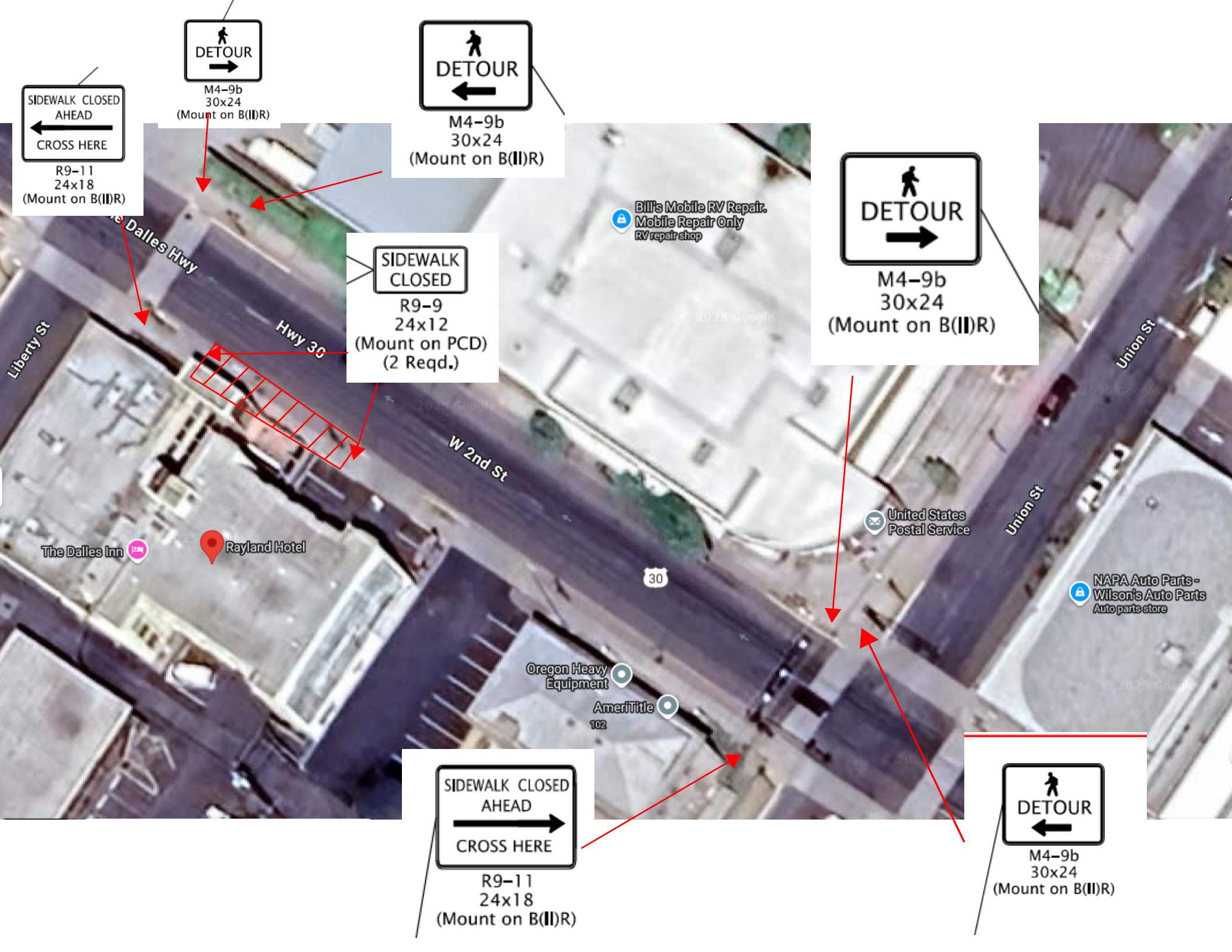

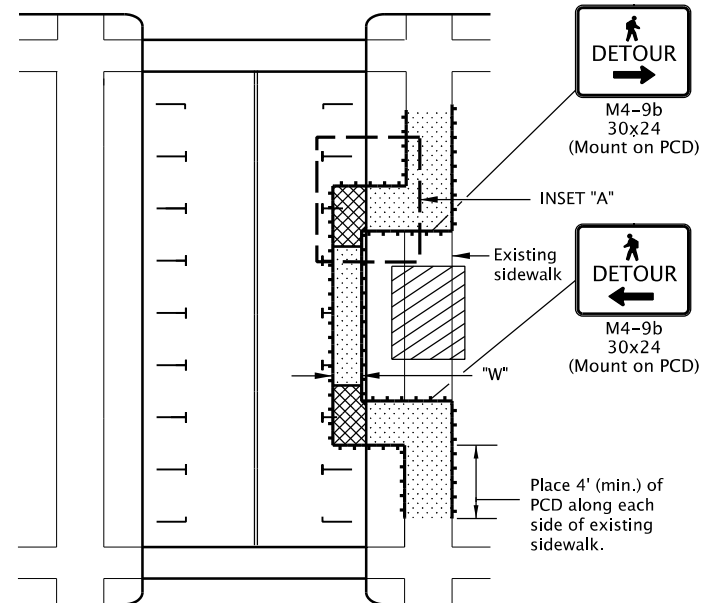

Within Roadway SIDEWALK DIVERSION

NOTES:

- Place or construct temp. sidewalk ramp, as needed.
- For roadways with a pre-construction posted speed of 40 mph or less.
- See inset "A" for Temp. Sidewalk Ramp details.
- "W" = 60", or, where 60" width cannot be maintained through the entire route, provide 48" min. width with 60" x 60" passing spaces every 200 ft.
- Use temporary ADA compliant surfaces to cross planter strips or other non-traversable surfaces.

NOTES:

- Ramp size will vary. Ramp must meet ADA requirements incl. max design grade of 7.5% and max design cross slope of 1.5%.

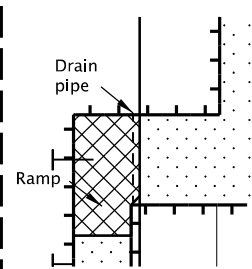

INSET "A"
(Temp. Sidewalk Ramp)

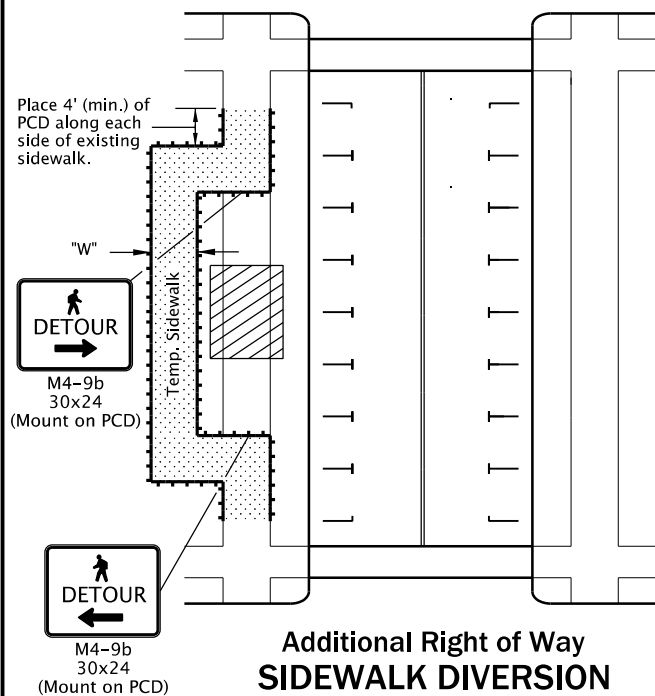

Additional Right of Way SIDEWALK DIVERSION

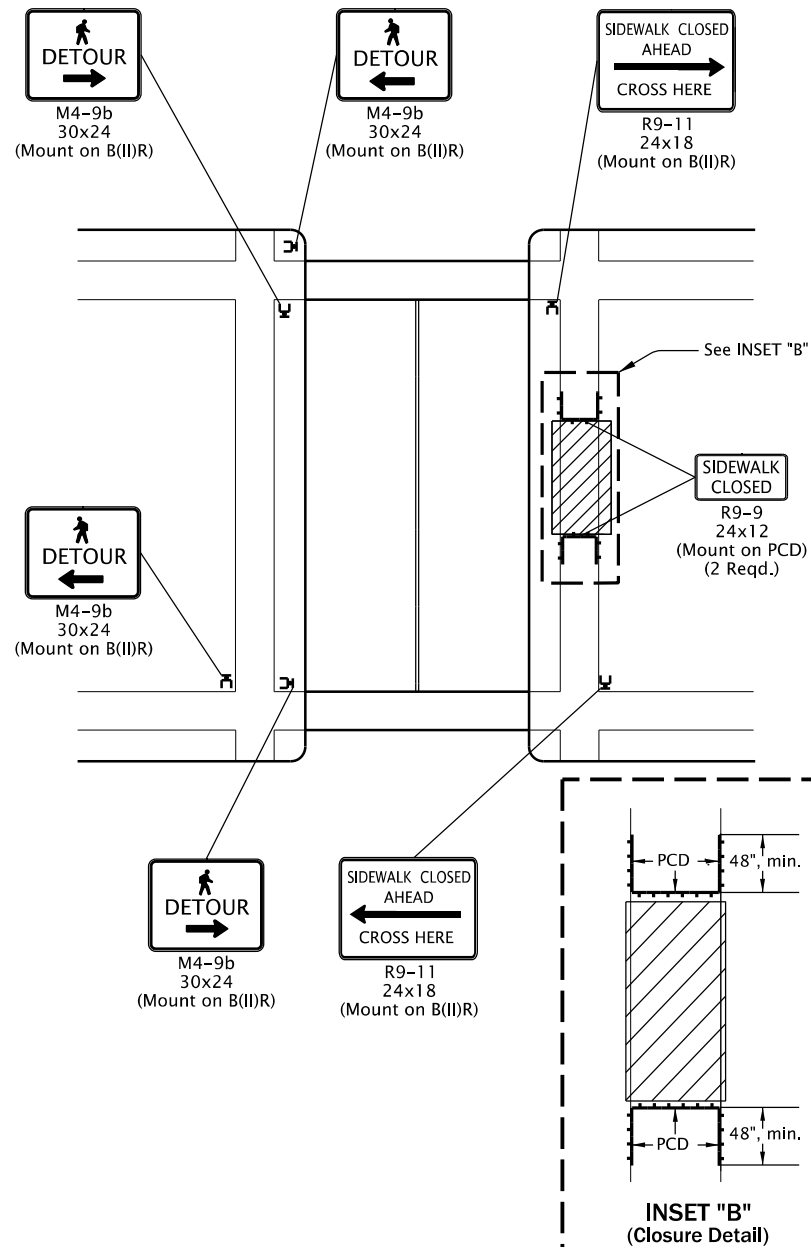

SIDEWALK CLOSURE, MIDBLOCK

GENERAL NOTES FOR ALL DETAILS:

- When closing or relocating crosswalks or other pedestrian facilities provide ADA compliant facilities. Include accessibility features consistent with existing pedestrian facilities by providing adequate slope transitions and surfacing.
- Provide non-slip, 60 inch minimum wide surface through entire pedestrian route. If not possible, provide 48" min. width with 60" x 60" passing spaces every 200 feet along the route.
- Only TCD for pedestrians are shown. Other devices may be necessary to control vehicular traffic.
- Stage work, as necessary, to provide a temporary pedestrian access route at all times. For roadways with no available detours, maintain one open sidewalk at all times.
- Minimize pedestrian out-of-direction travel.
- To be accompanied by Dwg. Nos. TM820 & TM821.

- UNDER PEDESTRIAN TRAFFIC
- UNDER CONSTRUCTION
- PEDESTRIAN CHANNELIZING DEVICE (PCD)

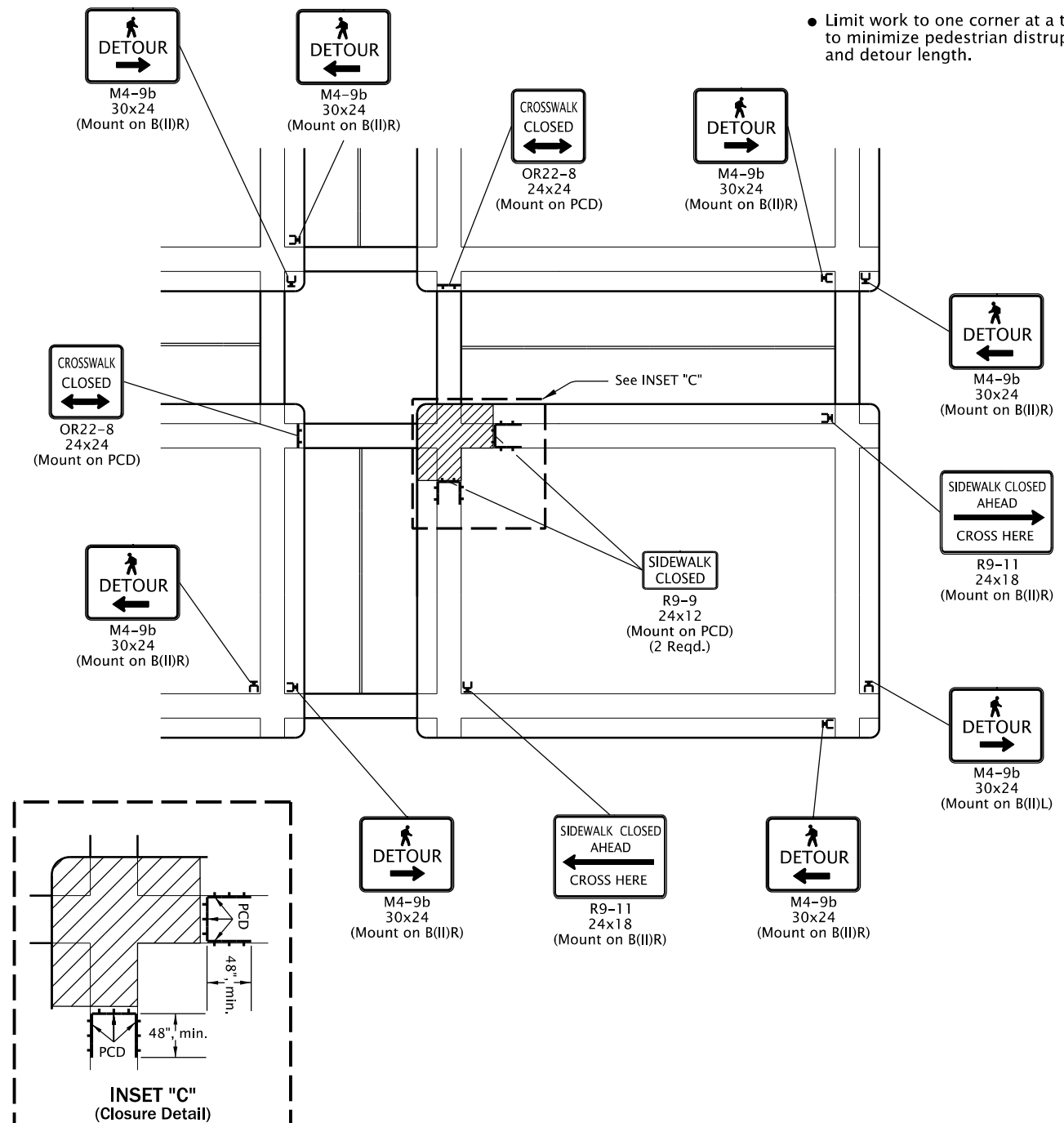

SIDEWALK CLOSURE, CORNER

NOTE:

- Limit work to one corner at a time to minimize pedestrian disruption and detour length.

CALC. BOOK NO. _____ N/A _____

SDR DATE _____ 01-JUL-2020 _____

NOTE: All material and workmanship shall be in accordance with the current Oregon Standard Specifications

OREGON STANDARD DRAWINGS

TEMPORARY PEDESTRIAN ACCESSIBLE ROUTES

2021

DATE	REVISION	DESCRIPTION

The selection and use of this Standard Drawing, while designed in accordance with generally accepted engineering principles and practices, is the sole responsibility of the user and should not be used without consulting a Registered Professional Engineer.

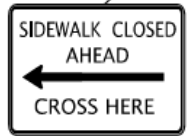

R9-11
24x18
(Mount on B(II)R)



M4-9b
30x24
(Mount on B(II)R)



M4-9b
30x24
(Mount on B(II)R)



R9-9
24x12
(Mount on PCD)
(2 Req'd.)



M4-9b
30x24
(Mount on B(II)R)

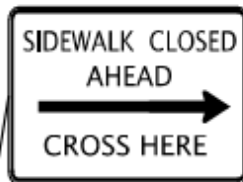

R9-11
24x18
(Mount on B(II)R)



M4-9b
30x24
(Mount on B(II)R)

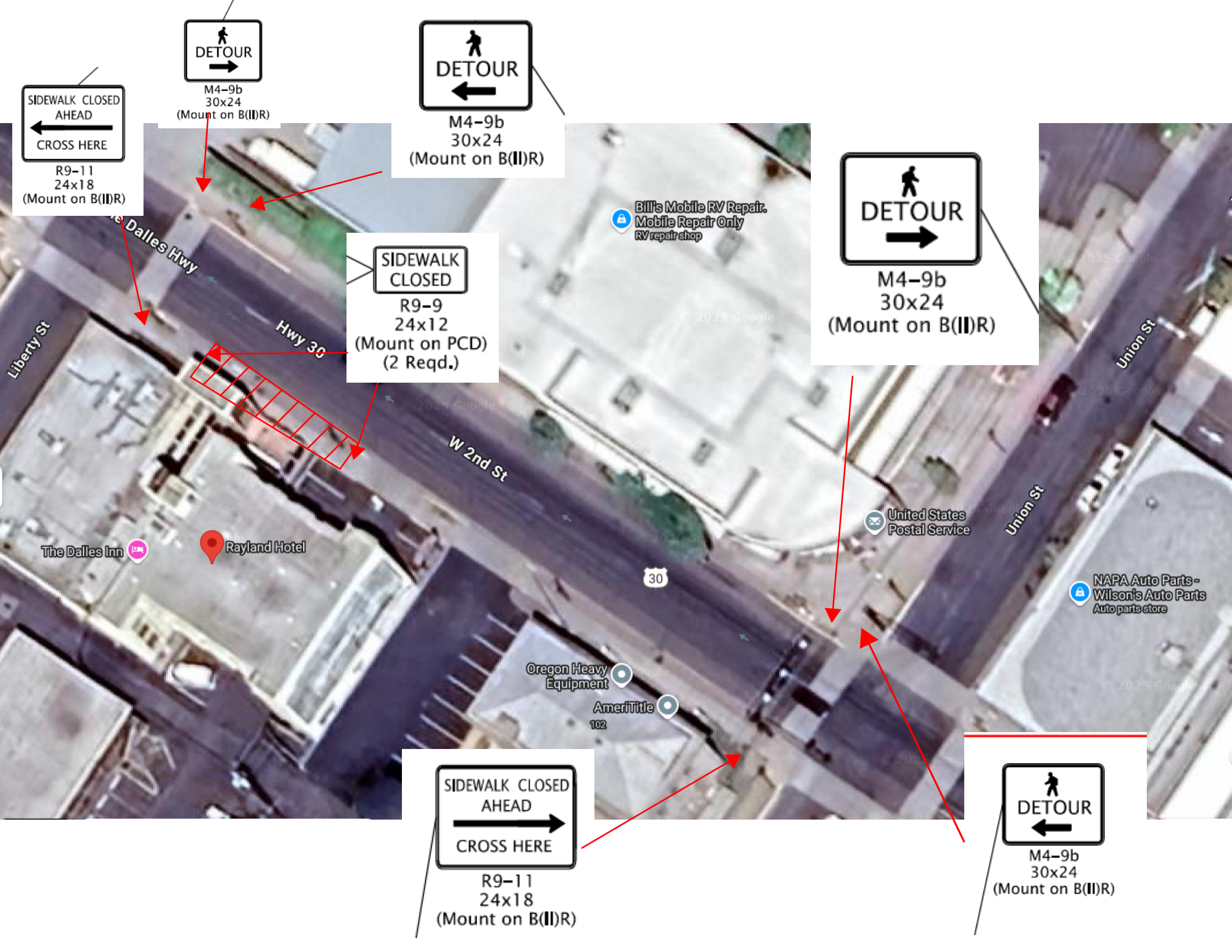

ACORDTM**CERTIFICATE OF LIABILITY INSURANCE**

DATE (MM/DD/YYYY)

5/14/2025

THIS CERTIFICATE IS ISSUED AS A MATTER OF INFORMATION ONLY AND CONFERS NO RIGHTS UPON THE CERTIFICATE HOLDER. THIS CERTIFICATE DOES NOT AFFIRMATIVELY OR NEGATIVELY AMEND, EXTEND OR ALTER THE COVERAGE AFFORDED BY THE POLICIES BELOW. THIS CERTIFICATE OF INSURANCE DOES NOT CONSTITUTE A CONTRACT BETWEEN THE ISSUING INSURER(S), AUTHORIZED REPRESENTATIVE OR PRODUCER, AND THE CERTIFICATE HOLDER.

IMPORTANT: If the certificate holder is an **ADDITIONAL INSURED**, the policy(ies) must have **ADDITIONAL INSURED** provisions or be endorsed. If **SUBROGATION IS WAIVED**, subject to the terms and conditions of the policy, certain policies may require an endorsement. A statement on this certificate does not confer any rights to the certificate holder in lieu of such endorsement(s).

PRODUCER Propel Insurance 805 SW Broadway; Suite 2300 COM Middle Market Portland, OR 97205-3363		CONTACT NAME: Bernadette Burns PHONE (A/C, No, Ext): 800 499-0933 E-MAIL ADDRESS: Bernadette.Burns@propelinsurance.com FAX (A/C, No): 866 577-1326																						
INSURED Bremik Construction, Inc 1026 SE Stark St Portland, OR 97214		<table border="1"> <thead> <tr> <th colspan="2">INSURER(S) AFFORDING COVERAGE</th> <th>NAIC #</th> </tr> </thead> <tbody> <tr> <td colspan="2">INSURER A : Continental Insurance Company</td> <td>35289</td> </tr> <tr> <td colspan="2">INSURER B : SAIF Corporation</td> <td>36196</td> </tr> <tr> <td colspan="2">INSURER C : Transportation Insurance Company</td> <td>20494</td> </tr> <tr> <td colspan="2">INSURER D : Columbia Casualty Company</td> <td>31127</td> </tr> <tr> <td colspan="2">INSURER E : Valley Forge Insurance Company</td> <td>20508</td> </tr> <tr> <td colspan="2">INSURER F :</td> <td></td> </tr> </tbody> </table>		INSURER(S) AFFORDING COVERAGE		NAIC #	INSURER A : Continental Insurance Company		35289	INSURER B : SAIF Corporation		36196	INSURER C : Transportation Insurance Company		20494	INSURER D : Columbia Casualty Company		31127	INSURER E : Valley Forge Insurance Company		20508	INSURER F :		
INSURER(S) AFFORDING COVERAGE		NAIC #																						
INSURER A : Continental Insurance Company		35289																						
INSURER B : SAIF Corporation		36196																						
INSURER C : Transportation Insurance Company		20494																						
INSURER D : Columbia Casualty Company		31127																						
INSURER E : Valley Forge Insurance Company		20508																						
INSURER F :																								

COVERAGES**CERTIFICATE NUMBER:****REVISION NUMBER:**

THIS IS TO CERTIFY THAT THE POLICIES OF INSURANCE LISTED BELOW HAVE BEEN ISSUED TO THE INSURED NAMED ABOVE FOR THE POLICY PERIOD INDICATED. NOTWITHSTANDING ANY REQUIREMENT, TERM OR CONDITION OF ANY CONTRACT OR OTHER DOCUMENT WITH RESPECT TO WHICH THIS CERTIFICATE MAY BE ISSUED OR MAY PERTAIN, THE INSURANCE AFFORDED BY THE POLICIES DESCRIBED HEREIN IS SUBJECT TO ALL THE TERMS, EXCLUSIONS AND CONDITIONS OF SUCH POLICIES. LIMITS SHOWN MAY HAVE BEEN REDUCED BY PAID CLAIMS.

INSR LTR	TYPE OF INSURANCE	ADDL INSR	SUBR WVD	POLICY NUMBER	POLICY EFF (MM/DD/YYYY)	POLICY EXP (MM/DD/YYYY)	LIMITS
A	<input checked="" type="checkbox"/> COMMERCIAL GENERAL LIABILITY <input type="checkbox"/> CLAIMS-MADE <input checked="" type="checkbox"/> OCCUR <input checked="" type="checkbox"/> BI/PD Ded:25000 GEN'L AGGREGATE LIMIT APPLIES PER: <input type="checkbox"/> POLICY <input checked="" type="checkbox"/> PRO-JECT <input type="checkbox"/> LOC OTHER:			6078897828	10/01/2024	10/01/2025	EACH OCCURRENCE \$1,000,000 DAMAGE TO RENTED PREMISES (Ea occurrence) \$100,000 MED EXP (Any one person) \$15,000 PERSONAL & ADV INJURY \$1,000,000 GENERAL AGGREGATE \$2,000,000 PRODUCTS - COMP/OP AGG \$2,000,000 \$
E	AUTOMOBILE LIABILITY <input checked="" type="checkbox"/> ANY AUTO OWNED AUTOS ONLY <input checked="" type="checkbox"/> HIRED AUTOS ONLY <input type="checkbox"/> SCHEDULED AUTOS NON-OWNED AUTOS ONLY			6078897800	10/01/2024	10/01/2025	COMBINED SINGLE LIMIT (Ea accident) \$1,000,000 BODILY INJURY (Per person) \$ BODILY INJURY (Per accident) \$ PROPERTY DAMAGE (Per accident) \$ \$
A	<input checked="" type="checkbox"/> UMBRELLA LIAB <input checked="" type="checkbox"/> EXCESS LIAB <input checked="" type="checkbox"/> RETENTION \$10000			6078897814	10/01/2024	10/01/2025	EACH OCCURRENCE \$15,000,000 AGGREGATE \$15,000,000 \$
B	WORKERS COMPENSATION AND EMPLOYERS' LIABILITY ANY PROPRIETOR/PARTNER/EXECUTIVE OFFICER/MEMBER EXCLUDED? <input checked="" type="checkbox"/> Y <input type="checkbox"/> N (Mandatory in NH) If yes, describe under DESCRIPTION OF OPERATIONS below		N/A	785189	10/01/2024	10/01/2025	<input checked="" type="checkbox"/> PER STATUTE <input type="checkbox"/> OTH-ER E.L. EACH ACCIDENT \$1,000,000 E.L. DISEASE - EA EMPLOYEE \$1,000,000 E.L. DISEASE - POLICY LIMIT \$1,000,000
C	Leased/Rented Equ			6079482992	10/01/2024	10/01/2025	200,000
D	Professional			CPB6078897831	10/01/2024	10/01/2025	\$10M pe Claim /\$10M Agg
D	Pollution			CSB6079571364	10/01/2024	10/01/2025	\$10M pe Claim /\$10M Agg

DESCRIPTION OF OPERATIONS / LOCATIONS / VEHICLES (ACORD 101, Additional Remarks Schedule, may be attached if more space is required)

RE: All Operations

CERTIFICATE HOLDER**CANCELLATION**

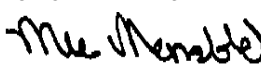
City of The Dalles 313 Court Street The Dalles, OR 97058	SHOULD ANY OF THE ABOVE DESCRIBED POLICIES BE CANCELLED BEFORE THE EXPIRATION DATE THEREOF, NOTICE WILL BE DELIVERED IN ACCORDANCE WITH THE POLICY PROVISIONS. AUTHORIZED REPRESENTATIVE 
---	---



City of The Dalles
313 Court Street | PO Box 1790
The Dalles, OR 97058
(541) 296-5481

XBP Confirmation Number: **231505236**

Transaction detail for payment to City of The Dalles.		Date: 05/15/2025 - 10:02:14 AM MT	
Transaction Number: 243103406 Visa — XXXX-XXXX-XXXX-8447 Status: Successful			
Account #	Item	Quantity	Item Amount
	SidewalkStreet Closure Permit	1	\$10.00

TOTAL: **\$10.00**

Billing Information
Tanner Woods
97214

Transaction taken by: Admin JCorbin