



Oregon

Tina Kotek, Governor

Department of Environmental Quality

Northwest Region

700 NE Multnomah Street, Suite 600

Portland, OR 97232

(503) 229-5263

FAX (503) 229-6945

TTY 711

October 11, 2023

Brent Budden
PO Box 5277
Klamath Falls, OR 97601

RE: Annual Inspection for Parcel WWTP
North Ridge Estates Superfund Site
ECSI No. 6024

Dear Brent Budden:

The Oregon Department of Environmental Quality (DEQ) completed an annual inspection of the protective cap on your property located on Old Fort Road during the week of July 3, 2023. Enclosed for your information is a summary of the inspection.

This letter provides notice of the following violation:

1. **Cap Damage.** Slides/soil sloughing on steep slope, rills, tire tracks, and gullies were noted during the inspection consistent with previous years (see enclosed figure).

Corrective Action. Fill in the damaged areas to restore the 2 foot soil cap and vegetate. Armor as needed to prevent reoccurrence by November 12, 2023.

DEQ will perform an inspection the week of November 13, 2023 to confirm the repairs have been made.

The Easement and Equitable Servitude recorded with Klamath County requires you to maintain and keep the protective caps in good repair. If the repairs are not completed by November 12, 2023, DEQ may perform the corrective action at your expense in accordance with Paragraph 4.1 of the Easement and Equitable Servitude.

The next annual inspection will be performed in June 2024. Please continue to contact DEQ prior to any disturbing any of the protective caps on your property with the exception of soil disturbances less than 2 feet below the ground surface. A fact sheet with additional information is enclosed.

If you have any questions, please contact me at 503-860-3943, or via email at Katie.Daugherty@deq.oregon.gov.

Sincerely,

Katie Daugherty, R.G.
Project Manager
NWR Cleanup Section

Enclosures

Digging at the North Ridge Estates Superfund Site

What do I need to do or know?

- 1) Perform all other normal permitting and utility locates as you would for any other project.
- 2) Be familiar with the types of protective caps at North Ridge Estates. The protective cap is intended to prevent people's exposure to any remaining asbestos-contaminated materials, including asbestos fibers in soil. Protective caps include:
 - A two-foot layer of clean soil with vegetation
 - Asphalt and concrete surfaces, such as garage concrete floor or basement concrete floor
 - Boulders
 - Black liners installed below covered porches and in home crawl spaces
 - Orange liners below the soil cap
- 3) Review the terms of the Easement and Equitable Servitude (EES) document recorded on the deed of your property. Determine if your planned activity is within the area covered by restrictions outlined in the EES. Some properties on the edge of the Superfund site only have a portion of the property restricted. *General rule of thumb: if the area was excavated during the Superfund Cleanup, the area is restricted.* Can't find your EES? Contact the Oregon Department of Environmental Quality (DEQ) project manager and they will email you a copy.
- 4) All activities or uses that could jeopardize the function of the protective cap, are prohibited without prior written approval from the DEQ.
- 5) Follow the steps below for your specific activity.

I want to dig **less than two feet** - what are the required steps?

- 1) Minor activities are allowed within the **soil protective cap**, such as installing fence posts, planting, or other activities that go no deeper than two feet below the ground surface without prior written approval from DEQ.
- 2) You must fully restore the cap to the surface after the activities are completed.
- 3) Stop immediately and call the DEQ project manager if you see an orange liner. **No matter the depth!** You are entering an asbestos contamination zone and risk exposure to asbestos if you continue.



Example of Orange Liner. 2018. Installing marker barrier consisting of rock base and orange liner on Parcel B prior to covering with clean soil.



Example of Black Liner. 2018. Black liner with rock to hold in place on Parcel A.

I want to **dig deeper than two feet, dig below a black or orange liner, dig through asphalt or concrete, or move boulders on my property** - what are the required steps?

- 1) Fill out the *North Ridge Estates Earthwork Notification and Reporting Form* and submit this form to the DEQ project manager. Can't find the form? Contact the project manager and they will email you a copy.

The project manager will review the information provided in the form and work with you to determine the conditions under which your work may be performed.

If your work will breach the cap, you must, at your own expense, use an Oregon-licensed asbestos abatement company during any action that may disturb a contaminated area. Any excavated material, including soil, will be required to be disposed at a landfill. If the liner is damaged during work, you must replace it at your expense.

- 2) Once work is complete, fill out the reporting section of the *North Ridge Estates Earthwork Notification and Reporting Form* and return to the DEQ project manager.



State of Oregon
Department of
Environmental
Quality

Cleanup Program

700 NE Multnomah St.,
Suite 600
Portland, OR 97232
Phone: 503-860-3943
800-452-4011
Fax: 503-229-6124
Katie.Daugherty@deq.oregon.gov
n.gov
Contact: Katie Daugherty

www.oregon.gov/DEQ

DEQ is a leader in restoring, maintaining and enhancing the quality of Oregon's air, land and water.

Alternative formats

DEQ can provide documents in an alternate format or in a language other than English upon request. Call DEQ at 800-452-4011 or email deqinfo@deq.oregon.gov

Parcel WWTP

Operations and Maintenance Inspection Form

Part I. General Site Information							
Site Name:		North Ridge Estates		State/Country:		Oregon (Klamath County)	
EPA Point of Contact		Linda Meyer (206) 553-6636		ODEQ Point of Contact		Katie Daugherty (503) 860-3943	
Inspection Date:		7/4/2023		Person(s) Performing Inspection:		Andrew Bisbee (Apex Companies, LLC)	
				Person(s) Performing Inspection:			
Part II. Remedy Performance Assessment							
Remedy Component	Potential Problem	Yes (Repair Needed)	Yes (Monitor/ No Repair)	No	N/A	If Yes, Describe Extent of Problem	Describe Potential Repair Solution
Protective Cap	Have rills developed deeper than 2 inches?	<input type="checkbox"/>	<input checked="" type="checkbox"/>	<input type="checkbox"/>	<input type="checkbox"/>	Rills were identified in a few locations adjoining the dirt road on the parcel. (Same as 2022)	
	Are the rills within a 10-foot interval?	<input type="checkbox"/>	<input checked="" type="checkbox"/>	<input type="checkbox"/>	<input type="checkbox"/>		
	Have gullies developed deeper than 6 inches?	<input checked="" type="checkbox"/>	<input type="checkbox"/>	<input type="checkbox"/>	<input type="checkbox"/>	A gully was identified near the dirt road and woodchip stockpile in the NE quadrant of the parcel.	Backfill gully to prevent further erosion.
	Have animals created burrows in the protective cap?	<input type="checkbox"/>	<input type="checkbox"/>	<input checked="" type="checkbox"/>	<input type="checkbox"/>		
	Have vehicles damaged the protective cap?	<input type="checkbox"/>	<input checked="" type="checkbox"/>	<input type="checkbox"/>	<input type="checkbox"/>	Tire ruts were noted at the base of the dirt road at the north central area of the parcel (Same as 2022).	
	Any evidence of ACM on Site including areas where the protective cap is less than 2 feet (see as-built drawings) or within the dripline of the legacy trees?	<input type="checkbox"/>	<input type="checkbox"/>	<input checked="" type="checkbox"/>	<input type="checkbox"/>		
	Are there areas that show evidence of unstable slopes, subsidence, or slope failure? Are there signs of active bank erosion and/or lateral cutting?	<input checked="" type="checkbox"/>	<input type="checkbox"/>	<input type="checkbox"/>	<input type="checkbox"/>	Multiple slides were identified along the southern perimeter of the parcel on the oversteepened slopes. (Same as 2021)	Repair the oversteepened slopes to prevent further erosion.
	Any visible ACM along the perimeter of the Site (where applicable)?	<input type="checkbox"/>	<input type="checkbox"/>	<input checked="" type="checkbox"/>	<input type="checkbox"/>		
Vegetation	Evidence of distressed or sparse vegetation? (sparse vegetation no greater than 10 percent of area and bare areas no greater than 100 square feet)	<input type="checkbox"/>	<input type="checkbox"/>	<input checked="" type="checkbox"/>	<input type="checkbox"/>		
	Evidence of trees and shrubs in distress?	<input type="checkbox"/>	<input type="checkbox"/>	<input checked="" type="checkbox"/>	<input type="checkbox"/>		
	Are there any stressed or dying trees that may impact or damage the protective cap when felled?	<input type="checkbox"/>	<input type="checkbox"/>	<input checked="" type="checkbox"/>	<input type="checkbox"/>		

Ditches and Culverts	Obstructions observed in ditches or culverts that may impede conveyance of stormwater?	<input type="checkbox"/>	<input type="checkbox"/>	<input checked="" type="checkbox"/>	<input type="checkbox"/>		
	Damaged observed to riprap surface? Note if riprap is not intact or not effectively providing armor protection.	<input type="checkbox"/>	<input type="checkbox"/>	<input type="checkbox"/>	<input checked="" type="checkbox"/>		
	Are there any areas that show signs of excessive scour? (i.e., gullies forming along centerline of ditch)	<input type="checkbox"/>	<input type="checkbox"/>	<input checked="" type="checkbox"/>	<input type="checkbox"/>		
	Are culvert inlets and outlets damaged?	<input type="checkbox"/>	<input type="checkbox"/>	<input checked="" type="checkbox"/>	<input type="checkbox"/>		
Driveways and Walkways	Are the driveways showing signs of failure? (i.e., alligator cracking)	<input type="checkbox"/>	<input type="checkbox"/>	<input type="checkbox"/>	<input checked="" type="checkbox"/>	Roads and driveways were gravel and/or dirt. (Same as 2021)	
	Are there any other signs of considerable damage to paved surfaces, other than normal wear and use?	<input type="checkbox"/>	<input type="checkbox"/>	<input type="checkbox"/>	<input checked="" type="checkbox"/>		
Crawlspace and Decks	Are the liners inside crawlspaces and under covered decks damaged or punctured?	<input type="checkbox"/>	<input type="checkbox"/>	<input type="checkbox"/>	<input checked="" type="checkbox"/>		
	Are the liners exposed to UV radiation?	<input type="checkbox"/>	<input type="checkbox"/>	<input type="checkbox"/>	<input checked="" type="checkbox"/>		
Access Controls	Are access controls damaged?	<input type="checkbox"/>	<input type="checkbox"/>	<input type="checkbox"/>	<input checked="" type="checkbox"/>		
	Are changes to the access controls needed?	<input type="checkbox"/>		<input type="checkbox"/>	<input checked="" type="checkbox"/>		
Miscellaneous Features / Changes in Site Conditions / Misc.	Are there any new site features installed that have damaged the protective cap?	<input type="checkbox"/>	<input type="checkbox"/>	<input checked="" type="checkbox"/>	<input type="checkbox"/>	Rock, gravel, woodchip, and soil stockpiles were noted throughout the parcel. No damage to protective cap was noted. (Same as 2021) New gravel stockpile provided by City in 2023 for road repairs was noted within laydown area located on east central portion of parcel.	
		<input type="checkbox"/>	<input type="checkbox"/>	<input type="checkbox"/>	<input type="checkbox"/>		
		<input type="checkbox"/>	<input type="checkbox"/>	<input type="checkbox"/>	<input type="checkbox"/>		
		<input type="checkbox"/>	<input type="checkbox"/>	<input type="checkbox"/>	<input type="checkbox"/>		
		<input type="checkbox"/>	<input type="checkbox"/>	<input type="checkbox"/>	<input type="checkbox"/>		

I:\Client\DEQ\Oregon\32-23006007 North Ridge Estates\Parcel Inspections

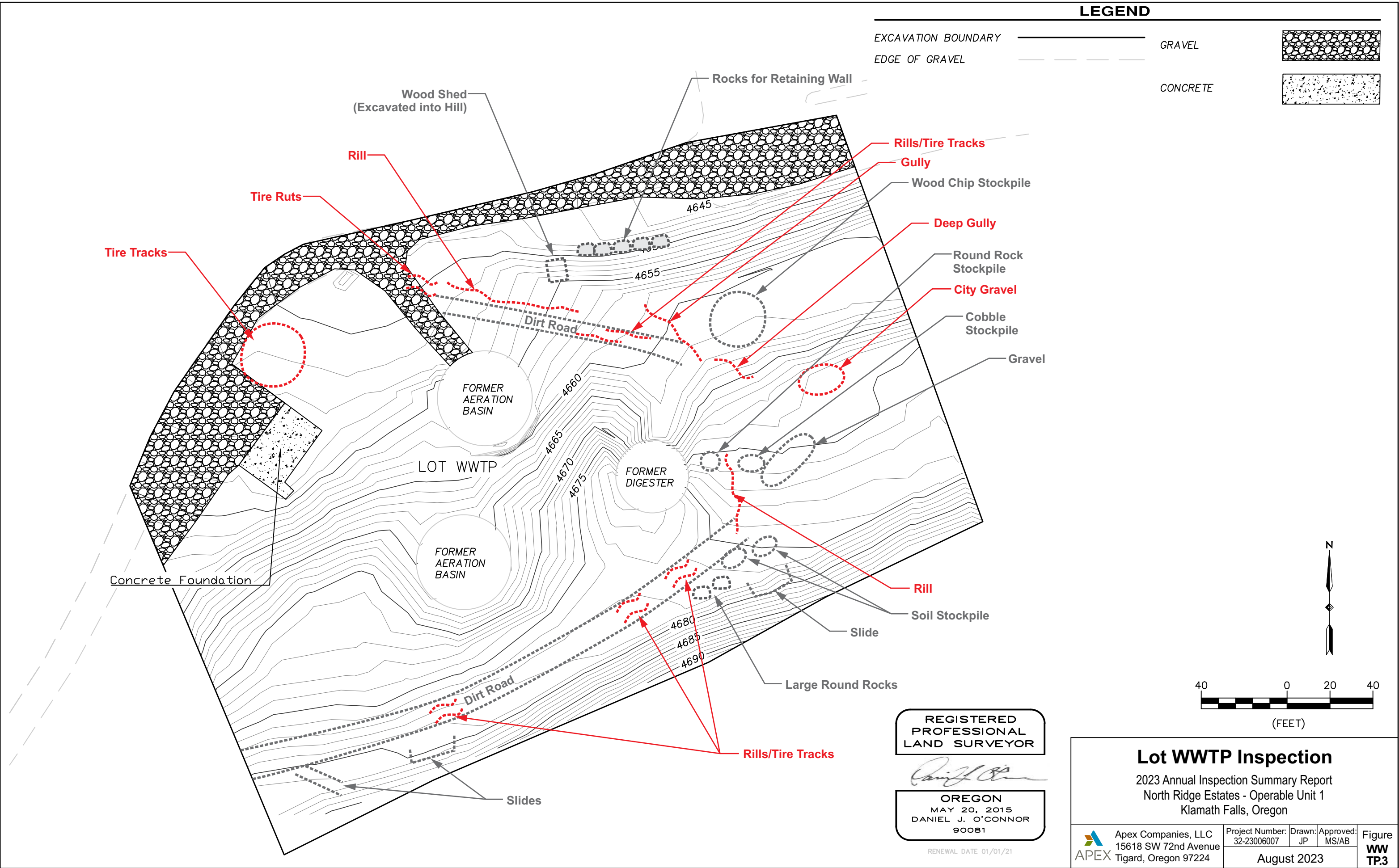

Parcel WWTP



Parcel WWTP – Northeast corner looking Southwest (Former Digester visible in background).



Parcel WWTP – Southeast corner looking west (view of laydown area).

Parcel WWTP



Parcel WWTP – Southwest corner looking Northeast (Former Aeration Basin visible in background).



Parcel WWTP – Northwest corner looking Southeast (view of parking area).

Parcel WWTP



Parcel WWTP – View of new Gravel Stockpile (provided by the City for road repairs).



Parcel WWTP – View of new downslope Gully alongside dirt road.

Parcel WWTP



Parcel WWTP – View of new Tire Ruts at base of dirt road.



Parcel WWTP – View of new Tire Tracks on dirt road (Former Aeration Basin visible in background).

Parcel WWTP



Parcel WWTP – View of new Rill alongside the dirt road.



Parcel WWTP – View of new Rill near Former Digester.