



CITY OF THE DALLES PUBLIC WORKS

1215 WEST FIRST STREET
THE DALLES, OREGON 97058
(541) 296-5401

Table with 2 columns: Fee Name, Amount. Application Fee \$10, Expedite Fee \$25, Deployment Fee \$50.

SIDEWALK/STREET CLOSURE PERMIT

This application must be submitted at least seven (7) business days prior to the proposed sidewalk/street closure date. Applications may be submitted in person or mailed to the Public Works office at the address above or emailed to publicworks@ci.the-dalles.or.us.

Please complete the entire form

Applicant Name: Jesus Mendez Date: 7/26/2024
Address: 802 Chenoweth Loop Rd Phone: (509) 637-5565
Contact/Responsible Person: Jesus Mendez Phone:
Email Address: Jesus@MCEED.org Cell: Same

TYPE OF CLOSURE (Check at least 1)
[ ] Street for Construction Work [X] Sidewalk for Construction Work
[ ] Street/Parking Lot for Event [ ] Sidewalk for Event
[ ] Parking Lane for Dumpster [ ] Other

CLOSURE FROM 7/26/2024 8am (Date/Time) TO 8/2/2024 5pm (Date/Time)
LOCATION/ADDRESS OF CLOSURE 5th & Court St., Near 700 Union St.
REASON FOR CLOSURE Bus Shelter Construction

INSTRUCTIONS/REQUIREMENTS:

- Applicant must provide a Traffic Control Plan (TCP) for approval for all Street and Parking Lot Closures.
Applicant must provide a Temporary Pedestrian Accessible Route Plan (TPARP) for approval for all Sidewalk Closures.
Applicant must notify Central Dispatch at the time of street closing and reopening.
Applicant must notify adjacent property/business owners prior to closure.
Applicant must provide proof of liability insurance with The City of The Dalles listed as co-insured if City Street/Parking Lot closure is for an event
Fee must be paid in full before application will be processed.
1. Application Fee: \$10.00
2. Expedited Fee (when application is turned in less than 5 days prior to the event): \$25.00
3. Event Deployment Fee (on for-profit events which require use of City signs and barricades that staff deliver to event): \$50.00

THIS PERMIT WILL BE CONSIDERED A PUBLIC DOCUMENT. ALL INFORMATION SUBMITTED WILL BE ACCESSIBLE TO THE PUBLIC, IN ITS ENTIRETY, ON THE CITY'S WEBSITE.

**ACKNOWLEDGEMENT OF APPLICANT RESPONSIBILITY**

The undersigned agrees to defend, indemnify and hold the City of The Dalles, its officers, agents and employees, harmless from and against all claims, liabilities, demands, damages and actions, of whatever form or nature, including but not limited to property damage, pedestrian accessibility, personal injury and death, together with costs and attorney fees incurred in defense thereof, arising from or relating in any way to the street or sidewalk closure authorized by this permit and the undersigned's activities in connection with this permit. Applicant for City Street or Parking Lot closures for events must provide a Certificate of General Liability Insurance with a minimum of \$1,000,000 coverage, with stated purpose on the Certificate for the event and listing the City of The Dalles as a co-insured. Insurance is in addition to acknowledgement of responsibility and cannot be cancelled without prior notice to the City. In addition the Responsible Person listed on this permit shall remain on-site during the duration of the event and closure.

Failure of the applicant to meet the requirements of this permit, including following of the Traffic Control Plan and/or Temporary Pedestrian Accessible Route Plan, will result in a Stop Work Order and possible revocation of the permit.

I understand and agree to the terms of this Sidewalk/Street Closure Permit.

Applicant Signature *J. Mendoza* Date 7/26/2024

**CITY USE ONLY**

- Mid block sidewalk closure, Park Ped to North Sidewalk
- \_\_\_\_\_
- \_\_\_\_\_
- \_\_\_\_\_

<u>Receipt of Required Items</u>			
TCP for Street/Parking Lot Closure	<input type="checkbox"/> Attached	<input checked="" type="checkbox"/> Not Required	
TPARP for Sidewalk Closure	<input checked="" type="checkbox"/> Attached	<input type="checkbox"/> Not Required	
Certificate of General Liability	<input type="checkbox"/> Attached	<input type="checkbox"/> Not Required	
Payment Received	<input type="checkbox"/> Check	<input type="checkbox"/> Cash	<input type="checkbox"/> Credit Card <u>waived per Dale McCabe</u>

**RELATED PERMITS** \_\_\_\_\_

**ROUTING ORDER**

Department	Approval	Date
Public Works – ADA Coordinator	<u><i>[Signature]</i></u>	<u>7/26/24</u>
Human Resources - Risk Manager		
Public Works – Transportation Manager	<u><i>Dale S. Mills for DAVID MILLS</i></u>	<u>7/26/2024</u>

**THIS PERMIT IS:**

**APPROVED** AND EXPIRES ON 8/5/2024

**APPROVED** WITH REVISIONS AND EXPIRES ON \_\_\_\_\_

**DENIED** FOR FOLLOWING REASON: \_\_\_\_\_

Authorized by: *Dale S. Mills* Title: CITY ENGINEER

**Public Works to notify Applicant of final decision**

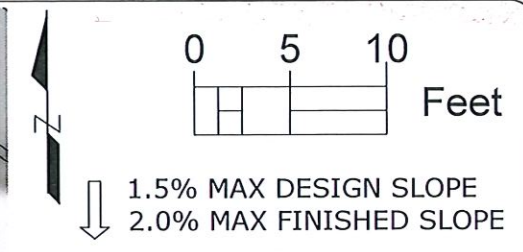
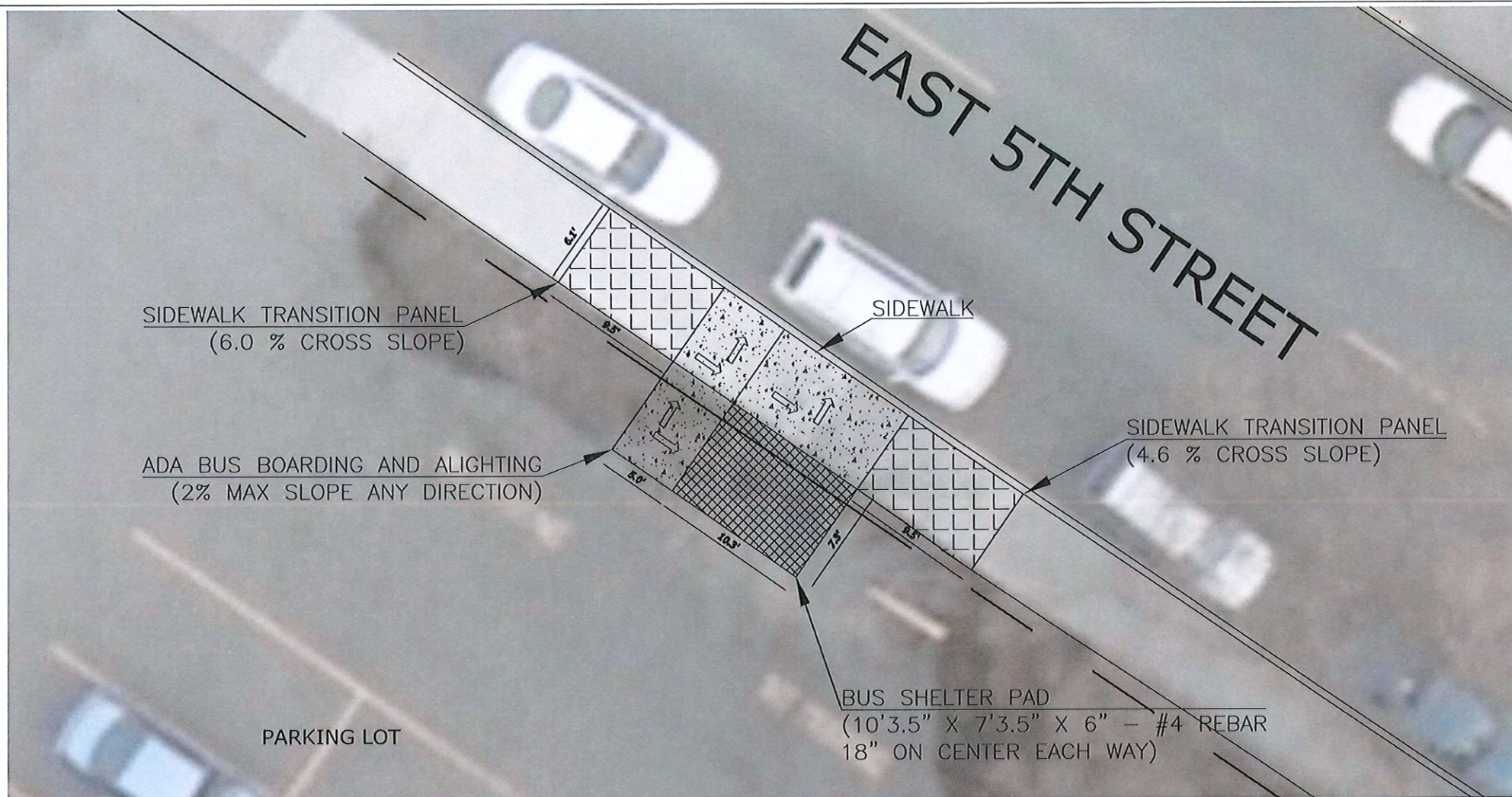

NO.	DATE	REVISIONS

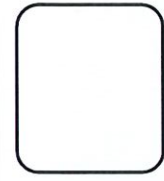

**CITY OF THE DALLES**  
 PUBLIC WORKS DEPARTMENT  
 1215 West 1st Street  
 The Dalles, Oregon 97058  
 (541) 296-5401

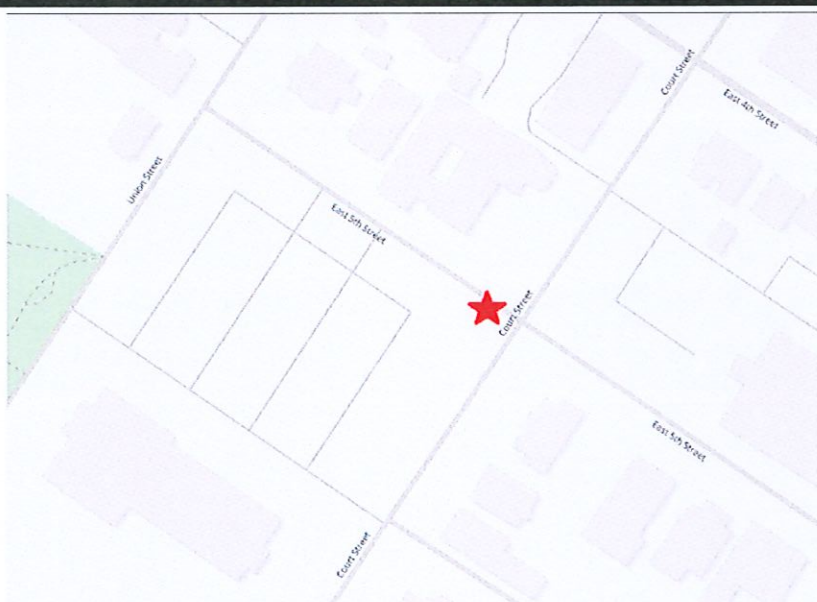

AREA MAP



NOT TO SCALE

**NOTES**

1. ALL WORK AND MATERIALS SHALL CONFORM TO THE CURRENT CITY OF THE DALLES SPECIFICATIONS AND DRAWINGS. COPIES CAN BE DOWNLOADED FROM THE CITY'S WEBSITE AT [WWW.CI.THE-DALLES.OR.US/ENGINEERING](http://WWW.CI.THE-DALLES.OR.US/ENGINEERING)

A LAYOUT PLAN FOR:  
**EAST 5TH ST. AND COURT ST.**  
**BUS STOP**  
 THE DALLES, OREGON

NAME	TMS
DATE	9/13/2023
SCALE	1" = 10'
CHECKED	
SHEET	1
OF	1 SHEETS
JOB NO.	



# CERTIFICATE OF LIABILITY INSURANCE

DATE (MM/DD/YYYY)

9/21/2023

THIS CERTIFICATE IS ISSUED AS A MATTER OF INFORMATION ONLY AND CONFERS NO RIGHTS UPON THE CERTIFICATE HOLDER. THIS CERTIFICATE DOES NOT AFFIRMATIVELY OR NEGATIVELY AMEND, EXTEND OR ALTER THE COVERAGE AFFORDED BY THE POLICIES BELOW. THIS CERTIFICATE OF INSURANCE DOES NOT CONSTITUTE A CONTRACT BETWEEN THE ISSUING INSURER(S), AUTHORIZED REPRESENTATIVE OR PRODUCER, AND THE CERTIFICATE HOLDER.

**IMPORTANT:** If the certificate holder is an ADDITIONAL INSURED, the policy(ies) must have ADDITIONAL INSURED provisions or be endorsed. If SUBROGATION IS WAIVED, subject to the terms and conditions of the policy, certain policies may require an endorsement. A statement on this certificate does not confer rights to the certificate holder in lieu of such endorsement(s).

<b>PRODUCER</b> LaPorte & Associates, Inc. 5515 SE MILWAUKIE AVENUE Portland OR 97202	<b>CONTACT NAME:</b> Torri Tjensvold	
	<b>PHONE (A/C. No. Ext):</b> 971-404-3759	<b>FAX (A/C. No.):</b> 503-231-9021
<b>E-MAIL ADDRESS:</b> ttjensvold@laporte-insurance.com		
<b>INSURER(S) AFFORDING COVERAGE</b>		<b>NAIC #</b>
<b>INSURER A:</b> Ohio Security Insurance Co.		24082
<b>INSURER B:</b> The Ohio Casualty Insurance Co		24074
<b>INSURER C:</b> SAIF Corporation		36196
<b>INSURER D:</b>		
<b>INSURER E:</b>		
<b>INSURER F:</b>		

**COVERAGES**

CERTIFICATE NUMBER: 1179724834

REVISION NUMBER:

THIS IS TO CERTIFY THAT THE POLICIES OF INSURANCE LISTED BELOW HAVE BEEN ISSUED TO THE INSURED NAMED ABOVE FOR THE POLICY PERIOD INDICATED. NOTWITHSTANDING ANY REQUIREMENT, TERM OR CONDITION OF ANY CONTRACT OR OTHER DOCUMENT WITH RESPECT TO WHICH THIS CERTIFICATE MAY BE ISSUED OR MAY PERTAIN, THE INSURANCE AFFORDED BY THE POLICIES DESCRIBED HEREIN IS SUBJECT TO ALL THE TERMS, EXCLUSIONS AND CONDITIONS OF SUCH POLICIES. LIMITS SHOWN MAY HAVE BEEN REDUCED BY PAID CLAIMS.

INSR LTR	TYPE OF INSURANCE	ADDL INSD	SUBR WVD	POLICY NUMBER	POLICY EFF (MM/DD/YYYY)	POLICY EXP (MM/DD/YYYY)	LIMITS
A	<input checked="" type="checkbox"/> COMMERCIAL GENERAL LIABILITY <input type="checkbox"/> CLAIMS-MADE <input checked="" type="checkbox"/> OCCUR GEN'L AGGREGATE LIMIT APPLIES PER: <input type="checkbox"/> POLICY <input checked="" type="checkbox"/> PRO-JECT <input checked="" type="checkbox"/> LOC <input type="checkbox"/> OTHER:	Y	Y	BKS54787403	4/27/2023	4/27/2024	EACH OCCURRENCE \$ 1,000,000 DAMAGE TO RENTED PREMISES (Ea occurrence) \$ 1,000,000 MED EXP (Any one person) \$ 15,000 PERSONAL & ADV INJURY \$ 1,000,000 GENERAL AGGREGATE \$ 2,000,000 PRODUCTS - COMP/OP AGG \$ 2,000,000 WA Stop Gap \$ 1,000,000
A	<input checked="" type="checkbox"/> AUTOMOBILE LIABILITY <input checked="" type="checkbox"/> ANY AUTO <input type="checkbox"/> OWNED AUTOS ONLY <input type="checkbox"/> SCHEDULED AUTOS <input checked="" type="checkbox"/> HIRED AUTOS ONLY <input checked="" type="checkbox"/> NON-OWNED AUTOS ONLY	Y	Y	BAS54787403	4/27/2023	4/27/2024	COMBINED SINGLE LIMIT (Ea accident) \$ 1,000,000 BODILY INJURY (Per person) \$ BODILY INJURY (Per accident) \$ PROPERTY DAMAGE (Per accident) \$ \$
B	<input checked="" type="checkbox"/> UMBRELLA LIAB <input checked="" type="checkbox"/> OCCUR <input type="checkbox"/> EXCESS LIAB <input type="checkbox"/> CLAIMS-MADE <input type="checkbox"/> DED <input checked="" type="checkbox"/> RETENTION \$ 10,000			USO54787403	4/27/2023	4/27/2024	EACH OCCURRENCE \$ 3,000,000 AGGREGATE \$ 3,000,000 \$
C	<b>WORKERS COMPENSATION AND EMPLOYERS' LIABILITY</b> ANY PROPRIETOR/PARTNER/EXECUTIVE OFFICER/MEMBER EXCLUDED? (Mandatory in NH) If yes, describe under DESCRIPTION OF OPERATIONS below	Y/N	N/A	945895	10/1/2023	10/1/2024	<input checked="" type="checkbox"/> PER STATUTE <input type="checkbox"/> OTH-ER E.L. EACH ACCIDENT \$ 1,000,000 E.L. DISEASE - EA EMPLOYEE \$ 1,000,000 E.L. DISEASE - POLICY LIMIT \$ 1,000,000
A	Leased/Rented Equipment			BKS54787403	4/27/2023	4/27/2024	\$500 Deductible 200,000

DESCRIPTION OF OPERATIONS / LOCATIONS / VEHICLES (ACORD 101, Additional Remarks Schedule, may be attached if more space is required)

Certificate Holder and all required entities are additional insured when required by written contract. Endorsements attached.

**CERTIFICATE HOLDER****CANCELLATION**

Mid-Columbia Economic Development District  
 802 Chenoweth Loop Road  
 The Dalles OR 97058

SHOULD ANY OF THE ABOVE DESCRIBED POLICIES BE CANCELLED BEFORE THE EXPIRATION DATE THEREOF, NOTICE WILL BE DELIVERED IN ACCORDANCE WITH THE POLICY PROVISIONS.

AUTHORIZED REPRESENTATIVE

© 1988-2015 ACORD CORPORATION. All rights reserved.

THIS ENDORSEMENT CHANGES THE POLICY. PLEASE READ IT CAREFULLY.

## COMMERCIAL GENERAL LIABILITY EXTENSION

This endorsement modifies insurance provided under the following:

COMMERCIAL GENERAL LIABILITY COVERAGE PART

### INDEX

<u>SUBJECT</u>	<u>PAGE</u>
NON-OWNED AIRCRAFT	2
NON-OWNED WATERCRAFT	2
PROPERTY DAMAGE LIABILITY - ELEVATORS	2
EXTENDED DAMAGE TO PROPERTY RENTED TO YOU (Tenant's Property Damage)	2
MEDICAL PAYMENTS EXTENSION	3
EXTENSION OF SUPPLEMENTARY PAYMENTS - COVERAGES A AND B	3
ADDITIONAL INSUREDS - BY CONTRACT, AGREEMENT OR PERMIT	3
PRIMARY AND NON-CONTRIBUTORY- ADDITIONAL INSURED EXTENSION	5
ADDITIONAL INSUREDS - EXTENDED PROTECTION OF YOUR "LIMITS OF INSURANCE"	6
WHO IS AN INSURED - INCIDENTAL MEDICAL ERRORS/MALPRACTICE AND WHO IS AN INSURED - FELLOW EMPLOYEE EXTENSION - MANAGEMENT EMPLOYEES	6
NEWLY FORMED OR ADDITIONALLY ACQUIRED ENTITIES	7
FAILURE TO DISCLOSE HAZARDS AND PRIOR OCCURRENCES	7
KNOWLEDGE OF OCCURRENCE, OFFENSE, CLAIM OR SUIT	7
LIBERALIZATION CLAUSE	7
BODILY INJURY REDEFINED	7
EXTENDED PROPERTY DAMAGE	8
WAIVER OF TRANSFER OF RIGHTS OF RECOVERY AGAINST OTHERS TO US - WHEN REQUIRED IN A CONTRACT OR AGREEMENT WITH YOU	8

With respect to coverage afforded by this endorsement, the provisions of the policy apply unless modified by the endorsement.

#### A. NON-OWNED AIRCRAFT

Under Paragraph 2. Exclusions of Section I - Coverage A - Bodily Injury And Property Damage Liability, exclusion g. Aircraft, Auto Or Watercraft does not apply to an aircraft provided:

1. It is not owned by any insured;
2. It is hired, chartered or loaned with a trained paid crew;
3. The pilot in command holds a currently effective certificate, issued by the duly constituted authority of the United States of America or Canada, designating her or him a commercial or airline pilot; and
4. It is not being used to carry persons or property for a charge.

However, the insurance afforded by this provision does not apply if there is available to the insured other valid and collectible insurance, whether primary, excess (other than insurance written to apply specifically in excess of this policy), contingent or on any other basis, that would also apply to the loss covered under this provision.

#### B. NON-OWNED WATERCRAFT

Under Paragraph 2. Exclusions of Section I - Coverage A - Bodily Injury And Property Damage Liability, Subparagraph (2) of exclusion g. Aircraft, Auto Or Watercraft is replaced by the following:

This exclusion does not apply to:

- (2) A watercraft you do not own that is:
  - (a) Less than 52 feet long; and
  - (b) Not being used to carry persons or property for a charge.

#### C. PROPERTY DAMAGE LIABILITY - ELEVATORS

1. Under Paragraph 2. Exclusions of Section I - Coverage A - Bodily Injury And Property Damage Liability, Subparagraphs (3), (4) and (6) of exclusion j. Damage To Property do not apply if such "property damage" results from the use of elevators. For the purpose of this provision, elevators do not include vehicle lifts. Vehicle lifts are lifts or hoists used in automobile service or repair operations.

2. The following is added to Section IV - Commercial General Liability Conditions, Condition 4. Other Insurance, Paragraph b. Excess Insurance:

The insurance afforded by this provision of this endorsement is excess over any property insurance, whether primary, excess, contingent or on any other basis.

#### D. EXTENDED DAMAGE TO PROPERTY RENTED TO YOU (Tenant's Property Damage)

If Damage To Premises Rented To You is not otherwise excluded from this Coverage Part:

1. Under Paragraph 2. Exclusions of Section I - Coverage A - Bodily Injury and Property Damage Liability:

a. The fourth from the last paragraph of exclusion j. Damage To Property is replaced by the following:

Paragraphs (1), (3) and (4) of this exclusion do not apply to "property damage" (other than damage by fire, lightning, explosion, smoke, or leakage from an automatic fire protection system) to:

- (i) Premises rented to you for a period of 7 or fewer consecutive days; or
- (ii) Contents that you rent or lease as part of a premises rental or lease agreement for a period of more than 7 days.

Paragraphs (1), (3) and (4) of this exclusion do not apply to "property damage" to contents of premises rented to you for a period of 7 or fewer consecutive days.

A separate limit of insurance applies to this coverage as described in Section III - Limits of Insurance.

- b. The last paragraph of subsection **2. Exclusions** is replaced by the following:

Exclusions **c.** through **n.** do not apply to damage by fire, lightning, explosion, smoke or leakage from automatic fire protection systems to premises while rented to you or temporarily occupied by you with permission of the owner. A separate limit of insurance applies to Damage To Premises Rented To You as described in **Section III - Limits Of Insurance.**

2. Paragraph **6.** under **Section III - Limits Of Insurance** is replaced by the following:

6. Subject to Paragraph **5.** above, the Damage To Premises Rented To You Limit is the most we will pay under Coverage **A** for damages because of "property damage" to:

- a. Any one premise:

(1) While rented to you; or

(2) While rented to you or temporarily occupied by you with permission of the owner for damage by fire, lightning, explosion, smoke or leakage from automatic protection systems; or

- b. Contents that you rent or lease as part of a premises rental or lease agreement.

3. As regards coverage provided by this provision **D. EXTENDED DAMAGE TO PROPERTY RENTED TO YOU (Tenant's Property Damage)** - Paragraph **9.a.** of **Definitions** is replaced with the following:

- 9.a.** A contract for a lease of premises. However, that portion of the contract for a lease of premises that indemnifies any person or organization for damage by fire, lightning, explosion, smoke, or leakage from automatic fire protection systems to premises while rented to you or temporarily occupied by you with the permission of the owner, or for damage to contents of such premises that are included in your premises rental or lease agreement, is not an "insured contract".

#### **E. MEDICAL PAYMENTS EXTENSION**

If **Coverage C Medical Payments** is not otherwise excluded, the Medical Payments provided by this policy are amended as follows:

Under Paragraph **1. Insuring Agreement** of **Section I - Coverage C - Medical Payments**, Subparagraph **(b)** of Paragraph **a.** is replaced by the following:

- (b)** The expenses are incurred and reported within three years of the date of the accident; and

#### **F. EXTENSION OF SUPPLEMENTARY PAYMENTS - COVERAGES A AND B**

1. Under **Supplementary Payments - Coverages A and B**, Paragraph **1.b.** is replaced by the following:

- b. Up to **\$3,000** for cost of bail bonds required because of accidents or traffic law violations arising out of the use of any vehicle to which the Bodily Injury Liability Coverage applies. We do not have to furnish these bonds.

2. Paragraph **1.d.** is replaced by the following:

- d. All reasonable expenses incurred by the insured at our request to assist us in the investigation or defense of the claim or "suit", including actual loss of earnings up to **\$500** a day because of time off from work.

#### **G. ADDITIONAL INSUREDS - BY CONTRACT, AGREEMENT OR PERMIT**

1. Paragraph **2.** under **Section II - Who Is An Insured** is amended to include as an insured any person or organization whom you have agreed to add as an additional insured in a written contract, written agreement or permit. Such person or organization is an additional insured but only with respect to liability for "bodily injury", "property damage" or "personal and advertising injury" caused in whole or in part by:

- a. Your acts or omissions, or the acts or omissions of those acting on your behalf, in the performance of your on going operations for the additional insured that are the subject of the written contract or written agreement provided that the "bodily injury" or "property damage" occurs, or the "personal and advertising injury" is committed, subsequent to the signing of such written contract or written agreement; or



221

of 202

87

- b. Premises or facilities rented by you or used by you; or
- c. The maintenance, operation or use by you of equipment rented or leased to you by such person or organization; or
- d. Operations performed by you or on your behalf for which the state or political subdivision has issued a permit subject to the following additional provisions:
  - (1) This insurance does not apply to "bodily injury", "property damage", or "personal and advertising injury" arising out of the operations performed for the state or political subdivision;
  - (2) This insurance does not apply to "bodily injury" or "property damage" included within the "completed operations hazard".
  - (3) Insurance applies to premises you own, rent, or control but only with respect to the following hazards:
    - (a) The existence, maintenance, repair, construction, erection, or removal of advertising signs, awnings, canopies, cellar entrances, coal holes, driveways, manholes, marquees, hoist away openings, sidewalk vaults, street banners, or decorations and similar exposures; or
    - (b) The construction, erection, or removal of elevators; or
    - (c) The ownership, maintenance, or use of any elevators covered by this insurance.

However:

- 1. The insurance afforded to such additional insured only applies to the extent permitted by law; and
- 2. If coverage provided to the additional insured is required by a contract or agreement, the insurance afforded to such additional insured will not be broader than that which you are required by the contract or agreement to provide for such additional insured.

With respect to Paragraph 1.a. above, a person's or organization's status as an additional insured under this endorsement ends when:

- (1) All work, including materials, parts or equipment furnished in connection with such work, on the project (other than service, maintenance or repairs) to be performed by or on behalf of the additional insured(s) at the location of the covered operations has been completed; or
- (2) That portion of "your work" out of which the injury or damage arises has been put to its intended use by any person or organization other than another contractor or subcontractor engaged in performing operations for a principal as a part of the same project.

With respect to Paragraph 1.b. above, a person's or organization's status as an additional insured under this endorsement ends when their written contract or written agreement with you for such premises or facilities ends.

With respects to Paragraph 1.c. above, this insurance does not apply to any "occurrence" which takes place after the equipment rental or lease agreement has expired or you have returned such equipment to the lessor.

The insurance provided by this endorsement applies only if the written contract or written agreement is signed prior to the "bodily injury" or "property damage".

We have no duty to defend an additional insured under this endorsement until we receive written notice of a "suit" by the additional insured as required in Paragraph b. of Condition 2. **Duties In the Event Of Occurrence, Offense, Claim Or Suit** under **Section IV - Commercial General Liability Conditions**.

2. With respect to the insurance provided by this endorsement, the following are added to Paragraph 2. **Exclusions under Section I - Coverage A - Bodily Injury And Property Damage Liability:**

This insurance does not apply to:

- a. "Bodily injury" or "property damage" arising from the sole negligence of the additional insured.
- b. "Bodily injury" or "property damage" that occurs prior to you commencing operations at the location where such "bodily injury" or "property damage" occurs.
- c. "Bodily injury", "property damage" or "personal and advertising injury" arising out of the rendering of, or the failure to render, any professional architectural, engineering or surveying services, including:
  - (1) The preparing, approving, or failing to prepare or approve, maps, shop drawings, opinions, reports, surveys, field orders, change orders or drawings and specifications; or
  - (2) Supervisory, inspection, architectural or engineering activities.

This exclusion applies even if the claims against any insured allege negligence or other wrongdoing in the supervision, hiring, employment, training or monitoring of others by that insured, if the "occurrence" which caused the "bodily injury" or "property damage", or the offense which caused the "personal and advertising injury", involved the rendering of, or the failure to render, any professional architectural, engineering or surveying services.

- d. "Bodily injury" or "property damage" occurring after:
  - (1) All work, including materials, parts or equipment furnished in connection with such work, on the project (other than service, maintenance or repairs) to be performed by or on behalf of the additional insured(s) at the location of the covered operations has been completed; or
  - (2) That portion of "your work" out of which the injury or damage arises has been put to its intended use by any person or organization other than another contractor or subcontractor engaged in performing operations for a principal as a part of the same project.
- e. Any person or organization specifically designated as an additional insured for ongoing operations by a separate **ADDITIONAL INSURED -OWNERS, LESSEES OR CONTRACTORS** endorsement issued by us and made a part of this policy.

3. With respect to the insurance afforded to these additional insureds, the following is added to **Section III - Limits Of Insurance:**

If coverage provided to the additional insured is required by a contract or agreement, the most we will pay on behalf of the additional insured is the amount of insurance:

- a. Required by the contract or agreement; or
- b. Available under the applicable Limits of Insurance shown in the Declarations; whichever is less.

This endorsement shall not increase the applicable Limits of Insurance shown in the Declarations.

**H. PRIMARY AND NON-CONTRIBUTORY ADDITIONAL INSURED EXTENSION**

This provision applies to any person or organization who qualifies as an additional insured under any form or endorsement under this policy.

Condition 4. **Other Insurance of SECTION IV - COMMERCIAL GENERAL LIABILITY CONDITIONS** is amended as follows:

- a. The following is added to Paragraph a. **Primary Insurance:**

If an additional insured's policy has an Other Insurance provision making its policy excess, and you have agreed in a written contract or written agreement to provide the additional insured coverage on a primary and noncontributory basis, this policy shall be primary and we will not seek contribution from the additional insured's policy for damages we cover.



**b.** The following is added to Paragraph **b. Excess Insurance**:

When a written contract or written agreement, other than a premises lease, facilities rental contract or agreement, an equipment rental or lease contract or agreement, or permit issued by a state or political subdivision between you and an additional insured does not require this insurance to be primary or primary and non-contributory, this insurance is excess over any other insurance for which the additional insured is designated as a Named Insured.

Regardless of the written agreement between you and an additional insured, this insurance is excess over any other insurance whether primary, excess, contingent or on any other basis for which the additional insured has been added as an additional insured on other policies.

**I. ADDITIONAL INSUREDS - EXTENDED PROTECTION OF YOUR "LIMITS OF INSURANCE"**

This provision applies to any person or organization who qualifies as an additional insured under any form or endorsement under this policy.

**1.** The following is added to Condition **2. Duties In The Event Of Occurrence, Offense, Claim or Suit**:

An additional insured under this endorsement will as soon as practicable:

- a.** Give written notice of an "occurrence" or an offense that may result in a claim or "suit" under this insurance to us;
- b.** Tender the defense and indemnity of any claim or "suit" to all insurers whom also have insurance available to the additional insured; and
- c.** Agree to make available any other insurance which the additional insured has for a loss we cover under this Coverage Part.
- d.** We have no duty to defend or indemnify an additional insured under this endorsement until we receive written notice of a "suit" by the additional insured.

**2.** The limits of insurance applicable to the additional insured are those specified in a written contract or written agreement or the limits of insurance as stated in the Declarations of this policy and defined in **Section III - Limits of Insurance** of this policy, whichever are less. These limits are inclusive of and not in addition to the limits of insurance available under this policy.

**J. WHO IS AN INSURED - INCIDENTAL MEDICAL ERRORS / MALPRACTICE  
WHO IS AN INSURED - FELLOW EMPLOYEE EXTENSION - MANAGEMENT EMPLOYEES**

Paragraph **2.a.(1)** of **Section II - Who Is An Insured** is replaced with the following:

**(1)** "Bodily injury" or "personal and advertising injury":

- (a)** To you, to your partners or members (if you are a partnership or joint venture), to your members (if you are a limited liability company), to a co-"employee" while in the course of his or her employment or performing duties related to the conduct of your business, or to your other "volunteer workers" while performing duties related to the conduct of your business;
- (b)** To the spouse, child, parent, brother or sister of that co-"employee" or "volunteer worker" as a consequence of Paragraph **(1) (a)** above;
- (c)** For which there is any obligation to share damages with or repay someone else who must pay damages because of the injury described in Paragraphs **(1) (a)** or **(b)** above; or
- (d)** Arising out of his or her providing or failing to provide professional health care services. However, if you are not in the business of providing professional health care services or providing professional health care personnel to others, or if coverage for providing professional health care services is not otherwise excluded by separate endorsement, this provision (Paragraph **(d)**) does not apply.

Paragraphs **(a)** and **(b)** above do not apply to "bodily injury" or "personal and advertising injury" caused by an "employee" who is acting in a supervisory capacity for you. Supervisory capacity as used herein means the "employee's" job responsibilities assigned by you, includes the direct supervision of other "employees" of yours. However, none of these "employees" are insureds for "bodily injury" or "personal and

advertising injury" arising out of their willful conduct, which is defined as the purposeful or willful intent to cause "bodily injury" or "personal and advertising injury", or caused in whole or in part by their intoxication by liquor or controlled substances.

The coverage provided by provision J. is excess over any other valid and collectable insurance available to your "employee".

**K. NEWLY FORMED OR ADDITIONALLY ACQUIRED ENTITIES**

Paragraph 3. of Section II - Who Is An Insured is replaced by the following:

3. Any organization you newly acquire or form and over which you maintain ownership or majority interest, will qualify as a Named Insured if there is no other similar insurance available to that organization. However:
  - a. Coverage under this provision is afforded only until the expiration of the policy period in which the entity was acquired or formed by you;
  - b. Coverage A does not apply to "bodily injury" or "property damage" that occurred before you acquired or formed the organization; and
  - c. Coverage B does not apply to "personal and advertising injury" arising out of an offense committed before you acquired or formed the organization.
  - d. Records and descriptions of operations must be maintained by the first Named Insured.

No person or organization is an insured with respect to the conduct of any current or past partnership, joint venture or limited liability company that is not shown as a Named Insured in the Declarations or qualifies as an insured under this provision.

**L. FAILURE TO DISCLOSE HAZARDS AND PRIOR OCCURRENCES**

Under Section IV - Commercial General Liability Conditions, the following is added to Condition 6. Representations:

Your failure to disclose all hazards or prior "occurrences" existing as of the inception date of the policy shall not prejudice the coverage afforded by this policy provided such failure to disclose all hazards or prior "occurrences" is not intentional.

**M. KNOWLEDGE OF OCCURRENCE, OFFENSE, CLAIM OR SUIT**

Under Section IV - Commercial General Liability Conditions, the following is added to Condition 2. Duties In The Event of Occurrence, Offense, Claim Or Suit:

Knowledge of an "occurrence", offense, claim or "suit" by an agent, servant or "employee" of any insured shall not in itself constitute knowledge of the insured unless an insured listed under Paragraph 1. of Section II - Who Is An Insured or a person who has been designated by them to receive reports of "occurrences", offenses, claims or "suits" shall have received such notice from the agent, servant or "employee".

**N. LIBERALIZATION CLAUSE**

If we revise this Commercial General Liability Extension Endorsement to provide more coverage without additional premium charge, your policy will automatically provide the coverage as of the day the revision is effective in your state.

**O. BODILY INJURY REDEFINED**

Under Section V - Definitions, Definition 3. is replaced by the following:

3. "Bodily Injury" means physical injury, sickness or disease sustained by a person. This includes mental anguish, mental injury, shock, fright or death that results from such physical injury, sickness or disease.



54767403

002519

221

of 202

91

**P. EXTENDED PROPERTY DAMAGE**

**Exclusion a. of COVERAGE A. BODILY INJURY AND PROPERTY DAMAGE LIABILITY** is replaced by the following:

**a. Expected Or Intended Injury**

"Bodily injury" or "property damage" expected or intended from the standpoint of the insured. This exclusion does not apply to "bodily injury" or "property damage" resulting from the use of reasonable force to protect persons or property.

**Q. WAIVER OF TRANSFER OF RIGHTS OF RECOVERY AGAINST OTHERS TO US - WHEN REQUIRED IN A CONTRACT OR AGREEMENT WITH YOU**

Under **Section IV - Commercial General Liability Conditions**, the following is added to Condition **8. Transfer Of Rights Of Recovery Against Others To Us**:

We waive any right of recovery we may have against a person or organization because of payments we make for injury or damage arising out of your ongoing operations or "your work" done under a contract with that person or organization and included in the "products-completed operations hazard" provided:

1. You and that person or organization have agreed in writing in a contract or agreement that you waive such rights against that person or organization; and
2. The injury or damage occurs subsequent to the execution of the written contract or written agreement.

**THIS ENDORSEMENT CHANGES THE POLICY. PLEASE READ IT CAREFULLY.**  
**BUSINESS AUTO COVERAGE ENHANCEMENT ENDORSEMENT**

This endorsement modifies insurance provided under the following:

**BUSINESS AUTO COVERAGE FORM**

With respect to coverage afforded by this endorsement, the provisions of the policy apply unless modified by the endorsement.

If the policy to which this endorsement is attached also contains a Business Auto Coverage Enhancement Endorsement with a specific state named in the title, this endorsement does not apply to vehicles garaged in that specified state.

**COVERAGE INDEX**

<u>SUBJECT</u>	<u>PROVISION NUMBER</u>
ACCIDENTAL AIRBAG DEPLOYMENT	13
ADDITIONAL INSURED BY CONTRACT, AGREEMENT OR PERMIT	4
AMENDED DUTIES IN THE EVENT OF ACCIDENT, CLAIM, SUIT OR LOSS	21
AMENDED FELLOW EMPLOYEE EXCLUSION	6
AUDIO, VISUAL AND DATA ELECTRONIC EQUIPMENT COVERAGE	15
BODILY INJURY REDEFINED	25
EMPLOYEES AS INSUREDS (Including Employee Hired Auto)	3
EXTRA EXPENSE - BROADENED COVERAGE	11
GLASS REPAIR - WAIVER OF DEDUCTIBLE	17
HIRED AUTO COVERAGE TERRITORY	23
HIRED AUTO PHYSICAL DAMAGE (Including Employee Hired Auto)	7
LOAN / LEASE GAP (Coverage Not Available In New York)	16
NEWLY FORMED OR ACQUIRED SUBSIDIARIES	2
PARKED AUTO COLLISION COVERAGE (WAIVER OF DEDUCTIBLE)	18
PERSONAL EFFECTS COVERAGE	12
PHYSICAL DAMAGE - ADDITIONAL TRANSPORTATION EXPENSE COVERAGE	9
PHYSICAL DAMAGE DEDUCTIBLE - VEHICLE TRACKING SYSTEM	14
PRIMARY AND NON-CONTRIBUTORY - WRITTEN CONTRACT OR WRITTEN AGREEMENT	24
RENTAL REIMBURSEMENT	10
SUPPLEMENTARY PAYMENTS	5
TOWING AND LABOR	8
TRAILERS - INCREASED LOAD CAPACITY	1
TWO OR MORE DEDUCTIBLES	19
UNINTENTIONAL FAILURE TO DISCLOSE HAZARDS	20
WAIVER OF TRANSFER OF RIGHTS OF RECOVERY AGAINST OTHERS TO US	22

**SECTION I - COVERED AUTOS** is amended as follows:

**1. TRAILERS - INCREASED LOAD CAPACITY**

The following replaces Paragraph **C.1. Certain Trailers, Mobile Equipment And Temporary Substitute Autos** of **SECTION I - COVERED AUTOS**:

"Trailers" with a load capacity of 3,000 pounds or less designed primarily for travel on public roads.

**SECTION II - LIABILITY COVERAGE** is amended as follows:

**2. NEWLY FORMED OR ACQUIRED SUBSIDIARIES**

**SECTION II - LIABILITY COVERAGE, Paragraph A.1. - Who Is An Insured** is amended to include the following as an "insured":

d. Any legally incorporated subsidiary of which you own more than 50 percent interest during the policy period. Coverage is afforded only for 90 days from the date of acquisition or formation. However, "insured" does not include any organization that:

- (1) Is a partnership or joint venture; or
- (2) Is an "insured" under any other automobile policy except a policy written specifically to apply in excess of this policy; or
- (3) Has exhausted its Limit of Insurance or had its policy terminated under any other automobile policy.

Coverage under this provision d. does not apply to "bodily injury" or "property damage" that occurred before you acquired or formed the organization.

**3. EMPLOYEES AS INSURED**

**SECTION II - LIABILITY COVERAGE, Paragraph A.1. Who Is An Insured** is amended to include the following as an "insured":

- e. Any "employee" of yours while using a covered "auto" you do not own, hire or borrow but only for acts within the scope of their employment by you. Insurance provided by this endorsement is excess over any other insurance available to any "employee".
- f. Any "employee" of yours while operating an "auto" hired or borrowed under a written contract or agreement in that "employee's" name, with your permission, while performing duties related to the conduct of your business and within the scope of their employment. Insurance provided by this endorsement is excess over any other insurance available to the "employee".

**4. ADDITIONAL INSURED BY CONTRACT, AGREEMENT OR PERMIT**

**SECTION II - LIABILITY COVERAGE, Paragraph A.1. Who Is An Insured** is amended to include the following as an "insured":

g. Any person or organization with respect to the operation, maintenance or use of a covered "auto", provided that you and such person or organization have agreed in a written contract, written agreement, or permit issued to you by governmental or public authority, to add such person, or organization, or governmental or public authority to this policy as an "insured".

However, such person or organization is an "insured":

- (1) Only with respect to the operation, maintenance or use of a covered "auto";
- (2) Only for "bodily injury" or "property damage" caused by an "accident" which takes place after you executed the written contract or written agreement, or the permit has been issued to you; and
- (3) Only for the duration of that contract, agreement or permit.

The "insured" is required to submit a claim to any other insurer to which coverage could apply for defense and indemnity. Unless the "insured" has agreed in writing to primary noncontributory wording per enhancement number 24, this policy is excess over any other collectible insurance.

**5. SUPPLEMENTARY PAYMENTS**

**SECTION II - LIABILITY COVERAGE, Coverage Extensions, 2.a. Supplementary Payments, Paragraphs (2) and (4)** are replaced by the following:

- (2) Up to \$3,000 for cost of bail bonds (including bonds for related traffic violations ) required because of an "accident" we cover. We do not have to furnish these bonds.
- (4) All reasonable expenses incurred by the "insured" at our request, including actual loss of earnings up to \$500 a day because of time off from work.

**6. AMENDED FELLOW EMPLOYEE EXCLUSION**

In those jurisdictions where, by law, fellow "employees" are not entitled to the protection afforded to the employer by the workers compensation exclusivity rule, or similar protection, the following provision is added:

**SECTION II - LIABILITY, Exclusion B.5. Fellow Employee** does not apply if the "bodily injury" results from the use of a covered "auto" you own or hire if you have workers compensation insurance in force for all of your "employees" at the time of "loss".

This coverage is excess over any other collectible insurance.

**SECTION III - PHYSICAL DAMAGE COVERAGE** is amended as follows:

**7. HIRED AUTO PHYSICAL DAMAGE**

Paragraph **A.4. Coverage Extensions of SECTION III - PHYSICAL DAMAGE COVERAGE**, is amended by adding the following:

If hired "autos" are covered "autos" for Liability Coverage, and if Comprehensive, Specified Causes of Loss or Collision coverage are provided under the Business Auto Coverage Form for any "auto" you own, then the Physical Damage coverages provided are extended to "autos":

- a. You hire, rent or borrow; or
- b. Your "employee" hires or rents under a written contract or agreement in that "employee's" name, but only if the damage occurs while the vehicle is being used in the conduct of your business, subject to the following limit and deductible:
  - a. The most we will pay for "loss" in any one "accident" or "loss" is the smallest of:
    - (1) \$50,000; or
    - (2) The actual cash value of the damaged or stolen property as of the time of the "loss"; or
    - (3) The cost of repairing or replacing the damaged or stolen property with other property of like kind and quality, minus a deductible.
  - b. The deductible will be equal to the largest deductible applicable to any owned "auto" for that coverage.
  - c. Subject to the limit, deductible and excess provisions described in this provision, we will provide coverage equal to the broadest coverage applicable to any covered "auto" you own.
  - d. Subject to a maximum of \$1,000 per "accident", we will also cover the actual loss of use of the hired "auto" if it results from an "accident", you are legally liable and the lessor incurs an actual financial loss.
  - e. This coverage extension does not apply to:
    - (1) Any "auto" that is hired, rented or borrowed with a driver; or
    - (2) Any "auto" that is hired, rented or borrowed from your "employee" or any member of your "employee's" household.

Coverage provided under this extension is excess over any other collectible insurance available at the time of "loss".

**8. TOWING AND LABOR**

**SECTION III - PHYSICAL DAMAGE COVERAGE**, Paragraph **A.2. Towing**, is amended by the addition of the following:

We will pay towing and labor costs incurred, up to the limits shown below, each time a covered "auto" classified and rated as a private passenger type, "light truck" or "medium truck" is disabled:

- a. For private passenger type vehicles, we will pay up to \$75 per disablement.
- b. For "light trucks", we will pay up to \$75 per disablement. "Light trucks" are trucks that have a gross vehicle weight (GVW) of 10,000 pounds or less.
- c. For "medium trucks", we will pay up to \$150 per disablement. "Medium trucks" are trucks that have a gross vehicle weight (GVW) of 10,001 - 20,000 pounds.

However, the labor must be performed at the place of disablement.

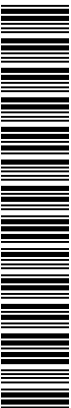

54787403

003426

221

of 76

37

**9. PHYSICAL DAMAGE - ADDITIONAL TRANSPORTATION EXPENSE COVERAGE**

Paragraph **A.4.a. Coverage Extensions, Transportation Expenses** of **SECTION III - PHYSICAL DAMAGE COVERAGE**, is amended to provide a limit of \$50 per day and a maximum limit of \$1,500.

**10. RENTAL REIMBURSEMENT**

**SECTION III - PHYSICAL DAMAGE COVERAGE, A. Coverage**, is amended by adding the following:

- a. We will pay up to \$75 per day for rental reimbursement expenses incurred by you for the rental of an "auto" because of "accident" or "loss", to an "auto" for which we also pay a "loss" under Comprehensive, Specified Causes of Loss or Collision Coverages. We will pay only for those expenses incurred after the first 24 hours following the "accident" or "loss" to the covered "auto."
- b. Rental Reimbursement requires the rental of a comparable or lessor vehicle, which in many cases may be substantially less than \$75 per day, and will only be allowed for the period of time it should take to repair or replace the vehicle with reasonable speed and similar quality, up to a maximum of 30 days.
- c. We will also pay up to \$500 for reasonable and necessary expenses incurred by you to remove and replace your tools and equipment from the covered "auto". This limit is excess over any other collectible insurance.
- d. This coverage does not apply unless you have a business necessity that other "autos" available for your use and operation cannot fill.
- e. If "loss" results from the total theft of a covered "auto" of the private passenger type, we will pay under this coverage only that amount of your rental reimbursement expenses which is not already provided under Paragraph **4. Coverage Extension**.
- f. No deductible applies to this coverage.
- g. The insurance provided under this extension is excess over any other collectible insurance.

If this policy also provides Rental Reimbursement Coverage you purchased, the coverage provided by this Enhancement Endorsement is in addition to the coverage you purchased.

For the purposes of this endorsement provision, materials and equipment do not include "personal effects" as defined in provision **12.B**.

**11. EXTRA EXPENSE - BROADENED COVERAGE**

Under **SECTION III - PHYSICAL DAMAGE COVERAGE, A. Coverage**, we will pay for the expense of returning a stolen covered "auto" to you. The maximum amount we will pay is \$1,000.

**12. PERSONAL EFFECTS COVERAGE**

**A. SECTION III - PHYSICAL DAMAGE COVERAGE, A. Coverage**, is amended by adding the following:

If you have purchased Comprehensive Coverage on this policy for an "auto" you own and that "auto" is stolen, we will pay, without application of a deductible, up to \$600 for "personal effects" stolen with the "auto."

The insurance provided under this provision is excess over any other collectible insurance.

**B. SECTION V - DEFINITIONS** is amended by adding the following:

For the purposes of this provision, "personal effects" mean tangible property that is worn or carried by an "insured." "Personal effects" does not include tools, equipment, jewelry, money or securities.

**13. ACCIDENTAL AIRBAG DEPLOYMENT**

**SECTION III - PHYSICAL DAMAGE COVERAGE, B. Exclusions** is amended by adding the following:

If you have purchased Comprehensive or Collision Coverage under this policy, the exclusion for "loss" relating to mechanical breakdown does not apply to the accidental discharge of an airbag.

Any insurance we provide shall be excess over any other collectible insurance or reimbursement by manufacturer's warranty. However, we agree to pay any deductible applicable to the other coverage or warranty.

of 76  
38

**14. PHYSICAL DAMAGE DEDUCTIBLE - VEHICLE TRACKING SYSTEM**

**SECTION III - PHYSICAL DAMAGE COVERAGE, D. Deductible**, is amended by adding the following:

Any Comprehensive Deductible shown in the Declarations will be reduced by 50% for any "loss" caused by theft if the vehicle is equipped with a vehicle tracking device such as a radio tracking device or a global position device and that device was the method of recovery of the vehicle.

**15. AUDIO, VISUAL AND DATA ELECTRONIC EQUIPMENT COVERAGE**

**SECTION III - PHYSICAL DAMAGE COVERAGE, B. Exclusions**, Paragraph **a.** of the exception to exclusions **4.c.** and **4.d.** is deleted and replaced with the following:

Exclusions **4.c.** and **4.d.** do not apply to:

- a. Electronic equipment that receives or transmits audio, visual or data signals, whether or not designed solely for the reproduction of sound, if the equipment is:
  - (1) Permanently installed in the covered "auto" at the time of the "loss" or removable from a housing unit that is permanently installed in the covered "auto"; and
  - (2) Designed to be solely operated by use from the power from the "auto's" electrical system; and
  - (3) Physical damage coverages are provided for the covered "auto".

If the "loss" occurs solely to audio, visual or data electronic equipment or accessories used with this equipment, then our obligation to pay for, repair, return or replace damaged or stolen property will be reduced by a \$100 deductible.

**16. LOAN / LEASE GAP COVERAGE (Not Applicable In New York)**

**A. Paragraph C. Limit Of Insurance of SECTION III - PHYSICAL DAMAGE COVERAGE** is amended by adding the following:

The most we will pay for a "total loss" to a covered "auto" owned by or leased to you in any one "accident" is the greater of the:

- 1. Balance due under the terms of the loan or lease to which the damaged covered "auto" is subject at the time of the "loss" less the amount of:
  - a. Overdue payments and financial penalties associated with those payments as of the date of the "loss";
  - b. Financial penalties imposed under a lease due to high mileage, excessive use or abnormal wear and tear;
  - c. Costs for extended warranties, Credit Life Insurance, Health, Accident or Disability Insurance purchased with the loan or lease;
  - d. Transfer or rollover balances from previous loans or leases;
  - e. Final payment due under a "Balloon Loan";
  - f. The dollar amount of any unrepaired damage which occurred prior to the "total loss" of a covered "auto";
  - g. Security deposits not refunded by a lessor;
  - h. All refunds payable or paid to you as a result of the early termination of a lease agreement or as a result of the early termination of any warranty or extended service agreement on a covered "auto";
  - i. Any amount representing taxes;
  - j. Loan or lease termination fees; or
- 2. The actual cash value of the damage or stolen property as of the time of the "loss".  
An adjustment for depreciation and physical condition will be made in determining the actual cash value at the time of the "loss". This adjustment is not applicable in Texas.

**B. Additional Conditions**

This coverage applies only to the original loan for which the covered "auto" that incurred the "loss" serves as collateral, or lease written on the covered "auto" that incurred the "loss".

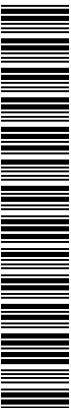

54767403

003426

221

of 76

39

**C. SECTION V - DEFINITIONS** is changed by adding the following:

As used in this endorsement provision, the following definitions apply:

"Total loss" means a "loss" in which the cost of repairs plus the salvage value exceeds the actual cash value.

A "balloon loan" is one with periodic payments that are insufficient to repay the balance over the term of the loan, thereby requiring a large final payment.

**17. GLASS REPAIR - WAIVER OF DEDUCTIBLE**

Paragraph **D. Deductible** of **SECTION III - PHYSICAL DAMAGE COVERAGE** is amended by the addition of the following:

No deductible applies to glass damage if the glass is repaired rather than replaced.

**18. PARKED AUTO COLLISION COVERAGE (WAIVER OF DEDUCTIBLE)**

Paragraph **D. Deductible** of **SECTION III - PHYSICAL DAMAGE COVERAGE** is amended by the addition of the following:

The deductible does not apply to "loss" caused by collision to such covered "auto" of the private passenger type or light weight truck with a gross vehicle weight of 10,000 lbs. or less as defined by the manufacturer as maximum loaded weight the "auto" is designed to carry while it is:

- a. In the charge of an "insured";
- b. Legally parked; and
- c. Unoccupied.

The "loss" must be reported to the police authorities within 24 hours of known damage.

The total amount of the damage to the covered "auto" must exceed the deductible shown in the Declarations.

This provision does not apply to any "loss" if the covered "auto" is in the charge of any person or organization engaged in the automobile business.

**19. TWO OR MORE DEDUCTIBLES**

Under **SECTION III - PHYSICAL DAMAGE COVERAGE**, if two or more company policies or coverage forms apply to the same "accident", the following applies to Paragraph **D. Deductible**:

- a. If the applicable Business Auto deductible is the smaller (or smallest) deductible, it will be waived; or
- b. If the applicable Business Auto deductible is not the smaller (or smallest) deductible, it will be reduced by the amount of the smaller (or smallest) deductible; or
- c. If the "loss" involves two or more Business Auto coverage forms or policies, the smaller (or smallest) deductible will be waived.

For the purpose of this endorsement, company means any company that is part of the Liberty Mutual Group.

**SECTION IV - BUSINESS AUTO CONDITIONS** is amended as follows:

**20. UNINTENTIONAL FAILURE TO DISCLOSE HAZARDS**

**SECTION IV- BUSINESS AUTO CONDITIONS**, Paragraph **B.2.** is amended by adding the following:

If you unintentionally fail to disclose any hazards, exposures or material facts existing as of the inception date or renewal date of the Business Auto Coverage Form, the coverage afforded by this policy will not be prejudiced.

However, you must report the undisclosed hazard of exposure as soon as practicable after its discovery, and we have the right to collect additional premium for any such hazard or exposure.

**21. AMENDED DUTIES IN THE EVENT OF ACCIDENT, CLAIM, SUIT, OR LOSS**

**SECTION IV - BUSINESS AUTO CONDITIONS**, Paragraph **A.2.a.** is replaced in its entirety by the following:

- a. In the event of "accident", claim, "suit" or "loss", you must promptly notify us when it is known to:
  - (1) You, if you are an individual;
  - (2) A partner, if you are a partnership;
  - (3) Member, if you are a limited liability company;
  - (4) An executive officer or the "employee" designated by the Named Insured to give such notice, if you are a corporation.

To the extent possible, notice to us should include:

- (a) How, when and where the "accident" or "loss" took place;
- (b) The "insureds" name and address; and
- (c) The names and addresses of any injured persons and witnesses.

**22. WAIVER OF TRANSFER OF RIGHTS OF RECOVERY AGAINST OTHERS TO US**

**SECTION IV - BUSINESS AUTO CONDITIONS**, Paragraph **A.5. Transfer Of Rights Of Recovery Against Others To Us**, is amended by the addition of the following:

If the person or organization has in a written agreement waived those rights before an "accident" or "loss", our rights are waived also.

**23. HIRED AUTO COVERAGE TERRITORY**

**SECTION IV - BUSINESS AUTO CONDITIONS**, Paragraph **B.7. Policy Period, Coverage Territory**, is amended by the addition of the following:

- f. For "autos" hired 30 days or less, the coverage territory is anywhere in the world, provided that the "insured's" responsibility to pay for damages is determined in a "suit", on the merits, in the United States, the territories and possessions of the United States of America, Puerto Rico or Canada or in a settlement we agree to.

This extension of coverage does not apply to an "auto" hired, leased, rented or borrowed with a driver.

**24. PRIMARY AND NON-CONTRIBUTING IF REQUIRED BY WRITTEN CONTRACT OR WRITTEN AGREEMENT**

The following is added to **SECTION IV - BUSINESS AUTO CONDITIONS, General Conditions, B.5. Other Insurance** and supersedes any provision to the contrary:

This Coverage Form's Covered Autos Liability Coverage is primary to and will not seek contribution from any other insurance available to an "insured" under your policy provided that:

- 1. Such "insured" is a Named Insured under such other insurance; and
- 2. You have agreed in a written contract or written agreement that this insurance would be primary and would not seek contribution from any other insurance available to such "insured".

**SECTION V - DEFINITIONS** is amended as follows:

**25. BODILY INJURY REDEFINED**

Under **SECTION V - DEFINITIONS**, Definition **C.** is replaced by the following:

"Bodily injury" means physical injury, sickness or disease sustained by a person, including mental anguish, mental injury, shock, fright or death resulting from any of these at any time.

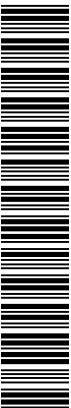

54787403

003426

221

of 76

41