

Ordinance No. 24- 03

AN ORDINANCE GRANTING THE VACATION OF A PORTION OF THE RIGHT OF WAY ON 20<sup>TH</sup> STREET SOUTH OF EXCHANGE STREET ADJACENT TO 2095 EXCHANGE STREET, TAX LOTS 80908DD06400 AND 80908DD06500

The Astoria City Council having initiated this proceeding for the vacation of a portion of 20<sup>th</sup> Street and after a public hearing and in compliance with the provisions of State Law and City Ordinance:

The City of Astoria does ordain as follows:

Section 1. Vacation Allowed. The vacation of that portion of 20<sup>th</sup> Street described on the attached Exhibit A as shown on the attached Exhibit B is ordered and allowed.

Section 2. Combining Lots. Pursuant to ORS 271.140 title to the vacated portion of 20<sup>th</sup> Street shall attach to the bordering properties in equal proportion .

Section 3. Effective Date. The provisions of this ordinance shall take effect 30 days after its passage.

ADOPTED BY THE COMMON COUNCIL THIS 18 DAY OF March, 2024.

APPROVED BY THE MAYOR THIS THIS 18 DAY OF March, 2024.

\_\_\_\_\_  
Mayor

ATTEST:

\_\_\_\_\_  
City Manager

ROLL CALL ON ADOPTION		YEA	NAY	ABSENT
Councilor	Davis	X		
	Brownson	X		
	Adams	X		
	Hilton	X		
Mayor	Fitzpatrick	X		

# EXHIBIT A

20<sup>TH</sup> Street Right-of-Way Vacation  
February 28, 2024  
Project No. 2915-001

## RIGHT OF WAY VACATION DESCRIPTION

A tract of land situated in the Southeast one quarter of Section 8, Township 8 North, Range 9 West, Willamette Meridian, Clatsop County, Oregon, being more particularly described as follows:

**BEGINNING** at the Northwestern corner of Block 139, Shivelys Astoria, a duly recorded subdivision in Clatsop County, Oregon, being on the Southerly Right-of-Way of Exchange Street;

**THENCE**, in a Southerly direction, along the East Right-of-Way of 20<sup>th</sup> Street, same being the West line of said Block 139, to a point that is 22.50 feet Northerly of, when measured at right angles, from the centerline of Franklin Avenue;

**THENCE**, in a Westerly direction, parallel with and 22.50 feet Northerly of said centerline of Franklin Avenue, to the apparent intersection with Westerly Right-of-Way of said 20<sup>th</sup> Street;

**THENCE**, in a Northerly direction, along the Westerly Right-of-Way of said 20<sup>th</sup> Street, same being the Easterly line of Block 138 of said Shivelys Astoria to the Northeasterly corner of said Block 138, being on the southerly Right-of-Way of aforementioned Exchange Street;

**THENCE**, in an Easterly direction, along the Southerly Right-of-Way of said Exchange street to the Northwest corner of said Block 139 and the **POINT OF BEGINNING**.

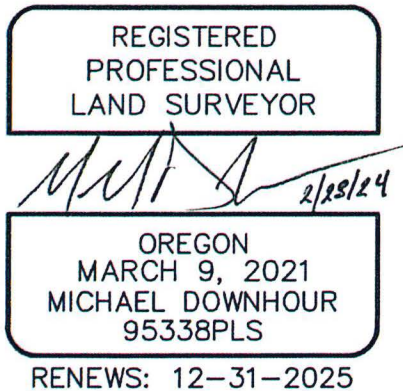



0 25' 50'  
SCALE: 1"=50'

REGISTERED  
PROFESSIONAL  
LAND SURVEYOR

*Michael Downhour* 2/28/24

OREGON  
MARCH 9, 2021  
MICHAEL DOWNHOUR  
95338PLS

RENEWS: 12-31-2025

EXCHANGE STREET

POINT OF BEGINNING

**LEGEND**

- PROPERTY LINE
- RIGHT OF WAY VACATION
- - - RIGHT-OF-WAY
- - - ROADWAY CENTERLINE
-  RIGHT-OF-WAY VACATION AREA

SHIVELY'S ASTORIA  
BLOCK 138

20TH STREET

SHIVELY'S ASTORIA  
BLOCK 139

FRANKLIN AVENUE STREET VACATION  
ORDINANCE 92-06,  
B.791, P.587

FRANKLIN AVENUE  
STREET VACATION  
ORDINANCE 14-10,  
INSTR. NO. 201406564

FRANKLIN AVENUE

**EXHIBIT B**  
**PAGE 1 OF 1**

LOCATED IN THE SE 1/4 OF SECTION 8  
TOWNSHIP 8N, RANGE 9W, W.M.  
CLATSOP COUNTY, OREGON

DATE	2/28/2024
DRAWN BY	SIH
CHECKED BY	MAD
REVISION	0
JOB NO.	2915-001

**WESTLAKE**  
CONSULTANTS INC.

ENGINEERING ♦ SURVEYING ♦ PLANNING

PACIFIC CORPORATE CENTER  
15115 S.W. SEQUOIA PARKWAY, SUITE 150 (503) 684-0652  
TIGARD, OREGON 97224 FAX (503) 624-0157

I:\2915-001.21\4. SURVEY\CAD\DWG\2915-001X\_VAC\_20TH.DWG 2024-02-28 10:13 AM - SIH