



## CITY OF THE DALLES PUBLIC WORKS

1215 WEST FIRST STREET  
THE DALLES, OREGON 97058  
(541) 298-5401

# SIDEWALK/STREET CLOSURE PERMIT

This application must be submitted at least five (5) business days prior to the proposed sidewalk/street closure date. Applications may be submitted in person or mailed to the Public Works office at the address above or emailed to [Jcorbin@ci.the-dalles.or.us](mailto:Jcorbin@ci.the-dalles.or.us). Applicant agrees to comply with the provisions of the Charter, Ordinances (2.24.060), Resolutions, and Policies of the City of The Dalles pertaining to such closures; and with the instructions and requirements as listed below.

Please complete the entire form

Applicant Name: Robert McNary  
Address: 1525 E 9th St TD  
Contact/Responsible Person Robert McNary  
Email Address: bgmcnary@charter.net

Date: 9-2-2021  
Phone: 541-980-3901  
Phone: 541-296-3313  
Cell: 541-980-3901

### TYPE OF CLOSURE (Check at least 1)

- |   |  |
|---|--|
| <input type="checkbox"/> Street for Construction Work | <input checked="" type="checkbox"/> Sidewalk for Construction Work |
| <input type="checkbox"/> Street/Parking Lot for Event | <input type="checkbox"/> Sidewalk for Event                        |
| <input type="checkbox"/> Parking Lane for Dumpster    | <input type="checkbox"/> Other                                     |

CLOSURE FROM 9-21-2021 7:00 AM (Date/Time) TO 9-27-2021 5:00 PM (Date/Time)

LOCATION/ADDRESS OF CLOSURE 1525 East 9th Street TD

REASON FOR CLOSURE New curb & sidewalk

### INSTRUCTIONS/REQUIREMENTS:

- Applicant **must** provide a Traffic Control Plan (TCP) for approval for all Street and Parking Lot Closures. Traffic Control Plan should show proposed detour routes, signs, barricades, and traffic control devices.
- Applicant **must** provide a Temporary Pedestrian Accessible Route Plan (TPARP) for approval for all Sidewalk Closures. TPARP should show proposed accessible pedestrian detours, signs, barricades, and pedestrian delineation devices. (See Standard Drawing TM844 for general TPARP examples)
- Applicant **must** notify Central Dispatch at the time of street closing and reopening. (541-298-5507)
- Applicant **must** notify adjacent property/business owners prior to closure.
- Applicant **must** provide proof of liability insurance with The City of The Dalles listed as co-insured if City Street/Parking Lot closure is for an event

**THIS PERMIT WILL BE CONSIDERED A PUBLIC DOCUMENT. ALL INFORMATION SUBMITTED WILL BE ACCESSIBLE TO THE PUBLIC, IN ITS ENTIRETY, ON THE CITY'S WEBSITE.**

## ACKNOWLEDGEMENT OF APPLICANT RESPONSIBILITY

The undersigned agrees to defend, indemnify and hold the City of The Dalles, its officers, agents and employees, harmless from and against all claims, liabilities, demands, damages and actions, of whatever form or nature, including but not limited to property damage, pedestrian accessibility, personal injury and death, together with costs and attorney fees incurred in defense thereof, arising from or relating in any way to the street or sidewalk closure authorized by this permit and the undersigned's activities in connection with this permit. Applicant for City Street or Parking Lot closures for events must provide a Certificate of General Liability Insurance with a minimum of \$1,000,000 coverage, with stated purpose of on the Certificate for the event and listing The City of The Dalles as a co-insured. Insurance is in addition to acknowledgement of responsibility and cannot be cancelled without prior notice to the City. In addition the Responsible Person listed on this permit shall remain on-site during the duration of the event and closure.

Failure of the applicant to meet the requirements of this permit, including following of the Traffic Control Plan and/or Temporary Pedestrian Accessible Route Plan, will result in a Stop Work Order and possible revocation of the permit.

I understand and agree to the terms of this Sidewalk/Street Closure Permit.

Applicant Signature Robert McNary Date 9-2-2021

### CITY USE ONLY

☒ NO ROAD CLOSURES ARE ALLOWED WITH THIS PERMIT.  
☐

#### Receipt of Required Items

TCP for Street/Parking Lot Closure	<input type="checkbox"/> Attached	<input checked="" type="checkbox"/> Not Required
TPARP for Sidewalk Closure	<input checked="" type="checkbox"/> Attached	<input type="checkbox"/> Not Required
Certificate of General Liability	<input type="checkbox"/> Attached	<input checked="" type="checkbox"/> Not Required

RELATED PERMITS \_\_\_\_\_

### ROUTING ORDER - PLEASE EXPEDITE

Department	Approval	Date
Public Works - Transportation	<i>[Signature]</i>	7/28/2021
Public Works - ADA Coordinator	<i>[Signature]</i>	9/2/2021
Police Department	<i>[Signature]</i>	9/2/21
Human Resources - Risk Manager	<i>[Signature]</i>	9/8/21
City Manager	<i>[Signature]</i> via email	9/17/21

#### THIS PERMIT IS:

☒ APPROVED AND EXPIRES ON 9-28-2021

☐ APPROVED WITH REVISIONS AND EXPIRES ON \_\_\_\_\_

☐ DENIED FOR FOLLOWING REASON: \_\_\_\_\_

Authorized by: Eric Hansen Title: Asst. P.W. Director

Public Works to Notify Applicant of final decision



Robert McNary  
 1525 E 9th St  
 The Dalles, OR 97058  
 (Property owner)

Sidewalk detour

Lewis St

Sidewalk ends 150 ft East of Bob's driveway  
 will have to close half of Bob's driveway  
 no driveway cuts East of Bob's driveway

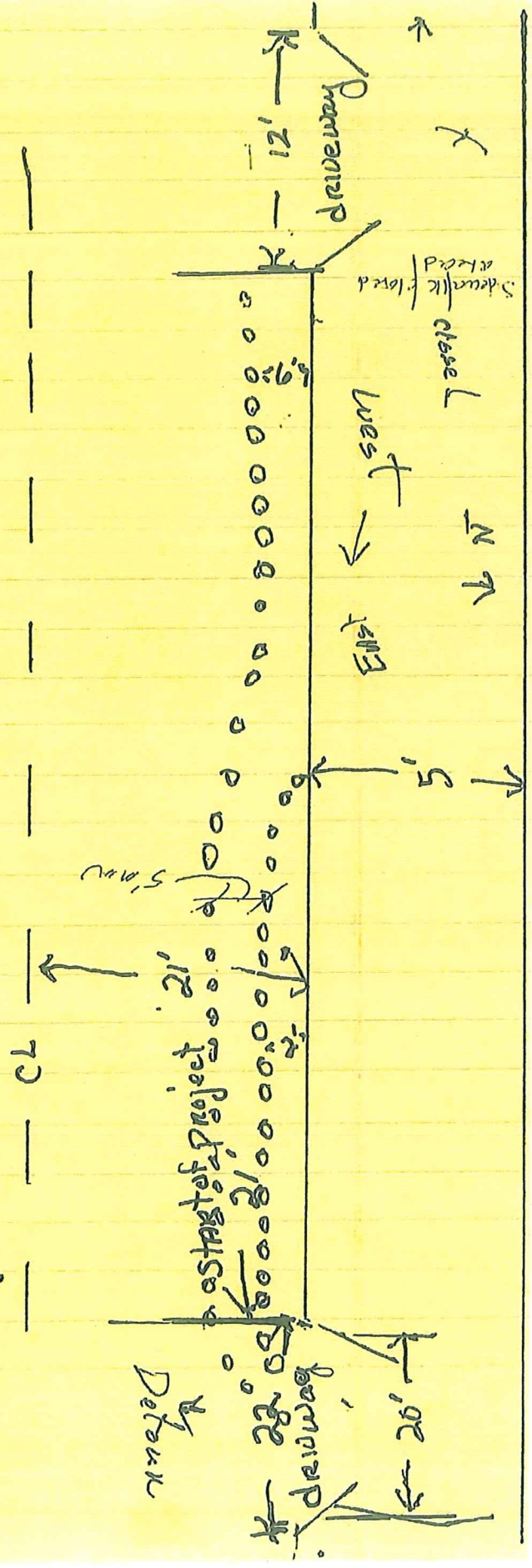





# BORROWED SIGN CHECKLIST





## General

<input checked="" type="checkbox"/> Cones, # <u>20</u> of Traffic Cones (28" Traffic Cones if used overnight)	Checked Out by _____ Checked In by _____
<input type="checkbox"/> Barricades, # _____ of Barricades, Type of Barricade _____ (II or III)	Checked Out by _____ Checked In by _____
<input type="checkbox"/> Sandbags, # _____ of Sandbags (used to weigh signs down from the wind)	Checked Out by _____ Checked In by _____
<input type="checkbox"/> Other, # _____	Checked Out by _____ Checked In by _____

## Street Closure

<input type="checkbox"/> Road Work Ahead Rollup, # _____ 	Checked Out by _____ Checked In by _____
<input type="checkbox"/> Road Closed Ahead - Rollup, # _____ 	Checked Out by _____ Checked In by _____
<input type="checkbox"/> Road Closed - Rollup, # _____ 	Checked Out by _____ Checked In by _____
<input type="checkbox"/> Detour - Rollup # _____ 	Checked Out by _____ Checked In by _____

## Sidewalk Closure

<input checked="" type="checkbox"/> Sidewalk Closed - Rollup # <u>2</u> 	Checked Out by _____ Checked In by _____
<input checked="" type="checkbox"/> Sidewalk Closed Ahead Cross Here - On Barricade # <u>1</u>  <u>R.T. ARROW</u>	Checked Out by _____ Checked In by _____
<input checked="" type="checkbox"/> Sidewalk Detour - On Barricade # <u>1</u>  <u>L.T. ARROW</u>	Checked Out by _____ Checked In by _____
<input type="checkbox"/> Crosswalk Closed - On Barricade # _____ 	Checked Out by _____ Checked In by _____
<input type="checkbox"/> Pedestrian Channelization Devices, Length or Number of sections _____	Checked Out by _____ Checked In by _____

## Other Signs

_____, # of Signs _____	Checked Out by _____ Checked In by _____
_____, # of Signs _____	Checked Out by _____ Checked In by _____