



OREGON 07058

CITY of THE DALLES PUBLIC WORKS

1215 WEST FIRST STREET
THE DALLES,

(541) 296-5401

SIDEWALK/STREET CLOSURE PERMIT

This application must be submitted at least five (5) business days prior to the proposed sidewalk/street closure date. Applications may be submitted in person or mailed to the Public Works office at the address above or emailed to Jcorbin@ci.the-dalles.or.us. Applicant agrees to comply with the provisions of the Charter, Ordinances, and Resolutions of the City of The Dalles pertaining to such closures; and with the instructions and requirements as listed below.

Please complete the entire form

Applicant Name: Oregon Equipment Co. Inc.Date: 11-12-20Address: 1505 W 1st StreetPhone: 541-296-2915Contact Person Ron Nelson

Phone: _____

Email Address: ron@oregonequipment.com

Cell: _____

Type of Closure: ☒ Street - Attach Traffic Control Plan☐ Sidewalk - Attach Temporary Pedestrian Accessible Route Plan

DATES	STREET CLOSED	FROM	TO	START TIME	END TIME
Ex. 01/01/2020 to 01/03/2020	Second	Washington	Union	8:00am	5:00pm
11/24/20	North lane of third	federal	laughlin	8:00	9:00

Reason for Closure: Replacing rooftop HVAC for building on North side of street.**INSTRUCTIONS/REQUIREMENTS:**

- Applicant **must** provide a Traffic Control Plan (TCP) for approval for all Street Closures. Traffic Control Plan should show proposed detour routes, signs, barricades, and traffic control devices.
- Applicant **must** provide a Temporary Pedestrian Accessible Route Plan (TPARP) for approval for all Sidewalk Closures. TPARP should show proposed accessible pedestrian detours, signs, barricades, and pedestrian delineation devices. (See Standard Drawing TM844 for general TPARP examples)
- Applicant **must** notify Central Dispatch at the time of street closing and reopening. (541-298-5507)
- Applicant **must** notify adjacent property/business owners prior to closure.

☒ -DUE TO THE LOCATION OF THIS PROJECT APPLICANT MUST FOLLOW THE PROVIDED LANE CLOSURE FOR SIDE INTERSECTIONS.

☒ -APPLICANT CAN CHECK OUT THE SIGNS NEEDED AT PUBLIC WORKS.

☒ TPARP MUST BE IN PLACE PRIOR TO ANY SIDEWALK CLOSURE

01/27/2020

Page 1 of 2

Reported by MHB

THIS PERMIT WILL BE CONSIDERED A PUBLIC DOCUMENT. ALL INFORMATION SUBMITTED WILL BE ACCESSIBLE TO THE PUBLIC, IN ITS ENTIRETY, ON THE CITY'S WEBSITE.

ACKNOWLEDGEMENT OF APPLICANT RESPONSIBILITY

The undersigned agrees to defend, indemnify and hold the City of The Dalles, its officers, agents and employees, harmless from and against all claims, liabilities, demands, damages and actions, of whatever form or nature, including but not limited to property damage, pedestrian accessibility, personal injury and death, together with costs and attorney fees incurred in defense thereof, arising from or relating in any way to the street or sidewalk closure authorized by this permit and the undersigned's activities in connection with this permit. If required as a condition of this permit, the undersigned shall name the City of The Dalles as additional insured and shall provide the City with a Certificate of such insurance that shall provide, among other things, that the policy may not be cancelled without prior notice to the City.

Failure of the applicant to meet the requirements of this permit, including following of the Traffic Control Plan and/or Temporary Pedestrian Accessible Route Plan, will result in a Stop Work Order and possible revocation of the permit.

I understand and agree to the terms of this Sidewalk/Street Closure Permit.

Applicant
Signature

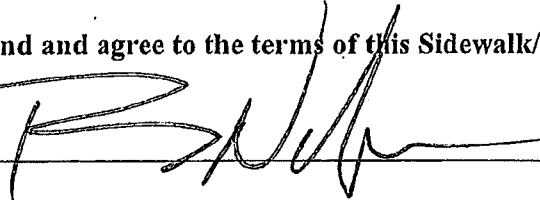

Date 11-12-20

CITY USE ONLY

THIS PERMIT IS:



APPROVED AND EXPIRES ON 11-25-2020



DENIED FOR FOLLOWING REASON: _____



Authorized by:



Title:

Asst. P.W. Director

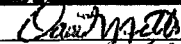
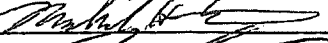
ROUTING ORDER - PLEASE EXPEDITE

Department	Approval	Date
Public Works - Transportation (Street Closures)		<u>11/13/2020</u>
Public Works - ADA Coordinator (Sidewalk Closures)		<u>11/13/2020</u>
Police Department		<u>11/16/20</u>
City Manager	<u>Via email</u>	<u>11/19/20</u>

Public Works to Notify Applicant of final decision

11/12/2020

Google Maps



TCP: TRAFFIC CONTROL PLAN

Cones and Signage will be placed in the Northern lane and Center of Street of E. 3rd Street just East of intersection with Federal Street to direct traffic to South lane of 3rd Street for approximately 100 Feet.

11/12/2020

Google Maps

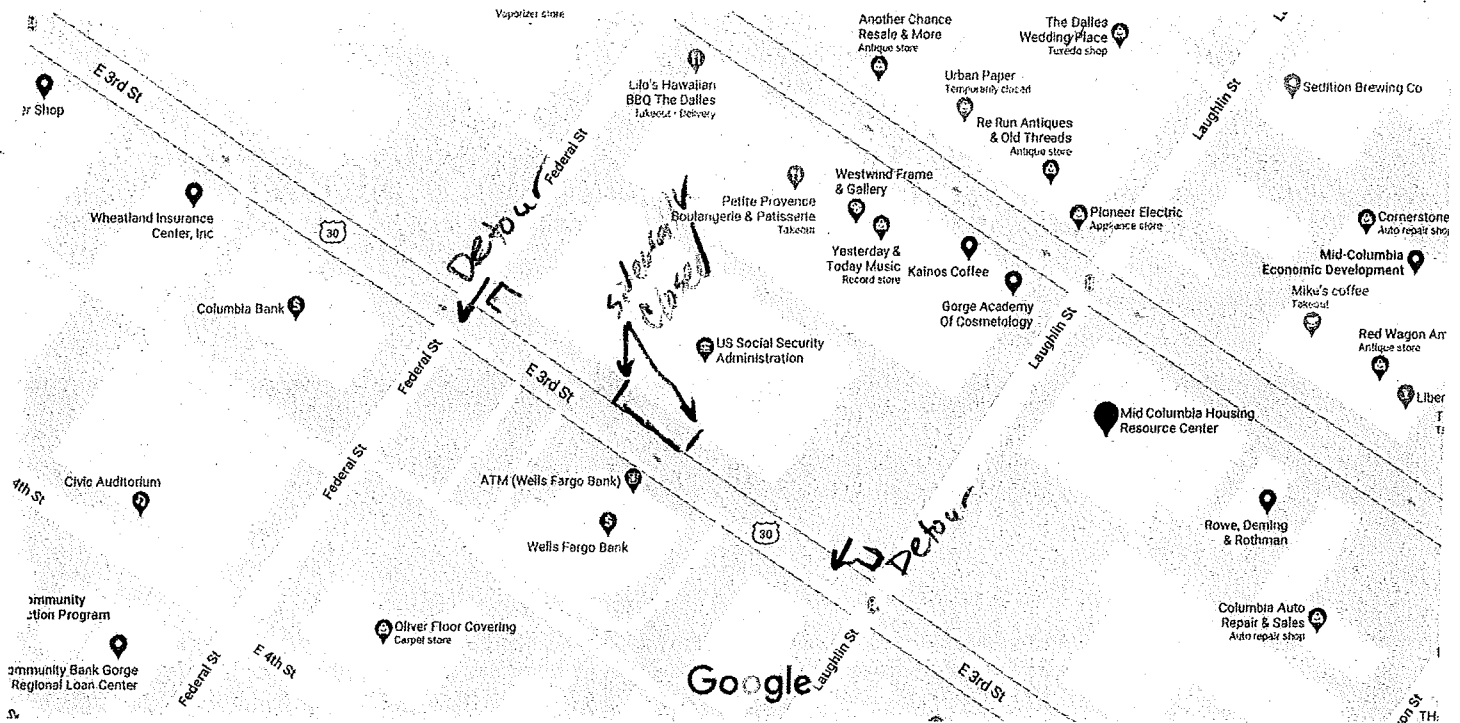

TPARP: TEMPORARY PEDESTRIAN ACCESIBLE ROUTE PLAN

Cones/Flagging and signage will be placed on North sidewalk blocking construction area. Detour signage will be placed @ N.E. Corner of Federal/3rd and N.W. Corner Laughlin/3rd, directing pedestrians to use South Sidewalk.

USE 'MID-BLOCK CLOSURE' DETAIL ON TM 844 AS TPARP
(ATTACHED)

Lane Closure – Far Side of Intersection

Diagram 610

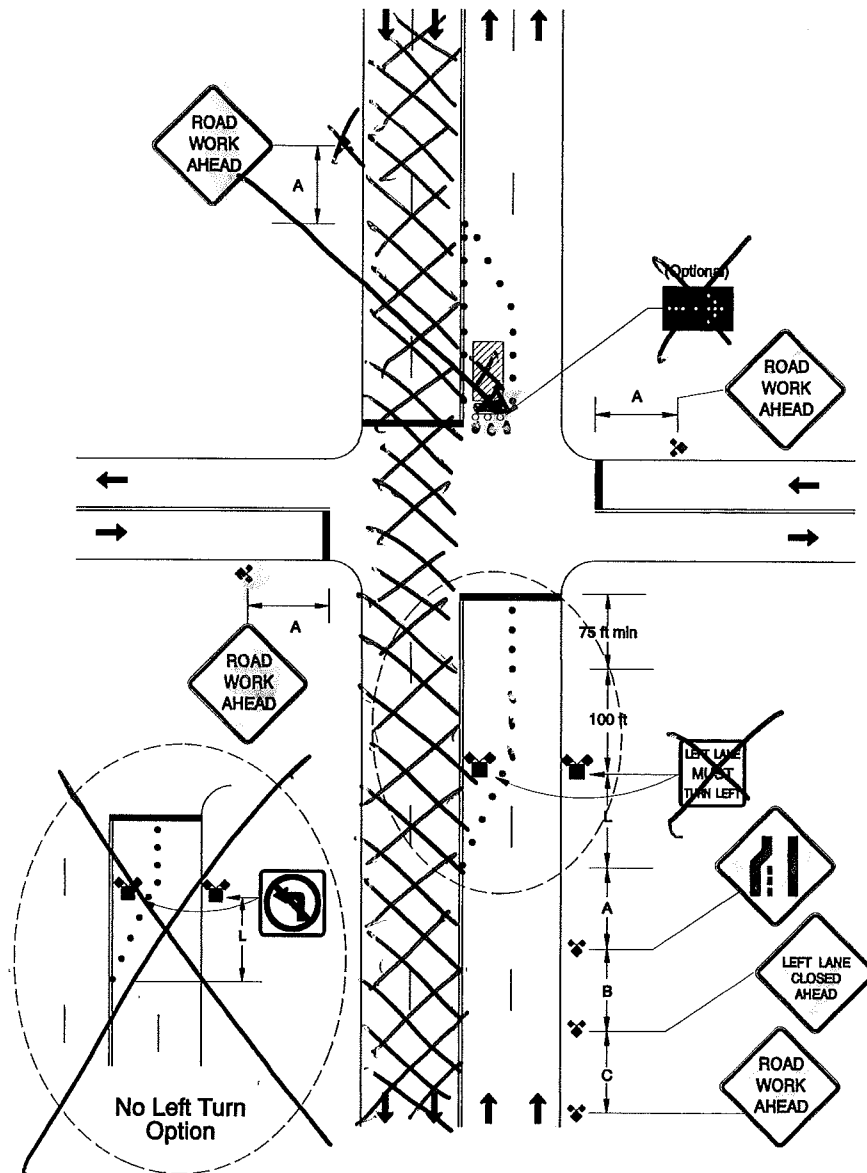

Lane Closure – Far Side of Intersection**Diagram 610**

Diagram 610 covers work within an area immediately downstream of an intersection. Work vehicles may or may not be in the work space. Movement of traffic through the intersection is regulated by existing traffic control only.

1. When left turns can be prohibited use the No Left Turn Option (see inset).
2. If left turns cannot be prohibited, a left turn lane may be set up after the lane closure by leaving an opening long enough for vehicles to enter. There should be a minimum of 75 feet of storage beyond the opening in the left turn lane. Adjust the length of the lane closure to accommodate the left turn lane.
3. If providing a left turn lane, place black-on-white, rectangular, "LEFT LANE MUST TURN LEFT" (R3-7L) signs on the right shoulder and inside the closed lane in advance of the left turn opening and in place of the "Left Turn Prohibition" (R3-2) sign(s).
4. When closing an interior lane of a three or more-lane facility, the merging taper **shall** direct traffic into only one of the adjacent lanes, but not both.

Intersections

Sign Spacing and Buffer Lengths (feet)

Posted Speed	Spacing Between Signs			"Buffer" Space
	A	B	C	
20	100	100	100	50
25				75
30				100
35	350	350	350	125
40				150
45				180
50	500	500	500	210
55				250
60				285
65	700	700	700	325
70				365

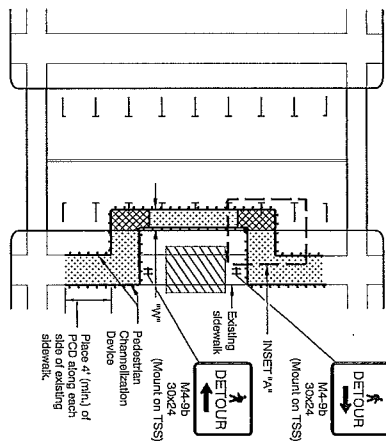

WITHIN ROADWAY SIDEWALK DIVERSION

NOTES:
• Ramp size will vary. ADA requirements incl. max grade of 7.5% and max cross slope of 2%.

- Place or construct temp. sidewalk ramp, as needed.
- For roadways with a pre-construction posted speed of 40 mph or less.
- See Inset 'A' for Temp. Sidewalk Ramp details.
- "V" = 60", or, where 60" width cannot be maintained through the entire route, provide 48" min. width with 60" x 60" passing spaces every 200 ft.
- Use temporary ADA compliant surfaces to cross planter strips or other non-traversable surfaces.

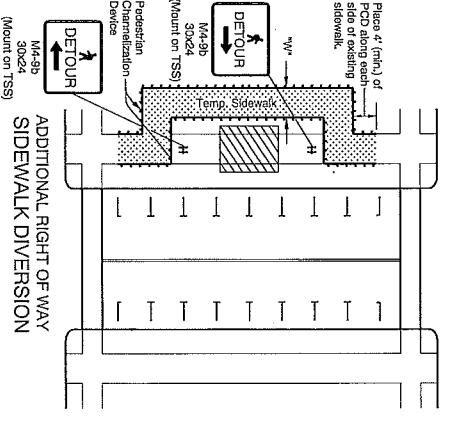
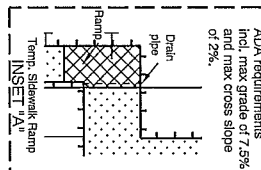

SIDEWALK CLOSURE, MIDDLEBLOCK

GENERAL NOTES FOR ALL DETAILS:

- When closing or relocating crosswalks or other pedestrian facilities provide ADA compliant facilities. Include accessibility features consistent with existing pedestrian facilities by providing adequate slope transitions and surfacing.
- Provide non-slip, 60 inch minimum wide surface through entire pedestrian route. If not possible, provide 48" min. width with 60" x 60" passing spaces every 200 feet along the route.
- Only TCD for pedestrians are shown. Other devices may be necessary to control vehicular traffic.
- Stage work, as necessary, to provide a temporary pedestrian access route at all times. For roadways with no available detours, maintain one open sidewalk at all times.
- Minimize pedestrian out-of-direction travel.

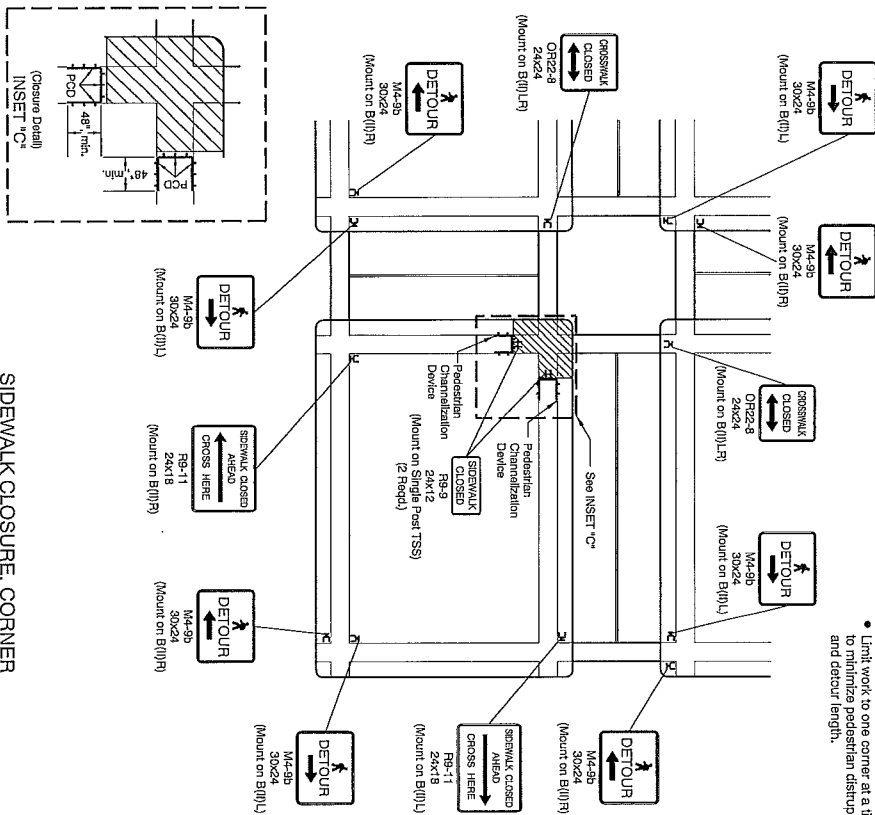
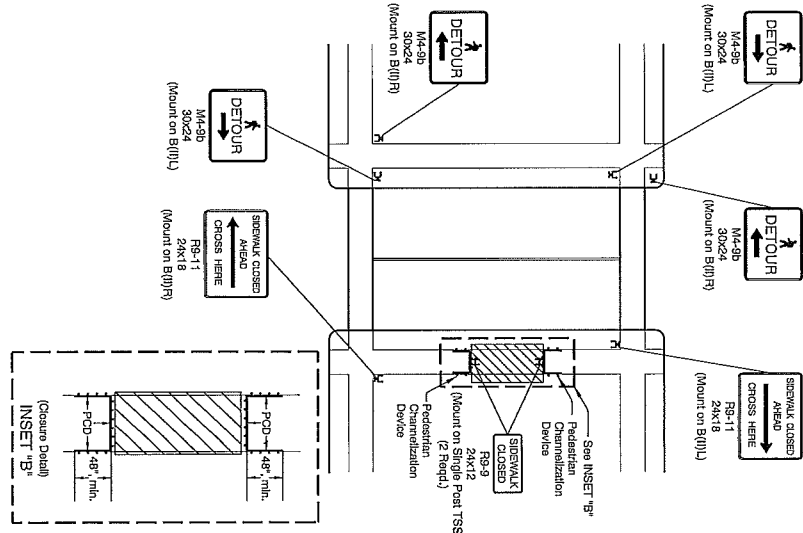

NOTE:
• Limit work to one corner at a time to minimize pedestrian disruption and detour length.

UNDER PEDESTRIAN TRAFFIC
UNDER CONSTRUCTION
PEDESTRIAN CHANNELIZATION DEVICE
To be accompanied by Drg. Nos. TM620 & TM621

SIDEWALK CLOSURE, CORNER

TEMPORARY PEDESTRIAN ACCESS ROUTING

NOTE: All material and workmanship shall be in accordance with the current City of The Dalles Standard Specifications.

The selection and use of this Standard Drawing, while designed in accordance with generally accepted engineering principles and practices, is the sole responsibility of the user and should not be used without consulting a Registered Professional Engineer.

DATE: 2018
REVISION DESCRIPTION: