

12-24-15 CD  
TL 2000, 2100, 2200

A BILL FOR AN ORDINANCE ANNEXING AND	)	
ZONING PROPERTY FOLLOWING HEARING AND	)	ORDINANCE BILL NO. <u>2</u>
UPON THE WRITTEN CONSENT FILED WITH	)	for 1999
THE CITY COUNCIL BY LANDOWNERS IN	)	
SAID AREA PURSUANT TO ORS 222.120 AND	)	ORDINANCE NO. <u>2237</u>
ORS 222.170		

WHEREAS, there has been submitted to the City of Lebanon written requests for annexation to the City signed by more than one-half of the landowners who also own more than one-half of the land in the contiguous territory described in Exhibit "A", which real property represents more than one-half of the assessed value of all real property in the contiguous territory to be annexed; and

WHEREAS, City Council has elected to dispense with submitting the question of the proposed annexation to the electors of the City, initiating the annexation of the territory pursuant to ORS 222.120 calling a hearing and directing that notice be given as required by ORS 222.120(3); and

WHEREAS, after conducting the hearing and considering all objections or remonstrances with reference to the proposed annexation, the City Council finds that this annexation is in the best interest of the City and of the contiguous territory;

NOW, THEREFORE, the City of Lebanon ordains as follows:

Section 1. Annexation Area. The following contiguous territory described in Exhibit "A" and incorporated herein by this reference is hereby proclaimed to be annexed to the City of Lebanon and zoned as indicated in accordance with the Lebanon Zoning Ordinance No. 1773, and given the zoning of Residential Mixed Density (RM).

Section 2. Record. The City Recorder shall submit to the Oregon Secretary of State a copy of this Ordinance. The City Recorder shall also send a description by metes and bounds or legal

Return to: City of Lebanon  
925 Main Street  
Lebanon, OR 97355

subdivision, and a map depicting the new boundaries of the City within ten (10) days of the effective date of this annexation to the Linn County Assessor, Linn County Clerk, and the State Department of Revenue.

Passed by the Council by a vote of 4 for and 0 against and approved by the Mayor this 24th of February, 1999.

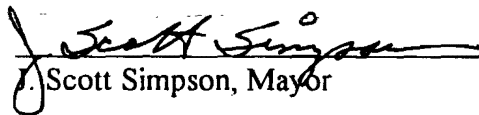
  
J. Scott Simpson, Mayor

ATTEST:

  
Judy Wendland, City Recorder and City Administrator Pro Tem

I hereby certify that I am the City Recorder Pro Tem for the City of Lebanon, State of Oregon; that the foregoing is a full, true, correct copy of the original; and that J. Scott Simpson, whose signature appears on the original document, was at the time of signing the mayor of the City of Lebanon.

  
Judith L. Wendland, City Recorder Pro Tem

**LEGAL DESCRIPTION**

A PARCEL OF LAND LOCATED IN THE SOUTHWEST ONE-QUARTER OF SECTION 15, TOWNSHIP 12 SOUTH, RANGE 2 WEST, WILLAMETTE MERIDIAN, LINN COUNTY, OREGON, BEING FURTHER DESCRIBED AS FOLLOWS:

ALL OF LOTS 19, 20, 21 OF BLOCK 3 OF "HARMONY SUBDIVISION" RECORDED IN VOLUME 9 , PAGE 10, ON MAY 3, 1947 IN THE RECORDS OF LINN COUNTY, CITY OF LEBANON, OREGON, BEING MORE FULLY DESCRIBED AS FOLLOWS:

BEGINNING AT SOUTHEAST CORNER OF LOT 21, BLOCK 3 OF "HARMONY SUBDIVISION" SAID POINT BEING ON THE NORTH RIGHT-OF-WAY LINE OF WASSOM STREET (50.00 FEET WIDE); THENCE SOUTH 90°00'00" WEST ALONG THE NORTH RIGHT-OF-WAY LINE OF WASSOM STREET, AND THE SOUTH LINE OF LOTS 21, 20 AND 19, A DISTANCE OF 425.97 FEET TO THE SOUTHWEST CORNER OF LOT 19 OF SAID PLAT; THENCE NORTH 00°09'24" WEST, LEAVING THE AFORESAID NORTH RIGHT-OF-WAY LINE, ALONG THE WEST LINE OF SAID LOT 19, A DISTANCE OF 281.94 FEET TO THE NORTHWEST CORNER OF SAID LOT 19; THENCE NORTH 90°00'00" EAST, LEAVING THE WEST LINE OF LOT 19, ALONG THE NORTH LINE OF LOTS 19, 20, AND 21, A DISTANCE OF 426.03 FEET TO THE NORTHEAST CORNER OF LOT 21; THENCE SOUTH 00°08'41" EAST, ALONG THE EAST LINE OF LOT 21, A DISTANCE OF 281.94 FEET TO THE SOUTHEAST CORNER OF LOT 21 AND THE TRUE POINT OF BEGINNING. CONTAINING 2.757 ACRES MORE OR LESS.

REGISTERED  
PROFESSIONAL  
LAND SURVEYOR



OREGON  
DEC. 16, 1920  
DAVID A. FOSTER  
#1934

RENEWED THRU 12/31/99

EXHIBIT "A"

**LEGAL DESCRIPTION**

**WASSOM STREET RIGHT-OF-WAY**

A PARCEL OF LAND LOCATED IN THE SOUTHWEST ONE-QUARTER OF SECTION 15, TOWNSHIP 12 SOUTH, RANGE 2 WEST, WILLAMETTE MERIDIAN, LINN COUNTY, OREGON, BEING FURTHER DESCRIBED AS FOLLOWS:

BEGINNING AT THE SOUTHEAST CORNER OF LOT 21 OF "HARMONY SUBDIVISION" SAID POINT BEING ON THE NORTH RIGHT-OF-WAY LINE OF WASSOM STREET (50.00 FEET WIDE); THENCE SOUTH 90°00'00" WEST ALONG THE NORTH RIGHT-OF-WAY LINE OF WASSOM STREET, AND THE SOUTH LINE OF LOTS 21, 20 AND 19, A DISTANCE OF 425.97 FEET TO THE SOUTHWEST CORNER OF LOT 19 OF SAID PLAT; THENCE SOUTH 00°09'25" WEST, LEAVING THE AFORESAID NORTH RIGHT-OF-WAY LINE, A DISTANCE OF 50.00 FEET TO THE NORTHWEST CORNER OF LOT 7, BLOCK 4 OF SAID PLAT, SAID POINT BEING ON THE SOUTH RIGHT-OF-WAY LINE OF SAID WASSOM STREET; THENCE NORTH 90°00'00" EAST ALONG THE NORTH LINE OF LOTS 7, 6 AND 5 OF BLOCK 4 OF SAID PLAT, A DISTANCE OF 425.96 FEET, TO THE NORTHEAST CORNER OF LOT 5 OF BLOCK 4 OF SAID PLAT; THENCE NORTH 00°08'41" WEST, LEAVING THE AFORESAID NORTH LINE OF LOTS 7, 6 AND 5, A DISTANCE OF 50.00 FEET TO THE TRUE POINT OF BEGINNING. CONTAINING 21,298 SQUARE FEET OR 0.489 ACRES MORE OR LESS.

REGISTERED  
PROFESSIONAL  
LAND SURVEYOR

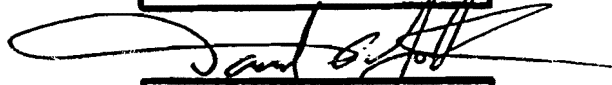

OREGON  
DEC. 16, 1900  
DAVID A. FOSTER  
#1934

RENEWED THRU 12/31/99

VOL 1018 PAGE 953  
**ANNEXATION MAP**

FILE # A-98-7

T12S-R2W-15CD  
 TAX LOTS 2000, 2100 AND 2200  
 AND ADJACENT WASSON STREET  
 RIGHT-OF-WAY

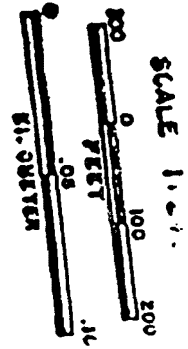

SE 1/4 SW 1/4 Sec. 15 T.12 S. R.2 W. W.M.

1" = 100'

12 2W 15CD  
 LEBANON

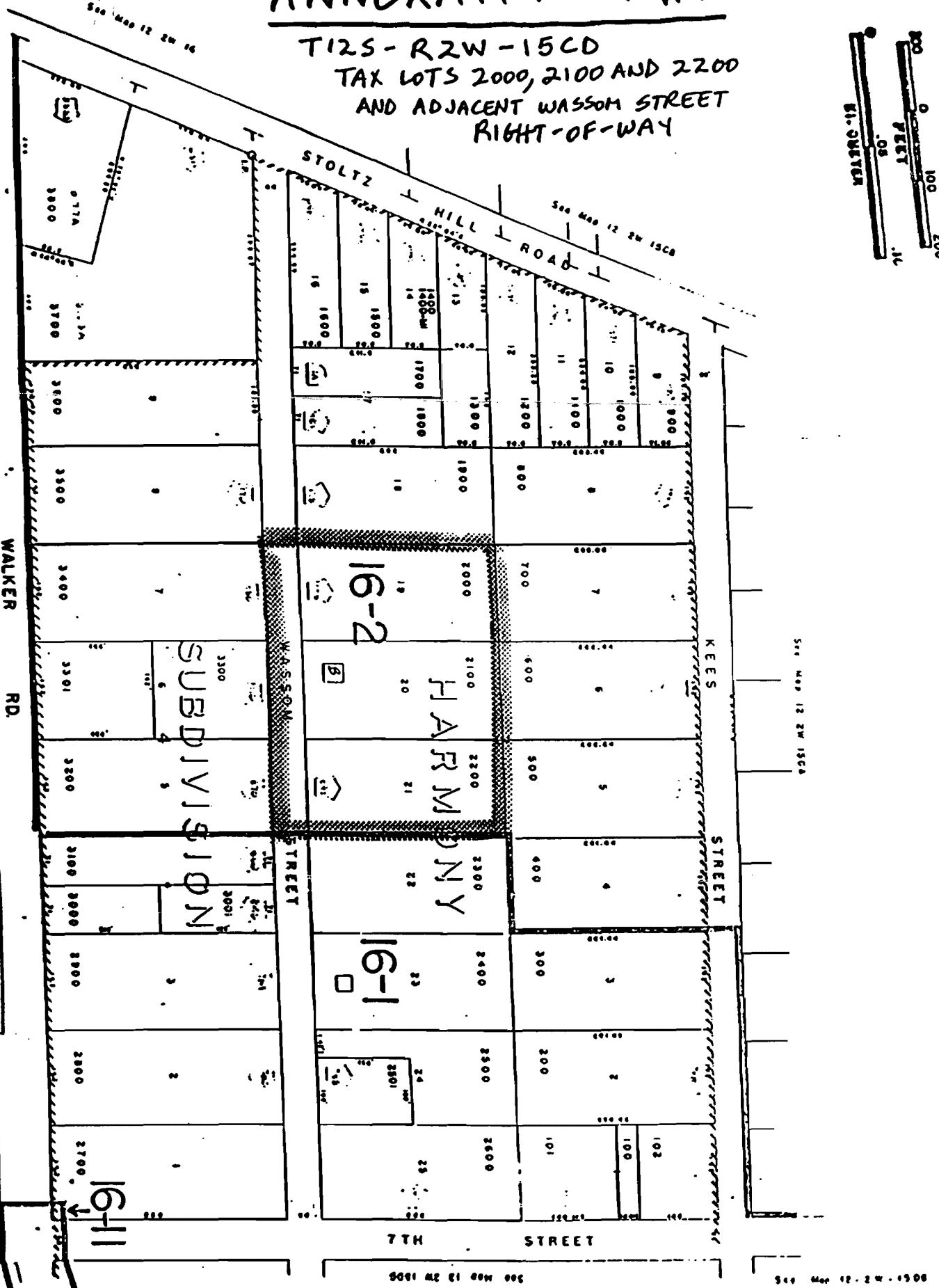

35

STATE OF OREGON  
County of Linn

M

8:30 O'clock a.m.

R

S

A

O

I hereby certify that the attached  
was received and duly recorded  
by me in Linn County records.

MAR 17 1999

STEVE DRUCKENMILLER  
Linn County Clerk

MF 1018

By PA, Deputy

PAGE 949