

A BILL FOR AN ORDINANCE ANNEXING AND ZONING PROPERTY FOLLOWING HEARING AND UPON THE WRITTEN CONSENT FILED WITH THE CITY COUNCIL BY LANDOWNERS IN SAID AREA PURSUANT TO ORS 222.120 AND ORS 222.170 )

ORDINANCE BILL NO. 17 for 1997

ORDINANCE NO. 2212

WHEREAS, there has been submitted to the City of Lebanon written requests for annexation to the City signed by more than one-half of the landowners who also own more than one-half of the land in the contiguous territory described in Exhibit "A", which real property represents more than one-half of the assessed value of all real property in the contiguous territory to be annexed; and

WHEREAS, City Council has elected to dispense with submitting the question of the proposed annexation to the electors of the City, initiating the annexation of the territory pursuant to ORS 222.120 calling a hearing and directing that notice be given as required by ORS 222.120(3); and

WHEREAS, after conducting the hearing and considering all objections or remonstrances with reference to the proposed annexation, the City Council finds that this annexation is in the best interest of the City and of the contiguous territory;

NOW, THEREFORE, the City of Lebanon ordains as follows:

Section 1. Annexation Area. The following contiguous territory described in Exhibit "A" and incorporated herein by this reference is hereby proclaimed to be annexed to the City of Lebanon and zoned as indicated in accordance with the Lebanon Zoning Ordinance No. 1773, and given the zoning of Residential Mixed Density (RM).

Section 2. Record. The City Recorder shall submit to the Oregon Secretary of State a copy of this Ordinance. The City Recorder shall also send a description by metes and bounds or legal

✓ AFTER RECORDING PLEASE RETURN TO: City of Lebanon Planning Department 925 Main Street Lebanon, OR 97355

subdivision, and a map depicting the new boundaries of the City within ten (10) days of the effective date of this annexation to the Linn County Assessor, Linn County Clerk, and the State Department of Revenue.

Passed by the Council by a vote of 6 for and 0 against and approved by the Mayor this 10th of December, 1997.

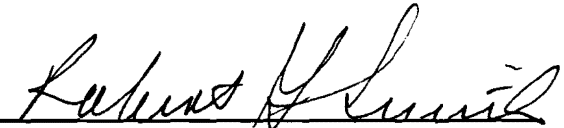
  
Robert G. Smith, Mayor

ATTEST:

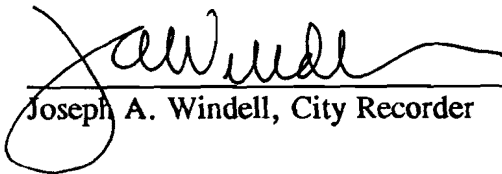
  
Joseph A. Windell, City Recorder

I hereby certify that I am the City Recorder for the City of Lebanon, State of Oregon; that the foregoing is a full, true, correct copy of the original; and that Robert G. Smith, whose signature appears on the original document, was at the time of signing the Mayor of the City of Lebanon.

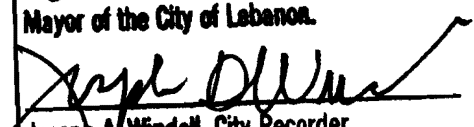
  
Joseph A. Windell, City Recorder

## Exhibit "A"

Engineers • Planners • Surveyors

ANNEXATION DESCRIPTION

Beginning at a point on the north line of that Ellis Tract (hereinafter called First Ellis Tract) described by deed recorded in Book 227, Page 131 of the Linn County Deed Records on May 22, 1952, which point being SOUTH 5.50 chains and North 89°49' East 651.9 feet from the southeast corner of the North one-half (N1/2) of the Russell T. Hill Donation Land Claim No. 77 in Township 12 South, Range 2 West, Willamette Meridian, Linn County, Oregon, which point being the northeast corner of that Gatchell Tract described by deed recorded in Book 234, Page 575 of the Linn County Deed Records on October 7, 1953; thence South 5°21' West, along the east line of said Gatchell Tract, 402.0 feet to a 5/8 inch rod at the southeast corner of that Lindquist Tract described by deed recorded in Book 311, Page 495 of the Linn County Deed Records on July 30, 1965; thence South 05°24'39" West, along the east line of said Gatchell Tract, 883.69 feet to the southeast corner of said Gatchell Tract, which point is on the south line of said First Ellis Tract described by said deed recorded in Book 227, Page 131; thence South 89°31'21" East 207.52 feet, more or less, to the southeast corner of said Ellis Tract, which point is on the center of a small creek; thence along said center of small creek the following four (4) courses: (1) North 15°03'39" East 158.40 feet; (2) thence North 04°03'21" West 79.20 feet; (3) thence North 23°32'39" East 85.80 feet; (4) thence North 16°25'39" East 37.58 feet to a point that bears North 89°44'45" East 45.46 feet from a 5/8 inch rod; thence leaving center of small creek South 89°44'45" West 45.46 feet to a 5/8 inch rod; thence South 89°44'45" West 52.19 feet to a 5/8 inch rod; thence North 05°19'31" East 169.33 feet to a 5/8 inch rod; thence North 89°44'45" East 12.00 feet to a 5/8 inch rod; thence North 05°19'31" East 77.00 feet to a 5/8 inch rod; thence North 89°44'45" East 226.00 feet to a 5/8 inch rod; thence South 05°19'31" West 65.00 feet to a 5/8 inch rod; thence continuing South 05°19'31" West 34.62 feet, more or less, to a point in the center of a small creek, which point is also on the southeasterly boundary of said First Ellis Tract described by said deed recorded in Book 227, Page 131; thence along said center of small creek the following five (5) courses: (1) North 66°31'39" East 30.64 feet; (2) thence North 70°17'39" East 165.00 feet; (3) thence North 59°05'39" East 88.44 feet; (4) thence North 83°20'39" East 52.80 feet; (5) thence North 42°35'39" East 166.79 feet to an angle point in the easterly line of said First Ellis Tract, which point being the most southerly corner of that Ellis Tract described by deed recorded in Microfilm Volume 603, Page 968 of the Linn County Deed Records on June 29, 1992 (hereinafter referred to as the Second Ellis Tract); thence continuing along center of said small creek North 42°35'39" East 100 feet, more or less, to its conflux with the South Santiam River, which point is the most easterly corner of said Second Ellis Tract; thence NORTHWESTERLY, along the west bank of said river to the northeast corner of said Second Ellis Tract; thence WEST 100 feet, more or less, to the northwest corner of said Second Ellis Tract, which point is the northeast corner of said First Ellis Tract; thence South 89°49' West, along the north line of said First Ellis Tract, 360.3 feet to the Point of Beginning.

October 10, 1997  
 CORNELL TRACT  
 (97-112) JRB:nm  
 File: nm\legal\112cml.tct

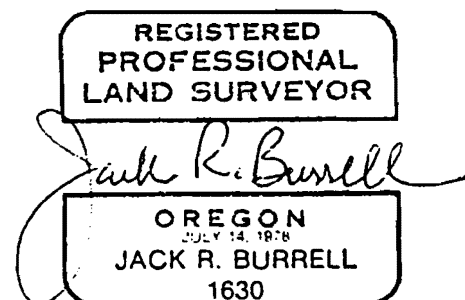

EXPIRATION DATE: 12/31/97

Exhibit "A"

Date 10/10/97  
 Map Scale 1"=200'  
 The above-mentioned map is  
 based on GDS & 1997

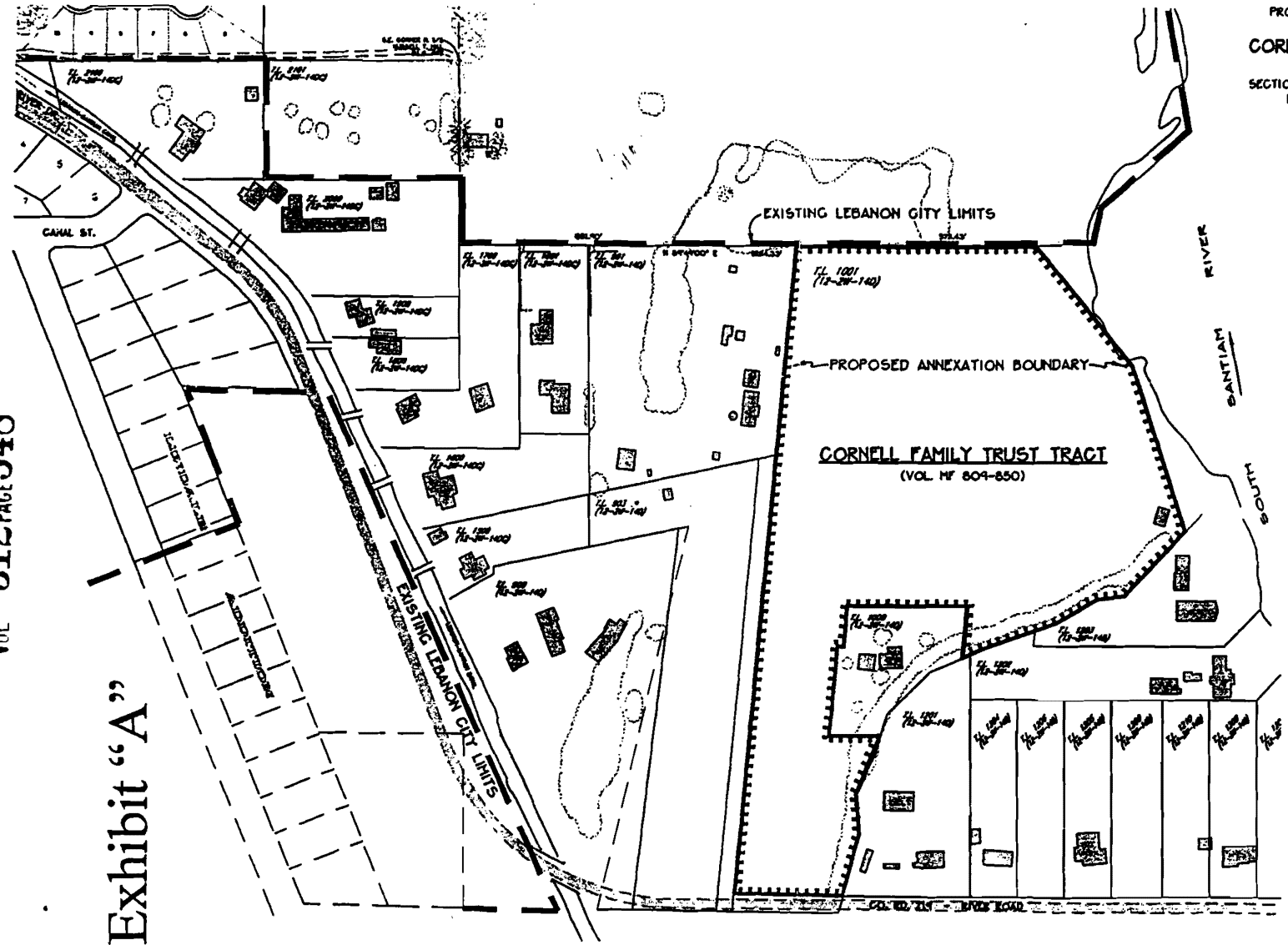

PROPOSED ANNEXATION MAP  
 FOR  
**CORNELL FAMILY TRUST**  
 LOCATED IN  
 SECTION 14, T. 12 S., R. 2 W., W.M.  
 LINN COUNTY, OREGON  
 OCTOBER 10, 1997

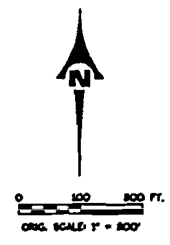

REGISTERED  
 PROFESSIONAL  
 LAND SURVEYOR  
*Jack R. Burrell*  
 OREGON  
 JACK R. BURRELL  
 1630

EXPIRATION DATE: 12/31/97

DATE	REVISIONS	BY

K & D ENGINEERING, INC.  
 876 N.W. SECOND ST.  
 P.O. BOX 728  
 ALBANY, OREGON 97112-0728  
 CIVIL ENGINEERING — LAND PLANNING  
 SURVEYING — CONSTRUCTION MANAGEMENT



SCALE: 1"=200'  
 DATE: OCTOBER 1997  
 SHEET NO.  
 SHEET 1 OF 1

STATE OF OREGON  
County of Linn

I hereby certify that the attached  
was received and duly recorded  
by me in Linn County records.

STEVE DRUCKENMILLER  
Linn County Clerk

By RU, Deputy

M  
R 20  
S 10  
A  
O

MF 912  
PAGE 945

8:30 O'clock a.m.

30

DEC 24 1997

OFFICE OF THE  
SECRETARY OF STATE

PHIL KEISLING  
SECRETARY OF STATE

MICHAEL GREENFIELD  
DEPUTY SECRETARY  
OF STATE



ARCHIVES DIVISION  
ROY TURNBAUGH  
DIRECTOR

800 Summer Street NE  
Salem, Oregon 97310  
(503) 373-0701

Facsimile (503) 373-0953

December 29, 1997

City of Lebanon  
Administrative Assistant  
925 Main Street  
Lebanon, Oregon 97355-3200

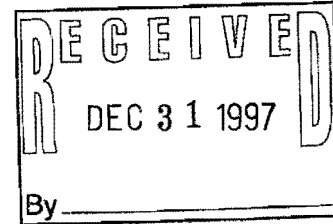

Dear Ms. Goss,

Please be advised we have filed on December 29, 1997 annexing territory to the city of Lebanon.

Ordinance No(s).	City	Our filing number(s)
2211	Lebanon	AN1997-0356
2212	Lebanon	AN1997-0357
2213	Lebanon	AN1997-0358

The Ordinance(s) shall become effective upon compliance with ORS 222.040 and/or ORS 222.180

Our assigned file number(s). are included with the above information.

Sincerely,

Rita F. Perry  
Official Public Documents

cc: LINN COUNTY  
ODOT/HIGHWAY DEPT.  
POPULATION RESEARCH CTR./PSU