

A BILL FOR AN ORDINANCE ANNEXING AND )  
ZONING PROPERTY FOLLOWING HEARING AND )  
UPON THE WRITTEN CONSENT FILED WITH )  
THE CITY COUNCIL BY LANDOWNERS IN SAID )  
AREA, PURSUANT TO ORS 222.120 AND )  
ORS 222.170, AND DECLARING AN EMERGENCY )

ORDINANCE BILL NO. 4  
FOR 1989  
ORDINANCE NO. 2048

WHEREAS, there has been submitted to the City of Lebanon written requests for annexation to the city signed by more than one-half of the landowners who also own more than one-half of the land in the contiguous territory described below, which real property represents more than one-half of the assessed value of all real property in the contiguous territory to be annexed; and

WHEREAS, Ordinance No. 2046 was passed, whereby City Council elected to dispense with submitting the question of the proposed annexation to the election of the city, initiating the annexation of the territory pursuant to ORS 222.120, calling a hearing and directing that notice be given as required by ORS 222.120(3); and

WHEREAS, after conducting the hearing and considering all objections or remonstrances with reference to the proposed annexation, the City Council finds that this annexation is in the best interest of the city and of the contiguous territory;

NOW THEREFORE, THE CITY OF LEBANON ORDAINS AS FOLLOWS:

Section 1. Annexation Area. The following contiguous territory is hereby proclaimed to be annexed to the City of Lebanon and zoned as indicated in accordance with the Lebanon Zoning Ordinance No. 1773, and given the zoning of CH, Highway Commercial.

Section 2. Record. The City Recorder shall submit to the Oregon Secretary of State a copy of this Ordinance. The City Recorder shall also send a description by metes and bounds or legal subdivision, and a map depicting the new boundaries of the city within ten (10) days of the effective date of this annexation to the Linn County Assessor, Linn County Clerk and the State Department of Revenue.

Section 3. Inasmuch as the provisions of this Ordinance are necessary for the immediate preservation of the peace, health and safety of the people of the City of Lebanon, an emergency is hereby declared to exist and this Ordinance

shall be in full force and effect immediately upon its passage by the Council and approval by the Mayor.

Passed by the Council by a vote of 6 for and 0 against and approved by the Mayor this 8th of March, 1989.

  
\_\_\_\_\_  
Mayor

ATTEST:

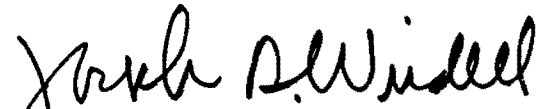
  
\_\_\_\_\_  
City Administrator

# JAMES F. UDELL

ENGINEER 8072

ENGINEERING & SURVEYING  
32388 Berlin Road  
LEBANON, OREGON 97355  
Phone (503) 451-5125

SURVEYOR 1366

Annexation Legal  
Dick Kearns  
Tax Lots 800 & 900  
Map 12-2W-14CB  
and adjacent Highway 20  
and adjacent Russell Lane

Beginning at a point on the East right-of-way line of U.S. Highway 20 and on the South line of the North 1/2 of the R.T. Hill Donation Land Claim #77, said point being South 2095.5 ft. and West 1790.18 ft. from the S.E. corner of the W.M. Ralston D.L.C. #48 in Township 12 South, Range 2 West of the Willamette Meridian in Linn County, Oregon, said point also being North  $0^{\circ}09'$  East 30.00 ft. of the initial point of INGRIM Subdivision as recorded in Linn County Records of Subdivision Plats; thence South  $0^{\circ}09'$  West 30 ft. to the initial point of said INGRIM Subdivision; thence North  $89^{\circ}38'59''$  East (North  $89^{\circ}42'$  East by former records) 240.00 ft. to the Northeast corner of Lot 30 of said INGRIM Subdivision; thence North  $0^{\circ}09'$  East 60 ft. to the North line of Russell Lane; thence South  $89^{\circ}38'59''$  West 37.03 ft.; thence North  $0^{\circ}08'03''$  East (North  $0^{\circ}09'$  East by former record) 114.10 ft.; thence South  $89^{\circ}38'59''$  West 202.93 ft. to the East right-of-way line of U.S. Highway 20; thence North  $0^{\circ}09'$  East 293.05 ft.; thence South  $89^{\circ}38'59''$  West 40 ft.; thence South  $0^{\circ}09'$  West along the centerline of U.S. Highway 20 627.45 ft.; thence North  $89^{\circ}38'59''$  East 40.0 ft. to the East right-of-way line of U.S. Highway 20; thence North  $0^{\circ}09'$  East 190.3 ft. to the point of beginning.

Jim Udell  
2-9-89



Applicant :

DICK KEARNS

Location :

12S-2W-14CB

# SITE MAP

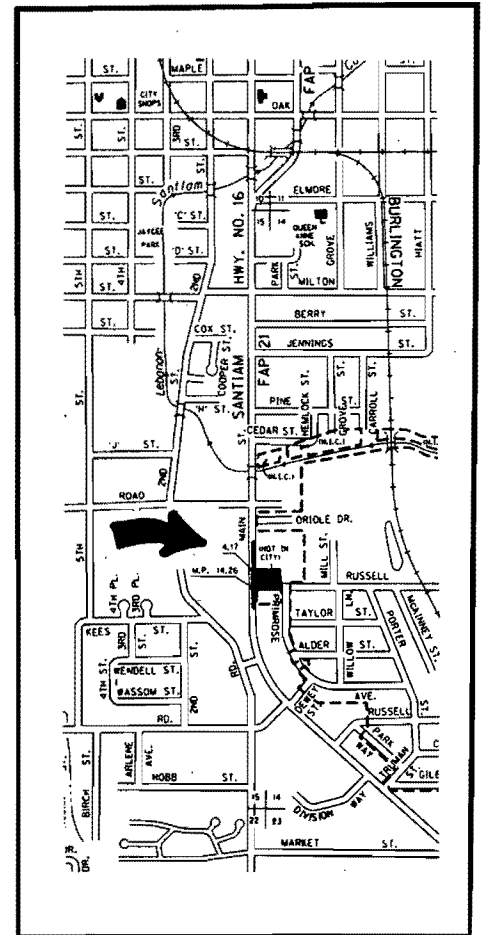
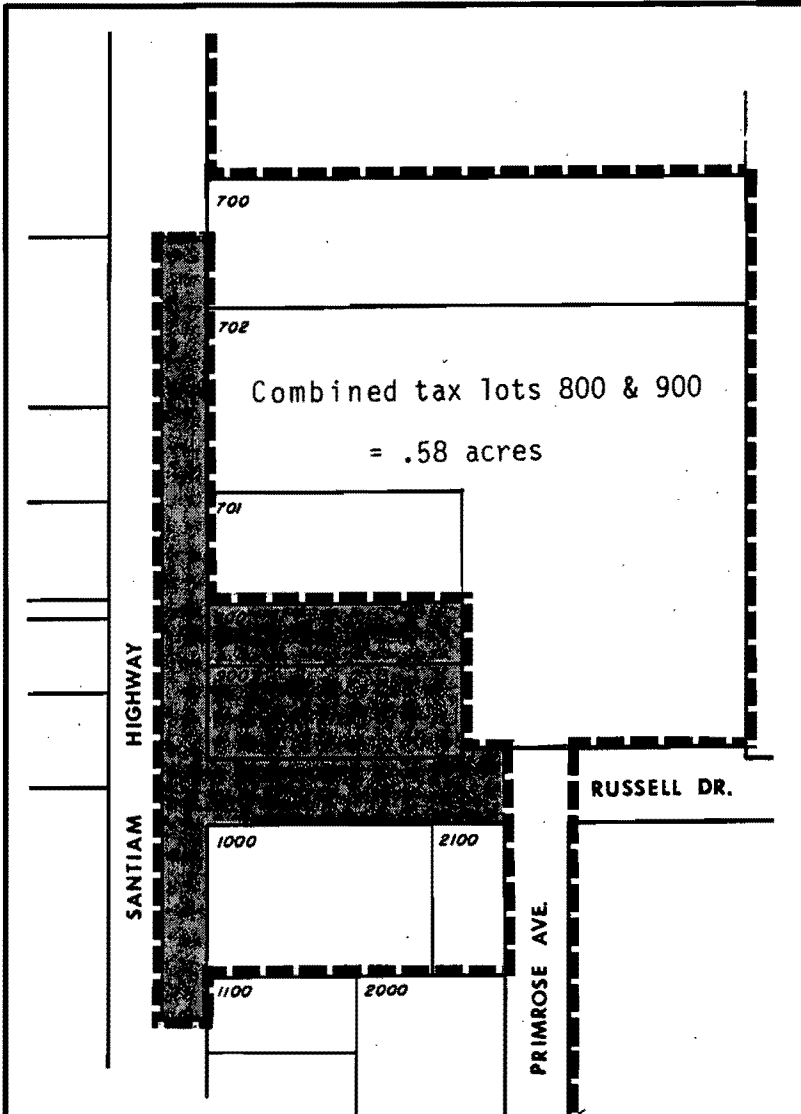

LOCATION MAP

 AREA PROPOSED FOR ANNEXATION

 EXISTING CITY LIMITS

TOTAL AREA PROPOSED FOR ANNEXATION = 1.43 ACRES

PLOT PLAN Scale 1" = 150'

