

A BILL FOR AN ORDINANCE ANNEXING AND ) ORDINANCE BILL NO. 4  
 ZONING PROPERTY FOLLOWING HEARING AND ) for 1985  
 UPON THE WRITTEN CONSENT FILED WITH )  
 THE CITY COUNCIL BY LANDOWNERS IN ) ORDINANCE NO. 1961  
 SAID AREA, PURSUANT TO ORS 222.120 )  
 AND ORS 222.170 AND DECLARING AN )  
 EMERGENCY. )

WHEREAS, there has been submitted to the City of Lebanon written requests for annexation to the City signed by more than one-half of the landowners who also own more than one-half of the land in the contiguous territory described below, which real property represents more than one-half of the assessed value of all real property in the contiguous territory to be annexed; and

WHEREAS, Ordinance No. 1959 was passed, initiating the annexation of the territory, calling a hearing and directing that notice be given; and

WHEREAS, after conducting the hearing and considering all objections or remonstrances with reference to the proposed annexation, the City Council finds that this annexation is in the best interest of the City and of the contiguous territory;

NOW THEREFORE, THE CITY OF LEBANON ORDAINS AS FOLLOWS:

Section 1. Annexation Area. The following contiguous territory is hereby proclaimed to be annexed to the City of Lebanon and zoned as indicated in accordance with the Lebanon Zoning Ordinance No. 1773, and given the zoning of MG, General Industrial.

COMMENCE at the northeast corner of the Morgan Kees Donation Land Claim (DLC) No. 43 in Section 2, Township 12 South, Range 2 West of the Willamette Meridian in Linn County, Oregon; thence South  $00^{\circ}03'$  West 1314.00 feet; thence North  $89^{\circ}59'$  West 20.00 feet to a  $3/4"$  iron pipe and the point of beginning; thence continue North  $89^{\circ}59'$  West 400.00 feet to a  $5/8"$  iron rod; thence South  $00^{\circ}03'$  West 600.00 feet to a  $3/4"$  iron pipe; thence North  $89^{\circ}59'$  West 680.32 feet to a  $3/4"$  iron pipe; thence North  $00^{\circ}01'$  East 81.62 feet to the southerly right-of-way of a 20.00 foot Sewer Easement granted unto the City of Lebanon by Crown Zellerbach Corporation on May 22, 1953; thence North  $87^{\circ}26'48"$  West 270 feet, more or less, along said southerly right-of-way to the easterly bank of Mark's Slough and the northwest corner of that tract of land sold by Quitclaim Deed to John and Ella Smith by Crown Zellerbach Corporation on September 3, 1965 and recorded on the 20th day of December 1965, in the Office of the Recorder of Linn County, Oregon, in Deed Book 314, page 128; thence southerly 110 feet, more or less, along said easterly bank to the southwest corner of the aforementioned tract of land; thence North  $89^{\circ}59'$  West 255 feet, more or less, to a point on the original east boundary of the City of Lebanon; thence North 274.49 feet along said original east boundary; thence North  $18^{\circ}00'00"$  West 264.00 feet; thence North  $7^{\circ}00'00"$  West 198.00 feet; thence West 822 feet, more or less, to the easterly bank of the Albany and Santiam Canal; thence North  $29^{\circ}50'10"$  East 214 feet, more or less, along said easterly bank to the intersection with the southerly bank of the Waste Slough; thence easterly and northeasterly along the said southerly bank of the Waste Slough for the following described six (6) courses: (1) South  $80^{\circ}56'14"$  East 70 feet, more or less; (2) North  $78^{\circ}17'36"$  East 123.67 feet; (3) North  $87^{\circ}08'28"$  East 146.22 feet; (4) North  $53^{\circ}53'45"$  East 123.93 feet; (5) North  $51^{\circ}57'14"$  East 126.28 feet; (6) North  $40^{\circ}21'50"$  East 121.27 feet; thence South  $54^{\circ}16'37"$  East 373 feet, more or less, to the centerline of Mark's Slough; thence northeasterly along said centerline of Mark's Slough for the following described six (6) courses: (1) North  $22^{\circ}28'47"$  East 210.51 feet; (2) North  $32^{\circ}04'35"$  East 120.28 feet; (3) North  $36^{\circ}22'28"$  East 167.96 feet; (4) North  $46^{\circ}11'27"$  East 299.72 feet; (5) North  $57^{\circ}14'07"$  East 438.32 feet; (6) North  $78^{\circ}01'43"$  East 135.53 feet; thence North  $00^{\circ}03'00"$  East 55.82 feet to the north line of the aforementioned Morgan Kees DLC No. 43 and a  $3/4"$  iron pipe; thence North  $89^{\circ}49'$  East 494.47 feet along said north line to a point South  $89^{\circ}49'$  West 20.00 feet from the northeast corner of said Morgan Kees DLC No. 43; thence South  $00^{\circ}03'$  West 1314.00 feet to the point of beginning.

SAVE AND EXCEPT therefrom the following described parcel for which Crown Zellerbach Corporation gave and granted on May 22, 1953 unto the City of Lebanon the right to lay, construct and maintain a sewer over:

A strip of land 20.00 feet in width being 10.00 feet on each side of (when measured at right angles to) the centerline described as follows:

BEGINNING at a point which is South  $0^{\circ}03'$  West (along the east line of Morgan Kees DLC No. 43) a distance of 1870.65 feet and North  $87^{\circ}26.8'$  West 420.00 feet from the northeast corner of the Morgan Kees DLC No. 43 in Township 12 South, Range 2 West of the Willamette Meridian in Linn County, Oregon; and running thence North  $87^{\circ}26.8'$  West, 1150.98 feet to a point on the present trunk sewer of the Sewer System of the City of Lebanon, said point being westerly 15.00 feet from the westerly wall of the Sewage Pump House of said Sewage System.

REGISTERED  
PROFESSIONAL  
LAND SURVEYOR

*C. Henry Cole*

OREGON  
JULY 13 1984  
C. HENRY COLE  
2023

Section 2. Record. The City Recorder shall submit to the Oregon Secretary of State a copy of this Ordinance. The City Recorder shall also send a description by metes and bounds or legal subdivision, and a map depicting the new boundaries of the City within ten (10) days of the effective date of this annexation to the Linn County Assessor, Linn County Clerk and the State Department of Revenue.

Section 3. Inasmuch as the provisions of this Ordinance are necessary for the immediate preservation of the peace, health and safety of the people of the City of Lebanon, an emergency is hereby declared to exist and this Ordinance shall be in full force and effect immediately upon its passage by the Council and approval by the Mayor.

Passed by the Council by a vote of 5 for and 0 against and approved by the Mayor this 23rd day of January, 1985.

Robert J. Smith  
Mayor

ATTEST:

Allen L. Henderson  
Recorder

STATE OF OREGON            )  
                                  )    ss.  
County of Linn             )

I, Allen L. Henderson, the duly appointed, qualified and Recorder of the City of Lebanon, do hereby certify that the foregoing is a true and exact copy of Ordinance No. 1961, City of Lebanon, as on record in the office of the City Recorder of Lebanon, Linn County, Oregon.

Allen L. Henderson  
Recorder



SCALE 1:3300

See Map 11 24 30

LINN

VOL 376 PAGE 448

HANZO

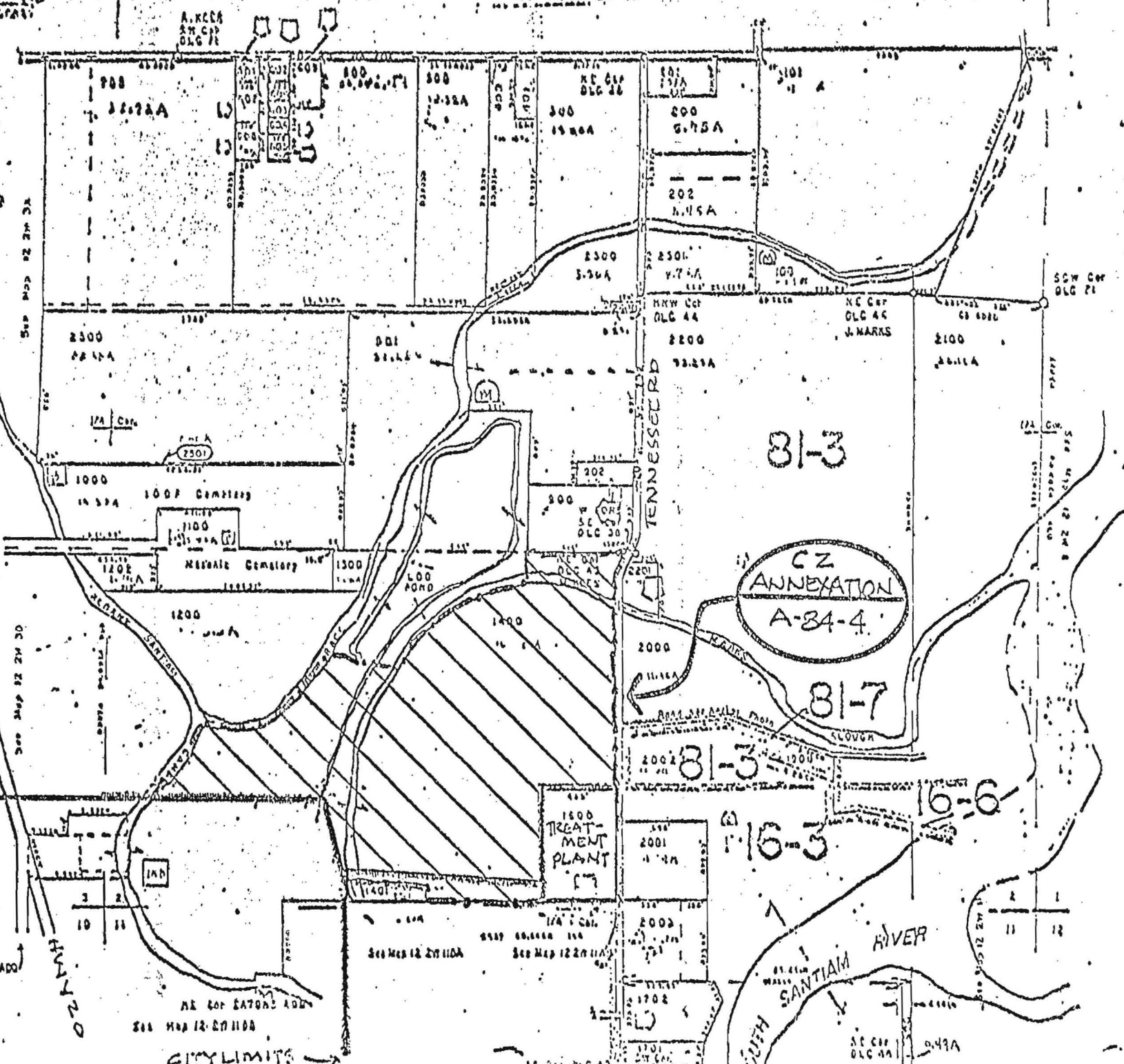

81-3

CZ ANNEXATION A-84-4

81-7

81-3

16-3

6-6

CITY LIMITS

RECEI. WATERS ADD

HANZO

NE COR. SATORIS ADD

See Map 12 27 110A

CITY LIMITS

See Map 12 27 110A

See Map 12 27 110A

SE COR. DUG AD

SOUTH SANTIAM RIVER

SE COR. DUG 41

0.49A

571458

✓✓ 1600  
JAN 28 9 34 AM '85

STATE OF OREGON  
County of Linn

DEL W. RILEY  
Linn County Clerk

I hereby certify that the attached was  
received and duly recorded by me in  
Linn County records:

By *[Signature]* Deputy

Volume: MF 376 Page: 445

*City of Lebanon  
P.O. Box 247  
Lebanon, Ore 97355*