

A RESOLUTION REMOVING A PORTION )  
OF NO PARKING ON PARK DRIVE )

RESOLUTION NO. 3  
for 1991

WHEREAS, the City Engineer has recommended that 23 feet of No Parking be removed on a portion of Park Drive.

WHEREAS, such regulation is deemed to be reasonable and necessary for the safe movement of traffic in the City of Lebanon.

NOW, THEREFORE, BE IT RESOLVED BY THE COUNCIL OF THE CITY OF LEBANON AS FOLLOWS:

A 23 foot portion of a No Parking Zone shall be removed along the East side of Park Drive, being the southerly most 23 feet of an existing 108 foot No Parking Zone.

Suitable signs shall be erected and/or markings painted and such designation shall be part of the traffic regulations of the City of Lebanon.

This Resolution supersedes and replaces conflicting portions of previous Resolutions governing parking at this location.

Passed by the Council by a vote of 5 for and 0 against and approved by the Mayor this 13th day of February, 1991.

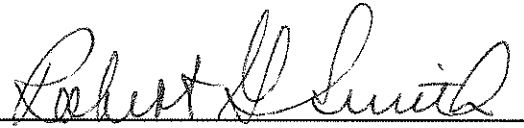
  
\_\_\_\_\_  
Mayor

ATTEST:

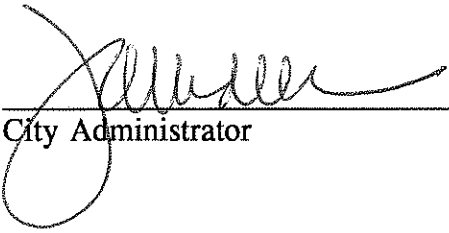
  
\_\_\_\_\_  
City Administrator

MILTON ST.

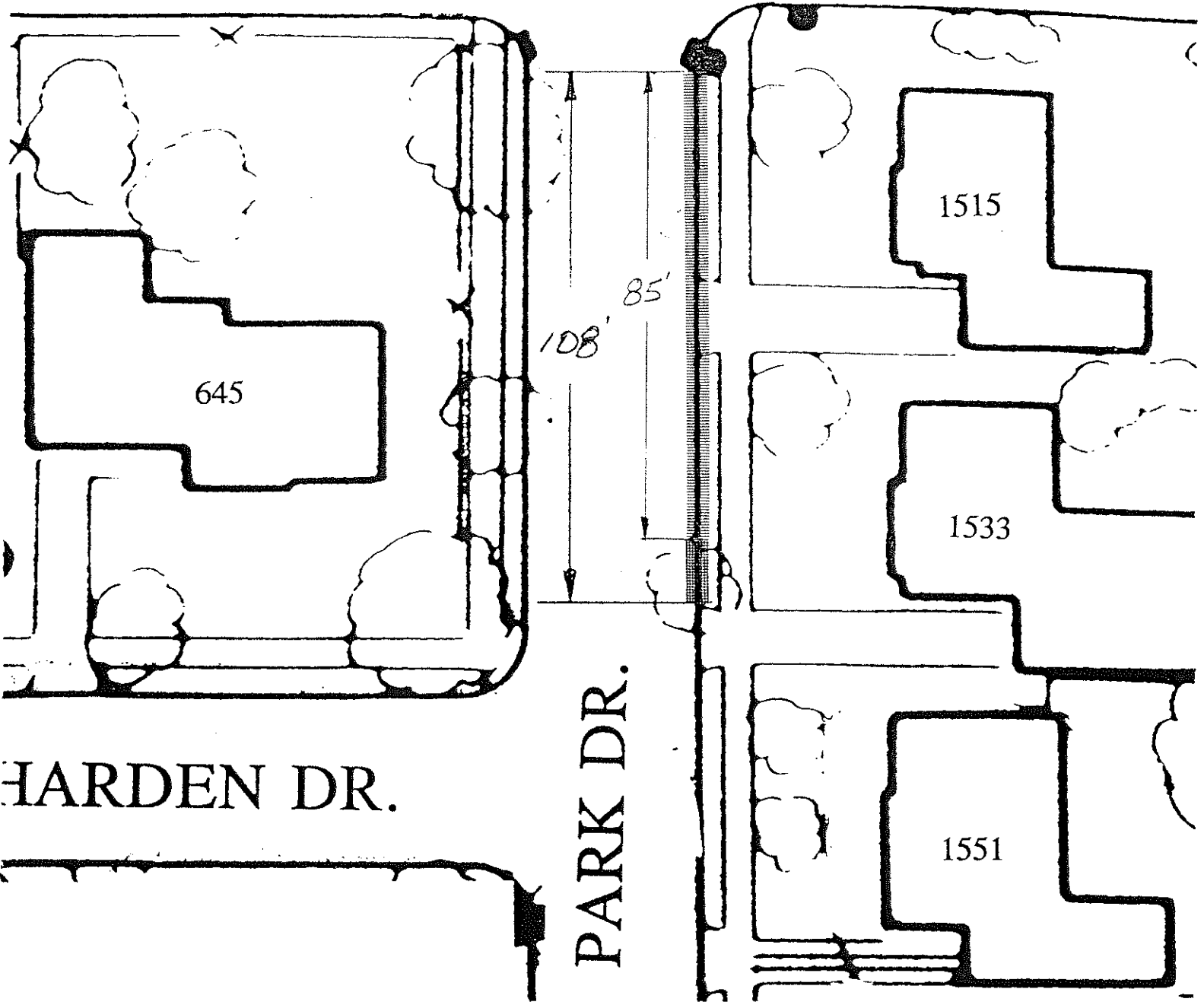

HARDEN DR.

PARK DR.

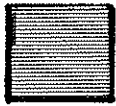

EXISTING NO PARKING ZONE



SECTION OF NO PARKING TO REMOVE



SCALE: 1"=50'

DATE: 10-30-90

DRWN BY: GAYLAN MORRIS