

A RESOLUTION PROHIBITING STREET)
PARKING ON A PORTION OF PARK ST.)

RESOLUTION NO. 43
for 1991

WHEREAS, the City Engineer has recommended that parking be prohibited to on a portion of Park Street between Sherman Street and Grant Street; and,

WHEREAS, such regulation is deemed to be necessary for the safe movement of traffic in the City of Lebanon,

NOW, THEREFORE, BE IT RESOLVED BY THE COUNCIL OF THE CITY OF LEBANON AS FOLLOWS:

Parking shall be prohibited on the west side of Park Street beginning at a point approximately 30 feet from the southern curb line of Sherman Street and extending southward a distance of 18 feet.

Suitable signs shall be erected and/or markings painted and such designation shall be part of the traffic regulation of the city of Lebanon.

This Resolution supersedes and replaces conflicting portions of previous Resolutions governing parking at this location.

Passed by the Council by a vote of 4 for and 0 against and approved by the Mayor this 11th day of September, 1991.



Mayor

ATTEST:

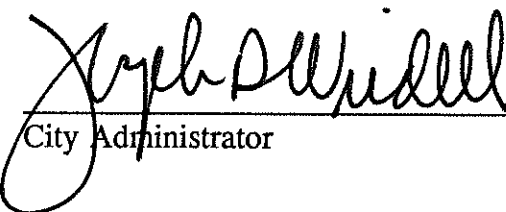

City Administrator

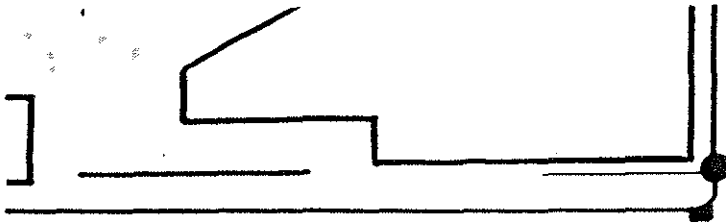

20

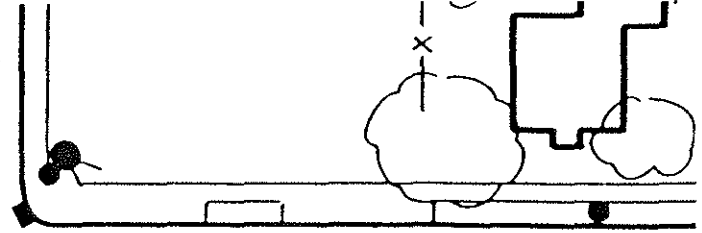

SHERMAN

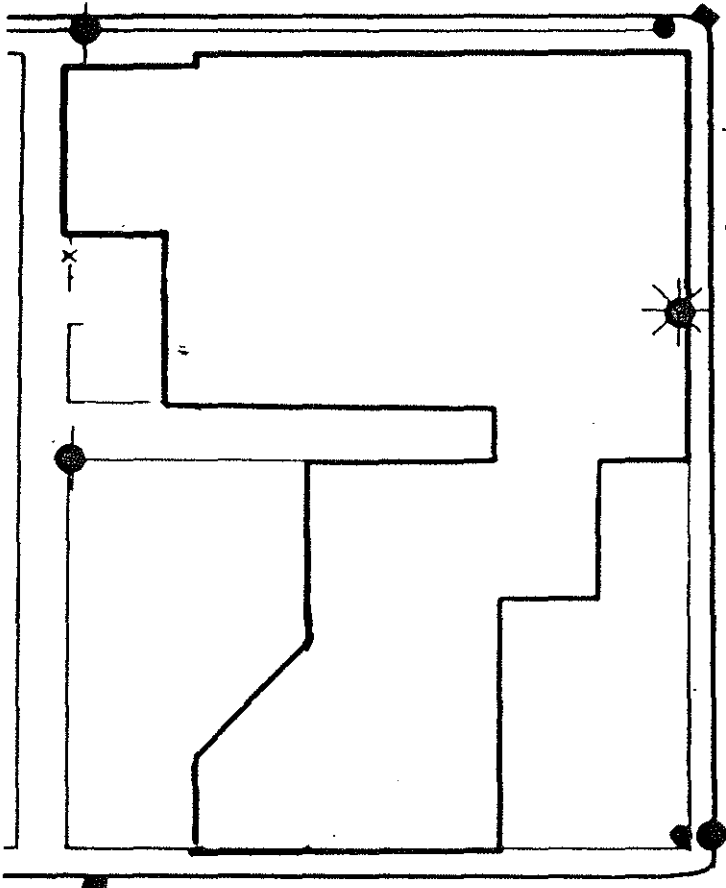

30'
NP
18'
NO PARKING ZONE

HWY

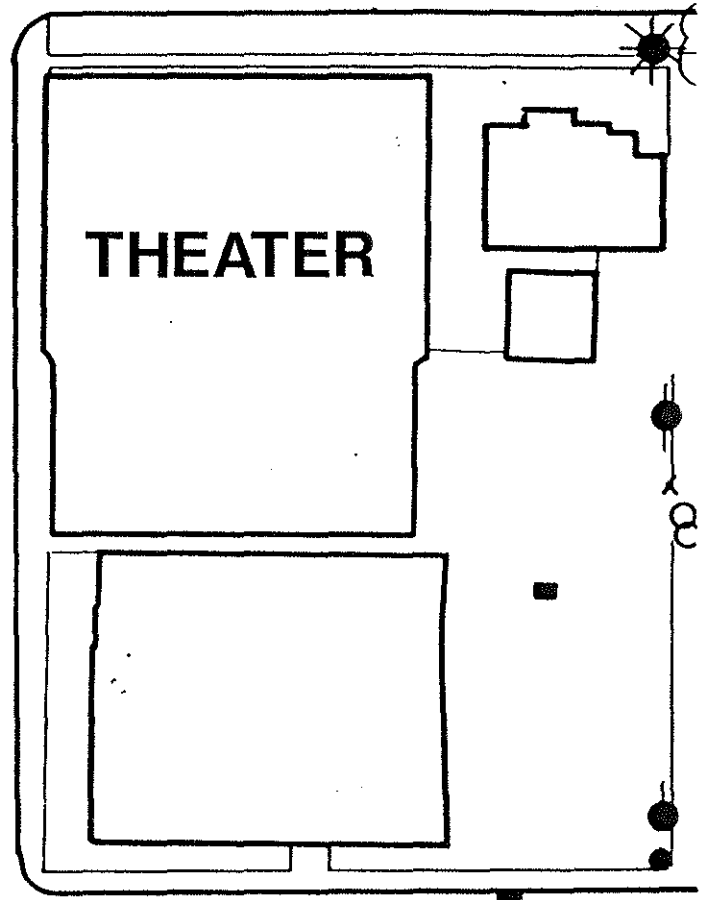

GRANT

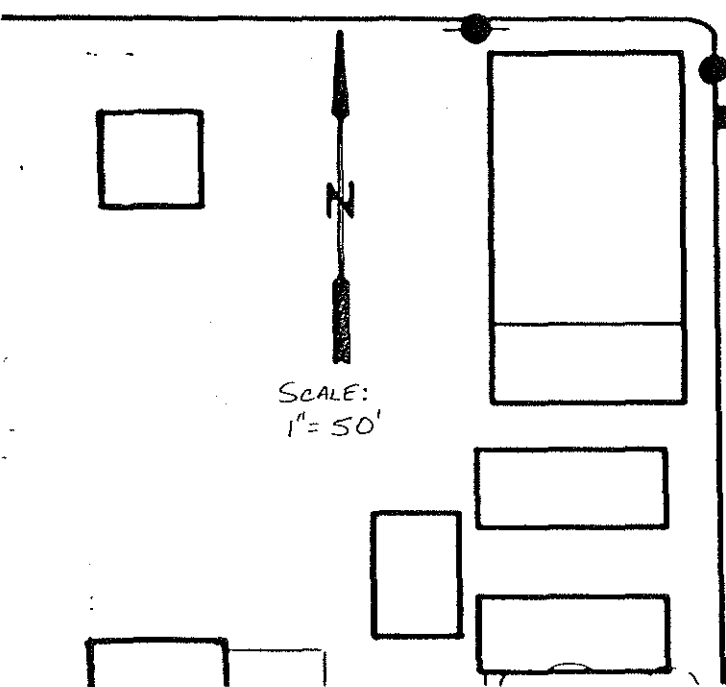

SCALE:
1" = 50'

