

A RESOLUTION REGULATING STREET)
PARKING IN THE CITY OF LEBANON)

RESOLUTION NO. 26
for 1991

WHEREAS, the City Engineer has recommended that parking be restricted to compact cars along a portion of Grove Street between Elmore Street and Milton Street.

WHEREAS, such regulation is deemed to be reasonable and necessary for the safe movement of traffic in the City of Lebanon.

NOW, THEREFORE BE IT RESOLVED BY THE COUNCIL OF THE CITY OF LEBANON AS FOLLOWS:

Parking shall be restricted to compact cars only on a portion of Grove Street beginning at a point 107 feet from the southern curb line of Elmore Street and extending southward a distance of 18 feet.

Suitable signs shall be erected and/or markings painted and such designations shall be part of the traffic regulation of the City of Lebanon.

This Resolution supersedes and replaces conflicting portions of previous Resolutions governing parking at these locations.

Passed by the Council by a vote of 6 for and 0 against and approved by the Mayor this 12th day of June, 1991.

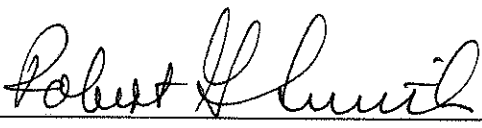

Mayor

ATTEST:

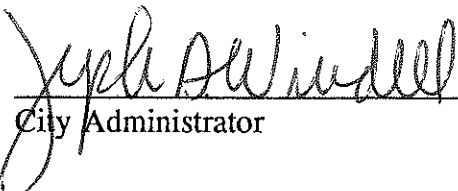

City Administrator

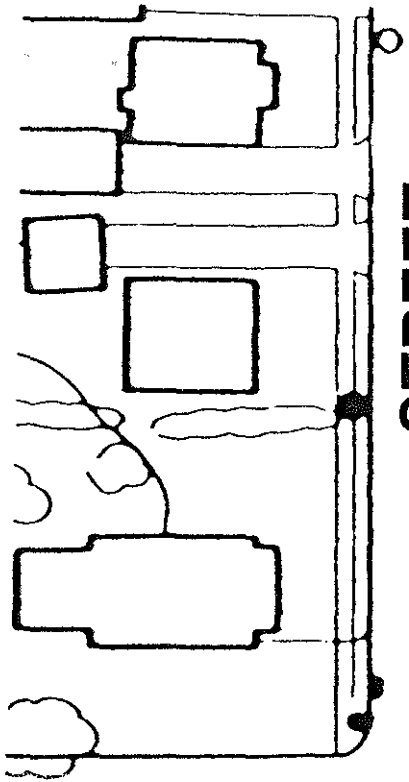

GROVE

STREET

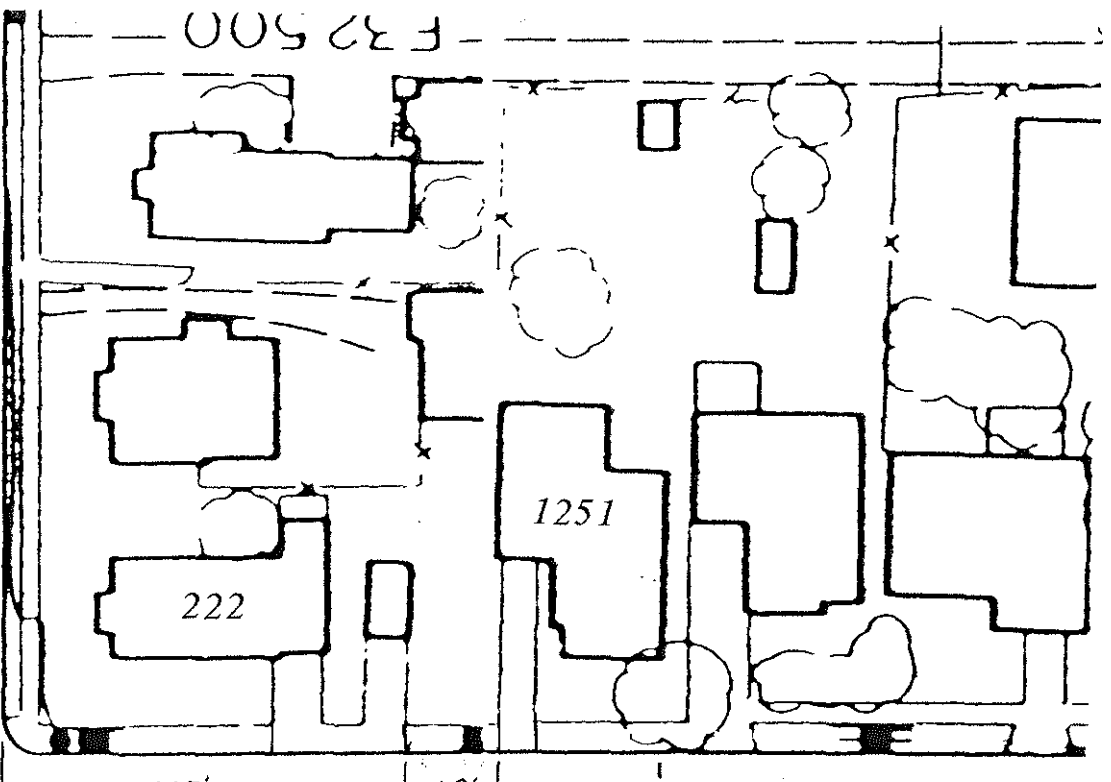

107'

18'

STREET

222

1251

F 32 500

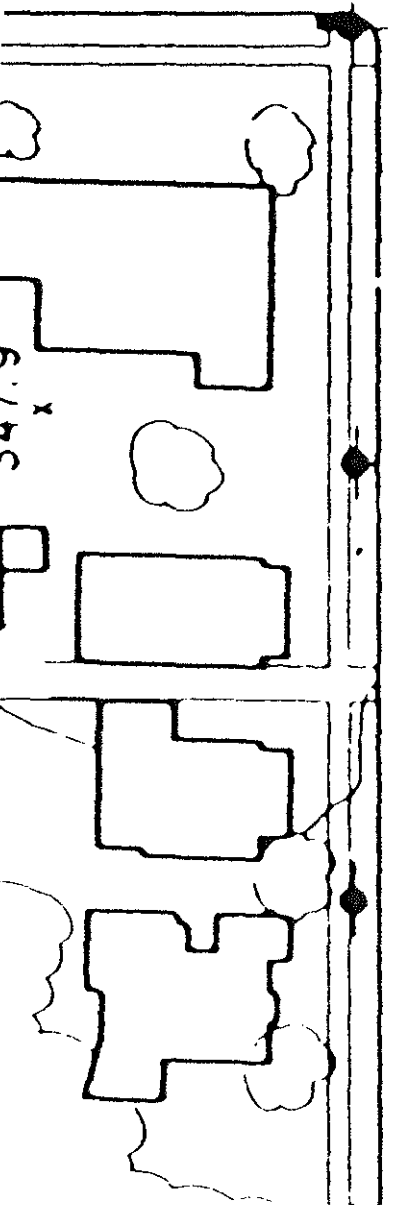

ELMORE

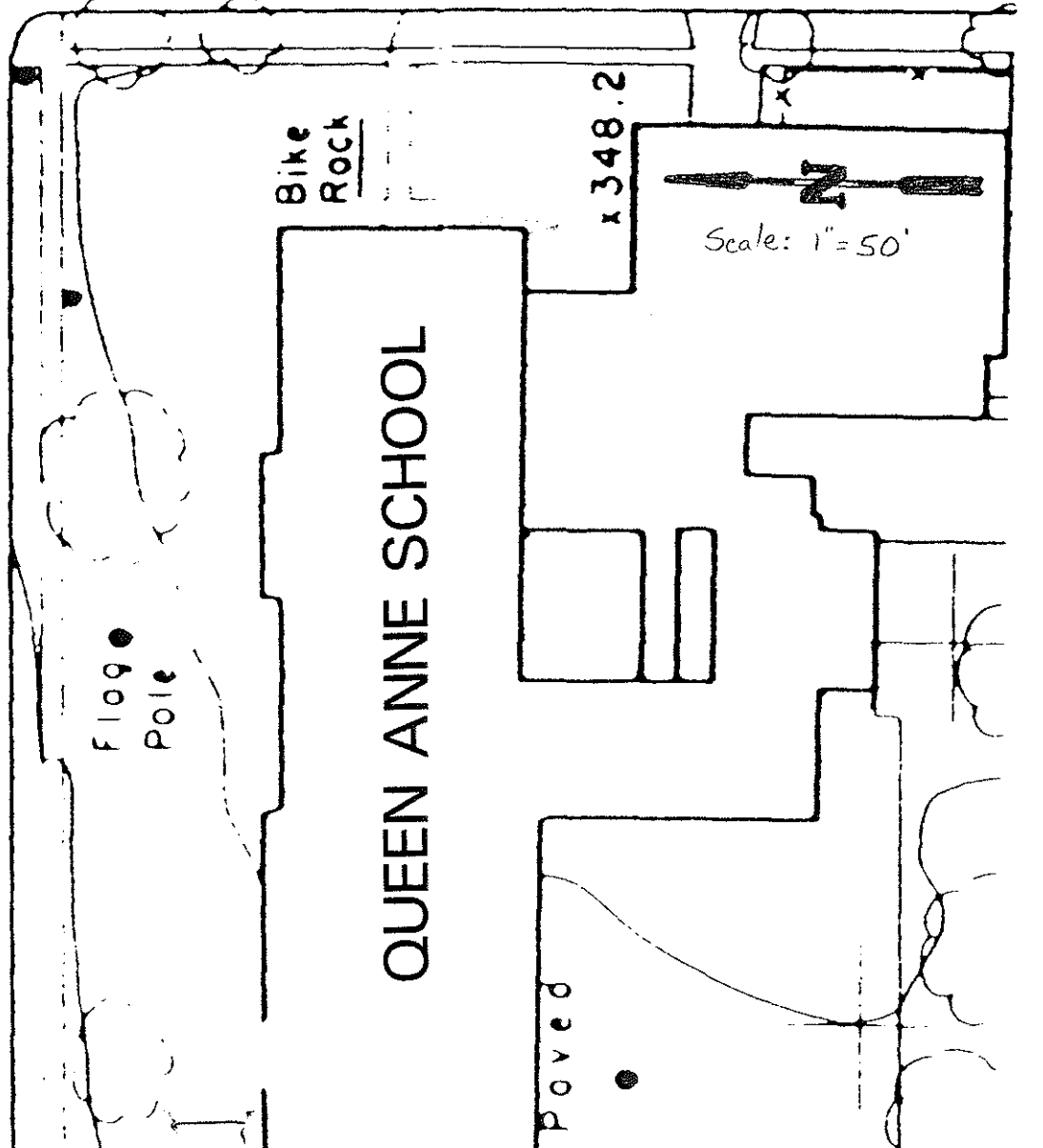

Flag Pole

Bike Rock

QUEEN ANNE SCHOOL

Paved

x 348.2

Scale: 1" = 50'



347.9'