

ORDINANCE 746-A

Introduced by Commissioner Robert L. MAY

AMENDING THE CITY OF WARRENTON COMPREHENSIVE PLAN AND ZONING MAPS, CHANGING THE DESIGNATION FOR LOTS 1-4, BLOCK 16, FIRST EXTENSION TO EAST WARRENTON, FROM LIMITED CONSERVATION AQUATIC (A-4) to MARINE COMMERCIAL (C-3); and LOTS 1-16, BLOCK 24, FIRST EXTENSION TO EAST WARRENTON FROM MARINE COMMERCIAL (C-3) to TOURIST COMMERCIAL (C-4).

THE CITY OF WARRENTON ORDAINS AS FOLLOWS:

Section 1. That in the area as described on Exhibit "A", which is the map attached hereto and by this reference incorporated herein, the comprehensive plan and zoning map of the City of Warrenton is amended from Limited Conservation Aquatic (A-4) to Marine Commercial (C-3) for Lots 1-4, Block 16; and from Marine Commercial (C-3) to Tourist Commercial (C-4) for Lots 1-16, Block 24, all said areas being in FIRST EXTENSION TO EAST WARRENTON.

Section 2. That the designation of Block 24, FIRST EXTENSION TO EAST WARRENTON, as described above and as shown on the General Land and Water Use Areas Map, Map #1 of the Comprehensive Plan, be changed from Urban Development Areas-ESWD Shorelands to Urban Development Areas-Other Shorelands.

Section 3. That the City of Warrenton Comprehensive Plan and Zoning Ordinances and Zoning Map shall be changed to conform with this ordinance.

Section 4. This amending ordinance is based on the Findings of Fact adopted by the Warrenton Planning Commission in recommendation made at its meeting of 14 March 1983, and the Warrenton City Commission at its regular meeting of this date.

First reading: 21 March 1983

Second reading: 4 APRIL 1983

Passed by the City Commission of the City of Warrenton this 4th day of APRIL 1983.

Approved by the Mayor of the City of Warrenton this 4th day of APRIL 1983.

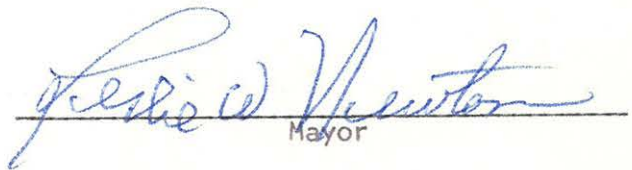

Mayor

ATTEST:



Auditor and Police Judge

Exhibit "A" - see reverse also

CITY OF WARRENTON

EXISTING ZONING

March '83

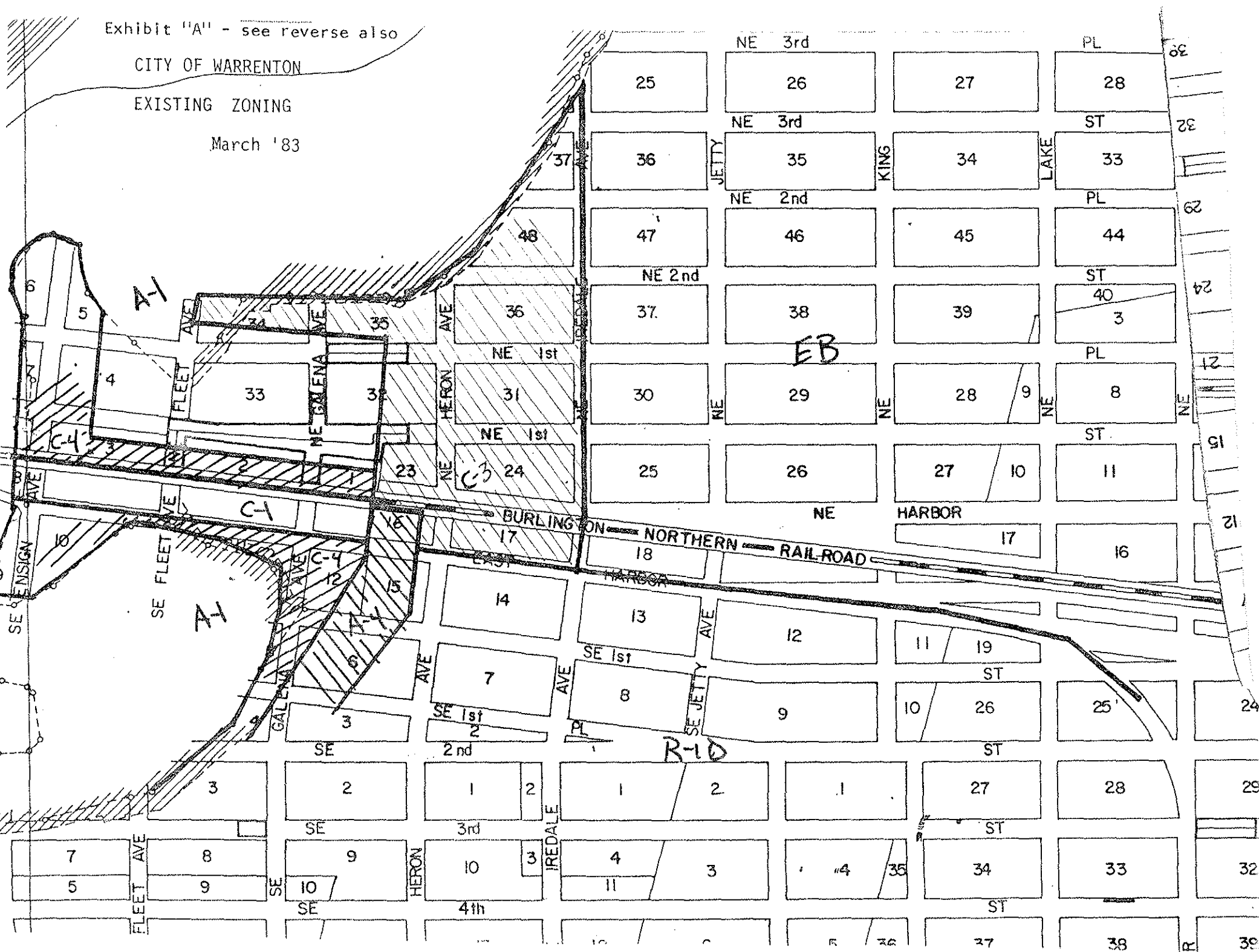
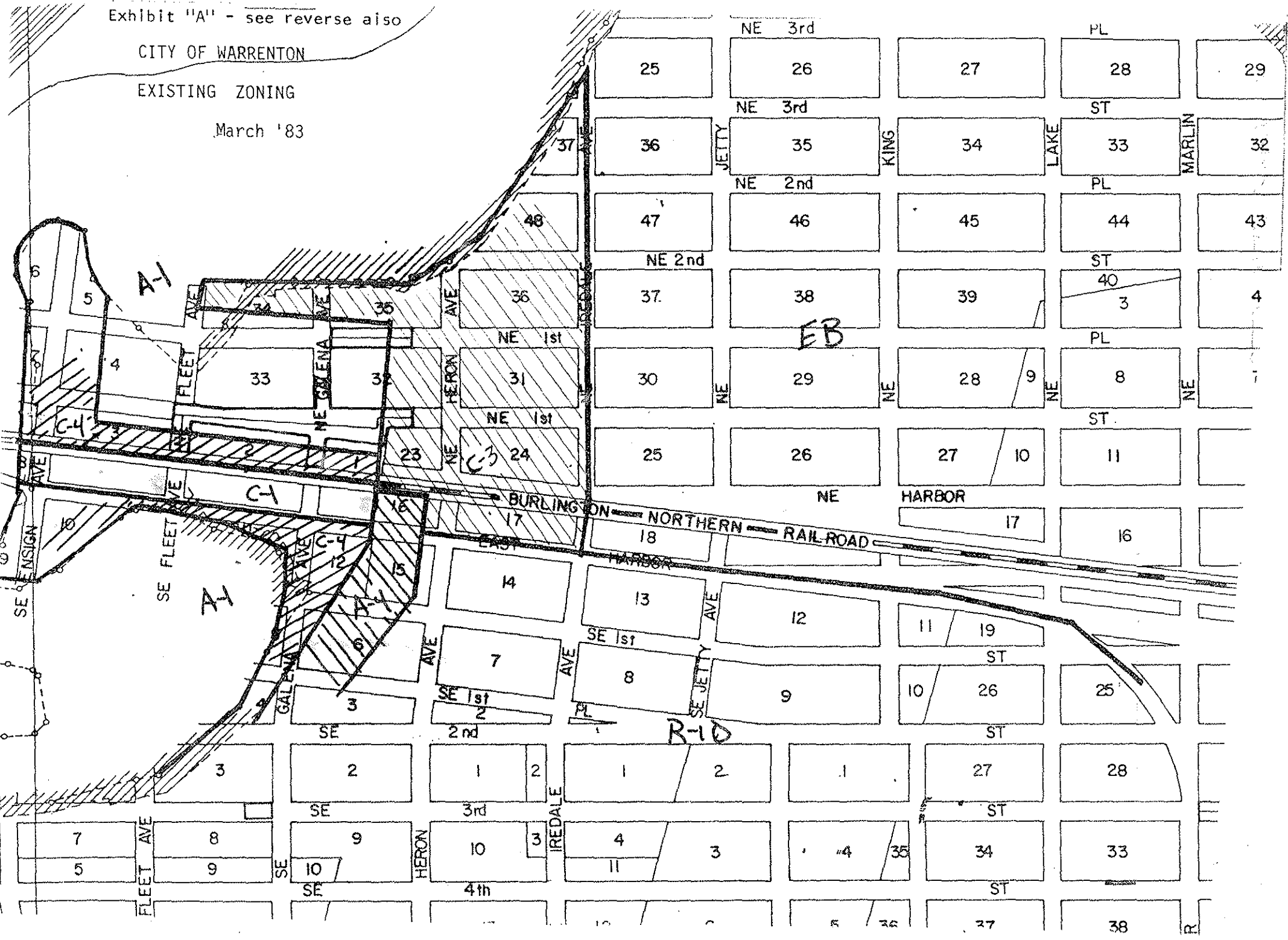

Exhibit "A" - see reverse also

CITY OF WARRENTON

EXISTING ZONING

March '83



NE 3rd

PL

25

26

27

28

29

NE 3rd

ST

36

35

34

33

32

NE 2nd

PL

48

47

46

45

44

43

NE 2nd

ST

37

38

39

40

4

NE 1st

PL

36

31

30

29

28

9

8

NE 1st

ST

33

32

25

26

27

10

11

23

24

18

17

14

13

12

NE HARBOR

17

16

10

11

7

8

9

10

11

19

26

25

3

2

1

2

1

27

28

3

4

3

4

35

34

33

7

8

9

10

11

3

4

35

34

33

3

4

35

34

33

3

4

35

34

33

3

4

35

34

33

3

4

35

34

33

3

4

35

34

33

3

4

35

34

33

3

4

35

34

33

3

4

35

34

33

3

4

35

34

33

3

4

35

34

33

3

4

35

34

33

3

4

35

34

33

3

4

35

34

33

3

4

35

34

33

3

4

35

34

33

3

4

35

34

33

3

4

35

34

33

3

4

35

34

33

3

4

35

34

33

3

4

35

34

33

3

4

35

34

33

3

4

35

34

33

3

4

35

34

33

3

4

35

34

33

3

4

35

34

33

3

4

35

34

33

3

4

35

34

33

3

4

35

34

33

3

4

35

34

33

3

4

35

34

33

3

4

35

34

33

3

4

35

34

33

3

4

35

34

33

3

4

35

34

33

3

4

35

34

33

3

4

35

34

33

3

4

35

34

33

3

4

35

34

33

3

4

35

34

33

3

4

35

34

33

3

4

35

34

33

3

4

35

34

33

3

4

35

34

33

3

4

35

34

33

3

4

35

34

33

3

4

35

34

33

3

4

35

34

33

3

4

35

34

33

3

4

35

34

33

3

4

35

34

33

3

4

35

34

33

3