

ORDINANCE NO. 717-A

Introduced by Commissioner Max BINGAMAN

AN ORDINANCE AMENDING THE ZONING AND COMPREHENSIVE PLAN MAPS OF THE CITY OF WARRENTON.

The City of Warrenton ordains as follows:

Section 1. Based on the application of the Warrenton Lumber Company, the Commission of the City of Warrenton finds that requisite notices have been given and appropriate public hearings held, and that the zoning and comprehensive plan maps of the City of Warrenton be amended to add as an overlay a priority two dredged material disposal site (DMD) on the three and one-half acre site owned by applicant, as more specifically set forth on Exhibit "A" attached hereto and by this reference incorporated herein.

Passed by the City Commission of the City of Warrenton, Oregon this 2nd day of September, 1981.

Examined and approved by the Mayor of the City of Warrenton, Oregon this 2nd day of September, 1981.

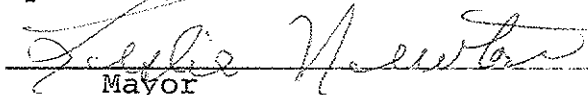
  
\_\_\_\_\_  
Mayor

ATTEST:

  
\_\_\_\_\_  
Auditor and Police Judge

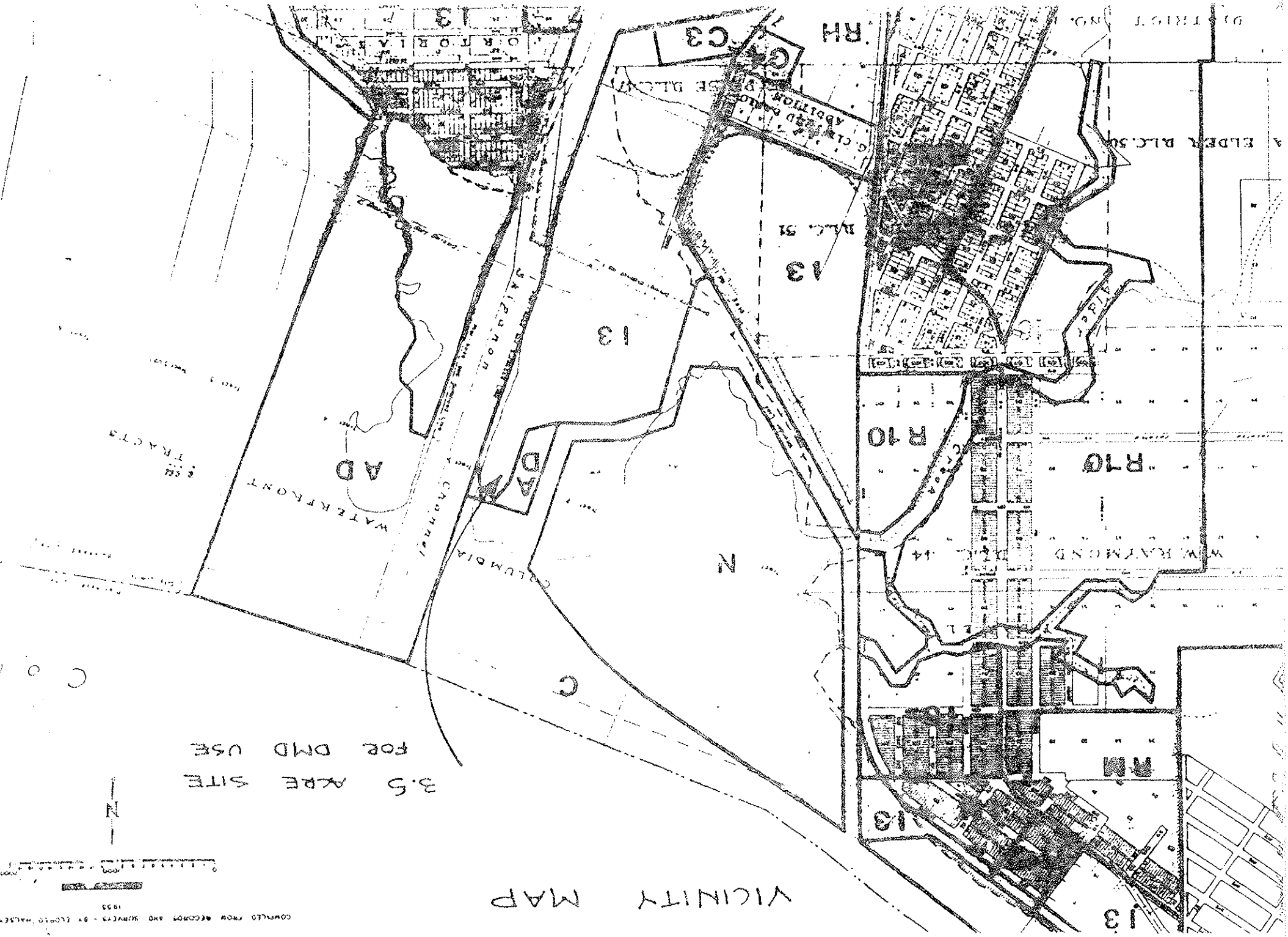

3.5 ACRE SITE  
FOR DMD USE

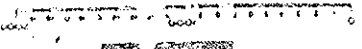

COMPILED FROM RECORDS AND SURVEYS - BY ELLIOTT WALSH & COMPANY - 1925

VICINITY MAP

# COLUMBIA RIVER

Modified Harbor Lines taken from  
Map approved by Corps of Engineers,  
U.S. Army, Pierhead Line

200  
85.60 Ac.

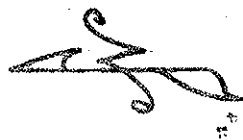

SCALE: 1"=400'

CITY LIMITS-WARRENTON

COMPREHENSIVE PLAN  
MAP CHANGE

3.5 ACRE  
PMD SITE

LOCATION MAP

## 30-04

### SKIPPANON WATERWAY

WEST BANK

EAST BANK

I-3

Map

B. O. 14

100  
94.074L

200  
85.60 Ac.

200  
85.60 Ac.

200  
85.60 Ac.

200  
85.60 Ac.

200  
85.60 Ac.

200  
85.60 Ac.

# VICINITY MAP

COMPILED FROM RECORDS AND SURVEYS - BY ELDRED HALSETT - D.  
1955

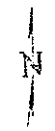
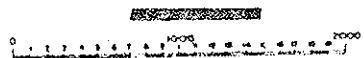

PROPOSED 3.5 ACRE SITE  
FOR DMD USE

Exhibit "A"

C 0 1

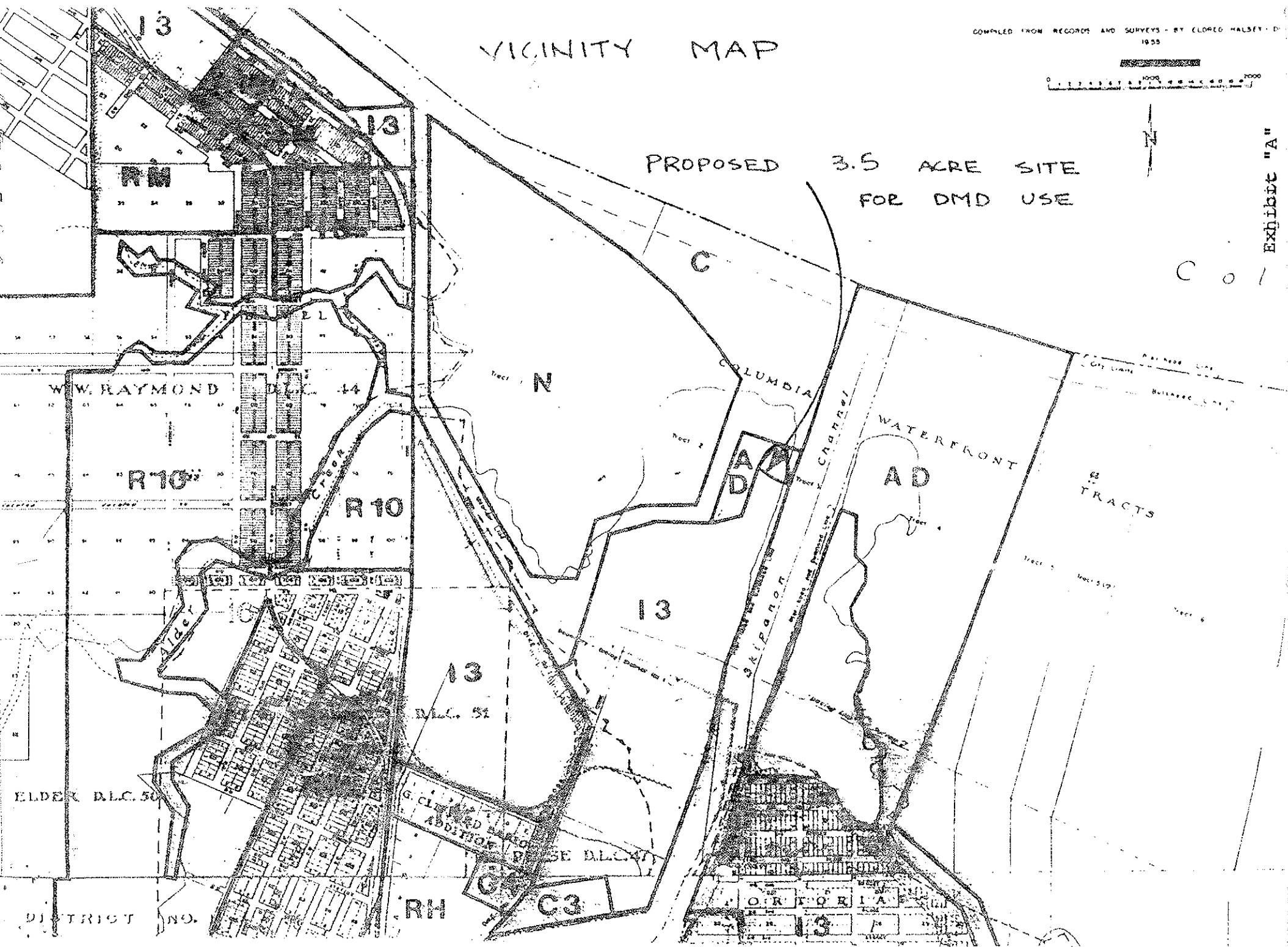

COLUMBIA RIVER

RIVER

200

96.60 Ac.

1" = 400'

Modified Harbor...  
Map approved by US ARMY CORPS OF ENGINEERS,  
PIERHEAD LINE...

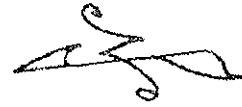

CITY LIMITS - WARRENTON

100  
94.07AL

COMBINED PIERHEAD & BURNHEAD LINE

PROPOSED 3.5  
ACRE DMD  
SITE.

WATERWAY

EAST BANK

WEST BANK

30-04

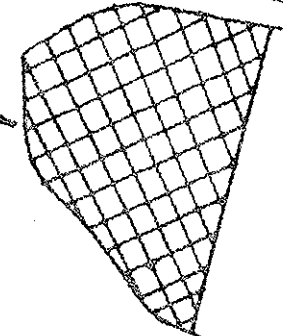

8 0 14

BE MOD