

R E S O L U T I O N N O. 65 -73

WHEREAS, under the provisions of ORS 366.800 and 366.805 there has been withdrawn from state highway funds appropriated for allocation to the several cities of the State of Oregon the sum of Two Hundred Fifty Thousand and No/100 (\$250,000) Dollars, and said sum has been set up in a separate account to be administered by the State Highway Commission and to be spent each year by said Commission upon streets not a part of the state highway system, within cities, which are receiving excessive wear through sudden increases in population in the area or heavy and unusual traffic; and

WHEREAS, the City of TROUTDALE is an incorporated city of the State of Oregon and has a population of 1680 as given by the latest official census; and

WHEREAS, the following streets of said city, of Troutdale.

S. E. 8th Street, East of Buxton Street to Harlow Street, regular 50'

This street has heavy traffic due to school buses and is in need of
repair for which the City is in need of assistance.

are not a part or parts of the state highway system, but are streets under the jurisdiction and control of said city which are "receiving excessive wear through sudden increase in population in the area, or heavy and unusual traffic," and

WHEREAS, said streets are and each of them is in need of repair, reconditioning, and other major improvement,

NOW, THEREFORE, the members of the City Council, in regular or special session assembled, do hereby find, declare, and resolve:

1. That the aforesaid named streets of said city are in need of repair, reconditioning, and other major improvement.
2. That said streets are in their present state and condition of disrepair by reason of excessive wear through sudden increases in population in the area, or by heavy and unusual traffic.
3. That the Oregon State Highway Commission hereby is respectfully requested to consider and declare said streets as qualified for reconditioning, repair, and other improvement out of funds allocated and made available by and through the said \$250,000 appropriation of state highway revenues which is to be administered and spent by the Highway Commission.

4. That the City of Troutdale does hereby offer to State Highway Commission, and does hereby pledge complete cooperation and assistance to the end that said city may share and participate in the use and benefit of said special fund and appropriation; and therefore does designate Mayor R. M. Sturges as the official representative of the city in all negotiations resulting from this request.

Passed and approved this 8th day of May, 1973.

There is attached hereto and made a part hereof, a city map on which is indicated the street, streets, road, or roads described in this resolution.

I hereby certify that the foregoing resolution was passed and approved by the City Council of the City of Troutdale at a regular or special meeting of said Council, held on the 8th day of May, 1973, and the above copy is a true and correct copy of the original and of the whole thereof.

Dated this 8th day of May, 1973.

Louise D. Wright
City Recorder

(MATCH TO SHEET 1)

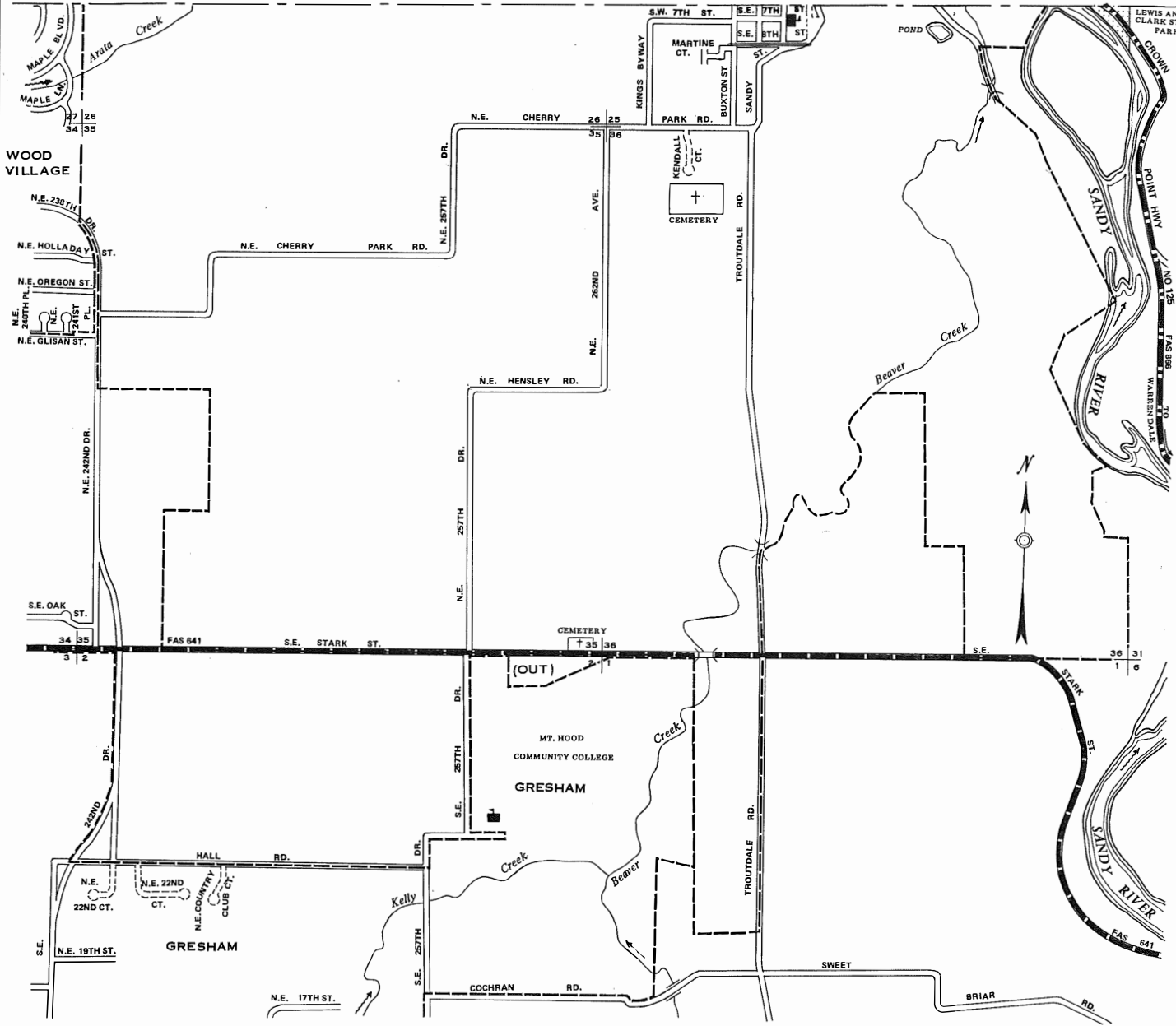

T1N T1S R3E W.M.

TROUTDALE

MULTNOMAH COUNTY, OREGON

- FEDERAL AID INTERSTATE SYSTEM
- FEDERAL AID PRIMARY SYSTEM
- FEDERAL AID SECONDARY SYSTEM-STATE
- FEDERAL AID SECONDARY SYSTEM-COUNTY
- OTHER FEDERAL AID SECONDARY-LOCAL
- TERMINATION OF FA SYSTEM
- TERMINATION OF ROUTE
- DIVIDED HIGHWAY
- UNDIVIDED HIGHWAY-NO. OF LANES
- STREET OPEN FOR TRAVEL
- STREET DEDICATED BUT NOT OPEN

LEGEND

- INTERSTATE NUMBERED ROUTE (FAI)
- U.S. NUMBERED ROUTE
- STATE NUMBERED ROUTE
- POST OFFICE
- SCHOOL
- CITY CENTER
- R.R. DEPOT
- CITY LIMITS
- PUBLIC BLDG.
- CITY HALL
- COURT HOUSE
- ARMORY
- LIBRARY

PREPARED BY THE
 OREGON STATE HIGHWAY DEPARTMENT
 IN COOPERATION WITH THE
 U.S. DEPARTMENT OF TRANSPORTATION
 FEDERAL HIGHWAY ADMINISTRATION

Population 1,300
 Scale in Feet

 Revised June 1970

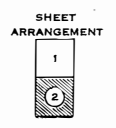

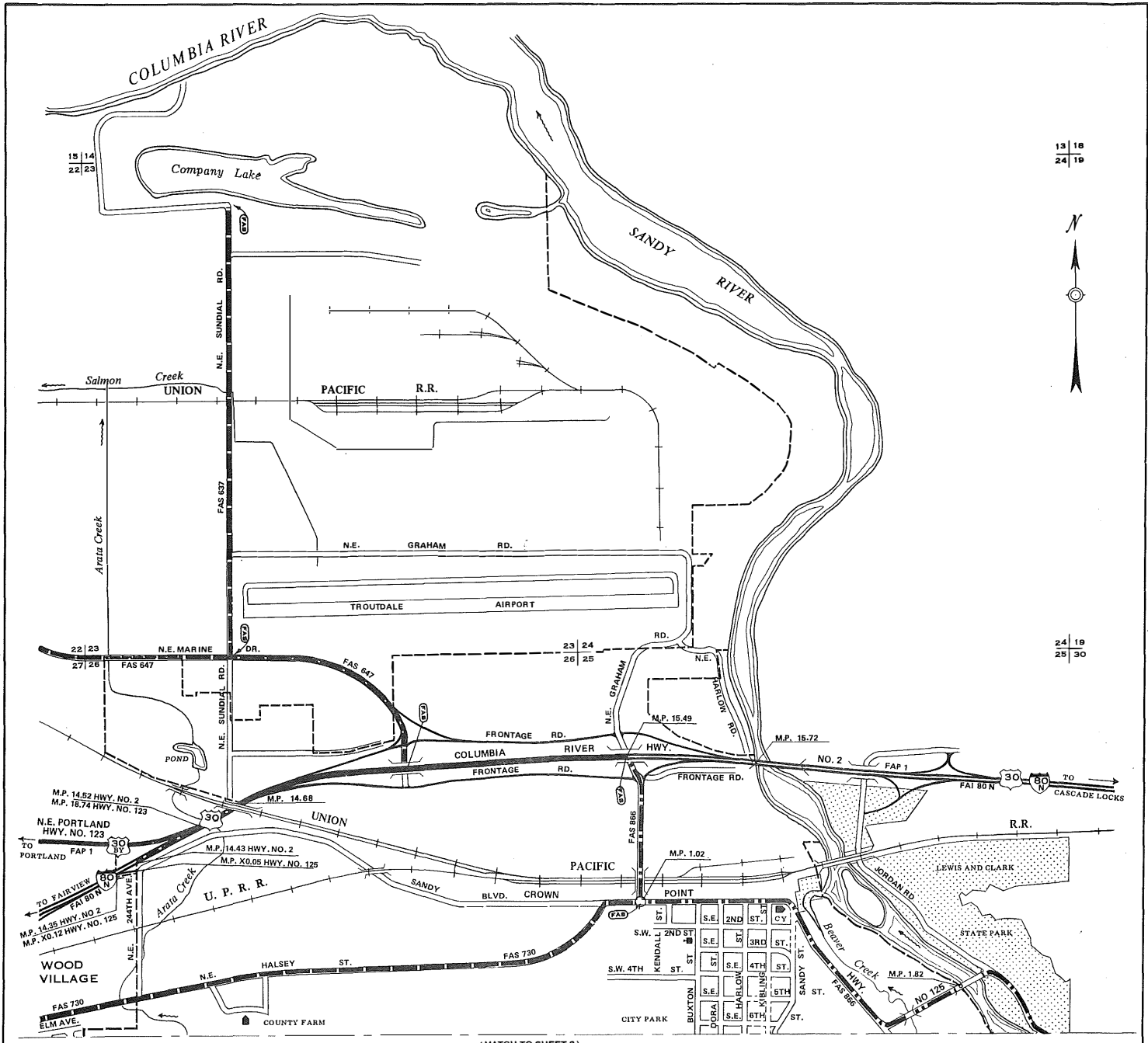

13 18
24 19



24 19
25 30

(MATCH TO SHEET 2)

TIN R3E W.M.

TROUTDALE

MULTNOMAH COUNTY, OREGON

LEGEND

- FEDERAL AID INTERSTATE SYSTEM
- FEDERAL AID PRIMARY SYSTEM
- FEDERAL AID SECONDARY SYSTEM-STATE
- FEDERAL AID SECONDARY SYSTEM-COUNTY
- OTHER FEDERAL AID SECONDARY-LOCAL
- TERMINATION OF FA SYSTEM
- TERMINATION OF ROUTE
- DIVIDED HIGHWAY
- UNDIVIDED HIGHWAY-NO. OF LANES
- STREET OPEN FOR TRAVEL
- STREET DEDICATED BUT NOT OPEN

- INTERSTATE NUMBERED ROUTE (FAI)
- U.S. NUMBERED ROUTE
- STATE NUMBERED ROUTE
- POST OFFICE
- SCHOOL
- CITY CENTER
- R.R. DEPOT
- CITY LIMITS
- PUBLIC BLDG.
- CITY HALL
- COURT HOUSE
- ARMORY
- LIBRARY

FINANCED BY THE
OREGON STATE HIGHWAY DEPARTMENT

IN COOPERATION WITH THE
U.S. DEPARTMENT OF TRANSPORTATION
FEDERAL HIGHWAY ADMINISTRATION
BUREAU OF PUBLIC ROADS

Population 643

Scale in Feet

March 1969

SHEET ARRANGEMENT



SHEET 1 OF 2 SHEETS