

# RESOLUTION NO. 1944

## A RESOLUTION RECOGNIZING THE COMPLETION OF THE PUBLIC IMPROVEMENTS ASSOCIATED WITH THE TYSON'S PLACE RESIDENTIAL SUBDIVISION AND ACCEPTING THEM INTO THE CITY'S FIXED ASSET SYSTEM.

### THE TROUTDALE CITY COUNCIL FINDS AS FOLLOWS:

1. The construction of the public improvements associated with the Tyson's Place subdivision was necessary to meet the demands of public health, safety, and welfare.
2. The construction of these public improvements has now been completed.
3. The public improvements have been inspected and found to be in compliance with the City of Troutdale *Construction Standards for Public Works Facilities* and the construction plans and specifications.

### NOW, THEREFORE, BE IT RESOLVED BY THE COUNCIL OF THE CITY OF TROUTDALE

Section 1. The following public improvements associated with the Tyson's Place subdivision are accepted into the City's fixed asset system, valued as follows:

<u>Improvement</u>	<u>Estimated Value</u>
Sanitary sewer system, consisting of 290 linear feet of 8" PVC sewer main and 5 manholes as shown on Sheet 2 of the project as-builts.	\$31,660
Stormwater collection and conveyance system, consisting of 300 linear feet of 18" ADS-N12 storm main, 50 linear feet of 12" ADS-N12 storm main, 4 manholes, 1 water quality manhole, and 2 catch basins as shown on Sheet 3 of the project as-builts.	\$51,950
Water system, consisting of 280 linear feet of 8" ductile iron water main, one 8" gate valve, and one blow-off assembly as shown on Sheet 1 of the project as-builts.	\$21,430
On-site 28' wide paved street (SW 10 <sup>th</sup> Way), consisting of base rock and asphalt surfacing as shown on Sheets 3 & 4 of the project as-builts.	\$36,580

On-site pedestrian facilities, consisting of 215 linear feet of 5-foot-wide sidewalk and two ADA ramps as shown on Sheet 3 of the project as-builts.	\$6,900
On-site curb and gutter, consisting of 725 linear feet of curb and gutter as shown on Sheet 3 of the project as-builts.	\$10,875
On-site emergency access, consisting of base rock and "GrassPave2" pervious surfacing as shown on Sheets 3 & 4 of the project as-builts.	\$3,686
<b>Total Estimated Value:</b>	<b>\$163,081</b>

Section 2. This resolution is effective upon adoption.

**YEAS: 6**  
**NAYS: 0**  
**ABSTAINED: 0**

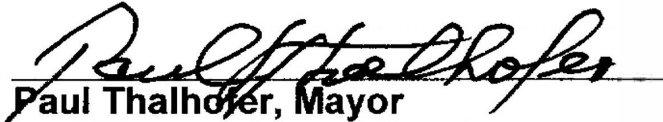
  
 Paul Thalhofer, Mayor  
 June 11, 2008  
 \_\_\_\_\_  
 Date

  
 Debbie Stickney, City Recorder

**Adopted: June 10, 2008**

**Exhibit A**

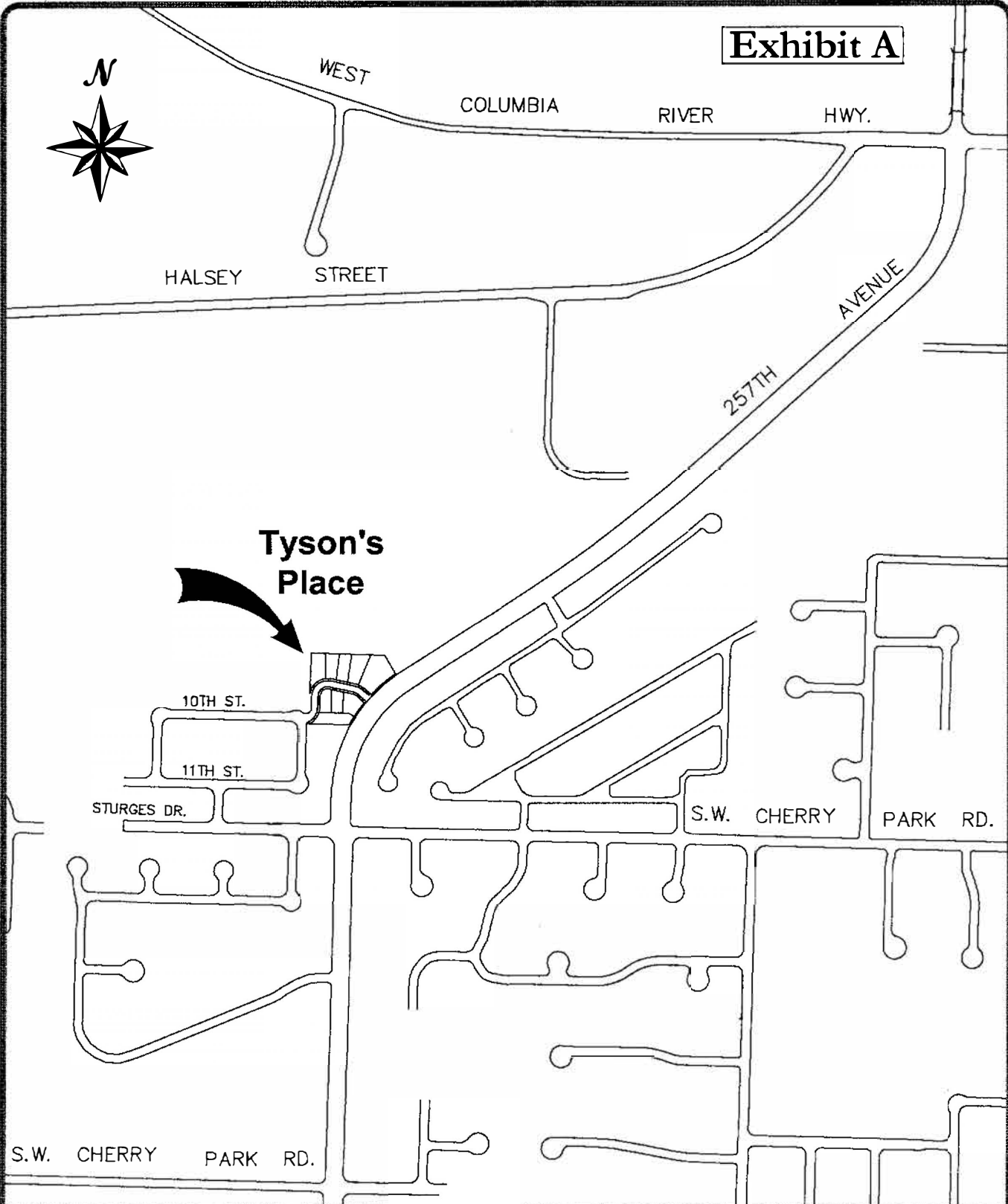

FILE NAME: *Acceptance Vicinity Map*  
TITLE BLOCK: *TB8X11*  
EXTERNAL REFERENCES: *NONE*  
PLOT DATE: *5-20-2008*  
BY: *O.S.*  
PREVIOUS REVISION DATE: *NONE*



DEPARTMENT OF PUBLIC WORKS  
CITY OF TROUTDALE

**Vicinity Map**

MULTNOMAH COUNTY, OREGON  
May 2008