

RESOLUTION NO. 1859

A RESOLUTION APPROVING THE ANNEXATION OF APPROXIMATELY 569 ACRES OF REAL PROPERTY (LAND USE FILE NO. 06-096 REYNOLDS PROPERTY ANNEXATION) AND ADOPTING FINDINGS

THE TROUTDALE CITY COUNCIL FINDS AS FOLLOWS:

1. The affected territory is generally described by the County Assessor Tax Map numbers as 1N3E14-00100; 1N3E22-00200 and -00302; 1N3E23-00100, -00101; 00200, -00300, -00400 and -00500; 1N3E23B-00200, -00600, -00700 and -00800; 1N3E24-00400 and includes NW Sundial Road right-of-way, as specifically described in Exhibit A Legal Description of Affected Territory and mapped in Exhibit B.
2. Pursuant to Troutdale Development Code 6.010 Annexation Criteria, the proposal for annexation of the affected territory to the City of Troutdale was conducted as a Type IV Quasi-Judicial procedure. The Director determined that the affected territory is eligible for annexation, as it is entirely within the Urban Growth Boundary.
3. Pursuant to Troutdale Development Code 16.030 Notice of Hearing, a public hearing was held before the Troutdale Planning Commission on January 24, 2007, and a hearing was held before the City Council on February 27, 2007, to consider annexation of the affected territory into the City of Troutdale.
5. Pursuant to Troutdale Development Code 6.010(A), the proposed annexation conforms to the City of Troutdale Comprehensive Land Use Plan goals and policies.
6. Pursuant to Troutdale Development Code 6.010(B), inclusion of the affected territory within the City of Troutdale is consistent with the purpose served by the City of Troutdale.

7. Pursuant to Metro Code §3.09.050(d), the annexation is consistent with the City-County Urban Planning Area Agreement of 1998; is consistent with the City's Comprehensive Land Use Plan; is consistent with the Metro Regional Framework and Functional Plans; will promote the timely, orderly and economic provisions of public facilities and services; and is consistent with other applicable criteria for annexation under state and local laws. Upon annexation, the City of Troutdale Public Works, City of Troutdale Police Department, and Reynolds School District will provide urban services to the affected territory. Upon annexation, the affected territory will be removed from the Multnomah County Sheriff's service area.
8. The affected territory lies within Multnomah County R.F.P.D. #10, but obtains fire service from Gresham Fire and Emergency Services via a contract with the Fire District. Upon annexation, the affected territory will be withdrawn from R.F.P.D. #10. Gresham Fire and Emergency Services will continue to provide fire service to the affected territory under its contract with the City of Troutdale.
9. Notices of the public hearings were provided in accordance with applicable laws.
 - Property owners within 250-feet of the Affected Territory were notified in writing on or before December 13, 2006, of the January 24, 2007 hearing before the Planning Commission.
 - The Affected Territory was posted in three places with the annexation request on January 2, 2007, giving notice of the January 24, 2007 hearing before the Planning Commission.
 - A notice of the January 24, 2007 hearing before the Planning Commission was published in the *Gresham Outlook* on January 13, 2007.
 - Property owners within 250-feet of the Affected Territory were notified in writing on February 2, 2007 of the February 27, 2007 hearing before the City Council.
 - The Affected Territory was posted in three places with the annexation request on or before February 10, 2007, giving notice of the February 27, 2007 hearing before the City Council.
 - Notice of the February 27, 2007, hearing before Council was posted in four public places within the City on or before February 10, 2007.
 - Notice of the February 27, 2007 hearing before Council was published in the *Gresham Outlook* on February 10, 17 and 24, 2007.

NOW THEREFORE BE IT RESOLVED BY THE COUNCIL OF THE CITY OF TROUTDALE

Section 1: Annexation. Based on these findings, the affected territory consisting of 24,772,572 square feet (568.7 acres), inclusive of the abutting right-of-way of NW Sundial road, specifically described in Exhibit A Legal Description of Affected Territory and as mapped in Exhibit B Map of Affected Territory, is hereby annexed into the corporate limits of the City of Troutdale.

Section 2: Withdrawal from Rural Fire Protection District No. 10. The property is also hereby withdrawn from Multnomah County R.F.P.D. #10 on the effective date of the annexation.

Section 3: Effective Date: This resolution shall be effective immediately.

**YEAS: 7
NAYS: 0
ABSTAINED: 0**

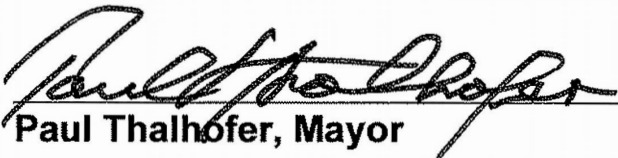
Paul Thalhofer, Mayor

Dated: February 28, 2007

Debbie Stickney, City Recorder

Adopted: February 27, 2007

CITY OF TROUTDALE
ANNEXATION DESCRIPTION

A TRACT OF LAND SITUATED IN THE SOUTHWEST AND SOUTHEAST ONE-QUARTERS OF SECTION 14, NORTHWEST ONE-QUARTER OF SECTION 22, NORTHWEST, NORTHEAST, SOUTHEAST AND SOUTHWEST ONE-QUARTERS OF SECTION 23, NORTHWEST AND SOUTHWEST ONE-QUARTERS OF SECTION 24, TOWNSHIP 1 NORTH, RANGE 3 EAST, WILLAMETTE MERIDIAN, MULTNOMAH COUNTY, OREGON BEING MORE PARTICULARLY DESCRIBED AS FOLLOWS:

BEGINNING AT A STONE WITH AN "X" AT THE NORTHWEST CORNER OF THE EAST-HALF OF THE CHARLES FEZETT DONATION LAND CLAIM NO. 47, SAID NORTHWEST CORNER BEING THE NORTH TERMINUS OF THE DIVISION LINE BETWEEN THE EAST AND WEST HALVES OF SAID CHARLES FEZETT DONATION LAND CLAIM; THENCE, ALONG THE NORTHERLY EXTENSION OF SAID DIVISION LINE, NORTH $00^{\circ}15'03''$ WEST, 1,638.10 FEET TO THE NORTH LINE OF THAT TRACT OF LAND DESCRIBED IN DEED TO REYNOLDS METAL COMPANY, RECORDED IN DEED BOOK 2120, PAGE 683 ON JUNE 14, 1962 IN THE MULTNOMAH COUNTY DEED RECORDS, SAID POINT BEING ON THE CENTERLINE OF A DRAINAGE DIKE; THENCE, ALONG SAID NORTH LINE THE FOLLOWING NINE (9) COURSES: 1) NORTH $80^{\circ}43'34''$ EAST, 110.06 FEET ; 2) THENCE NORTH $84^{\circ}22'04''$ EAST, 529.10 FEET; 3) THENCE NORTH $81^{\circ}40'34''$ EAST, 299.90 FEET; 4) THENCE NORTH $85^{\circ}14'34''$ EAST, 334.20 FEET; 5) THENCE NORTH $88^{\circ}21'34''$ EAST, 592.14 FEET; 6) THENCE NORTH $88^{\circ}13'17''$ EAST, 706.60 FEET; 7) THENCE NORTH $88^{\circ}11'56''$ EAST, 649.79 FEET; 8) THENCE NORTH $83^{\circ}52'53''$ EAST, 544.17 FEET; 9) THENCE SOUTH $89^{\circ}07'07''$ EAST, 182.40 FEET TO A POINT AT THE CENTERLINE TERMINUS OF NW SUNDIAL ROAD; THENCE, ALONG THE NORTHERLY EXTENSION OF THE CENTERLINE OF SAID NW SUNDIAL ROAD, NORTH $00^{\circ}16'42''$ WEST, 1655.39 FEET MORE OR LESS TO THE ORDINARY HIGH WATER OF THE COLUMBIA RIVER; THENCE ALONG THE ORDINARY HIGH WATERLINE OF THE COLUMBIA AND SANDY RIVERS THE FOLLOWING THIRTY-FOUR (34) COURSES: 1) SOUTH $78^{\circ}23'17''$ EAST, 191.56 FEET; 2) THENCE SOUTH $70^{\circ}23'26''$ EAST, 97.42 FEET; 3) THENCE NORTH $89^{\circ}07'37''$ EAST, 103.02 FEET; 4) THENCE SOUTH $75^{\circ}51'20''$ EAST, 148.58 FEET; 5) THENCE SOUTH $78^{\circ}14'13''$ EAST, 157.43 FEET; 6) THENCE SOUTH $74^{\circ}18'33''$ EAST, 104.34 FEET; 7) THENCE NORTH $63^{\circ}01'48''$ EAST, 153.81 FEET; 8) THENCE SOUTH $68^{\circ}54'19''$ EAST, 116.32 FEET; 9) THENCE SOUTH $85^{\circ}06'24''$ EAST, 127.65 FEET; 10) THENCE SOUTH $80^{\circ}10'53''$ EAST, 111.57 FEET; 11) THENCE SOUTH $83^{\circ}31'21''$ EAST, 140.91 FEET; 12) THENCE SOUTH $75^{\circ}45'30''$ EAST, 125.40 FEET; 13) THENCE SOUTH $77^{\circ}57'29''$ EAST, 164.44 FEET; 14) THENCE SOUTH $83^{\circ}59'15''$ EAST, 169.31 FEET; 15) THENCE SOUTH $75^{\circ}53'29''$ EAST, 253.98 FEET; 16) THENCE SOUTH $79^{\circ}45'27''$ EAST, 157.48 FEET; 17) THENCE SOUTH $74^{\circ}49'55''$ EAST, 126.98 FEET; 18) THENCE SOUTH $72^{\circ}25'31''$ EAST, 138.38 FEET; 19) THENCE SOUTH $61^{\circ}31'41''$ EAST, 55.35 FEET; 20) THENCE SOUTH $55^{\circ}10'27''$ EAST, 314.18 FEET; 21) THENCE SOUTH $29^{\circ}33'26''$ EAST, 94.23 FEET; 22) THENCE SOUTH $36^{\circ}03'27''$ EAST, 93.83 FEET; 23) THENCE SOUTH $31^{\circ}16'02''$ EAST, 82.56 FEET; 24) THENCE SOUTH $31^{\circ}19'16''$ EAST, 110.34 FEET; 25) THENCE SOUTH $26^{\circ}25'50''$ EAST, 119.34 FEET; 26) THENCE SOUTH $30^{\circ}58'43''$ EAST, 159.29 FEET; 27) THENCE SOUTH $23^{\circ}31'40''$ EAST, 74.72 FEET; 28) THENCE SOUTH $23^{\circ}58'13''$ EAST, 107.25 FEET; 29) THENCE SOUTH $40^{\circ}37'19''$ EAST, 144.39 FEET; 30) THENCE SOUTH $31^{\circ}45'00''$ EAST, 127.55 FEET; 31) THENCE SOUTH $34^{\circ}34'58''$ EAST, 184.20 FEET; 32) THENCE SOUTH $49^{\circ}50'19''$ EAST, 78.77 FEET; 33) THENCE SOUTH $23^{\circ}31'12''$ EAST, 91.68 FEET; 34) THENCE SOUTH $19^{\circ}57'32''$ EAST, 1.38

FEET TO A POINT ON THE EAST LINE OF THAT TRACT OF LAND CONVEYED TO THE DEFENSE PLANT CORPORATION IN DEED BOOK 647, PAGE 16 ON NOVEMBER 5, 1941 IN MULTNOMAH COUNTY DEED RECORDS; THENCE, ALONG SAID EAST LINE, SOUTH 00° 18'25" EAST, 696.33 FEET TO THE SOUTHERLY RIGHT-OF-WAY LINE OF THE SANDY DRAINAGE DISTRICT, AS SHOWN ON THE US ARMY CORPS OF ENGINEERS PLAT, RECORDED IN PLAT BOOK 1178, PAGE 25 ON JUNE 12, 1940, MULTNOMAH COUNTY PLAT RECORDS; THENCE, ALONG SAID SOUTHERLY RIGHT-OF-WAY LINE THE FOLLOWING EIGHT (8) COURSES: 1) SOUTH 75° 18'59" EAST, 225.65 FEET; 2) THENCE SOUTH 65° 58'59" EAST, 698.35 FEET; 3) THENCE SOUTH 59° 41'59" EAST, 254.19 FEET; 4) THENCE SOUTH 55° 53'59" EAST, 186.77 FEET; 5) THENCE SOUTH 61° 49'59" EAST, 321.73 FEET; 6) THENCE SOUTH 61° 18'59" EAST, 310.15 FEET; 7) THENCE NORTH 28° 41'01" EAST, 50.00 FEET TO A POINT OF CUSP; 8) THENCE, 873.30 FEET ALONG THE ARC OF A 820.00-FOOT NON-TANGENT RADIUS CURVE TO THE RIGHT, CONCAVE TO THE SOUTHWEST, THROUGH A CENTRAL ANGLE OF 61° 01'13" (THE LONG CHORD BEARS SOUTH 30° 48'23" EAST, 832.61 FEET) TO A POINT OF NON-TANGENCY AT THE NORTHEAST CORNER OF THAT TRACT OF LAND CONVEYED TO THE CITY OF TROUTDALE IN DEED FEE NO. 2000-43577, MULTNOMAH COUNTY DEED RECORDS; THENCE, ALONG THE NORTH LINE OF SAID CITY OF TROUTDALE PARCEL, SOUTH 88° 28'25" WEST, 943.46 FEET TO THE NORTHWEST CORNER THEREOF; THENCE, ALONG THE WEST LINE THEREOF, SOUTH 00° 14'57" EAST, 96.07 FEET TO THE NORTHEAST CORNER OF THAT TRACT OF LAND CONVEYED TO THE UNITED STATES OF AMERICA ON JUNE 3, 1949, IN DEED BOOK 1344, PAGE 285, MULTNOMAH COUNTY DEED RECORDS; THENCE, ALONG THE NORTH LINE OF SAID UNITED STATES OF AMERICA PROPERTY AND THE NORTH LINE OF PARCEL 1 DEED BOOK 2358, PAGE 846, MULTNOMAH COUNTY DEED RECORDS, SOUTH 89° 44'17" WEST, 532.48 FEET TO THE NORTHWEST CORNER OF SAID PARCEL 1; THENCE, ALONG THE WEST LINE OF SAID PARCEL 1, SOUTH 00° 14'57" EAST, 401.33 FEET TO THE NORTHERLY RIGHT-OF-WAY LINE OF NW GRAHAM ROAD (30.00 FEET FROM CENTERLINE); THENCE, ALONG SAID NORTHERLY RIGHT-OF-WAY LINE, SOUTH 89° 45'05" WEST, 1234.44 FEET TO THE POINT OF CURVATURE; THENCE, DEPARTING SAID NORTHERLY RIGHT-OF-WAY LINE AND RUNNING ALONG THE NORTHERLY LINE OF THAT TRACT OF LAND CONVEYED TO THE PORT OF PORTLAND ON MARCH 23, 1976, IN DEED BOOK 1094, PAGE 453, MULTNOMAH COUNTY DEED RECORDS, SOUTH 89° 45'15" WEST, 2509.64 FEET TO THE EASTERLY LINE OF THAT TRACT OF LAND CONVEYED TO WILLIAM E. WALSH AND MARGARET M. WALSH, HUSBAND AND WIFE, ON JUNE 8, 1994, IN DOCUMENT 94-89054, MULTNOMAH COUNTY DEED RECORDS; THENCE, ALONG SAID WALSH TRACT, NORTH 00° 16'37" WEST, 185.00 FEET TO THE NORTHEAST CORNER THEREOF; THENCE, ALONG THE NORTH LINE THEREOF, SOUTH 89° 45'15" WEST, 572.88 FEET TO A POINT OF CUSP ON THE EASTERLY RIGHT OF WAY LINE OF NW SUNDIAL ROAD (30.00 FEET FROM CENTERLINE); THENCE, ALONG SAID EASTERLY RIGHT OF WAY LINE 53.89 FEET ALONG THE ARC OF A 830.00-FOOT NON-TANGENT RADIUS CURVE TO THE LEFT, CONCAVE TO THE WEST, THROUGH A CENTRAL ANGLE OF 03° 43'12", (THE LONG CHORD BEARS NORTH 07° 52'26" EAST, 53.88 FEET) TO A POINT OF NON-TANGENCY ON SAID RIGHT OF WAY LINE; THENCE, CONTINUING ALONG SAID EASTERLY RIGHT OF WAY LINE, NORTH 00° 16'42" WEST, 730.68 FEET TO A POINT AT THE INTERSECTION WITH THE EASTERLY RIGHT OF WAY LINE OF SAID NW SUNDIAL ROAD AND THE EASTERLY EXTENSION OF THE NORTHERLY LINE OF THAT TRACT OF LAND CONVEYED TO THE OREGON-WASHINGTON RAILROAD & NAVIGATION COMPANY (O.W.R.R. & N. CO.) RECORDED ON FEBRUARY 16, 1942 IN DEED BOOK 665, PAGE 572, MULTNOMAH COUNTY DEED RECORDS; THENCE SOUTH 89° 44'32" WEST, 50.00 FEET TO THE WESTERLY RIGHT-OF-WAY LINE OF NW SUNDIAL ROAD AND THE NORTHEAST

CORNER OF SAID RAILROAD TRACT; THENCE, ALONG THE NORTHERLY LINE OF SAID RAILROAD TRACT, SOUTH 89° 44'32" WEST, 2285.62 FEET TO A POINT OF CURVATURE; THENCE 316.26 FEET ALONG THE ARC OF A 766.34-FOOT RADIUS CURVE TO THE LEFT, CONCAVE TO THE SOUTH, THROUGH A CENTRAL ANGLE OF 23° 38'43" (THE LONG CHORD BEARS SOUTH 77° 55'11" WEST, 314.02 FEET) TO A POINT OF CUSP ON THE WESTERLY LINE OF THE EAST ONE-HALF OF THE EAST ONE-HALF OF THE CHARLES FEZETT DLC NO. 47; THENCE, ALONG SAID WEST LINE, NORTH 00° 11'29" WEST, 218.52 FEET TO THE NORTHWEST CORNER OF THE EAST ONE-HALF OF THE EAST ONE-HALF OF SAID FEZETT DLC; THENCE, ALONG THE NORTH LINE OF SAID FEZETT DLC, NORTH 89° 53'17" WEST, 1320.38 FEET TO THE POINT OF BEGINNING.

THE BEARINGS IN THIS DESCRIPTION ARE BASED UPON SURVEY NUMBER 60,128 RECORDED AT THE MULTNOMAH COUNTY SURVEYOR'S OFFICE.

EXCEPTING THEREFROM THOSE TRACTS OF LAND CONVEYED TO PACIFIC POWER & LIGHT (PP&L) ON AUGUST 29, 1968 IN DEED BOOK 637, PAGE 1597 AND DEED BOOK 1691, PAGE 1651 ON SEPTEMBER 14, 1983, MULTNOMAH COUNTY DEED RECORDS.

ALSO EXCEPTING THEREFROM THAT TRACT OF LAND CONVEYED TO NORTHWESTERN ELECTRIC COMPANY, RECORDED ON JULY 31, 1946 IN DEED BOOK 1083, PAGE 423, MULTNOMAH COUNTY DEED RECORDS.

ALSO EXCEPTING THEREFROM THAT TRACT OF LAND CONVEYED TO JAMES RIVER II, INC., IN TRACT 559816-052, RECORDED ON MAY 3, 1988 IN DEED BOOK 2100, PAGE 1102, MULTNOMAH COUNTY DEED RECORDS.

CONTAINING 568.7 ACRES, MORE OR LESS.

EXHIBIT B

File 06-096 Reynolds Annexation

Map of Affected Territory

For Council Resolution

12/27/07 11:53:07 AM 276001 1:8000 (1:8000) by: [unreadable]

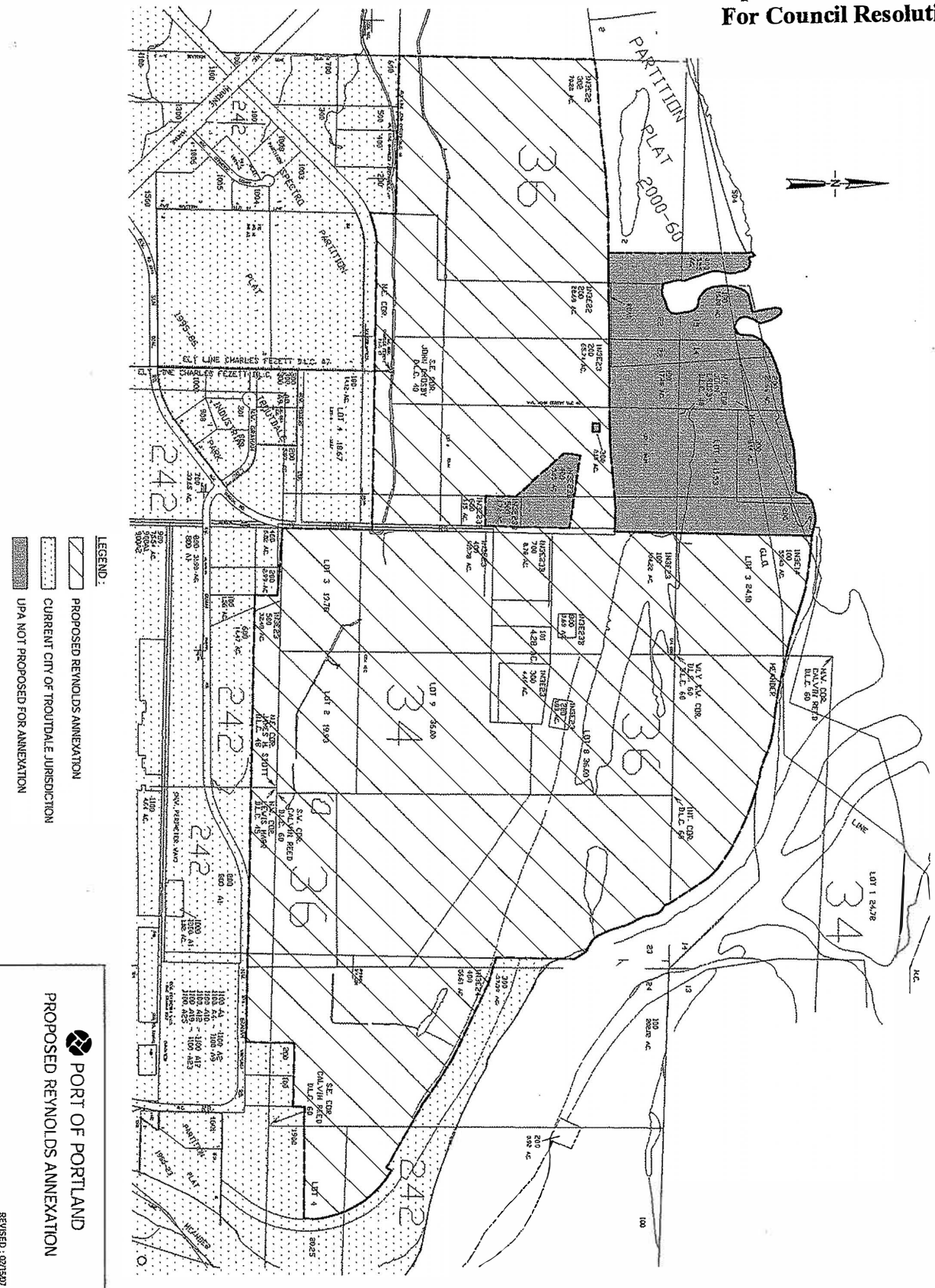
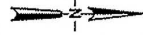

- LEGEND:**
- PROPOSED REYNOLDS ANNEXATION
 - CURRENT CITY OF TROUTDALE JURISDICTION
 - UPA NOT PROPOSED FOR ANNEXATION

PORT OF PORTLAND
PROPOSED REYNOLDS ANNEXATION

REVISED: 02/15/07

The Complete
Annexation File
is located in the
Community
Development
Department

Office of the Secretary of State

BILL BRADBURY
Secretary of State



Archives Division
MARY BETH HERKERT
Director

800 Summer St. NE
Salem, Oregon 97310
(503) 373-0701

Facsimile (503) 373-0953

April 11, 2007

RECEIVED
4/13/07 OS
RECORDER'S OFFICE
CITY OF TROUTDALE

Metro
Linda Martin
600 NE Grand Ave
Portland, Oregon 97232-2736

Dear Ms. Martin:

Please be advised that we have received and filed, as of April 11, 2007, the following records annexing territory to the following:

Ordinance/Resolution Number(s)	Our File Number
1859 (Troutdale)	AN 2007-0188
07-1143 (Metro)	SD 2007-0060

For your records please verify the effective date through the application of ORS 199.519.

Our assigned file number(s) are included in the above information.

Sincerely,

Linda Bjornstad
Official Public Documents

cc: County Clerk(s)
Department of Revenue
ODOT
Population Research Center



CITY OF TROUTDALE

"Gateway to the Columbia River Gorge"

EXECUTIVE DEPARTMENT

Fax: (503) 665-7265

Administration

City Administrator
City Recorder

Human Resources

Community Service

March 5, 2007

Anthony Hair, Customer Service

Waste Management

7227 NE 55th

Portland, OR 97218

Mr. Hair:

The Troutdale City Council, at its February 27, 2007 meeting, adopted Resolution No. 1859 approving annexation of the following property into the City of Troutdale:

County Assessor Tax Map Numbers:

***1N3E14-00100; 1N3E22-00200; 1N3E22-00302; 1N3E23-00100;
1N3E23-00101; 1N3E23-00200; 1N3E23-00300; 1N3E23-00400;
1N3E23-00500; 1N3E23B-00200; 1N3E23B-00600; 1N3E23B-
00700; 1N3E23B-00800; 1N3E24-00400 and includes NW
Sundial Road right-of-way.***

This notification is being sent to you as required by ORS 222.005. Attached you will find a copy of Resolution No. 1859, a legal description and a map of the annexed area.

Please make the necessary changes to your records to reflect this annexation for calculation of your franchise fee payments to the City of Troutdale.

If you have any questions regarding this annexation, please contact Rich Faith, Community Development Director at 503-674-7261.

Sincerely,

A handwritten signature in cursive script that reads "Debbie Stickney".

Debbie Stickney
City Recorder

Visit us on the Web:
www.troutdale.info

Printed on Recycled Paper

104 SE Kibling Avenue • Troutdale, Oregon 97060-2099 • (503) 665-5175

Fax (503) 667-6403 • TDD/TEX Telephone Only (503) 666-7470

SENDER: COMPLETE THIS SECTION

- Complete items 1, 2, and 3. Also complete item 4 if Restricted Delivery is desired.
- Print your name and address on the reverse so that we can return the card to you.
- Attach this card to the back of the mailpiece, or on the front if space permits.

1. Article Addressed to:

**Anthony Hair, Customer Service
Waste Management
7227 NE 55th
Portland, OR 97218**

2. Article Number

(Transfer from sen

7004 0750 0000 5325 5030

COMPLETE THIS SECTION ON DELIVERY

A. Signature

X *[Signature]*

Agent

Addressee

B. Received by (*Printed Name*)

D. Baker

C. Date of Delivery

2/7/07

D. Is delivery address different from item 1?
if YES, enter delivery address below:

Yes

No

3. Service Type

Certified Mail

Express Mail

Registered

Return Receipt for Merchandise

Insured Mail

C.O.D.

4. Restricted Delivery? (*Extra Fee*)

Yes



CITY OF TROUTDALE

"Gateway to the Columbia River Gorge"

EXECUTIVE DEPARTMENT

Fax: (503) 665-7265

Administration

City Administrator
City Recorder

Human Resources

Community Service

March 5, 2007

Dave Yordy

Comcast

9605 SW Nimbus Avenue
Beaverton, OR 97008-7198

Mr. Yordy:

The Troutdale City Council, at its February 27, 2007 meeting, adopted Resolution No. 1859 approving annexation of the following property into the City of Troutdale:

County Assessor Tax Map Numbers:

**1N3E14-00100; 1N3E22-00200; 1N3E22-00302; 1N3E23-00100;
1N3E23-00101; 1N3E23-00200; 1N3E23-00300; 1N3E23-00400;
1N3E23-00500; 1N3E23B-00200; 1N3E23B-00600; 1N3E23B-
00700; 1N3E23B-00800; 1N3E24-00400 and includes NW
Sundial Road right-of-way.**

This notification is being sent to you as required by ORS 222.005. Attached you will find a copy of Resolution No. 1859, a legal description and a map of the annexed area.

Please make the necessary changes to your records to reflect this annexation for calculation of your franchise fee payments to the City of Troutdale.

If you have any questions regarding this annexation, please contact Rich Faith, Community Development Director at 503-674-7261.

Sincerely,

A handwritten signature in cursive script that reads "Debbie Stickney".

Debbie Stickney
City Recorder

Visit us on the Web:
www.troutdale.info

Printed on Recycled Paper

104 SE Kibling Avenue • Troutdale, Oregon 97060-2099 • (503) 665-5175
Fax (503) 667-6403 • TDD/TEX Telephone Only (503) 666-7470

SENDER: COMPLETE THIS SECTION

- Complete items 1, 2, and 3. Also complete item 4 if Restricted Delivery is desired.
- Print your name and address on the reverse so that we can return the card to you.
- Attach this card to the back of the mailpiece, or on the front if space permits.

1. Article Addressed to:

Dave Yordy
Comcast
9605 SW Nimbus Avenue
Beaverton, OR 97008-7198

2. Article Number
(Transfer from sender)

7004 0750 0000 5325 5023

COMPLETE THIS SECTION ON DELIVERY

A. Signature
 Agent
 Addressee
R. Adde

B. Received by (Printed Name)
R. Adde

C. Date of Delivery
3/6/07

D. Is delivery address different from item 1? Yes
if YES, enter delivery address below: No

3. Service Type
 Certified Mail Express Mail
 Registered Return Receipt for Merchandise
 Insured Mail C.O.D.

4. Restricted Delivery? (Extra Fee) Yes



CITY OF TROUTDALE

"Gateway to the Columbia River Gorge"

EXECUTIVE DEPARTMENT

Fax: (503) 665-7265

Administration

City Administrator
City Recorder

Human Resources

Community Service

March 5, 2007

NW Natural

Customer Billing Services

Attention: Annexation Coordinator

220 NW 2nd Avenue

Portland, OR 97209

Franchise Clerk:

The Troutdale City Council, at its February 27, 2007 meeting, adopted Resolution No. 1859 approving annexation of the following property into the City of Troutdale:

County Assessor Tax Map Numbers:

**1N3E14-00100; 1N3E22-00200; 1N3E22-00302; 1N3E23-00100;
1N3E23-00101; 1N3E23-00200; 1N3E23-00300; 1N3E23-00400;
1N3E23-00500; 1N3E23B-00200; 1N3E23B-00600; 1N3E23B-
00700; 1N3E23B-00800; 1N3E24-00400 and includes NW
Sundial Road right-of-way.**

This notification is being sent to you as required by ORS 222.005. Attached you will find a copy of Resolution No. 1859, a legal description and a map of the annexed area.

Please make the necessary changes to your records to reflect this annexation for calculation of your franchise fee payments to the City of Troutdale.

If you have any questions regarding this annexation, please contact Rich Faith, Community Development Director at 503-674-7261.

Sincerely,

Debbie Stickney
City Recorder

SENDER: COMPLETE THIS SECTION

- Complete items 1, 2, and 3. Also complete item 4 if Restricted Delivery is desired.
- Print your name and address on the reverse so that we can return the card to you.
- Attach this card to the back of the mailpiece, or on the front if space permits.

1. Article Addressed to:

NW Natural
Customer Billing Services
Attention: Annexation Coordinator
220 NW 2nd Avenue
Portland, OR 97209

2. Article Number
(Transfer from ser

7004 0750 0000 5325 5047

PS Form 3811, August 2001

COMPLETE THIS SECTION ON DELIVERY

- A. Signature Agent
 Addressee
Greg Batman
- B. Received by (Printed Name) *Greg Batman*
- C. Date of Delivery *3-6-97*
- D. Is delivery address different from item 1? Yes
if YES, enter delivery address below: No

3. Service Type
- Certified Mail Express Mail
 Registered Return Receipt for Merchandise
 Insured Mail C.O.D.

4. Restricted Delivery? (Extra Fee) Yes

Domestic Return Receipt

2ACPR1-03-P-4081



CITY OF TROUTDALE

"Gateway to the Columbia River Gorge"

EXECUTIVE DEPARTMENT

Fax: (503) 665-7265

Administration

City Administrator
City Recorder

Human Resources

Community Service

March 5, 2007

Portland General Electric

City Annexations, Corporate Accounting
121 SW Salmon Street, 1WTC0501
Portland, Oregon 97204

To Whom It May Concern:

The Troutdale City Council, at its February 27, 2007 meeting, adopted Resolution No. 1859 approving annexation of the following property into the City of Troutdale:

County Assessor Tax Map Numbers:

**1N3E14-00100; 1N3E22-00200; 1N3E22-00302; 1N3E23-00100;
1N3E23-00101; 1N3E23-00200; 1N3E23-00300; 1N3E23-00400;
1N3E23-00500; 1N3E23B-00200; 1N3E23B-00600; 1N3E23B-
00700; 1N3E23B-00800; 1N3E24-00400 and includes NW
Sundial Road right-of-way.**

This notification is being sent to you as required by ORS 222.005. Attached you will find a copy of Resolution No. 1859, a legal description and a map of the annexed area.

Please make the necessary changes to your records to reflect this annexation for calculation of your franchise fee payments to the City of Troutdale.

If you have any questions regarding this annexation, please contact Rich Faith, Community Development Director at 503-674-7261.

Sincerely,

Debbie Stickney
City Recorder

Visit us on the Web:
www.troutdale.info

Printed on Recycled Paper

104 SE Kibling Avenue • Troutdale, Oregon 97060-2099 • (503) 665-5175
Fax (503) 667-6403 • TDD/TEX Telephone Only (503) 666-7470

SENDER: COMPLETE THIS SECTION

- Complete items 1, 2, and 3. Also complete item 4 if Restricted Delivery is desired.
- Print your name and address on the reverse so that we can return the card to you.
- Attach this card to the back of the mailpiece, or on the front if space permits.

1. Article Addressed to:

Portland General Electric
City Annexations, Corporate Accounting
121 SW Salmon Street, 1WTC0501
Portland, Oregon 97204

2. Article Number
(Transfer from service)

7004 0750 0000 5325 5061

PS Form 3811, August 2001

Domestic Return Receipt

2ACPRI-03-P-4081

COMPLETE THIS SECTION ON DELIVERY

A. Signature
 Agent
 Addressee

B. Received by (Printed Name) C. Date of Delivery
Isaac Lagrone 7-6

D. Is delivery address different from item 1? Yes
if YES, enter delivery address below: No

3. Service Type
 Certified Mail Express Mail
 Registered Return Receipt for Merchandise
 Insured Mail C.O.D.

4. Restricted Delivery? (Extra Fee) Yes



CITY OF TROUTDALE

"Gateway to the Columbia River Gorge"

EXECUTIVE DEPARTMENT

Fax: (503) 665-7265

Administration

City Administrator
City Recorder

Human Resources

Community Service

March 5, 2007

David Mielke
Verizon
600 Hidden Ridge
MC: HQE01J29
Irving, TX 75038

Mr. Mielke:

The Troutdale City Council, at its February 27, 2007 meeting, adopted Resolution No. 1859 approving annexation of the following property into the City of Troutdale:

County Assessor Tax Map Numbers:

**1N3E14-00100; 1N3E22-00200; 1N3E22-00302; 1N3E23-00100;
1N3E23-00101; 1N3E23-00200; 1N3E23-00300; 1N3E23-00400;
1N3E23-00500; 1N3E23B-00200; 1N3E23B-00600; 1N3E23B-
00700; 1N3E23B-00800; 1N3E24-00400 and includes NW
Sundial Road right-of-way.**

This notification is being sent to you as required by ORS 222.005. Attached you will find a copy of Resolution No. 1859, a legal description and a map of the annexed area.

Please make the necessary changes to your records to reflect this annexation for calculation of your franchise fee payments to the City of Troutdale.

If you have any questions regarding this annexation, please contact Rich Faith, Community Development Director at 503-674-7261.

Sincerely,

A handwritten signature in cursive script that reads "Debbie Stickney".

Debbie Stickney
City Recorder

Visit us on the Web:
www.troutdale.info

 Printed on Recycled Paper

104 SE Kibling Avenue • Troutdale, Oregon 97060-2099 • (503) 665-5175
Fax (503) 667-6403 • TDD/TEX Telephone Only (503) 666-7470

SENDER: COMPLETE THIS SECTION

- Complete items 1, 2, and 3. Also complete item 4 if Restricted Delivery is desired.
- Print your name and address on the reverse so that we can return the card to you.
- Attach this card to the back of the mailpiece, or on the front if space permits.

1. Article Addressed to:

David Mielke
Verizon
600 Hidden Ridge
MC H9E01 J29
Irving, Tx 75038

2. Article Number
(Transfer from service label)

7004 0750 0000 5325 5054

COMPLETE THIS SECTION ON DELIVERY

A. Signature

X

Agent
 Addressee

B. Received by (Printed Name)

Richard Bass

C. Date of Delivery

3-7-07

D. Is delivery address different from item 1? Yes
If YES, enter delivery address below: No

3. Service Type

Certified Mail Express Mail
 Registered Return Receipt for Merchandise
 Insured Mail C.O.D.

4. Restricted Delivery? (Extra Fee)

Yes

ANNEXATION NOTIFICATION INFORMATION – FRANCHISEES

Portland General Electric

City Annexations, Corporate Accounting
121 SW Salmon Street, 1WTC0501
Portland, Oregon 97204

Received letter from PGE Dated
11/23/04 with mailing information

Phone 503-464-8362
Fax: 503-464-2507
Email: city.annexations@pgn.com

Verizon Telephone

David Mielke
Verizon
600 Hidden Ridge
MC: HQEO1J29
Irving, TX 75038

This information provided by Marnie Allen.
I tried contacting David Mielke by phone
and never received calls back. Phone #
for David Mielke is: 972-718-3435

NW Natural

CBS
Attention: Annexation Coordinator
220 NW 2nd Avenue
Portland, OR 97209

Per letter dated 6/27/06 Chg. to Attn:
Annexation Coordinator. (see
scanned copy of letter)

Chuck Muehleck, Customer Billing Manager 503-226-4211 Ext. 5859
Renee Berry, Clerk – 503-226-4211 Ext 5837

Waste Management

Anthony Hair, Customer Service
Waste Management
7227 NE 55th
Portland, OR 97218

Information provided by Chris
Thomas on 1/4/05
503-528-7707

Comcast

Dave Yordy
Comcast
9605 SW Nimbus Avenue
Beaverton, OR 97008-7198

Information from Dave Yordy
on 1/4/05
503-605-6071

Chuck Muehleck
Manager, Customer Billing Services
Telephone: (503)226-4211 ext. 5859
Facsimile: (503)273-4806
Email: cam@nwnatural.com



June 27, 2006

Jodi L. Rogers, Permit Specialist
City of Troutdale
104 SE Kibling Ave
Troutdale OR 97060-2099

TD
Dalene Johnson
ent

RECEIVED
6-29-06 JR
CITY OF TROUTDALE
DEPARTMENT OF COMMUNITY DEVELOPMENT

RE: Notification of Annexations to NW Natural

Dear Ms. Rogers,

NW Natural strives to maintain up to date records of its customers in each municipal jurisdiction. In order to do this, we rely on information regarding annexations provided by your municipality. We use this information to update our billing records, which ultimately determines the amount of city franchise fees we pay to your community. Thus, timely processing of your annexation activity is beneficial to both organizations.

Oregon Revised Statute 222.005 (copy attached) requires that utilities be notified of annexations by certified mail within 10 working days after passage of such annexation. The notification requirement includes 1) legal description of the annexed area, 2) map of the annexed area, 3) each site address within the annexation, and 4) a copy of the resolution or ordinance that approved the annexation.

This letter is to advise you of where to send approved annexation records for utility processing at NW Natural. That address is:

NW Natural
Customer Billing Services
Attn: Annexation Coordinator
220 NW 2nd Ave
Portland OR 97209

Thank you for helping us maintain up to date records so we can provide accurate franchise payments to your community.

Sincerely,

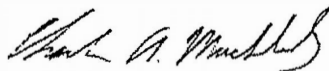

Chuck Muehleck
Manager, Customer Billing Services
NW Natural

Enclosure

The text appearing in this database was produced from material provided by the Legislative Counsel Committee of the Oregon Legislative Assembly. The official record copy is the printed published copy of the Oregon Revised Statutes. The text in the database is not the official text of Oregon law.

Although efforts have been made to match the database text to the official legal text they represent, substantive errors or differences may remain. It is the user's responsibility to verify the legal accuracy of all legal text. The Legislative Counsel Committee claims copyright protection in those parts of Oregon Revised Statutes that are legally subject to copyright protection. The State of Oregon is not liable for any loss or damage resulting from errors introduced into the materials supplied by the Legislative Counsel Committee, by a user or any third party, or resulting from any defect in or misuse of any search software, drivers or other equipment.

Hint: Use your browser's Find feature (usually found in the Edit menu) to get to a section more quickly.

Chapter 222 — City Boundary Changes; Mergers; Consolidations; Withdrawal

2005 EDITION

BOUNDARY CHANGES; MERGERS & CONSOLIDATIONS

CITIES

GENERAL PROVISIONS

- ★ 222.005 Notice to public utilities of annexation; contents of notice; effect
- 222.010 Report of city boundary changes; contents of report; time for filing; exception
- 222.030 Assessor to furnish statement of assessed valuation of territory to be annexed
- 222.040 Delay of effective date of actions under this chapter because of election; effective date of certain annexations and transfers of territory
- 222.045 Effect of split, consolidation or merger of two or more cities on unfunded PERS liability or surplus
- 222.050 Certain consolidations and mergers; additional question concerning taxes authorized; requirements for approval

ANNEXATION OF CONTIGUOUS TERRITORY

(Temporary provisions relating to annexation are compiled as notes preceding ORS 222.111)

- 222.111 Authority and procedure for annexation
- 222.115 Annexation contracts; recording; effect
- 222.120 Procedure without election by city electors; hearing; ordinance subject to referendum
- 222.125 Annexation by consent of all owners of land and majority of electors; proclamation of annexation

Elizabeth McCallum [emccallum@ci.troutdale.or.us]

Thursday, June 29, 2006 1:08 PM

cam@nwnatural.com

'Debbie Stickney, Troutdale City Recorder'; 'Jodi Rogers, Troutdale Permit Specialist'; 'Rita Correy, Planning Technician'

City of Troutdale, Oregon Annexations

June 29, 2006

Mr. Chuck Muehl eck, Manager, Customer Billing Services, NWNatural,

Your letter of June 27, 2006 re notification of annexations to NWNatural was received by the City of Troutdale on June 29, 2006. The City Recorder, Debbie Stickney, has notified N Natural of all annexations pursuant ORS 222.005. The most recent notification was for Annexation 1778, dated October 3, 2005. The letter went to CBS Attention Franchise Clerk.

Your letter will be given to the City Recorder for the City's records and action.

Elizabeth A. McCallu
Senior Planner
City of Troutdale
104 SE Kibling Ave
Troutdale, OR 97060
(503) 674-7228
FA (503) 667-0524