

RESOLUTION NO. 1733

A RESOLUTION RECOGNIZING THE COMPLETION OF THE PUBLIC IMPROVEMENTS ASSOCIATED WITH THE MORGAN MEADOWS PHASE II PLANNED DEVELOPMENT AND ACCEPTING THESE IMPROVEMENTS INTO THE CITY'S FIXED ASSET SYSTEM.

THE TROUTDALE CITY COUNCIL FINDS AS FOLLOWS:

1. The construction of the public improvements associated with the Morgan Meadows Phase II planned development was necessary to meet the demands of public health, safety and welfare.
2. The construction of these public improvements has now been completed.
3. The public improvements have been inspected and found to be in compliance with the City of Troutdale *Construction Standards for Public Works Facilities* and the construction plans and specifications.

NOW, THEREFORE, BE IT RESOLVED BY THE COUNCIL OF THE CITY OF TROUTDALE

Section 1. The following public improvements associated with the Morgan Meadows Phase II planned development are accepted into the City's fixed asset system, valued as follows:

Improvement	Estimated Value
Sanitary Sewer System, consisting of approximately 1,853 linear feet of 8" PVC sewer main (Sanitary Lines D, E, F, G and H) and 11 manholes, as shown on sheets 16 and 18-20 of the project as-builts.	\$69,840
On-Site stormwater collection system for the subdivision, consisting of 1,934 linear feet of 12" ADS-N12 storm main (Storm Lines 9-12), 286 linear feet of 18" ADS-N12 storm main (Storm Line 9), 545 linear feet of 24" ADS-N12 storm main (Storm Line 9), 16 manholes and 19 catch basins as shown on sheets 7-12 of the project as-builts.	\$129,527

Off-Site stormwater collection components serving SW Hensley Road, consisting of 32 linear feet of 12" ADS-N12 storm main (catch basin leads) and 4 catch basins as shown on sheets 13-14 of the project as-built. \$6,612

Water System, consisting of 2,851 linear feet of 8" ductile iron water main, 14 gate valves, 2 blow off assemblies, 1 vaulted pressure-reducing/pressure-sustaining assembly and 6 fire hydrant assemblies as shown on sheets 16-20 of the project as-built. \$127,811

On-site 32' wide paved streets, consisting of base rock and asphalt-concrete surfacing as follows:

SW Wright Place – 541 linear feet (sheet 9)
SW Hewitt Avenue – 573 linear feet (sheet 10)
SW 17th Way – 1,135 linear feet (sheets 7 & 8) \$157,700
SW Fox Avenue – 66 linear feet (sheet 11)

and a combination of half-street and full-street improvements to SW 16th Way, encompassing 304 linear feet (sheet 11) as shown on the indicated sheets of the project as-built.

Half-street improvements to the west side of the north-south leg of SW Hensley Road, consisting of 1,366 linear feet of base rock and asphalt-concrete surfacing as shown on sheets 13-14 of the project as-built \$49,571

On-site pedestrian accessibility facilities consisting of 11 ADA ramps as shown on sheets 7-11 of the project as-built. \$11,455

Off-site pedestrian facilities consisting of 1900 linear feet of 5' wide sidewalk and 5 ADA ramps as shown on sheets 13-15 of the project as-built. \$35,812

On-site curb and gutter consisting of 5,047 linear feet of curb and gutter as shown on sheets 7-11 of the project as-built. \$30,989

Off-site curb and gutter consisting of 1,336 linear feet of curb and gutter as shown on sheets 13-14 of the project as-built. \$8,697

TOTAL ESTIMATED VALUE \$628,014

Section 2. This resolution is effective upon adoption.

YEAS: 7
NAYS: 0
ABSTAINED: 0



Paul Thalhofer, Mayor
February 24, 2005

Date



Sarah Greif, Office Support Specialist

Adopted: February 22, 2005

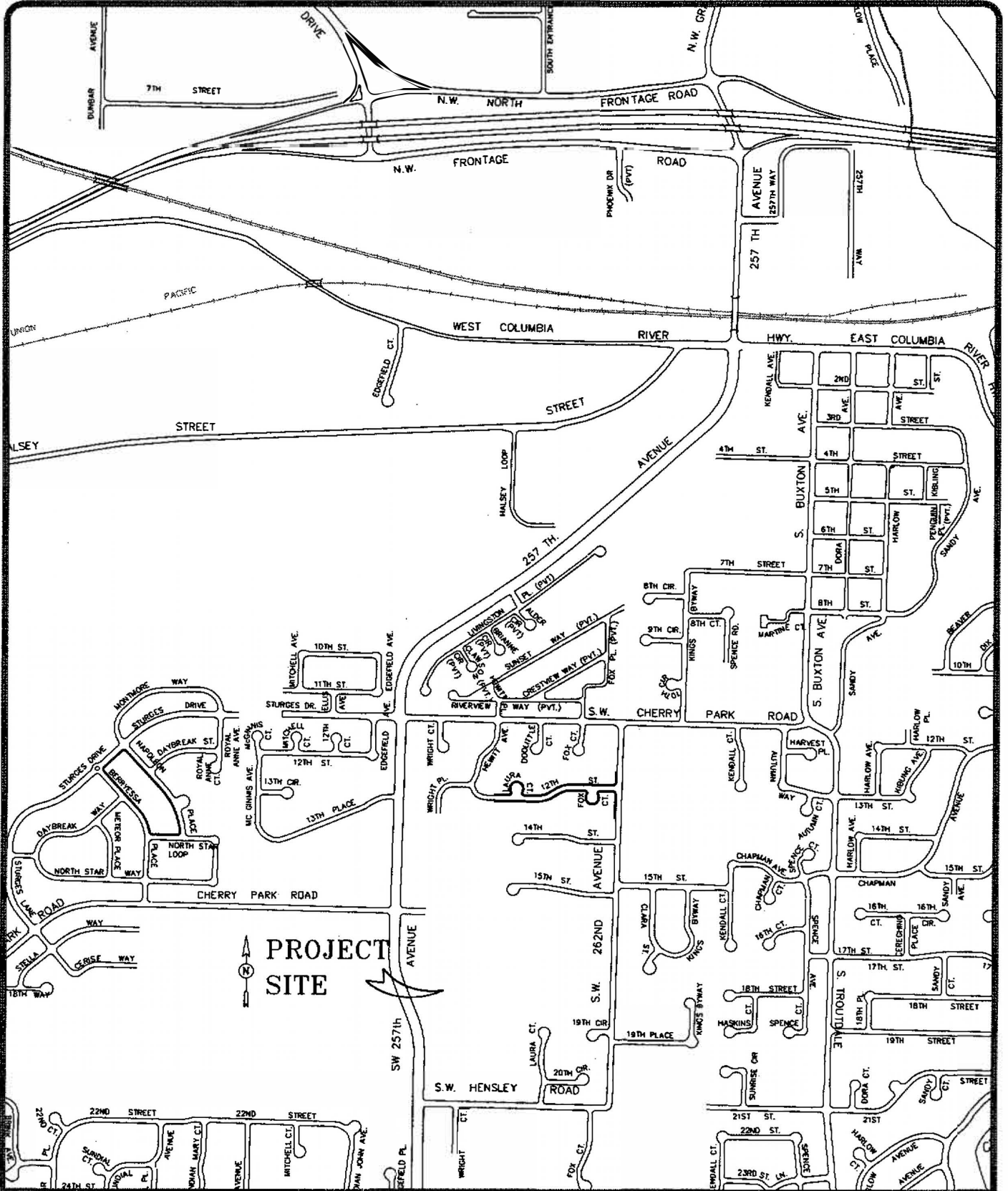

EXHIBIT A

FILE NAME: VICINITY MAP
 TITLE BLOCK: TB8X11
 EXTERNAL REFERENCES: NONE
 PLOT DATE: 7/20/04
 BY: TH
 PREVIOUS REVISION DATE: NONE



DEPARTMENT OF PUBLIC WORKS
 CITY OF TROUTDALE
Morgan Meadows

MULTNOMAH COUNTY, OREGON
 7/04