

RESOLUTION NO. 1729

A RESOLUTION ACCEPTING 165 LINEAL FEET OF STORM SEWER ASSOCIATED WITH THE ROGERS CONSTRUCTION PROJECT INTO THE CITY'S FIXED ASSET SYSTEM.

THE TROUTDALE CITY COUNCIL FINDS AS FOLLOWS:

1. There exists 165 lineal feet of storm sewer associated with the Rogers Construction project that were overlooked in the original acceptance resolution and have not yet been accepted into the City's fixed asset system.
2. It was found that the construction of the public facilities in the aforesaid subdivision was necessary to meet the demands of public health, safety, and welfare.
3. The construction of these public facilities was completed and inspected by City staff.
4. These public facilities were found to be in accordance with the Troutdale City standards and the plans and specifications.

NOW, THEREFORE, BE IT RESOLVED BY THE COUNCIL OF THE CITY OF TROUTDALE

Section 1. The City accepts 165 lineal feet of 12" ADS N-12 storm sewer pipe valued at \$4,125 associated with the Rogers Construction project into the City's fixed asset system.

Section 2. This resolution is effective upon adoption.

YEAS: 5
NAYS: 0
ABSTAINED: 0

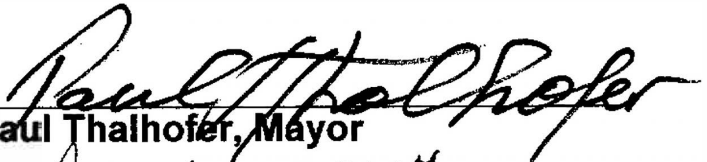
Paul Thalhofer, Mayor
December 15, 2004
Date

Sarah Greif, Office Support Specialist

Adopted: December 14, 2004

RESOLUTION NO. 1278

A RESOLUTION RECOGNIZING THE COMPLETION OF THE PUBLIC IMPROVEMENTS FOR ROGER'S CONSTRUCTION AND ACCEPTING THEM INTO THE CITY'S FIXED ASSET SYSTEM.

WHEREAS, it was found that the construction of the public facilities in the aforesaid subdivision was necessary to meet the demands of public health, safety and welfare; and

WHEREAS, the construction of these public facilities have been completed and inspected by City staff; and

WHEREAS, these public facilities were all found in accordance with the Troutdale City standards and the plans and specifications.

NOW THEREFORE BE IT RESOLVED BY THE COUNCIL OF THE CITY OF TROUTDALE

That the following public works facilities are accepted into the City's fixed asset system:

STREETS:

1450 L.F. of 32-foot wide street valued at	=	\$188,500
1475 L.F. of 5-foot concrete sidewalk and wheelchair ramps valued at	=	16,225
2950 L.F. of concrete curb and gutter valued at	=	<u>20,650</u>
Street Total	=	225,375

STORM SEWER COLLECTION SYSTEM:

608 L.F. of 12" AD N-12 pipe valued at	=	15,200
3 each storm sewer manholes valued at	=	5,400
5 each catch basins	=	<u>3,500</u>
Storm Sewer Total	=	24,100

WATER DISTRIBUTION SYSTEM:

1475 L.F. of 12" ductile iron pipe valued at	=	47,200
3 each fire hydrants valued at	=	4,500
1 L.S. Miscellaneous Fittings valued at	=	<u>5,200</u>
Water System Total	=	56,900

SANITARY SEWER COLLECTION SYSTEM:

750 L.F. of 8" PVC valued at = 22,500
2 each sanitary sewer manhole valued at = 3,600

Sanitary Sewer Total = 26,100

Grand Total = \$332,475

YEAS: 7
NAYS: 0
ABSTAINED: 0



Paul Thalhofer, Mayor

Dated: 9-13-96

George Martinez, City Recorder

Adopted: 9-10-96

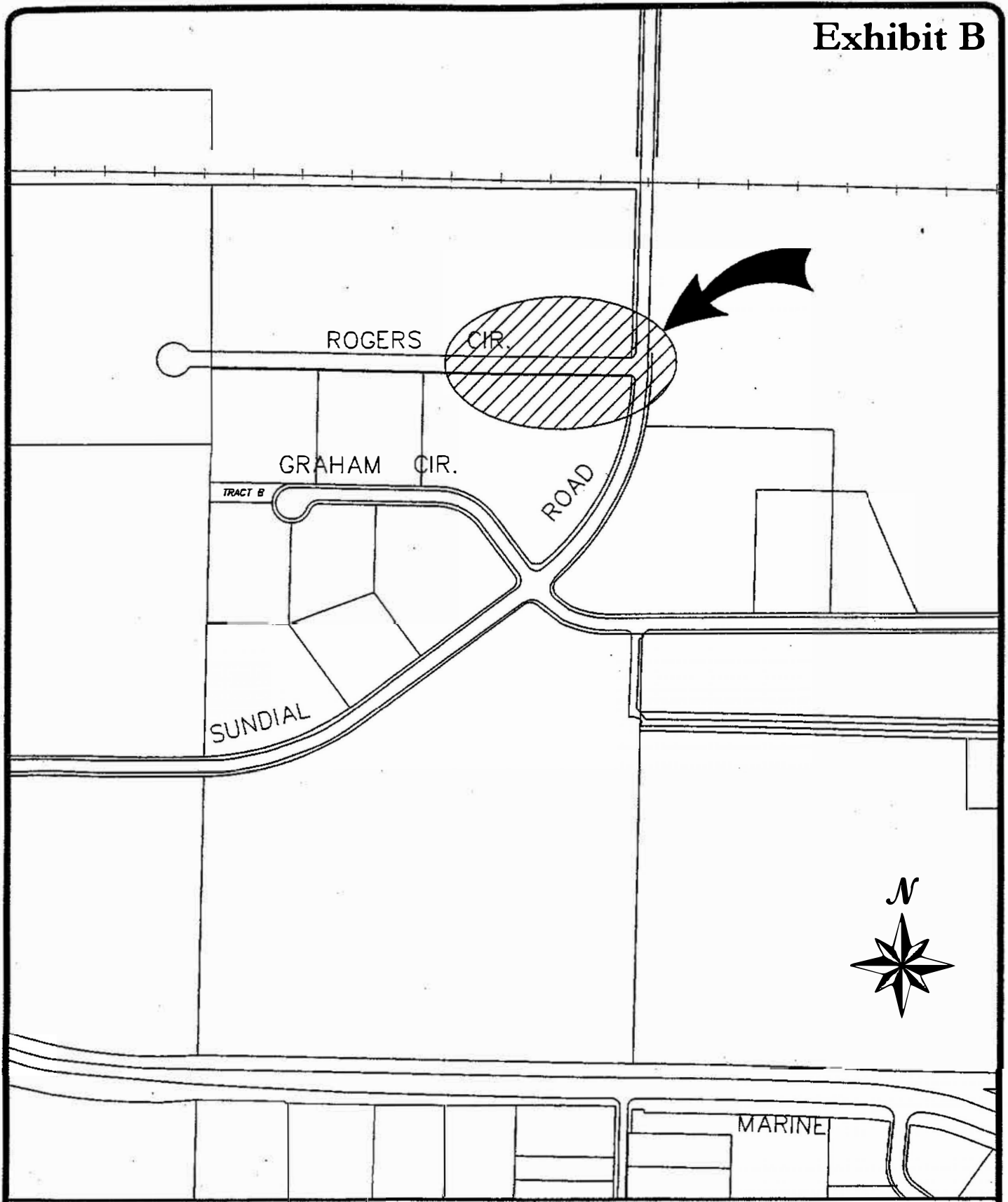
Exhibit B



FILE NAME: *Rogers Map*
TITLE BLOCK: *TBBX11*
EXTERNAL REFERENCES: *NONE*
PLOT DATE: *11-08-2004*
BY: *O.S.*
PREVIOUS REVISION DATE: *NONE*



DEPARTMENT OF PUBLIC WORKS
CITY OF TROUTDALE
Rogers Circle
MULTNOMAH COUNTY, OREGON
November 2004