

RESOLUTION NO. 1531

A RESOLUTION RECOGNIZING THE COMPLETION OF THE CAPITAL IMPROVEMENTS ASSOCIATED WITH THE NORTH EVANS OUTFALL PROJECT AND ACCEPTING THEM INTO THE CITY'S FIXED ASSET SYSTEM

THE TROUTDALE CITY COUNCIL FINDS AS FOLLOWS:

1. The construction of the public works facilities associated with the North Evans Outfall project was necessary to meet the demands of public health, safety, and welfare; and
2. The construction of these improvements has been completed and inspected by City staff; and
3. These public facilities were found to be in accordance with the plans and specifications.

NOW THEREFORE BE IT RESOLVED BY THE COUNCIL OF THE CITY OF TROUTDALE

That the capital improvements associated with the North Evans Outfall project, consisting of the following facilities, are accepted into the City's fixed asset system:

260 LF of 30" diameter HDPE fused pipe w/ anchors valued at	\$38,307.60
34 LF of 36" diameter HDPE fused pipe valued at	\$2,040.00
4 54" diameter manholes valued at	\$14,000.00
1 72" diameter energy dissipating "bubbler" outfall structure valued at	\$9,000.00
GRAND TOTAL	\$63,347.60

YEAS: 5

NAYS: 0

ABSTAINED: 0

Paul Thalhoffer, Mayor

Dated: 11-15-00

Debbie Stickney, City Recorder

Adopted: 11-14-00

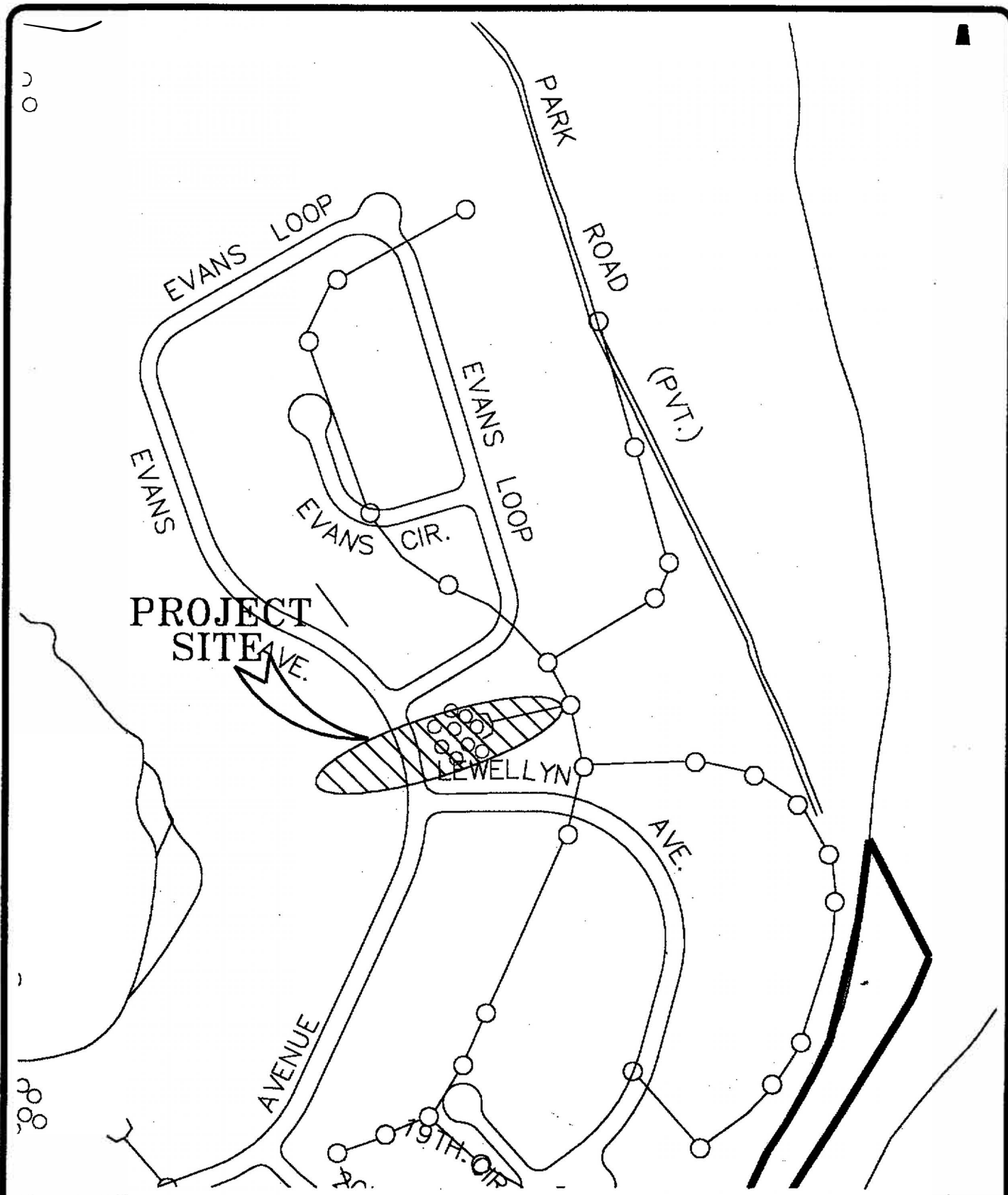

EXHIBIT 1

FILE NAME:
 TITLE BLOCK: TBBX11
 EXTERNAL REFERENCES: troutbas
 PLOT DATE: 10-28-98
 BY: TH
 PREVIOUS REVISION DATE: NONE



CITY OF TROUTDALE
 North Evans Outfall
 Vicinity Map