

**RESOLUTION NO. 1413**

**A RESOLUTION RECOGNIZING THE COMPLETION OF THE 12-INCH WATER MAIN RELOCATION, ASSOCIATED WITH THE I-84 RAILROAD BRIDGE AND HIGHWAY WIDENING, AND ACCEPTING THIS WATER MAIN INTO THE CITY'S FIXED ASSET SYSTEM.**

**WHEREAS**, this 12-inch ductile iron water main replacement and relocation was triggered by the improvements proposed by the Oregon Department of Transportation (ODOT) as part of the I-84 Highway Widening; and

**WHEREAS**, replacing and relocating this 12-inch ductile iron water main was done for the best interest, benefit and welfare of the citizens of the City of Troutdale; and

**WHEREAS**, this 12-inch water main exists inside the Union Pacific Railroad's (UPRR) right-of-way; and

**WHEREAS**, by way of a written agreement previously entered into by the City and the UPRR, the UPRR has granted the City of Troutdale permission to be inside its right-of-way with this water main indefinitely; and

**WHEREAS**, this water main is also found inside the property of Joanne Maurine Connell, located at 2077 Historic West Columbia River Highway in Troutdale, Oregon, County of Multnomah; and

**WHEREAS**, the portion of the water main existing inside Mrs. Connell's property is within a public access and water utility easement (PUE) dedicated to the City of Troutdale by said property owner; and

**WHEREAS**, such PUE gives the maintenance crews of the City of Troutdale the legal and permanent right to ingress/egress these premises to maintain, own and operate this water main; and

**WHEREAS**, during installation, this 12-inch water main was inspected by qualified personnel from the ODOT and the City of Troutdale and was found to be installed in accordance to the applicable standards set forth by the American Water Works Association, the Oregon State Health Department, the City of Troutdale Standards and the construction plans and specifications.

**NOW THEREFORE BE IT RESOLVED BY THE COUNCIL OF THE CITY OF TROUTDALE**

That this 12-inch water main shown on the attached Exhibit Map be accepted into the City's fixed asset system. This water system is valued as follows:

553 L.F. of 12-inch DI Water Main at : \$ 47,000.00

YEAS: 6  
NAYS: 0  
ABSTAINED: 0

  
Paul Thalhofer, Mayor

Dated: 10-16-98

  
George Martinez, City Recorder

Adopted: 10-13-98

CARESOL98

EXISTING WATER MAIN  
ON NW DUNBAR AVE.

WATER MAIN IN ITS  
NEW ALIGNMENT

I-84 ROW

TOE OF BANK

TOP OF BANK

"KRR" LINE

"KRR225" LINE

AC  
DRIVE

LAWRENCE STEEL INC.  
2077 WEST COLUMBIA RIVER HWY  
TROUTDALE, OR 97060

COLUMBIA RIVER HWY TO TROUTDALE



FILE NAME: Troutbas  
TITLE BLOCK: T88X11  
EXTERNAL REFERENCES: NONE  
PLOT DATE: 10-06-98  
BY: W.H.  
PREVIOUS REVISION DATE: NONE



DEPARTMENT OF PUBLIC WORKS  
CITY OF TROUTDALE  
I-84 Railroad Bridge Water main  
Relocation/Exhibit Map  
MULTNOMAH COUNTY, OREGON  
OCTOBER 1998

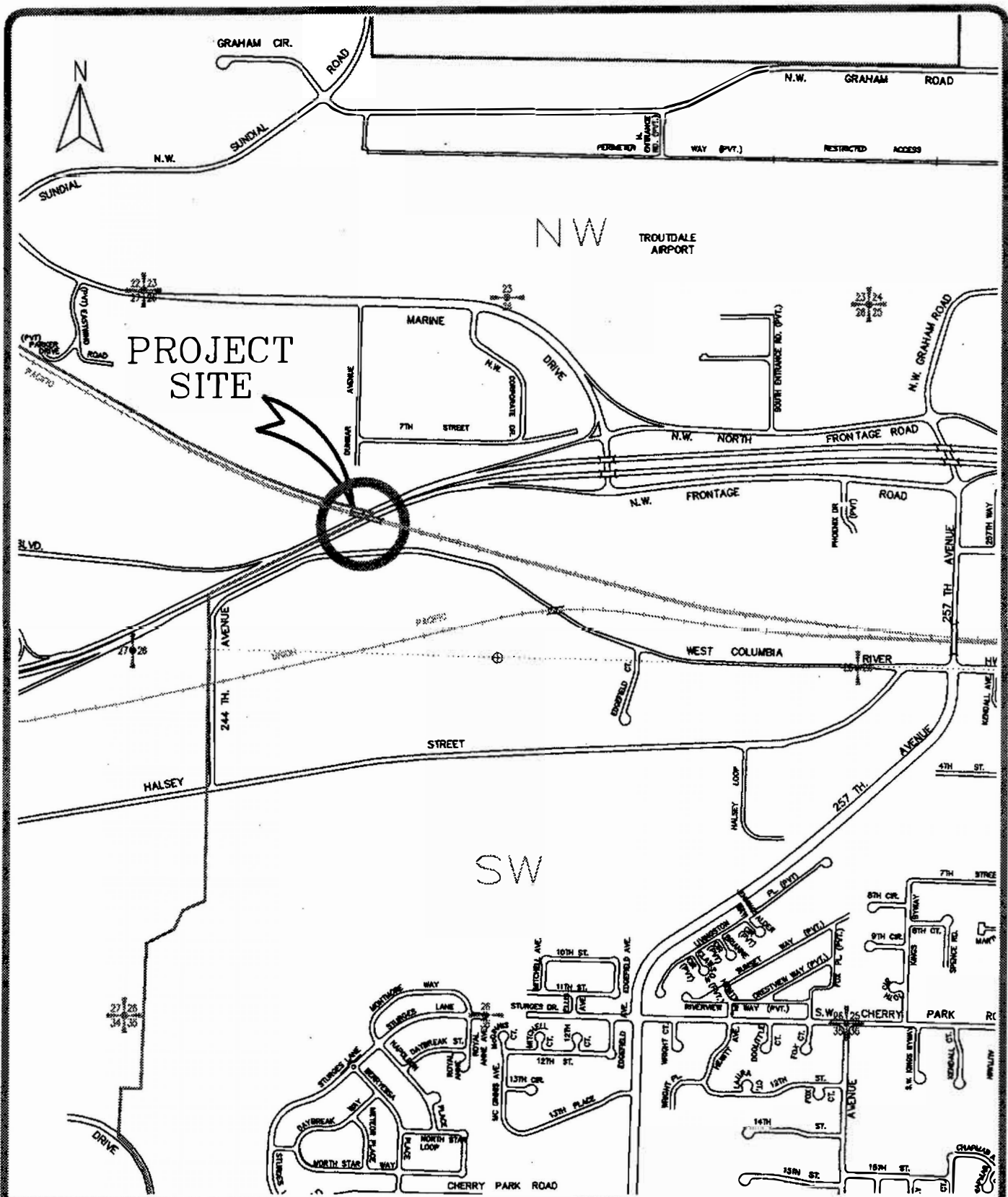

FILE NAME: TROUTBAS  
 TITLE BLOCK: TBBX11  
 EXTERNAL REFERENCES: NONE  
 PLOT DATE: 10-06-98  
 BY: W.H.  
 PREVIOUS REVISION DATE:



DEPARTMENT OF PUBLIC WORKS  
**CITY OF TROUTDALE**  
*12-inch D.I. Water Main*  
*Vicinity Map*  
 MULTNOMAH COUNTY, OREGON  
 OCTOBER 1998