

RESOLUTION NO. 1355

A RESOLUTION RECOGNIZING THE COMPLETION OF THE ENTRANCE ROAD TO COLUMBIA PARK, ACCEPTING IT INTO THE CITY'S FIXED ASSET SYSTEM AND RESCINDING RESOLUTION NO. 1347.

WHEREAS, it was found that the construction of the Columbia Park access road (SW Imagination Way) was necessary to meet the demands of public health, safety, and welfare; and

WHEREAS, the construction of this improvement has been completed and inspected by City staff; and

WHEREAS, this public facility was found to be in accordance with the Troutdale City standards and the plans and specifications, and

WHEREAS, this entrance road was accepted by the City Council by Resolution No. 1347 on October 14, 1997, naming the street "SW Latourell Place", and

WHEREAS, the City Council now desires to rename the entrance road

NOW THEREFORE BE IT RESOLVED BY THE COUNCIL OF THE CITY OF TROUTDALE

Section 1. Resolution No. 1347 is rescinded.

Section 2. The Columbia Park access road (SW Imagination Way), consisting of the following facilities, is accepted into the City's fixed asset system:

845 LF of 24 ft. wide street valued at	\$35,200.00
Grand Total	\$34,200.00

YEAS:	<u>5</u>
NAYS:	<u>0</u>
ABSTAINED:	<u>0</u>

Paul Thalhofer, Mayor
Dated: 12-3-97

George Martinez, City Recorder

Adopted: 11-25-97

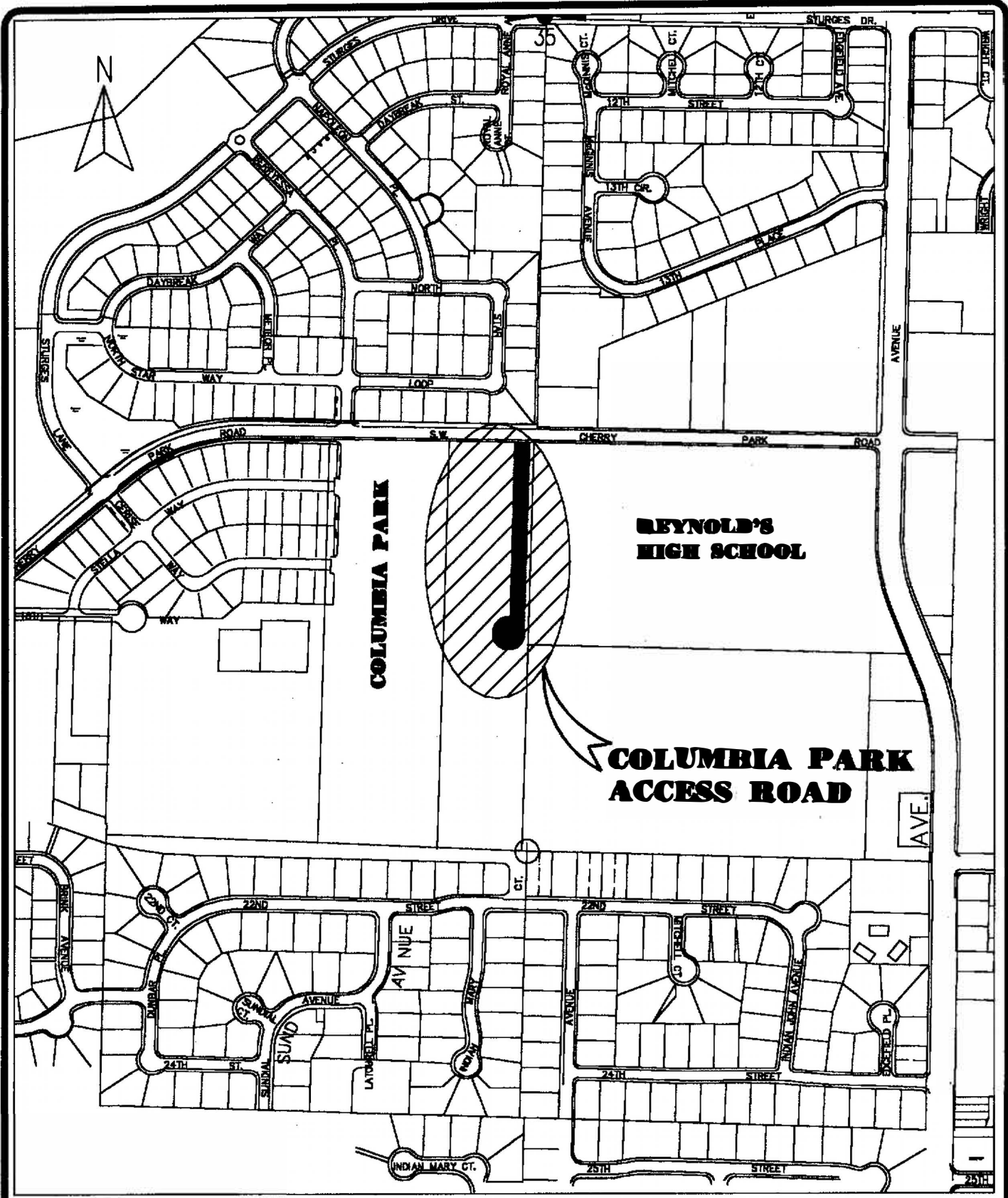

EXHIBIT I

FILE NAME: TROUTBAS
 TITLE BLOCK: TB&X11
 EXTERNAL REFERENCES: NONE
 PLOT DATE: 10-29-97
 BY: W.H.
 PREVIOUS REVISION DATE: NONE



DEPARTMENT OF PUBLIC WORKS
**COLUMBIA PARK ACCESS
 ROAD IMPROVEMENTS**
VICINITY MAP

MULTNOMAH COUNTY, OREGON
 OCTOBER 1997