

RESOLUTION NO. 1350

A RESOLUTION GRANTING AN ACCESS AND WATER UTILITY EASEMENT TO VIKING PROPERTIES, DEVELOPER OF THE HAMPTON HEIGHTS APARTMENTS, THROUGH THE HELEN ALTHAUS PARK GROUNDS, LOT 3500, IN THE SW ¼ OF SECTION 25, RANGE 3 EAST, TOWNSHIP 1 NORTH, WILLAMETTE MERIDIAN.

WHEREAS, the granting of this easement was necessary to provide the Hampton Heights Apartments (previously known as the Cedar Hills Apartments) with water services; and

WHEREAS, the water main would cross the Helen Althaus Park grounds property; and

WHEREAS, the alignment where this privately owned water main is placed does not prevent, hinder or otherwise negatively impact City property.

NOW THEREFORE BE IT RESOLVED BY THE COUNCIL OF THE CITY OF TROUTDALE

That an access and water utility easement as described in the attached legal description and shown on the attached drawing, which are made a part hereof, is granted to Viking Properties, the developer of Hampton Heights Apartments

YEAS: 5
NAYS: 0
ABSTAINED: 0

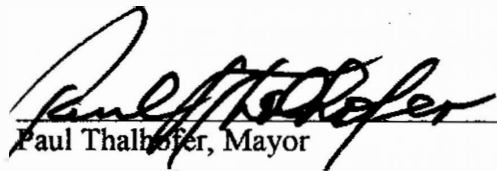
Paul Thalhofer, Mayor

Dated: 12-3-97

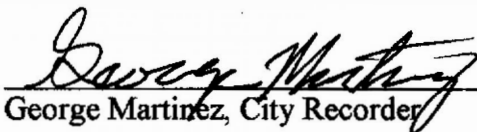
George Martinez, City Recorder

Adopted: 11-25-97

Recorded in the County of Multnomah, Oregon
C. Swick, Deputy Clerk

 45.00

98000770 08:48am 01/05/98

C:\RESOL97

003 40024139 04 03
E79 4 5.00 20.00 0.00 20.00

Ret:

4

Hampton Heights Apartments

Water Easement

October, 1997

A 15 foot wide water line easement centered on the following described line:

Beginning at a point that is North $00^{\circ}13'53''$ East 30.71 feet from the southeast corner of that tract of land Deeded to Justin Barton and Edward N. Hall by Deed recorded in the Multnomah County Deed Records, Deed No. 96107730 on July 17, 1996, said point being on the east line of said tract; thence running South $89^{\circ}46'07''$ East 23.51 feet; thence South $72^{\circ}43'01''$ East 26.04 feet; thence North $61^{\circ}16'45''$ East 31.24 feet; thence North $86^{\circ}55'08''$ East 9.23 feet to a point on the right-of-way of 7th Street

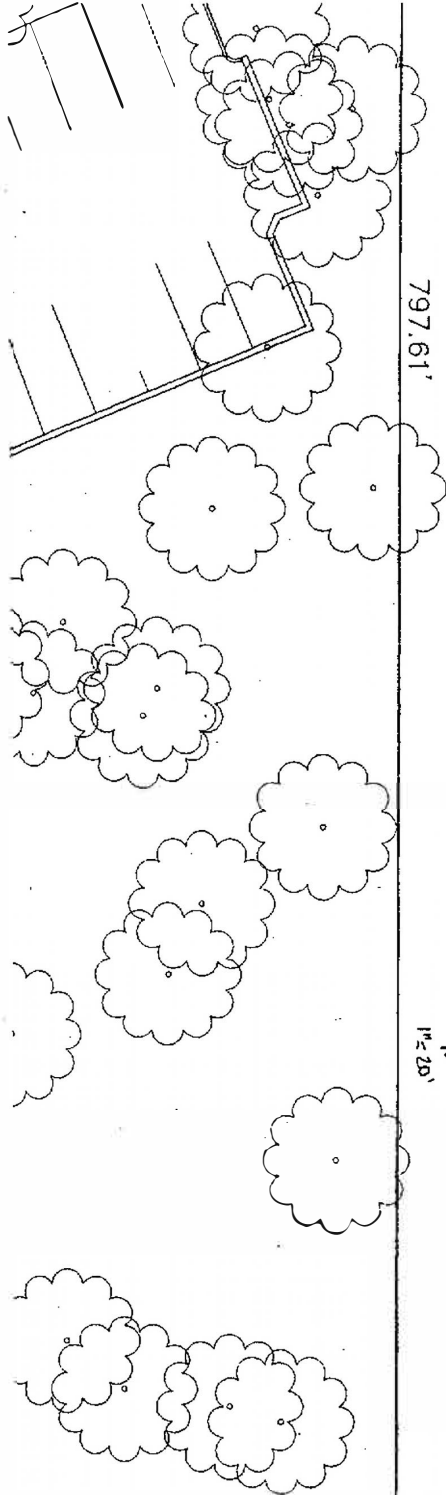

CITY PARK

15' WATER MAIN EASEMENT

S89°46'07"E
23.51'

S72°43'01"E
26.04'

N61°16'45"E
31.24'

N00°13'53"E
30.71'

N86°55'08"E
9.23'

E 380.55, 99N

7th St.

END OF PAINT

END OF PAINT

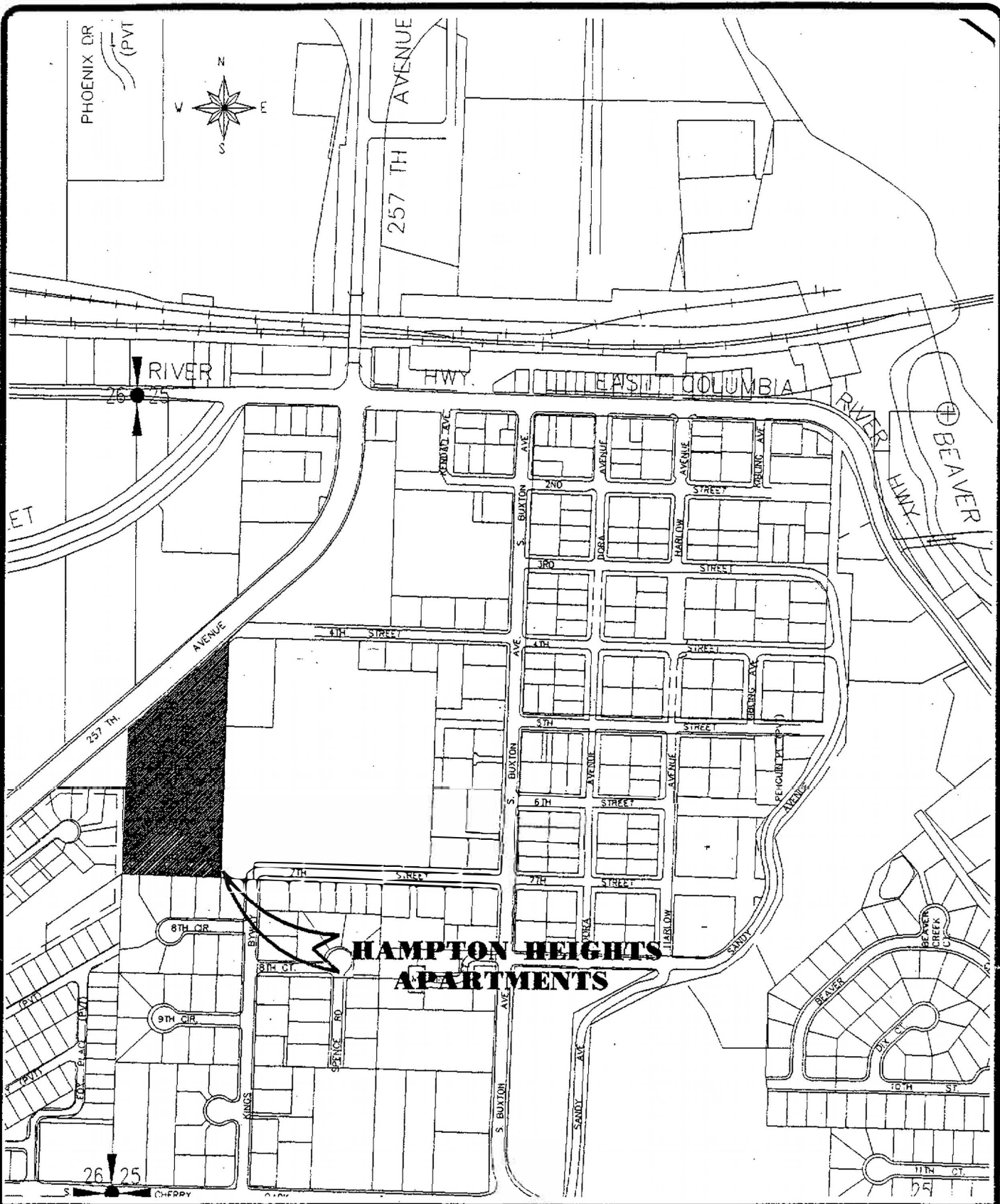

NOTE:

FILE NAME: *TROUTBAS*
 TITLE BLOCK: *1B8X11*
 EXTERNAL REFERENCES: *NONE*
 PLOT DATE: *11-10-97*
 BY: *W.H.*
 PREVIOUS REVISION DATE: *01-16-97*



DEPARTMENT OF PUBLIC WORKS
 CITY OF TROUTDALE
HAMPTON HEIGHTS APARTMENTS
VICINITY MAP
 MULTNOMAH COUNTY, OREGON
 NOVEMBER 1997