

RESOLUTION NO. 1264

A RESOLUTION RECOGNIZING THE COMPLETION OF THE PUBLIC IMPROVEMENTS IN THE CHERRY RIDGE SUBDIVISION CONSTRUCTION PHASE V (PLAT PHASE III), AND THE OFF-SITE WATER DISTRIBUTION SYSTEM, AND ACCEPTING THEM INTO THE CITY'S FIXED ASSET SYSTEM.

WHEREAS, it was found that the construction of the public facilities in the Cherry Ridge Phase V subdivision was necessary to meet the demands of public health, safety and welfare; and,

WHEREAS, at the request of Multnomah County, for ease in identifying the plat of this fifth construction phase, Construction Phase V became Phase III on the County - recorded plat; and,

WHEREAS, the construction of these public facilities within the boundaries of this subdivision Phase V have been completed, along with the necessary off-site water distribution system improvements (a 12-inch ductile iron water main) extending from the most northeastern corner of this subdivision to the most southeastern corner of Cherry Ridge residential Phase IV; and,

WHEREAS, this new 12-inch, off-site water main was necessary to eliminate future conflicts with structures built on these lots; and,

WHEREAS, this new 12-inch water main replaces a previous water main located further to the west; and,

WHEREAS, the previous 12-inch water main has now been properly abandoned and is no longer in service; and,

WHEREAS, City staff have inspected this subdivision and the new 12-inch, off-site water distribution system and found all public facilities to be in compliance with the Troutdale City Standards, construction plans and specifications.

NOW THEREFORE BE IT RESOLVED BY THE COUNCIL OF THE CITY OF TROUTDALE

That the following public works facilities in the Cherry Ridge Phase V subdivision, and the off-site 12-inch water main, are accepted into the City's fixed asset system:

STREETS	
811 L.F. of 40' wide street valued at	\$118,797.96
1943 L.F. of 32' wide street valued at	\$136,010.00
5432 L.F. of Concrete curb and gutter valued at	\$32,863.60
630 L. F. of 5' wide sidewalks and wheelchair ramps valued at	\$11,043.90
Streets Total	\$298,715.46

<u>STORM SEWER SYSTEM</u>	
160 L.F. of 30" ADS N-12 Sewer Pipe valued at	\$7,680.00
960 L.F. of 18" ADS N-12 Sewer Pipe valued at	\$29,476.00
1902 L.F. of 12" ADS N-12 Sewer Pipe valued at	\$45,099.24
276 L.F. of 8" ADS N-12 Sewer Pipe valued at .	\$4,140.00
367 L.F. of 6" ADS N-12 Sewer Pipe valued at	\$5,251.00
20 L.F. of 4" ADS N-12 Sewer Pipe valued at	\$400.00
16 48" Diameter Manholes valued at	\$22,120.00
19 Catch Basins valued at	\$21,337.00
Miscellaneous Pipe Fittings, Cleanouts, etc., valued at	\$3,330.02
Storm Sewer System Total	\$138,833.26
<u>SANITARY SEWER SYSTEM</u>	
1990 L.F. of 8" Sanitary Sewer Main valued at	\$57,048.28
1421 L.F. of 4" Sanitary Sewer Main valued at	\$33,546.34
12 48" Diameter Manholes valued at	\$20,892.00
Miscellaneous Pipe Fittings, Cleanouts, etc., valued at	\$4,247.80
Sanitary Sewer System Total	\$115,734.42
<u>WATER DISTRIBUTION SYSTEM (Includes 12-inch off-site water main)</u>	
1565 L.F. of 12" DIP valued at	\$39,125.00
2542 L.F. of 8" DIP valued at	\$62,279.00
130 L.F. of 4" DIP valued at	\$2,665.00
4 Fire Hydrants valued at	\$4,872.00
2000 lbs Cast Iron Fittings valued at	\$4,860.00
38 1" double water services valued at	\$14,022.00
14 3/4" single water services valued at	\$4,508.00
Miscellaneous Connections, Testing, Values, etc. valued at	\$6,414.00
Water Distribution Total	\$138,745.00
GRAND TOTAL	\$692,028.14

YEAS: 1
NAYS: 0
ABSTAINED: 0

Paul Thalhofer, Mayor
Dated: 7-29-96

George Martinez, City Recorder

Adopted: July 23, 1996

C:\WORD\RESOL96

EXHIBIT B

EDGEFIELD C

244 TH.

STREET

HALSEY



**NEW 12-INCH
WATER MAIN**

EXISTING 12-INCH
WATER MAIN

EXISTING 12-INCH
WATER MAIN

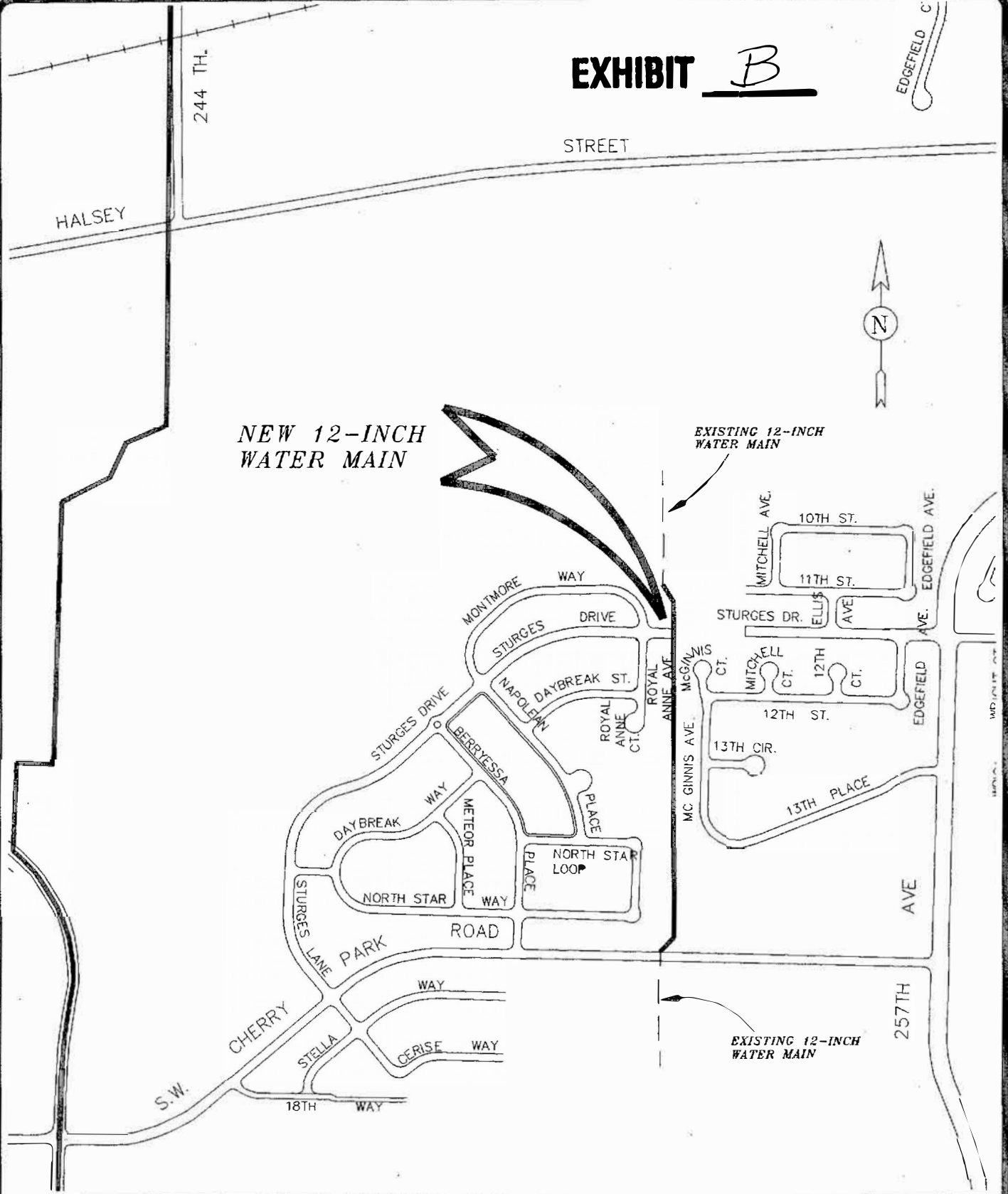

FILE NAME: *CHRY_WTR*
TITLE BLOCK: *T08X11*
EXTERNAL REFERENCES: *NONE*
PLOT DATE: *07-16-96*
BY: *J.M.*
PREVIOUS REVISION DATE: *NONE*



DEPARTMENT OF PUBLIC WORKS
CITY OF TROUTDALE
CHERRY RIDGE SUBDIVISION
OFF-SITE 12-INCH WATER MAIN
MULTNOMAH COUNTY, OREGON
JULY 1996