

**RESOLUTION NO. 1207**

**A RESOLUTION RECOGNIZING THE COMPLETION OF THE OFF-SITE SANITARY SEWER AND ACCESS ROAD IMPROVEMENTS PERTAINING TO AND SERVING THE CHERRY RIDGE DEVELOPMENT, AND ACCEPTING THEM INTO THE CITY'S FIXED ASSET SYSTEM.**

**WHEREAS**, it was found that the construction of this off-site sanitary sewer and access road was necessary to meet the demands of the public health, safety and welfare; and,

**WHEREAS**, the construction of these public facilities have been completed; and,

**WHEREAS**, City staff has inspected these projects and found them to be in compliance with the Troutdale City Standards, construction plans and specifications.

**NOW THEREFORE BE IT RESOLVED BY THE COUNCIL OF THE CITY OF TROUTDALE**

That the following public facilities are accepted into the City's fixed assest system:

**Off-site sanitary sewer main:**

1677 linear feet of 10-inch diameter sanitary sewer main valued at	\$ 58,701
1000 linear feet of 8-inch diameter sanitary sewer main valued at	\$ 38,399
Off-site sanitary sewer main total at	\$ 97,100

**Access road:**

1664 linear feet of a paved, 15-foot wide access road (2-inches of A.C. on 8 inches 1-inch minus crushed rock material) valued at	\$ 57,240
1109 linear feet of a graveled, 15-foot wide access road (8 inches of 1-inch crushed rock) valued at	\$ 38,160
Access road total at	\$ 95,400

**Total of off-site sanitary sewer and access road at** **\$ 192,500**

YEAS: 7  
NAYS: 0  
ABSTAINED: 0

  
Paul Thalhof Mayor

Dated: 10-13-95

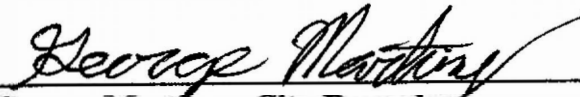
  
George Martinez, City Recorder

Adopted: October 10, 1995

C:\PW95

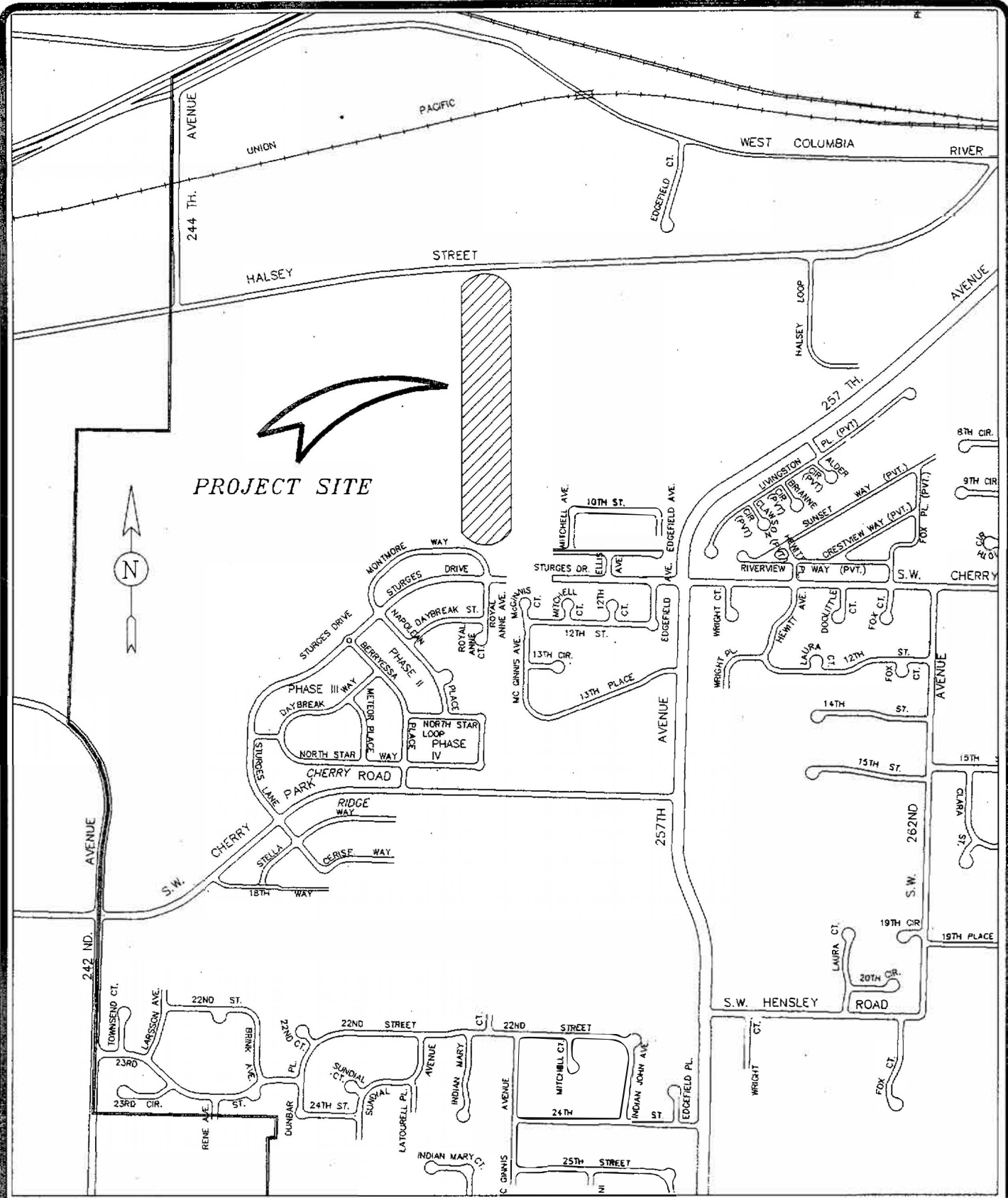

PROJECT SITE



FILE NAME: CHRY\_234  
 TITLE BLOCK: TB8X11  
 EXTERNAL REFERENCES: NONE  
 PLOT DATE: 10-02-95  
 BY: J.M.  
 PREVIOUS REVISION DATE: NONE

DEPARTMENT OF PUBLIC WORKS  
 CITY OF TROUTDALE  
 CHERRY RIDGE OFF-SITE  
 SANITARY SEWER AND  
 ACCESS ROAD  
 MULTNOMAH COUNTY, OREGON  
 OCTOBER 1995