

**RESOLUTION NO. 1123**

**RESOLUTION RECOGNIZING THE COMPLETION OF THE PUBLIC FACILITIES (WATER AND SANITARY SEWER MAINS ONLY) TO SERVE THE SWIFT TRANSPORTATION DEVELOPMENT, AND ACCEPTING THEM INTO THE CITY'S SYSTEM AS A FIXED ASSET.**

**WHEREAS**, it was found that the construction of the public facilities (water and sanitary sewer mains only) was necessary to meet the demands of public health, safety, and welfare; and

**WHEREAS**, the construction of these public facilities has been completed; and

**WHEREAS**, City staff has inspected the project and found it to be in compliance with the plans and specifications.

**NOW, THEREFORE, BE IT RESOLVED BY THE COMMON COUNCIL OF THE CITY OF TROUTDALE THAT:**

The public facilities needed to serve the Swift Transportation Development consisting of:

- 600 lineal feet of 12" water main plus associated facilities valued at \$37,400
- 600 lineal feet of 10" sanitary sewer main plus associated facilities valued at \$32,800

are accepted into the City's fixed asset system.

**ADOPTED BY THE COMMON COUNCIL OF THE CITY OF TROUTDALE THIS 27TH DAY OF SEPTEMBER, 1994.**

YEAS: 5  
NAYS: 0  
ABSTAINED: 0

  
Paul Thathofer, Mayor

Dated: 9-29-94

ATTEST:

  
George Martinez  
City Recorder

COLUMBIA

RIVER

DEVELOPEMENT  
SITE

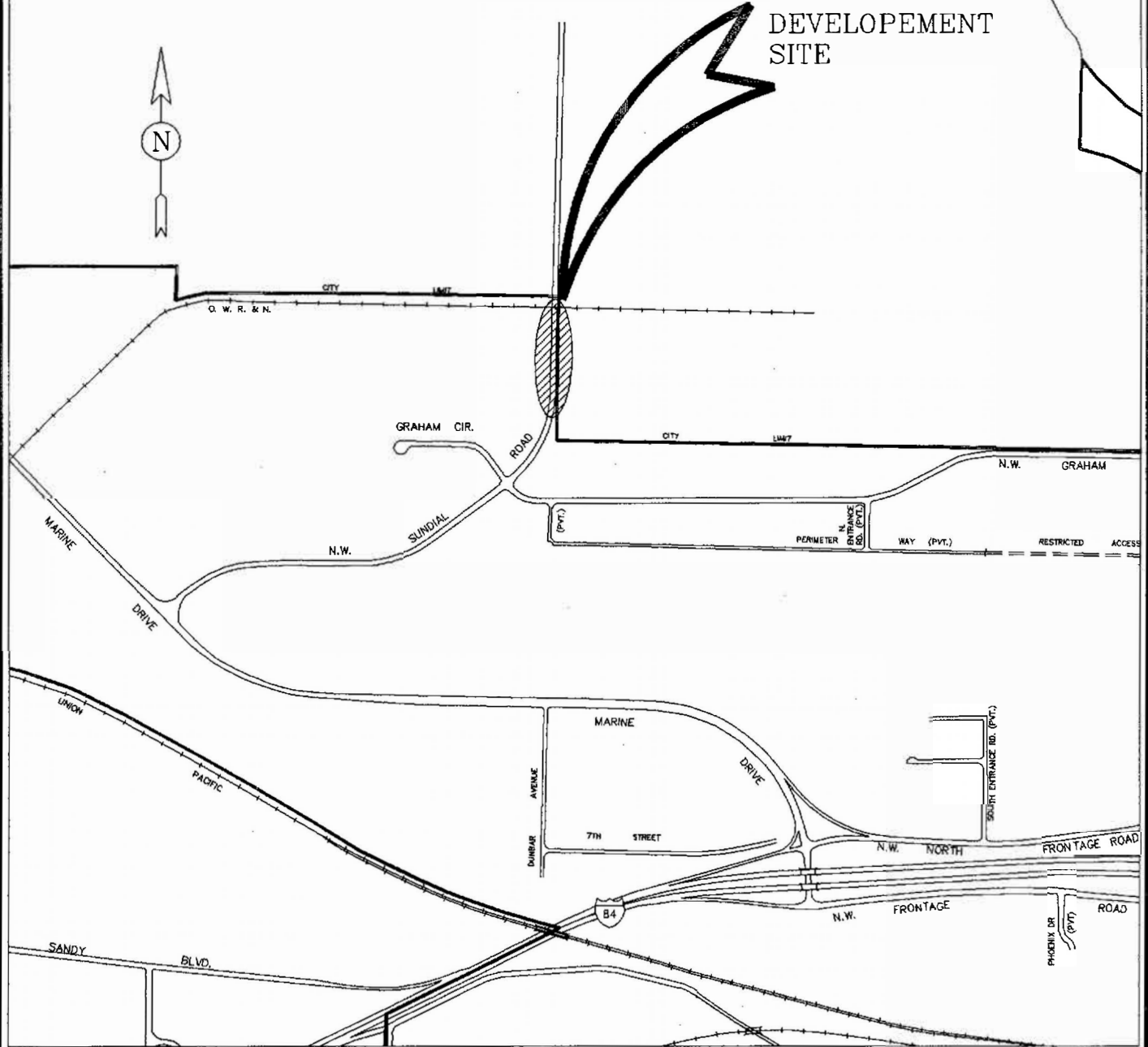

FILE NAME: SWIFT  
TITLE BLOCK: TBBX11  
EXTERNAL REFERENCES: NONE  
PLOT DATE: 08-26-94  
BY: J.M.  
PREVIOUS REVISION DATE: NONE



DEPARTMENT OF PUBLIC WORKS  
**CITY OF TROUTDALE**  
**WATER AND SANITARY**  
**IMPROVEMENTS**  
(SERVING SWIFT TRANSPORTATION)  
MULTNOMAH COUNTY, OREGON  
AUGUST 1994