

RESOLUTION NO. 1120

RESOLUTION RECOGNIZING THE COMPLETION OF THE PUBLIC FACILITIES IN THE KINGS BYWAY PARTITION PLAT SUBDIVISION AND ACCEPTING THEM INTO THE CITY'S SYSTEM AS A FIXED ASSET.

WHEREAS, it was found that the construction of the public facilities in the Kings Byway Partition Plat subdivision was necessary to meet the demands of public health, safety, and welfare; and

WHEREAS, the construction of these public facilities has been completed; and

WHEREAS, City staff has inspected the project and found it to be in compliance with the plans and specifications.

NOW, THEREFORE, BE IT RESOLVED BY THE COMMON COUNCIL OF THE CITY OF TROUTDALE THAT:

The public facilities of the Kings Byway Partition Plat subdivision consisting of:

- 872 square yards of street valued at \$12,756
- 90 lineal feet of 4" water line valued at \$2,755
- 139 lineal feet of 8" sanitary sewer line valued at \$3978
- 20 lineal feet of 12" storm sewer line valued at \$ 470

are accepted into the City's fixed asset system.

ADOPTED BY THE COMMON COUNCIL OF THE CITY OF TROUTDALE THIS 13th DAY OF SEPTEMBER, 1994.

YEAS: 5
NAYS: 0
ABSTAINED: 0

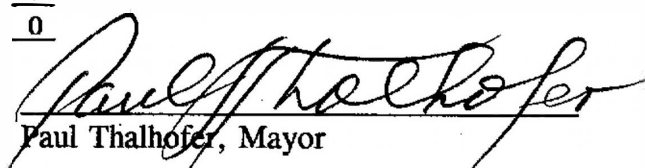
Paul Thalhofer, Mayor

Dated: 9-16-94

ATTEST:

George Martinez
City Recorder
C:\KINGBYWA

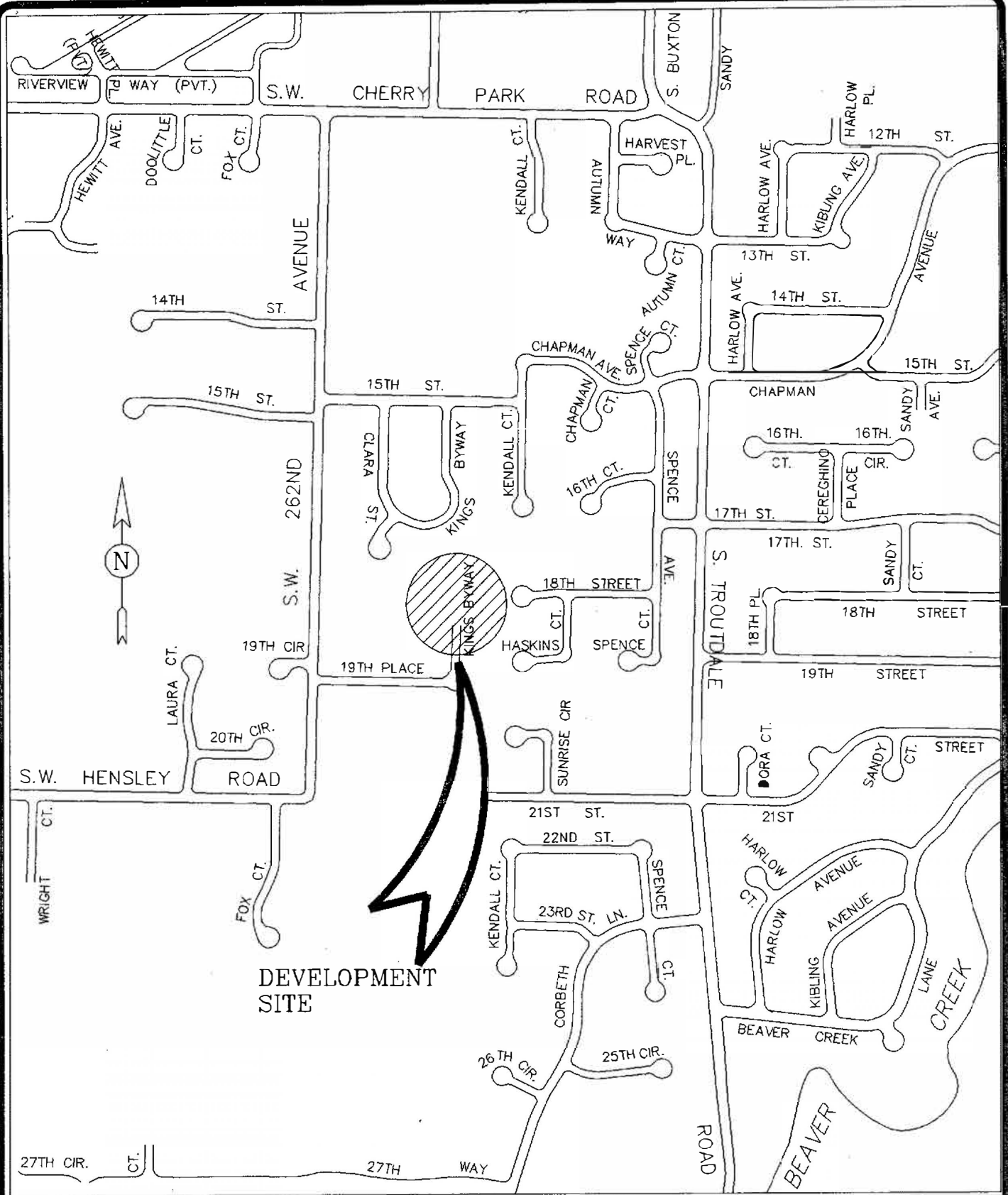

DEVELOPMENT
SITE

FILE NAME: 19TH
 TITLE BLOCK: TB8X11
 EXTERNAL REFERENCES: NONE
 PLOT DATE: 08-26-94
 BY: J.M.
 PREVIOUS REVISION DATE: NONE



DEPARTMENT OF PUBLIC WORKS
 CITY OF TROUTDALE
 KINGS BYWAY
 PARTITION PLAT
 MULTNOMAH COUNTY, OREGON
 AUGUST 1994