

RESOLUTION NO. 1049

**RESOLUTION AUTHORIZING THE AWARD OF A
CONSTRUCTION CONTRACT FOR IMPROVEMENTS TO
HARLOW COURT**

WHEREAS, the reconstruction of Harlow Court is necessary for the public safety and general welfare; and

WHEREAS, a project to reconstruct Harlow Court was approved in the FY 1993-94 budget; and

WHEREAS, plans and specifications have been prepared, an advertisement for bids has been published, bids have been opened, and the results have been analyzed; and

WHEREAS, the City staff and the consulting engineer recommend that the City award a contract in conformance with the published plans and specifications.

NOW, THEREFORE, BE IT RESOLVED BY THE COMMON COUNCIL OF THE CITY OF TROUTDALE THAT:

The Mayor is authorized to enter into a contract for the reconstruction of Harlow Court with the responsible low bidder, as determined by the Council, and that staff issue the appropriate Notice to Proceed upon receipt of the appropriately executed contract documents, payment bonds, performance bonds, and other requirements set forth in the bid documents.

ADOPTED BY THE COMMON COUNCIL OF THE CITY OF TROUTDALE THIS 10TH DAY OF AUGUST, 1993.

YEAS: 6
NAYS: 0
ABSTAINED: 0

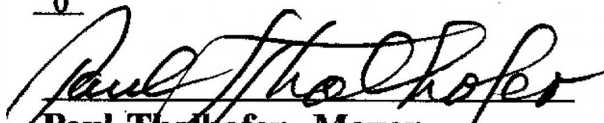
Paul Thalhofer, Mayor
Dated: Aug 10, 1993

ATTEST:

George Martinez
Deputy City Recorder

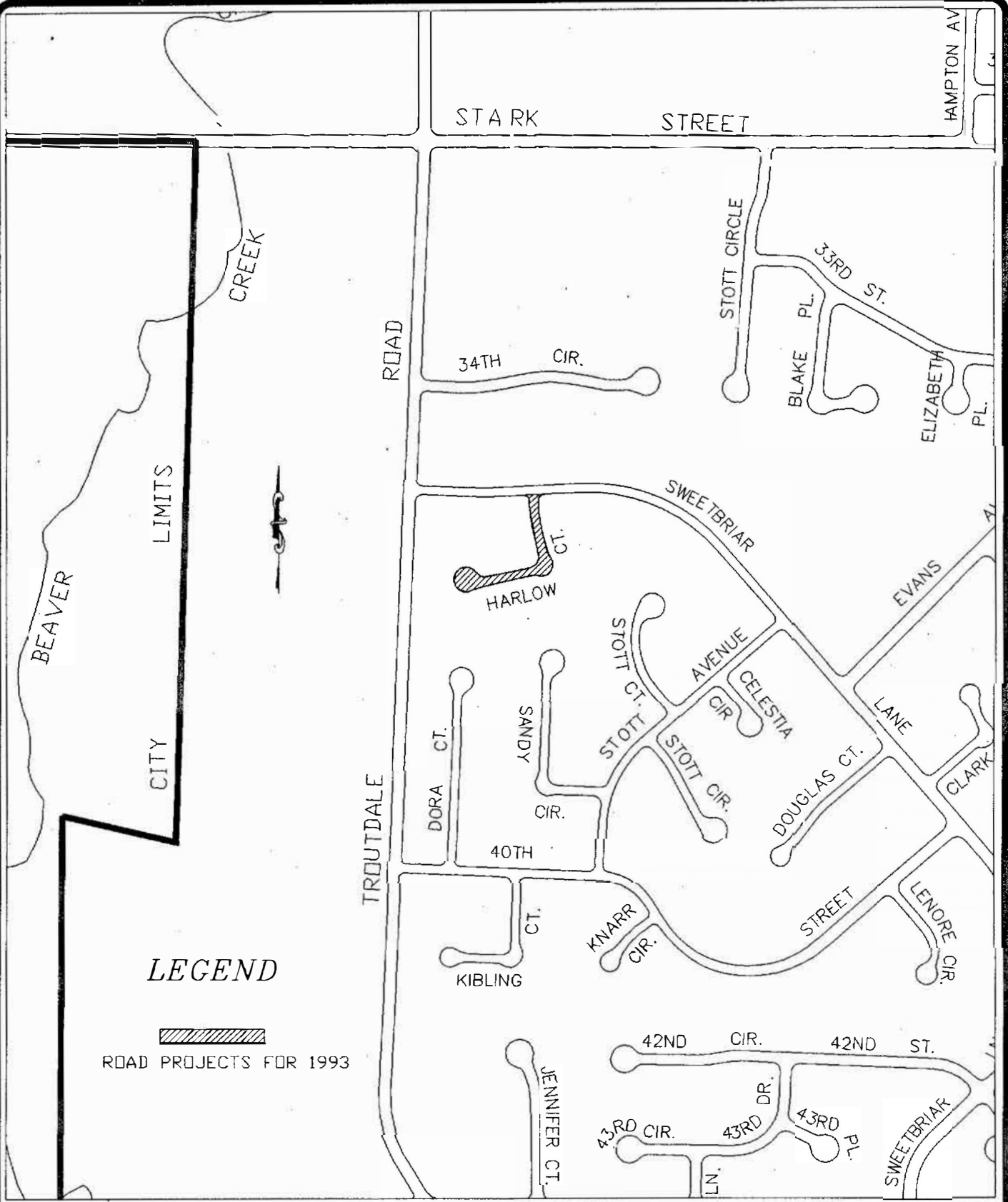

FILE NAME: ODD-ENDS
 TITLE BLOCK: TB8X11
 EXTERNAL REFERENCES: TROUTBAS;
 PLOT DATE: 8/3/93
 BY: J.M.
 PREVIOUS REVISION DATE: 1/27/93



DEPARTMENT OF PUBLIC WORKS
CITY OF TROUTDALE
1993 ROAD PROJECTS
 HARLOW COURT
 MULTNOMAH COUNTY, OREGON
 AUGUST 1993

CITY OF TROUTDALE
DEPARTMENT OF PUBLIC WORKS

CONSTRUCTION : FALL 1993

PROJECT #:

HARLOW COURT RECONSTRUCTION
BID COMPARISON SHEET

Item #	Approx Quant	Unit of Msr	Descript'n	ENGINEER'S ESTM		KERR CONST.	
				Unit \$	Total \$	Unit \$	Total \$
REGULAR CONTRACT							
1	1	L.S.	Mobilization	\$3,000.00	\$3,000.00	\$2,875.00	\$2,875.00
2	1	L.S.	Maintnce & protection of Traff.	\$500.00	\$500.00	\$575.00	\$575.00
3	1	L.S.	Clearing & Grubbing	\$500.00	\$500.00	\$1,150.00	\$1,150.00
4	250	C.Y.	Earthwork (Unclassified Exc.)	\$10.00	\$2,500.00	\$17.50	\$4,375.00
5	275	TON	Aggregate Base 3/4"-0	\$13.00	\$3,575.00	\$13.23	\$3,638.25
6	110	TON	Asphaltic Concrete/Class "C"	\$40.00	\$4,400.00	\$50.21	\$5,523.10
7	330	L.F.	12" RCP Strom Sewer	\$30.00	\$9,900.00	\$20.16	\$6,652.80
8	4	Each	Drainage Inlet	\$700.00	\$2,800.00	\$850.00	\$3,400.00
9	2	Each	Precast Concrete Storm MH	\$1,500.00	\$3,000.00	\$1,265.00	\$2,530.00
10	600	L.F.	Underdrain	\$7.00	\$4,200.00	\$7.65	\$4,590.00
11	1	L.S.	Reset Inlet Frame and Grate	\$200.00	\$200.00	\$660.00	\$660.00
12	4	S.Y.	Conc Ped. Ramp/4" thick	\$15.00	\$60.00	\$183.50	\$734.00
13	1	Each	Adjust MH to Grade	\$500.00	\$500.00	\$345.00	\$345.00
Regular Contract Total					\$35,135.00		\$37,048.15
SUPPLEMENTAL							
A	0	S.Y.	** Concrete Driveway		\$0.00	\$40.00	\$0.00
B	0	S.Y.	** Driveway's Curb & Gutter		\$0.00	\$12.00	\$0.00
Supplemental Totals					\$0.00		\$0.00
Regular & Supplemental Totals					\$35,135.00		\$37,048.15

** Quantities are to be determined in field, if property owner chooses to have his/her driveway approach reconstructed

CITY OF TROUTDALE
DEPARTMENT OF PUBLIC WORKS

CONSTRUCTION : FALL 1993
PROJECT #:

HARLOW COURT RECONSTRUCTION
BID COMPARISON SHEET

Item #	Approx Quant	Unit of Msr	Descrpt'n	PARKER NW		KEAT'G EXC.	
				Unit \$	Total \$	Unit \$	Total \$
REGULAR CONTRACT							
1	1	L.S.	Mobilization	\$1,850.00	\$1,850.00	\$2,000.00	\$2,000.00
2	1	L.S.	Maintnce & protection of Traff.	\$1,000.00	\$1,000.00	\$1,000.00	\$1,000.00
3	1	L.S.	Clearing & Grubbing	\$600.00	\$600.00	\$1,000.00	\$1,000.00
4	250	C.Y.	Earthwork (Unclassified Exc.)	\$18.00	\$4,500.00	\$25.00	\$6,250.00
5	275	TON	Aggregate Base 3/4"-0	\$22.00	\$6,050.00	\$18.00	\$4,950.00
6	110	TON	Asphaltic Concrete/Class "C"	\$60.00	\$6,600.00	\$53.00	\$5,830.00
7	330	L.F.	12" RCP Strom Sewer	\$24.20	\$7,986.00	\$30.00	\$9,900.00
8	4	Each	Drainage Inlet	\$1,000.00	\$4,000.00	\$1,000.00	\$4,000.00
9	2	Each	Precast Concrete Storm MH	\$1,760.00	\$3,520.00	\$1,500.00	\$3,000.00
10	600	L.F.	Underdrain	\$7.70	\$4,620.00	\$15.33	\$9,198.00
11	1	L.S.	Reset Inlet Frame and Grate	\$250.00	\$250.00	\$800.00	\$800.00
12	4	S.Y.	Conc Ped. Ramp/4" thick	\$70.00	\$280.00	\$100.00	\$400.00
13	1	Each	Adjust MH to Grade	\$175.00	\$175.00	\$500.00	\$500.00
Regular Contract Total					\$41,431.00		\$48,828.00
SUPPLEMENTAL							
A	0	S.Y.	** Concrete Driveway	\$35.00	\$0.00	\$125.00	\$0.00
B	0	S.Y.	** Driveway's Curb & Gutter	\$20.00	\$0.00	\$50.00	\$0.00
Suplemental Totals					\$0.00		\$0.00
Regular & Supplemental Totals					\$41,431.00		\$48,828.00

**** Quantities are to be determined in field, if property owner chooses to have his/her driveway approach reconstructe**

CITY OF TROUTDALE
DEPARTMENT OF PUBLIC WORKS

CONSTRUCTION : FALL 1993
PROJECT #:

HARLOW COURT RECONSTRUCTION
BID COMPARISON SHEET

Item #	Approx Quant	Unit of Msr	Descript'n	BENGE CONST	
				Unit \$	Total \$
REGULAR CONTRACT					
1	1	L.S.	Mobilization	\$2,076.00	\$2,076.00
2	1	L.S.	Maintnce & protection of Traff.	\$650.00	\$650.00
3	1	L.S.	Clearing & Grubbing	\$2,171.00	\$2,171.00
4	250	C.Y.	Earthwork (Unclassified Exc.)	\$29.56	\$7,390.00
5	275	TON	Aggregate Base 3/4"-0	\$30.85	\$8,483.75
6	110	TON	Asphaltic Concrete/Class "C"	\$50.00	\$5,500.00
7	330	L.F.	12" RCP Strom Sewer	\$45.85	\$15,130.50
8	4	Each	Drainage Inlet	\$825.00	\$3,300.00
9	2	Each	Precast Concrete Storm MH	\$1,600.00	\$3,200.00
10	600	L.F.	Underdrain	\$13.43	\$8,058.00
11	1	L.S.	Reset Inlet Frame and Grate	\$400.00	\$400.00
12	4	S.Y.	Conc Ped. Ramp/4" thick	\$47.00	\$188.00
13	1	Each	Adjust MH to Grade	\$400.00	\$400.00
Regular Contract Total					\$56,947.25
SUPPLEMENTAL					
A	0	S.Y.	** Concrete Driveway	\$54.00	\$0.00
B	0	S.Y.	** Driveway's Curb & Gutter	\$14.25	\$0.00
Supplemental Totals					\$0.00
Regular & Supplemental Totals					\$56,947.25

** Quantities are to be determined in field, if property owner chooses to have his/her driveway approach reconstructe