

RESOLUTION NO. 441-R

A RESOLUTION DECLARING EXCESS CAPACITY IN THE HALSEY STORM SEWER TRUNK OUTFALL AND AUTHORIZING TEMPORARY CONNECTION FOR LAND OUTSIDE THE LID BOUNDARY TO THE SAME.

WHEREAS, Multnomah County was a participant in the Halsey Storm Sewer LID (LID 3-78) and was assessed initially for the required oversizing of the system outfall to accommodate 125 acres of land owned by the County, and

WHEREAS, the development of said lands appears to be reserved for some future date, and

WHEREAS, the County is currently in need of a storm sewer outfall for Cherry Park and Buxton Roads in Troutdale,

AND, NOW THEREFORE, BE IT RESOLVED BY THE COMMON COUNCIL OF THE CITY OF TROUTDALE THAT:

Multnomah County be allowed to connect to the existing outfall trunk line at Buxton Road and Columbia Boulevard so as to utilize that portion of the line's capacity for which it has been assessed; it being fully understood that said connection is temporary and that an alternate outfall shall be established prior to the connection of any of its property along Halsey Street to the existing storm sewer trunk.

ADOPTED BY THE COMMON COUNCIL OF THE CITY OF TROUTDALE THIS 28th DAY OF July, 1981.

YEAS 6

NAYS 0



Robert M. Sturges, Mayor

ATTEST:

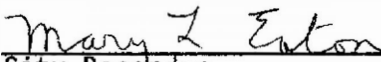

City Recorder

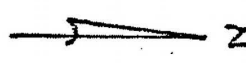
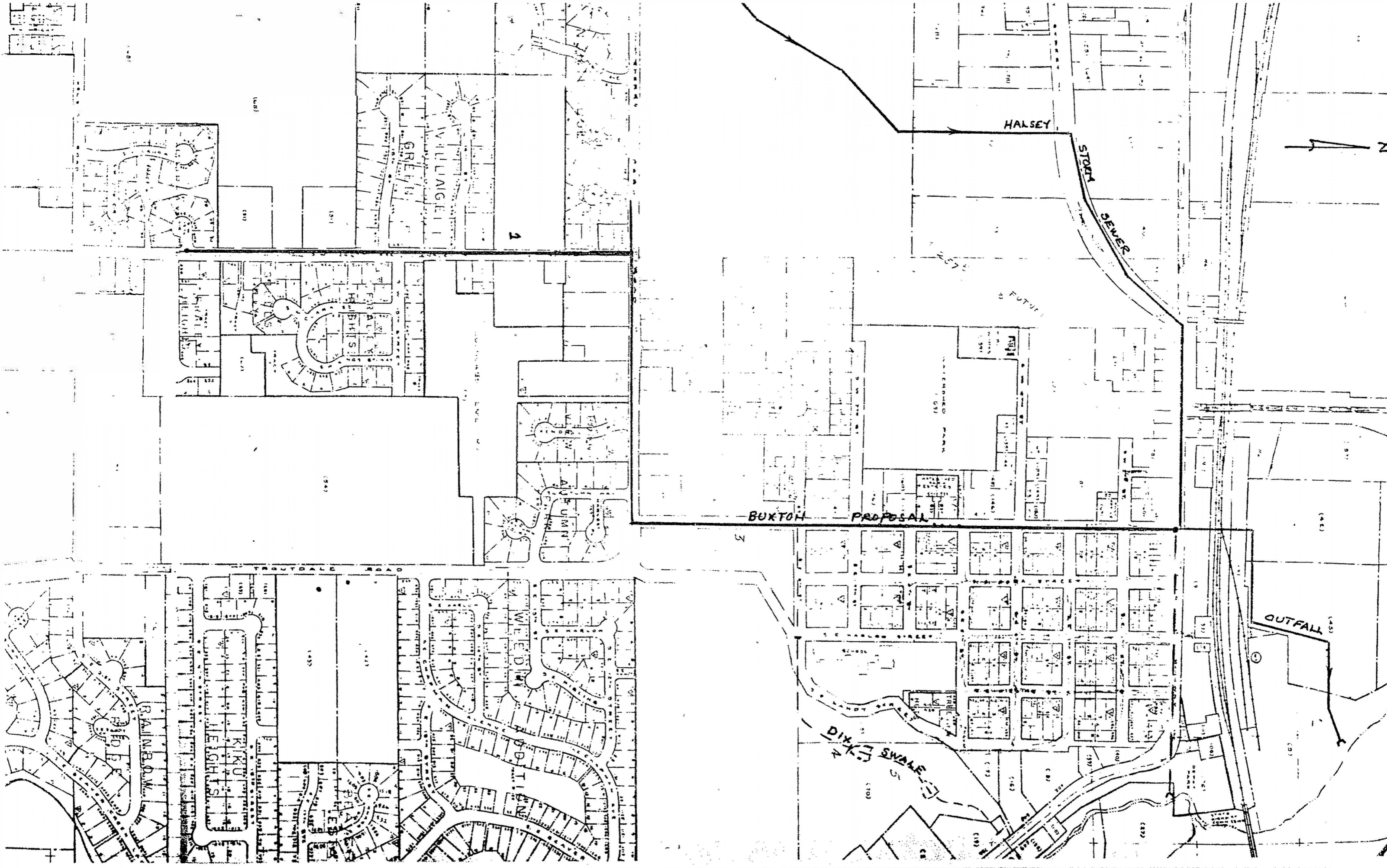

HALSEY

STORM SEWER

BUXTON PROPOSAL

OUTFALL

DIXON SWALE

1

3

GREVILLE
WILLIAMS

FURNACE
JEHSHITS

WEDDING
DIXON

RAILROAD
BRAIN

KURU
JEHSHITS

WATERED PARK

FUTURE

1000

1000

1000

1000

1000

1000

1000

1000

1000

1000

1000

1000

1000

1000

1000

1000

1000

1000

1000

1000

1000

1000

1000

1000

1000

1000

1000

1000

1000

1000

1000

1000

1000

1000

1000

1000

1000

1000

1000

1000

1000

1000

1000

1000

1000

1000

1000

1000

1000

1000

1000

1000

1000

1000

1000

1000

1000

1000

1000

1000

1000

1000

1000

1000

1000

1000

1000

1000

1000

1000

1000

1000

1000

1000

1000

1000

1000

1000

1000

1000

1000

1000

1000

1000

1000

1000

1000

1000

1000

1000

1000

1000

1000

1000

1000

1000

1000

1000

1000

1000

1000

1000

1000

1000

1000

1000

1000

1000

1000

1000

1000

1000

1000

1000

1000

1000

1000

1000

1000

1000

1000

1000

1000

1000

1000

1000

1000

1000

1000

1000

1000

1000

1000

1000

1000

1000

1000

1000

1000

1000

1000

1000

1000

1000

1000

1000

1000

1000

1000

1000

1000

1000

1000

1000

1000

1000

1000

1000

1000

1000

1000

1000

1000

1000

1000

1000

1000

1000

1000

1000

1000

1000

1000

1000

1000

1000

1000

1000

1000

1000

1000

1000

1000

1000

1000

1000

1000

1000

1000

1000

1000

1000

1000

1000

1000

1000

1000

1000

1000

1000

1000

1000

1000

1000

1000

1000

1000

1000

1000

1000

1000

1000

1000

1000

1000

1000

1000

1000

1000

1000

1000

1000

1000

1000

1000

1000

1000

1000

1000

1000

1000

1000

1000

1000

1000

1000

1000

1000

1000

1000

1000

1000

1000

1000

1000

1000

1000

1000

1000

1000

1000

1000

1000

1000

1000

1000

1000

1000

1000

1000

1000

1000

1000

1000

1000

1000

1000

1000

1000

1000

1000

1000

1000

1000

1000

1000

1000

1000

1000

1000

1000

1000

1000

1000

1000

1000

1000

1000

1000

1000

1000

1000

1000

1000

1000

1000

1000

1000

1000

1000

1000

1000