

RESOLUTION No. 413-R

A RESOLUTION ACCEPTING DEDICATED PUBLIC IMPROVEMENTS

WHEREAS, The streets named below, which are recorded on the final plat of "Fleur De Lis" subdivision and are located within the City of Troutdale, have been dedicated by Burlingame Development, Inc. for use by the public;

WHEREAS, The City Engineer, Public Works Director, Parks Foreman and Planning Director have inspected the streets named below and are recommending acceptance of all streets, sanitary sewer, storm sewer and water system improvements;

NOW, THEREFORE BE IT RESOLVED BY THE COMMON COUNCIL OF THE CITY OF TROUTDALE That the City does hereby accept the following streets as dedicated streets to be operated and maintained by the City of Troutdale, for use by the general public from this date forward.

NAME OF RECORDED STREETS:

1. S.W. 27th Circle
2. S.W. 27th Way
3. S.W. Laura Court
4. S.W. Hewitt Avenue
5. S.W. 28th Street
6. S.W. Hewitt Place

NAME OF RECORDED TRACTS:

1. Tract "D"

PASSED BY THE COMMON COUNCIL OF THE CITY OF TROUTDALE THIS 10th
DAY OF March, 1981.

YEAS 4

NAYS 0 (1 abstention - Dalton Williams)

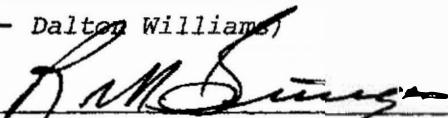
Robert M. Sturges, Mayor

ATTEST:

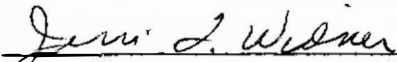
Terri L. Widner
Finance Director/City Recorder

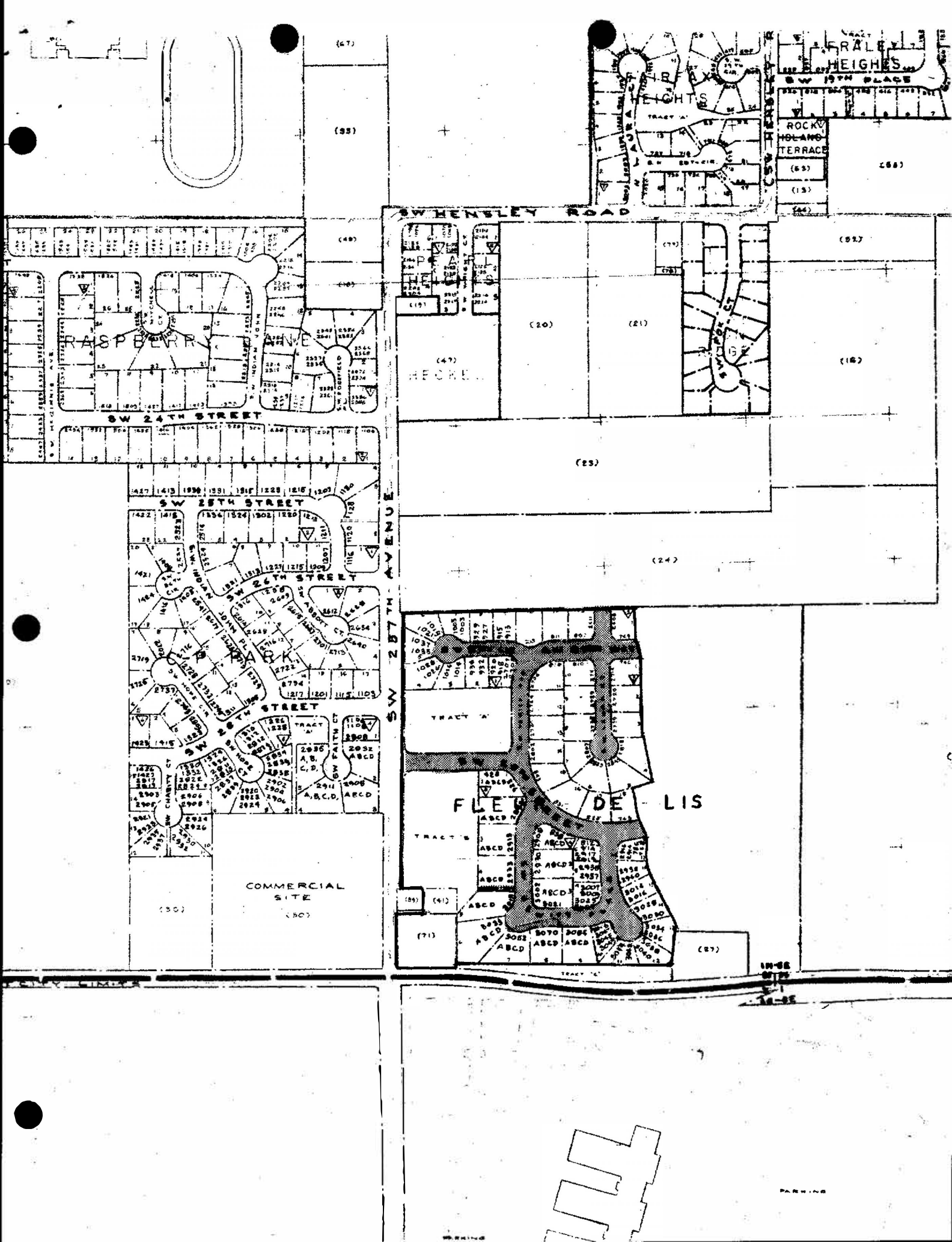

(47)

(55)

(48)

(49)

(50)

(51)

(52)

(53)

(54)

TRACT
HEIGHES
SW 19TH PLACE
ROCKY
HOLLAND
TERRACE
(55)
(15)
(56)

(58)

(57)

(16)

(24)

(23)

(20)

(21)

(47)

SW HENSLEY ROAD

SW 27TH AVENUE

SW 24TH STREET

SW 25TH STREET

SW 26TH STREET

SW 27TH STREET

COMMERCIAL SITE

TRACT A

TRACT B

TRACT C

FLEISCHER DE LIS

IN-52
0175
14-52

PARKING

WORKING