

RESOLUTION No. 116

WHEREAS, under the provisions of ORS 366.800 and 366.805 there has been withdrawn from state highway funds appropriated for allocation to the several cities of the State of Oregon the sum of Two Hundred Fifty Thousand and No/100 (\$250,000) Dollars, and said sum has been set up in a separate account to be administered by the Oregon Transportation Commission and to be spent each year by said Commission upon streets not a part of the state highway system, within cities which are receiving excessive wear through sudden increases in population in the area or heavy and unusual traffic; and

WHEREAS, the City of TROUTDALE is an incorporated city of the State of Oregon and has a population of 2500 as given by the latest official census; and

WHEREAS, the following streets of said city, S.E. 7th
FROM S.E. HARLOW TO BUXTON

are not a part or parts of the state highway system, but are streets under the jurisdiction and control of said city which are "receiving excessive wear through sudden increase in population in the area or heavy and unusual traffic," and

WHEREAS, said streets are and each of them is in need of repair, reconditioning, and other major improvement,

NOW, THEREFORE, the members of the City Council, in regular or special session assembled, do hereby find, declare, and resolve:

1. That the aforesaid named streets of said city are in need of repair, reconditioning, and other major improvement.
2. That said streets are in their present state and condition of disrepair by reason of excessive wear through sudden increases in population in the area, or by heavy and unusual traffic.
3. That the Oregon Transportation Commission hereby is respectfully requested to consider and declare said streets as qualified for reconditioning, repair, and other improvement out of funds allocated and made available by and through the said \$250,000 appropriation of state highway revenues which is to be administered and spent by the Transportation Commission.

4. That the City of TROUTDALE does hereby offer to Transportation Commission and does hereby pledge complete cooperation and assistance to the end that said city may share and participate in the use and benefit of said special fund and appropriation; and therefore does designate ROBERT JEAN as the official representative of the city in all negotiations resulting from this request.

Passed and approved this 22nd day of June, 1976.

There is attached hereto and made a part hereof, a city map on which is indicated the street, streets, road, or roads described in this resolution.

* * * * *

I hereby certify that the foregoing resolution was passed and approved by the City Council of the City of TROUTDALE at a regular or special meeting of said Council, held on the 22nd day of June, 1976, and the above copy is a true and correct copy of the original and of the whole thereof.

Dated this 23rd day of June, 1976.

Betty J. Bampton
City Recorder

Adopted by the Common Council this 22nd day of June, 1976 and signed by the Mayor this 22nd day of June, 1976.

R. M. Stenger
Mayor

RESOLUTION No. 116

WHEREAS, under the provisions of ORS 366.800 and 366.805 there has been withdrawn from state highway funds appropriated for allocation to the several cities of the State of Oregon the sum of Two Hundred Fifty Thousand and No/100 (\$250,000) Dollars, and said sum has been set up in a separate account to be administered by the Oregon Transportation Commission and to be spent each year by said Commission upon streets not a part of the state highway system, within cities which are receiving excessive wear through sudden increases in population in the area or heavy and unusual traffic; and

WHEREAS, the City of TROUTDALE is an incorporated city of the State of Oregon and has a population of 2500 as given by the latest official census; and

WHEREAS, the following streets of said city, S.E. 7th
FROM S.E. HARLOW TO BUXTON

are not a part or parts of the state highway system, but are streets under the jurisdiction and control of said city which are "receiving excessive wear through sudden increase in population in the area or heavy and unusual traffic," and

WHEREAS, said streets are and each of them is in need of repair, reconditioning, and other major improvement,

NOW, THEREFORE, the members of the City Council, in regular or special session assembled, do hereby find, declare, and resolve:

1. That the aforesaid named streets of said city are in need of repair, reconditioning, and other major improvement.

2. That said streets are in their present state and condition of disrepair by reason of excessive wear through sudden increases in population in the area, or by heavy and unusual traffic.

3. That the Oregon Transportation Commission hereby is respectfully requested to consider and declare said streets as qualified for reconditioning, repair, and other improvement out of funds allocated and made available by and through the said \$250,000 appropriation of state highway revenues which is to be administered and spent by the Transportation Commission.

4. That the City of TROUTDALE does hereby offer to Transportation Commission and does hereby pledge complete cooperation and assistance to the end that said city may share and participate in the use and benefit of said special fund and appropriation; and therefore does designate ROBERT JEAN as the official representative of the city in all negotiations resulting from this request.

Passed and approved this 22 day of JUNE, 19 76

There is attached hereto and made a part hereof, a city map on which is indicated the street, streets, road, or roads described in this resolution.

* * * * *

I hereby certify that the foregoing resolution was passed and approved by the City Council of the City of TROUTDALE at a regular or special meeting of said Council, held on the 22 day of JUNE, 19 76 and the above copy is a true and correct copy of the original and of the whole thereof.

Dated this 23 day of JUNE, 19 76

Betty J. Bergstrom
City Recorder

PROJECT DATA. CITY OF TROUTDALE Date 6-14-76

To be financed by Special City Allotment Fund and necessary city funds.

Street name S.E. 7TH STREET - FROM S.E. HARLOW STREET TO BUXTON
(Locate project on attached map.)

Project length 720 FEET

DESIRED STREET SECTION:

Standard roadway; width of travel way: 28 feet, width of shoulders: 2 feet

Curbed section; width curb to curb: NONE feet

Remarks _____

Surface now in place: Oil X Paving X Gravel _____

Present surface width: 20 feet

RIGHT-OF-WAY: (City shall, without cost to State, provide all right-of-way required)

Width of present right-of-way: 60 feet

Additional right-of-way required? Yes _____ No X

State to furnish right-of-way descriptions? Yes _____ No X

Give width of intersecting streets: 20 FEET - 50 FOOT RIGHTAWAYS

Are intersecting streets curbed? Yes _____ No X

Remarks _____

CONCRETE CURBS:

Now in place? Yes _____ No X

Width between present curbs: 0 feet

City to construct curbs? Yes X No _____

To be constructed as part of project? Yes _____ No X

Length of desired radius on curb returns: _____ feet

Does city desire special type of curbs? Yes _____ No X

Explain: CITY TO CONSTRUCT CURBS WHEN FUNDS ARE AVAILABLE

SIDEWALKS

Are sidewalks now in place? Yes ___ No X

Present sidewalks, Length: 0 feet; Width: 0 feet

Distance between present sidewalks: 0 feet

Are sidewalks to be constructed as part of project? Yes ___ No X

Width of sidewalks to be constructed: 0 feet

Are sidewalks to be constructed only on one side of street? Yes ___ No X

Are sidewalks to be constructed on both sides of street? Yes ___ No X

Give: Length to be constructed and On which side of street

 feet N. ___ S. ___ E. ___ W. ___

 feet N. ___ S. ___ E. ___ W. ___

Should sidewalks be placed against curbs? Yes ___ No ___

Is utility strip required? Yes ___ No ___; Width: feet

Remarks NO SIDEWALKS TO BE CONSTRUCTED AT PRESENT TIME

STORM SEWERS - - - - -

Now in place? Yes ___ No X

If yes, are they adequate for increased flow? Yes ___ No ___

Indicate depth of main lines from present surface: feet

To be constructed by City? Yes X No ___

To be constructed as part of project? Yes ___ No X

/Show location of outfall on city map./

SANITARY SEWERS - - - - -

Now in place? Yes X No ___ /NOTE: City to adjust if required./

If yes, indicate depth of sewers from present surface: 6 feet

Remarks CITY IS PRESENTLY CONTEMPLATING A STORM SEWER STUDY, CITY

WIDE

WORK TO BE DONE BY CITY AS PART OF PROJECT:

Grading? Yes No x
 Clearing? Yes x No
 Base rock? Yes No x
 Concrete curbs? Yes No x
 Driveways? Yes No x

Remarks SOME ORNAMENTAL POSTS, AND CONCRETE STEPS TO BE MOVED BY CITY

GENERAL INFORMATION:

Are city finances available? Yes x No

When available? Date JULY 1977

Has city established grade on street? Yes No x
 (If yes, please include copy of data.)

Please indicate site for disposal of excess excavated material: NORTH

SHOULDER OF S.W. 7TH STREET

General remarks: STREET IS HEAVILY USED BY SCHOOL BUSES AND INCREAS-
ING NUMBER OF PARENTS DUE TO GROWTH IN AREA

By R. M. Sturges
 R. M. STURGES Mayor
 By R. W. Jean
~~City Recorder~~ or City Manager
 ROBERT JEAN
 By Duane Lee P. E.
 DUANE LEE City Engineer

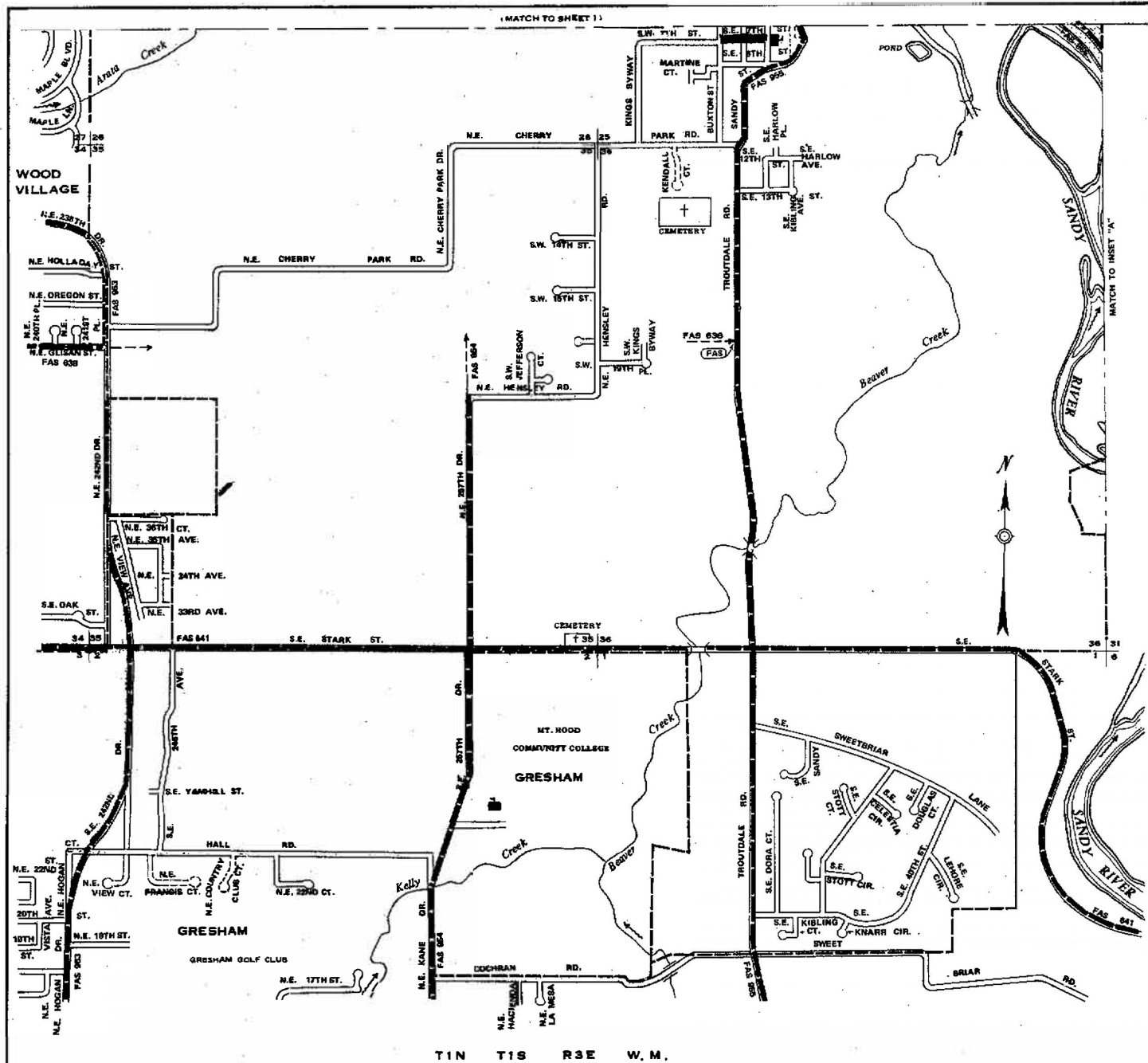

TROUTDALE

MULTNOMAH COUNTY, OREGON

LEGEND

- FEDERAL AID INTERSTATE SYSTEM
- FEDERAL AID PRIMARY SYSTEM
- FEDERAL AID SECONDARY SYSTEM-STATE
- FEDERAL AID SECONDARY SYSTEM-COUNTY
- OTHER FEDERAL AID SECONDARY-LOCAL
- TERMINATION OF FA SYSTEM
- TERMINATION OF ROUTE
- DIVIDED HIGHWAY
- UNDIVIDED HIGHWAY-NO. OF LANES
- STREET OPEN FOR TRAVEL
- STREET DEDICATED BUT NOT OPEN

- INTERSTATE NUMBERED ROUTE (FAI)
- U.S. NUMBERED ROUTE
- STATE NUMBERED ROUTE
- POST OFFICE
- SCHOOL
- CITY CENTER
- R.R. DEPOT
- CITY LIMITS
- PUBLIC BLDG.
- CITY HALL
- COURT HOUSE
- ARMORY
- LIBRARY

PROJ. 17-18
OREGON STATE HIGHWAY DEPARTMENT
U.S. DEPARTMENT OF TRANSPORTATION
FEDERAL HIGHWAY ADMINISTRATION

Population 1,680
Scale in Feet
REVISED FEB. 1973

SHEET
ARRANGEMENT
1
2

SHEET 2 OF 2 SHEETS