

RESOLUTION NO. 761

A RESOLUTION AUTHORIZING AND DIRECTING THE CITY RECORDER TO CERTIFY TO THE CLACKAMAS COUNTY CLERK A MEASURE REFERRING TO THE ELECTORATE A PROPOSED ANNEXATION OF 0.61 ACRES DESCRIBED AS TAX LOT 300 OF TAX MAP 4-1E-03BB LOCATED ON THE WEST SIDE OF S. REDWOOD STREET ACROSS FROM TROST ELEMENTARY SCHOOL TO THE CITY OF CANBY; AUTHORIZING THE CITY RECORDER TO SEND AN EXPLANATORY STATEMENT FOR THE VOTER'S PAMPHLET; AND DOING ALL OTHER NECESSARY ACTS TO PLACE THE MATTER BEFORE THE VOTERS OF THE CITY OF CANBY FOR THE NOVEMBER 6, 2001 GENERAL ELECTION.

WHEREAS, the Canby City Council has heretofore approved an application filed by David and Donna Sheldon to annex approximately 0.61 acres of land into the City of Canby; and

WHEREAS, pursuant to the provisions of the Canby City Charter, the approval of the proposed annexation must be referred to the electorate of the City of Canby for an election; and

WHEREAS, ORS 250.035 requires a Notice of Measure be prepared by the City and submitted to the Clackamas County Elections Department by September 6, 2001 in order to appear on the ballot for the November 6, 2001 general election; and

WHEREAS, pursuant to the Canby Municipal Code, the Canby City Attorney has prepared a Notice of City Measure Election and Summary for Voter's Pamphlet to be submitted to the Elections Department;

NOW THEREFORE, IT IS HEREBY RESOLVED by the City Council of the City of Canby, as follows:

1. The City Recorder of the City of Canby is hereby authorized and directed to certify to the Clackamas County Clerk for submission to the voters at the November 6, 2001 general election, the Notice of City Measure Election. Such Notice of City Measure Election is attached to this Resolution in proper form and adopted by the City.
2. The City Recorder of the City of Canby is further authorized and directed to submit a Summary of the Measure to be placed in the voter's pamphlet explaining in clear and concise language the affect of such ballot measure. Such summary is attached to this Resolution in proper form and adopted by the City.

3. The City Recorder, the City Administrator and the City Attorney are hereby authorized to do all other necessary and proper acts to place the ballot measure before the voters at the November 6, 2001 general election.

ADOPTED this 15th day of August, 2001, by the Canby City Council.

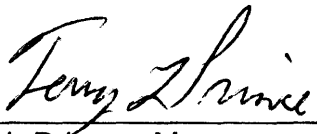

Terry L Prince - Mayor

ATTEST:



Chaunee Seifried,
City Recorder, Pro-Tem

NOTICE OF CITY MEASURE ELECTION

CITY OF CANBY

Notice is hereby given that on Tuesday, November 6, 2001, an election will be held in the City of Canby, Clackamas County, Oregon. The following shall be the ballot title for the measure submitted to the City's voters on this date:

CAPTION: MEASURE APPROVING ANNEXATION OF 0.61 ACRES INTO CITY OF CANBY

QUESTION: SHALL 0.61 ACRES LOCATED AT 687 S. REDWOOD STREET BE ANNEXED INTO CANBY?

SUMMARY: Annexation is the legal process to bring property inside the City limits. David and Donna Sheldon, as owners of 0.61 acres (one tax lot), have filed an application asking the City to bring their property into the City limits. The legal description of the property is Tax Lot 300 of Tax Map 4-1E-03BB located at 687 S. Redwood Street across from Trost Elementary School. Properties surrounding this tax lot on the east, west, north and south are within the City limits and within the Urban Growth Boundary. This application has previously been approved by the Planning Commission and City Council by unanimous votes. The property contains one residence. The applicants currently reside in the residence. The City's Zoning Map calls for low density residential for the property upon annexation. Future development of the property would be limited to a maximum of two additional houses through a minor land partition. Any land partitioning would have to comply with state and local land use laws and would be subject to public review.

The following authorized local government official hereby certifies that the above ballot title is true and complete.

Chaunee Seifried
Chaunee Seifried,
Canby City Recorder

8-15-01
Date

[illegible]

S 89° 34' 40" E 144.99

200

0.51A_c

609

P. P.

PARCEL 1

2000-28

SA COURT

100

14000

13900

67

- 66

65

500

13400

13300

61

60

5'45"

VE:

3100

13200.

361.

1391

57

58

2400

12300

360

1380

50

49

400

3.08 AC.

300

0.61Ac

687

344.36

154.84

13085

324.56

314.5x.

C.R. NO. 227

8
→

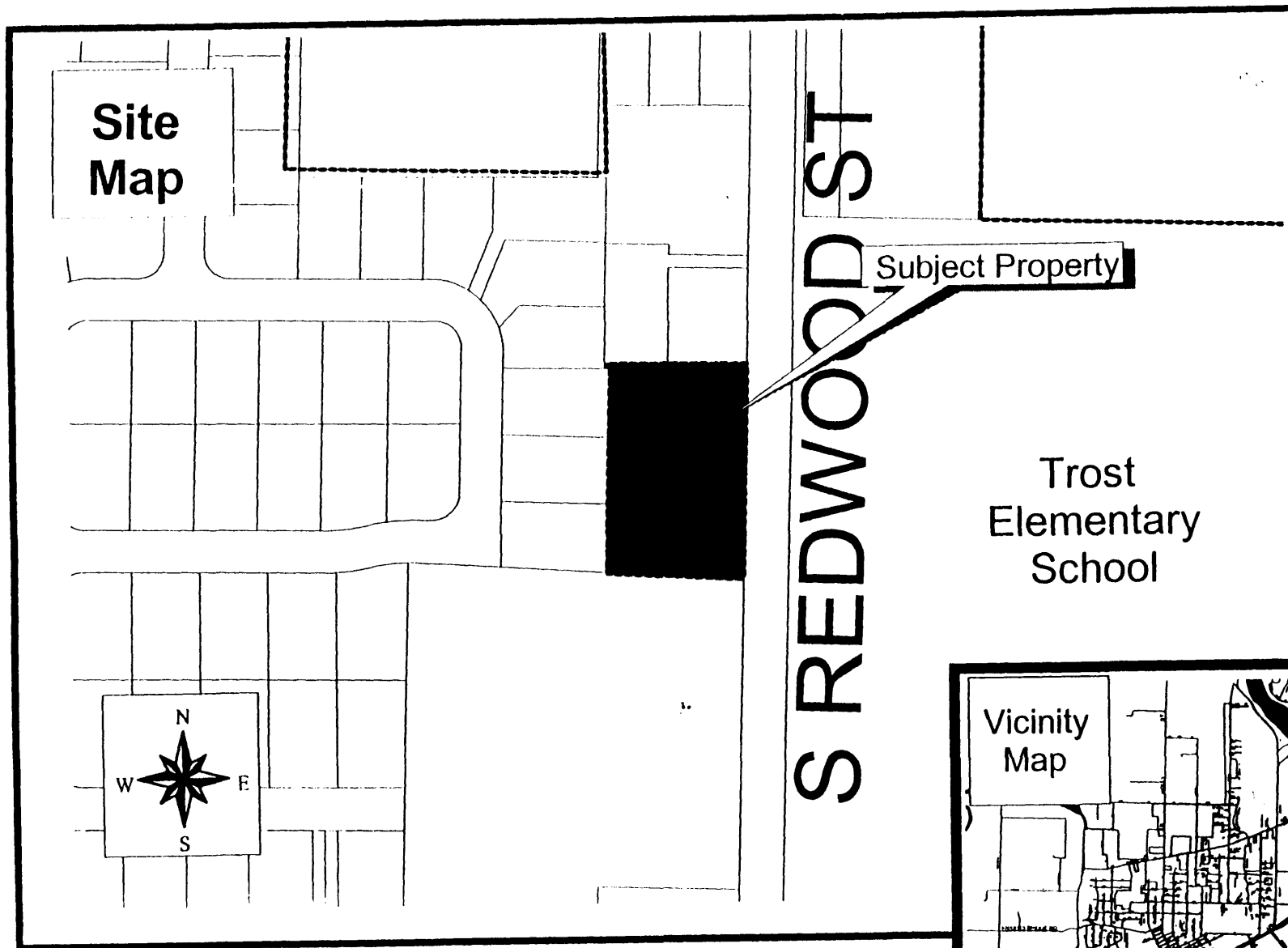

Site and Vicinity Maps

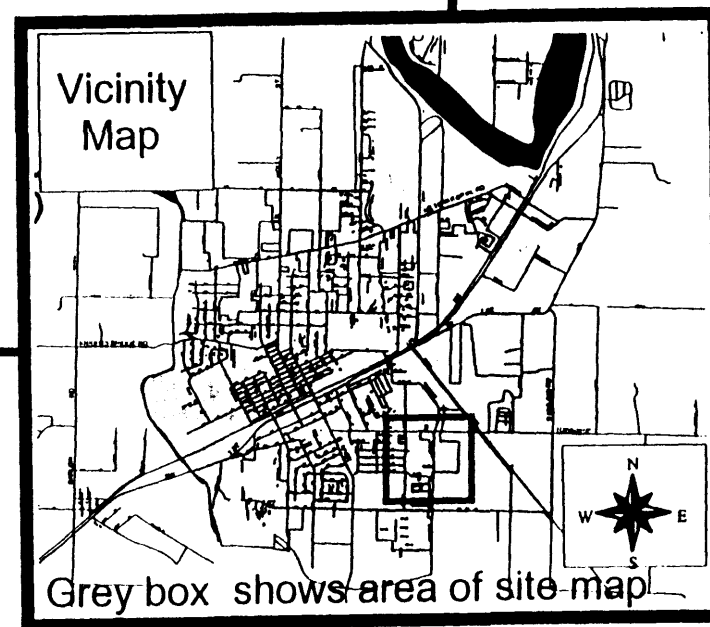

EXPLANATORY STATEMENT FOR VOTER'S PAMPHLET

**MEASURE APPROVING ANNEXATION OF 0.61 ACRES
INTO THE CITY OF CANBY**

Measure No. 3-4a

Word Total 304 (500 max)

This measure would approve the annexation of one 0.61 acre parcel into the city limits of the City of Canby. The property which would be included within the City boundaries is known as Tax Lot 300 of Tax Map 4-1E-03BB. This tax lot is located on the west side of S. Redwood Street, across the street from Trost Elementary School. The applicants reside at that location. The address of the property is 687 S. Redwood Street. The parcel is currently zoned RRFF-5 (Rural Residential, Farm and Forest). If annexation into the City is approved by the voters, it would be rezoned Low Density Residential as required under the City's Comprehensive Land Use Plan (Comp Plan).

Tax Lot 300 is owned by David and Donna Sheldon. Both owners have applied jointly to the City of Canby for approval of annexation as allowed by Oregon law. The City, following its Charter, has put this matter before the voters for approval.

Tax Lot 300 is surrounded on the east, west, north and south by properties within the City limits and within the City's Urban Growth Boundary. The lot presently contains one single family residence where the applicants reside. Future development of the property would be limited to a maximum of two additional houses through a minor land partition. Any land partitioning would have to comply with state and local land use laws and would be subject to public review.

The Canby Comp Plan also designates properties for annexation as Priority "A", "B" or "C". Priority "A" properties shall generally be annexed prior to those areas shown as Priority "B" which, in turn, shall generally be annexed prior to those areas shown as Priority "C". This lot is designated Priority "A" property. Both the Canby Planning Commission and the City Council unanimously approved this annexation application.

CITY OF CANBY

Chauncey Seifried
Chauncey Seifried,
Canby City Recorder - Pro tem

August 15, 2001
Date