

RESOLUTION NO. 705

A RESOLUTION ACCEPTING THE RESULTS OF MAY 18, 1999 ELECTION, PROCLAIMING ANNEXATION INTO THE CITY OF CANBY OF 5.5 ACRES OF PROPERTY, AND SETTING THE BOUNDARIES OF THE PROPERTY TO BE INCLUDED WITHIN THE CITY LIMITS.

WHEREAS, on May 18, 1999, at a general election, the voters of the City of Canby approved by a vote of 1113 to 563 Measure No. 3-55 which called for the annexation of 5.5 acres into the City of Canby. Clackamas County Elections Department certified the above elections results as accurate on May 24, 1999. Applicants for the property were Daryl and Margaret Buchanan. The property is known as Tax lot 200 of Tax Map 3-1E-34B. A complete legal description and map showing the location of the property is attached hereto as Exhibits "A" and "B" and by this reference incorporated herein; and

WHEREAS, pursuant to CMC 16.84.080, the City of Canby must proclaim by resolution, the annexation of said property into the City and set the boundaries of the new property by legal description; now, therefore, its is hereby

RESOLVED that the Election Results as set forth in the abstract dated May 24, 1999 are official and accepted by the Council of Canby; and it is hereby

PROCLAIMED by the Council of Canby that 5.5 acres of property described in Exhibit "A" and shown on Exhibit "B" is annexed to the incorporated limits of the City of Canby, Oregon. Said boundaries of the property are set by the legal description set forth in Exhibit "A".

ADOPTED this 2 day of June, 1999, by the Canby City Council.

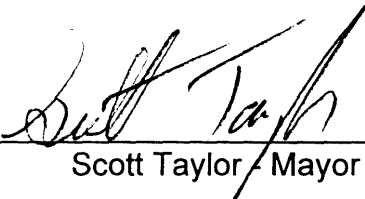

Scott Taylor - Mayor

ATTEST:



Chaunee Seifried,
City Recorder, Pro-Tem

EXHIBIT "A"

The premises are in Clackamas County and are described as follows.

Part of the Northeast one-quarter of the Northwest one-quarter of section 34, Township 3 South, range 1 East of the Willamette Meridian, in Clackamas County, Oregon, described as follows:

Beginning at the Southeast corner of Tract 93 of CANBY GARDENS on the Northwestern line of the right of way of the Southern Pacific Railroad; running thence West on the South line of said Tract 93, a distance of 624.00 feet to the Southwest corner of said tract 93; thence South on the East side of N. Redwood Street, of said CANBY GARDENS, 714.20 feet to said Northwestern line of said southern Pacific right of way; thence Northeasterly along said Northwestern line of said right of way, 948.40 feet to the place of beginning.

EXHIBIT "B"

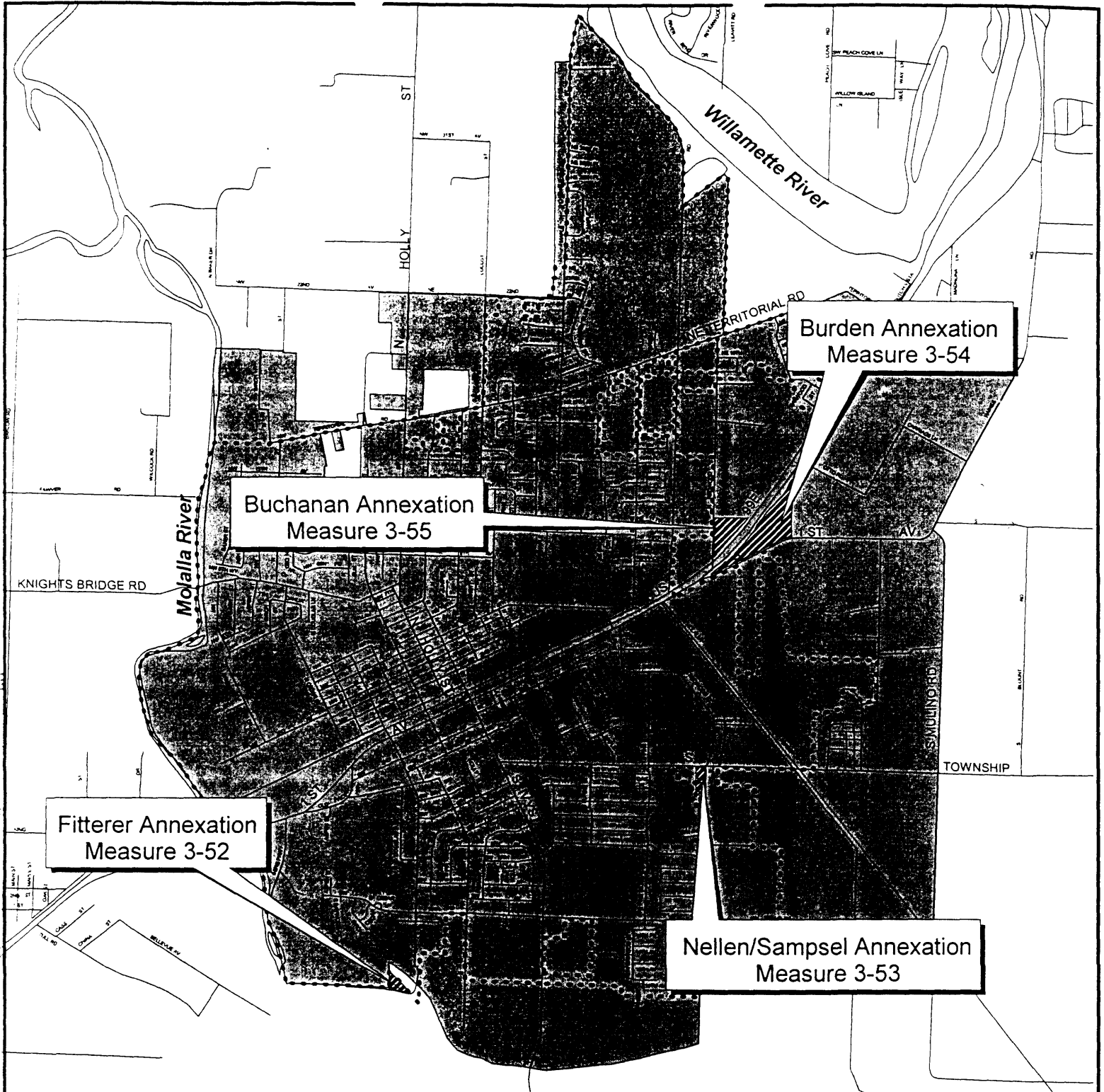

May, 1999
General Election
Canby Annexations

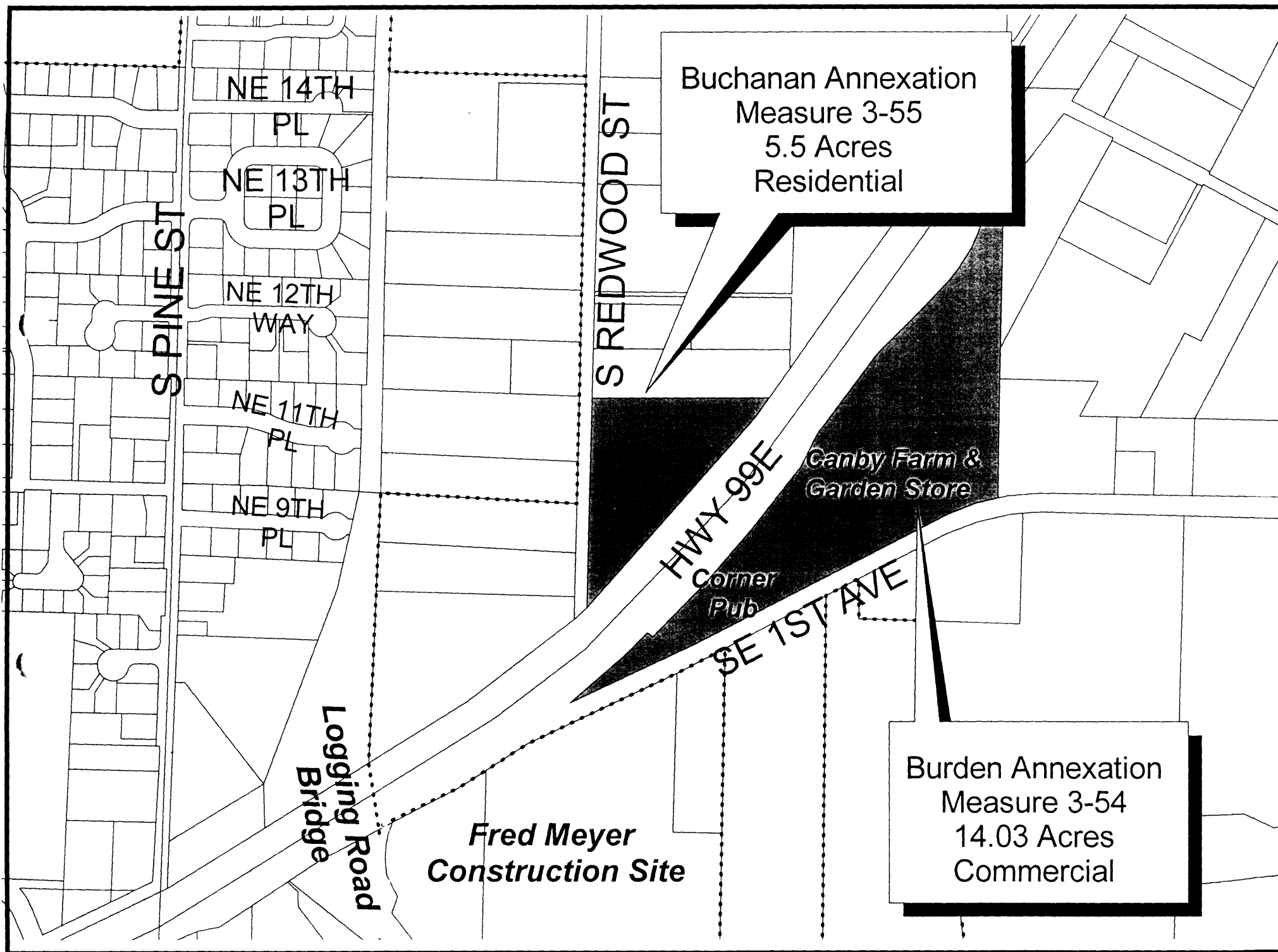

Buchanan Annexation
Measure 3-55
5.5 Acres
Residential

Canby Farm &
Garden Store

Corner
Pub

Burden Annexation
Measure 3-54
14.03 Acres
Commercial

Fred Meyer
Construction Site

Logging Road
Bridge