

RESOLUTION NO. 704

A RESOLUTION ACCEPTING THE RESULTS OF MAY 18, 1999 ELECTION, PROCLAIMING ANNEXATION INTO THE CITY OF CANBY OF 14.03 ACRES OF PROPERTY, AND SETTING THE BOUNDARIES OF THE PROPERTY TO BE INCLUDED WITHIN THE CITY LIMITS.

WHEREAS, on May 18, 1999, at a general election, the voters of the City of Canby approved by a vote of 1309 to 608, Measure No. 3-54 which called for the annexation of 14.03 acres into the City of Canby. Clackamas County Elections Department certified the above elections results as accurate on May 24, 1999. Applicant for the property was Irene Burden. The property is known as Tax lot 2200 of Tax Map 3-1E-34B. A complete legal description and map showing the location of the property is attached hereto as Exhibits "A" and "B" and by this reference incorporated herein; and

WHEREAS, pursuant to CMC 16.84.080, the City of Canby must proclaim by resolution, the annexation of said property into the City and set the boundaries of the new property by legal description; now, therefore, its is hereby

RESOLVED that the Election Results as set forth in the abstract dated May 24, 1999 are official and accepted by the Council of Canby; and it is hereby

PROCLAIMED by the Council of Canby that 14.03 acres of property described in Exhibit "A" and shown on Exhibit "B" is annexed to the incorporated limits of the City of Canby, Oregon. Said boundaries of the property are set by the legal description set forth in Exhibit "A".

ADOPTED this 2 day of June, 1999, by the Canby City Council.

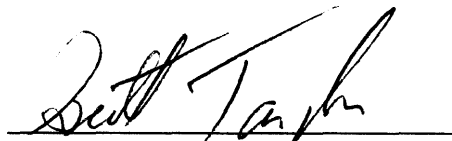

Scott Taylor, Mayor

ATTEST:



Chaunee Seifried,
City Recorder, Pro-Tem

EXHIBIT "A"

to grantor paid by

IRENE E. BURDEN, a married person

, hereinafter called the grantee,
does hereby grant, bargain, sell and convey unto the said grantee and grantee's heirs, successors and assigns, that certain real property, with the tenements, hereditaments and appurtenances thereunto belonging or appertaining, situated in the County of Clackamas and State of Oregon, described as follows, to-wit: A part of section 34, T. 3 S., R. 1 E. of the W. M. described as: Beginning at the intersection of the center line of the E. M. Haines County Road No. 687 with the line dividing Section 34, T. 3 S., R. 1 E. of the W. M. into east and west halves, said point of intersection being at the southeast corner of the northeast quarter of the Northwest quarter of said section 34, and at the salient angular corner on the north line of the Philander Lee Donation Land Claim No. 56, running thence North on said line dividing said section 34 into East and West halves 1264.44 feet to the south side line of the right of way of the Southern Pacific Railroad; thence southwesterly tracing said south line of said right of way to its intersection with the north line of said Donation Land Claim; thence north 63°15' East tracing said claim line and the center line of said E. M. Haines County Road 1914 feet to the place of beginning, containing 15 acres, more or less, situate in Clackamas County, state of Oregon EXCEPTING therefrom public roads and highways AND EXCEPTING FURTHER any portion thereof heretofore conveyed to the state of Oregon acting through its Oregon State Highway Commission.

EXHIBIT "B"

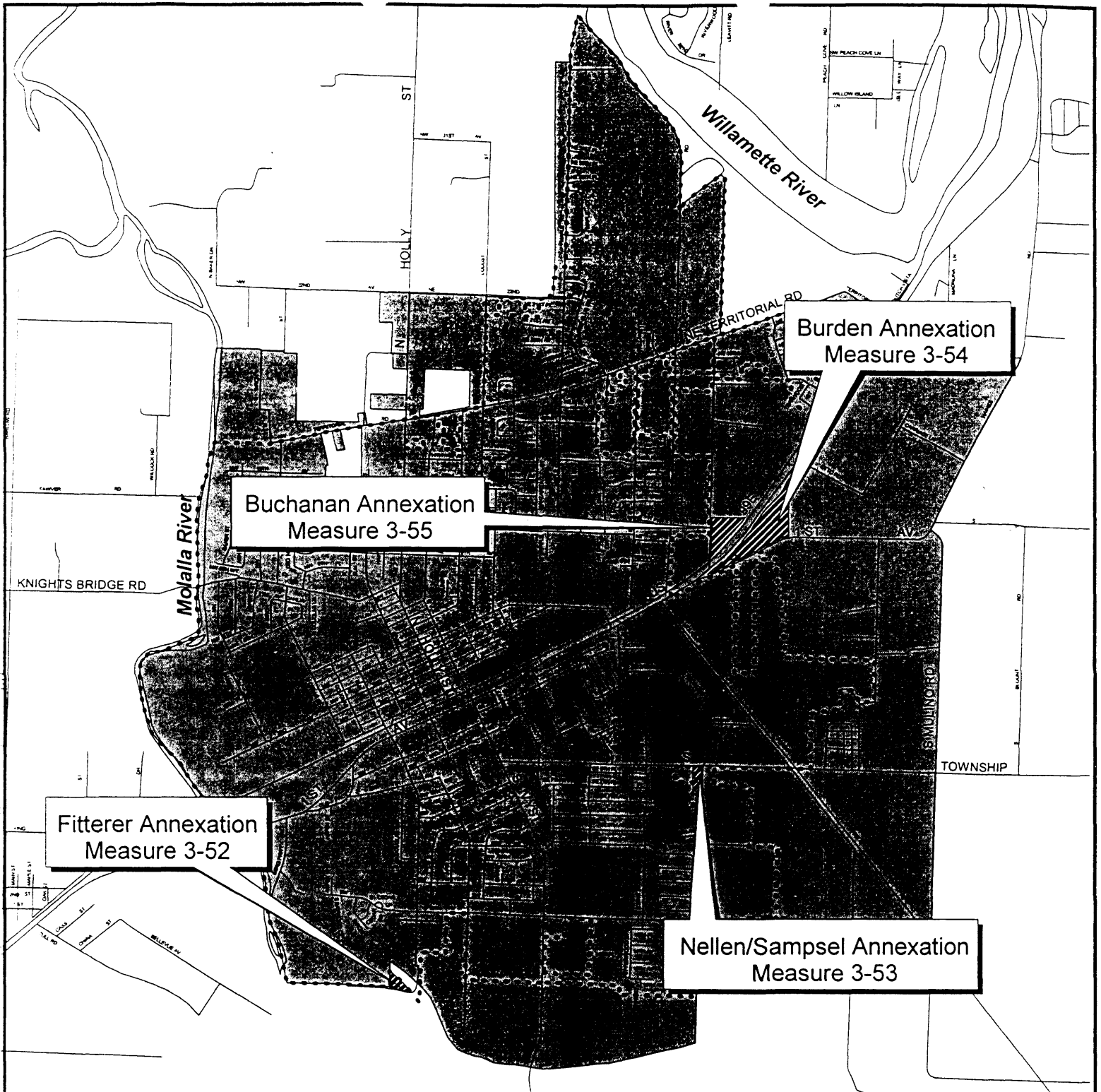

May, 1999
General Election
Canby Annexations

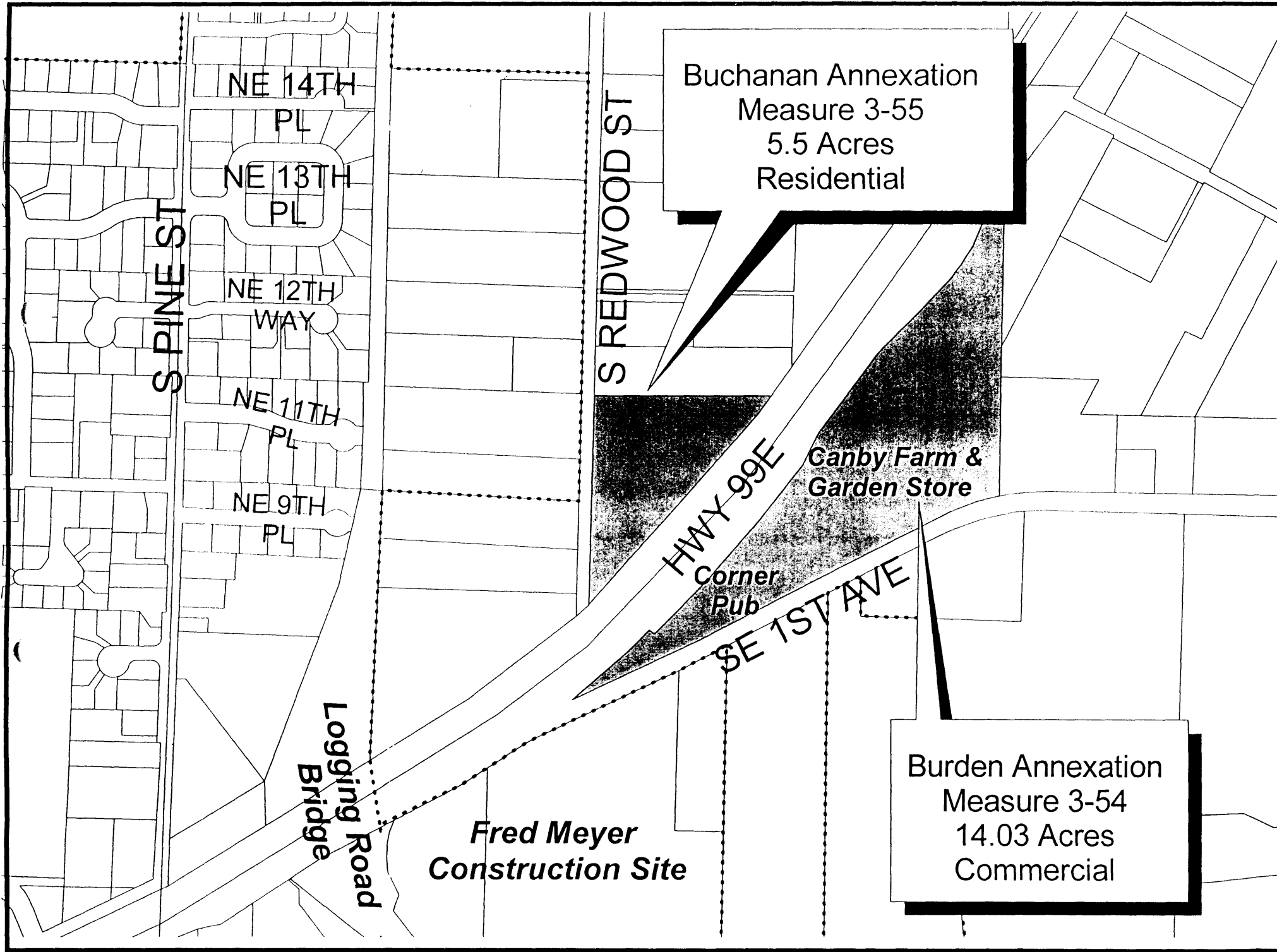

Buchanan Annexation
Measure 3-55
5.5 Acres
Residential

Burden Annexation
Measure 3-54
14.03 Acres
Commercial