

RESOLUTION NO. 703

A RESOLUTION ACCEPTING THE RESULTS OF MAY 18, 1999 ELECTION, PROCLAIMING ANNEXATION INTO THE CITY OF CANBY OF 0.64 ACRES AND 0.86 ACRES OF PROPERTY, AND SETTING THE BOUNDARIES OF THE PROPERTY TO BE INCLUDED WITHIN THE CITY LIMITS.

WHEREAS, on May 18, 1999, at a general election, the voters of the City of Canby approved by a vote of 1467 to 494, Measure No. 3-53 which called for the annexation of 0.64 acres and 0.86 acres into the City of Canby. Clackamas County Elections Department certified the above elections results as accurate on May 24, 1999. Applicants for the 0.64 acre parcel were Jay and Patricia Nellen. The property is known as Tax lot 100 of Tax Map 4-1E-3BB. Applicants for the .086 acre parcel were Leon and Adelaide Sampsel. The property is known as Tax Lot 200 of Tax Map 4-1E-3BB. A complete legal description and map showing the location of both properties is attached hereto as Exhibits "A" and "B" and by this reference incorporated herein; and

WHEREAS, pursuant to CMC 16.84.080, the City of Canby must proclaim by resolution, the annexation of said property into the City and set the boundaries of the new property by legal description; now, therefore, its is hereby

RESOLVED that the Election Results as set forth in the abstract dated May 24, 1999 are official and accepted by the Council of Canby; and it is hereby

PROCLAIMED by the Council of Canby that 0.64 acres and .086 acres of property described in Exhibit "A" and shown on Exhibit "B" is annexed to the incorporated limits of the City of Canby, Oregon. Said boundaries of the property are set by the legal description set forth in Exhibit "A".

ADOPTED this 2 day of June, 1999, by the Canby City Council.

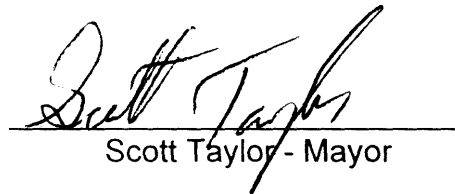
Scott Taylor - Mayor

ATTEST:

Chaunee Seifried,
City Recorder, Pro-Tem

EXHIBIT A

LEGAL DESCRIPTION FOR SAMPSEL/NELLEN PROPERTY

PARCEL 1

Beginning at the Northeast corner of the Northwest quarter of the Northwest quarter of Section 3, Township 4 South, Range 1 East, Willamette Meridian, Clackamas County, Oregon, said point being the northeast corner of a tract of land conveyed to Emil P. Kraft, et ux, by deed recorded in Clackamas County Deed Book 451, Page 103; thence South along the 1/16th section line and along the East line of said Kraft tract, 198.00 feet to the southeast corner thereof, said point being the true point of beginning of the tract herein to be described; thence West along the South line of said Kraft tract 165.00 feet to a point on the East line of a tract of land conveyed to Kenneth L. Lundsten, et ux, by deed recorded in Clackamas County Deed Book 672, Page 444; thence South along the East line of said Lundsten tract and the Southerly extension thereof, 264.00 feet to a point; thence East, parallel with the South line of the aforementioned Kraft tract, 165.00 feet to a point on the east line of the Northwest quarter of the Northwest quarter of said Section 3; thence North along the 1/16th section line 264.00 feet to the true point of beginning.

SAVE AND EXCEPT: A tract of land located in the Northwest quarter of the Northwest quarter of Section 3, Township 4 South, Range 1 East, Willamette Meridian, Clackamas County, Oregon, more particularly described as follows:

Beginning at the Southwest corner of that tract of land conveyed to Leon E. Sampsel and Adelaide J. Sampsel, husband and wife, by deed recorded in Book 682, Page 344, Deed Records of Clackamas County, Oregon, with said Southwest corner being located South 264.00 feet and West 165.00 feet from the Northeast corner of the Northwest quarter of the Northwest quarter of said Section 3; thence from said point of beginning, N 01°14'40" E 186.80 feet along the westerly line of said Sampsel tract to the Southeast corner of that tract of land conveyed to Robert W. Peterson by deed recorded as Fee No. 90-1154, Deed Records of Clackamas County, Oregon; thence S 89°34'48" E 4.63 feet to a 5/8 inch iron rod; thence S 00°31'03" W 186.78 feet to a point on the South line of said Sampsel tract from which a 5/8" iron rod bears S 89°36'02" W 0.48 feet and S 00°23'58" W 0.23 feet; thence N 89°36'02" W 7.00 feet to the point of beginning.

SAVE AND EXCEPT: Any portion lying within a public right-of-way.

PARCEL 2

Part of the West half of the Northwest quarter of Section 3, Township 4 South, Range 1 East, Willamette Meridian, Clackamas County, Oregon, more particularly described as follows:

Beginning at the Northeast corner of the Northwest quarter of the Northwest quarter of said Section 3; thence West along the North line of said Section 3, 165.00 feet; thence South 198.00 feet; thence East 165.00 feet; thence North 198.00 feet to the point of beginning.

SAVE AND EXCEPT: That portion lying with a public right-of-way.

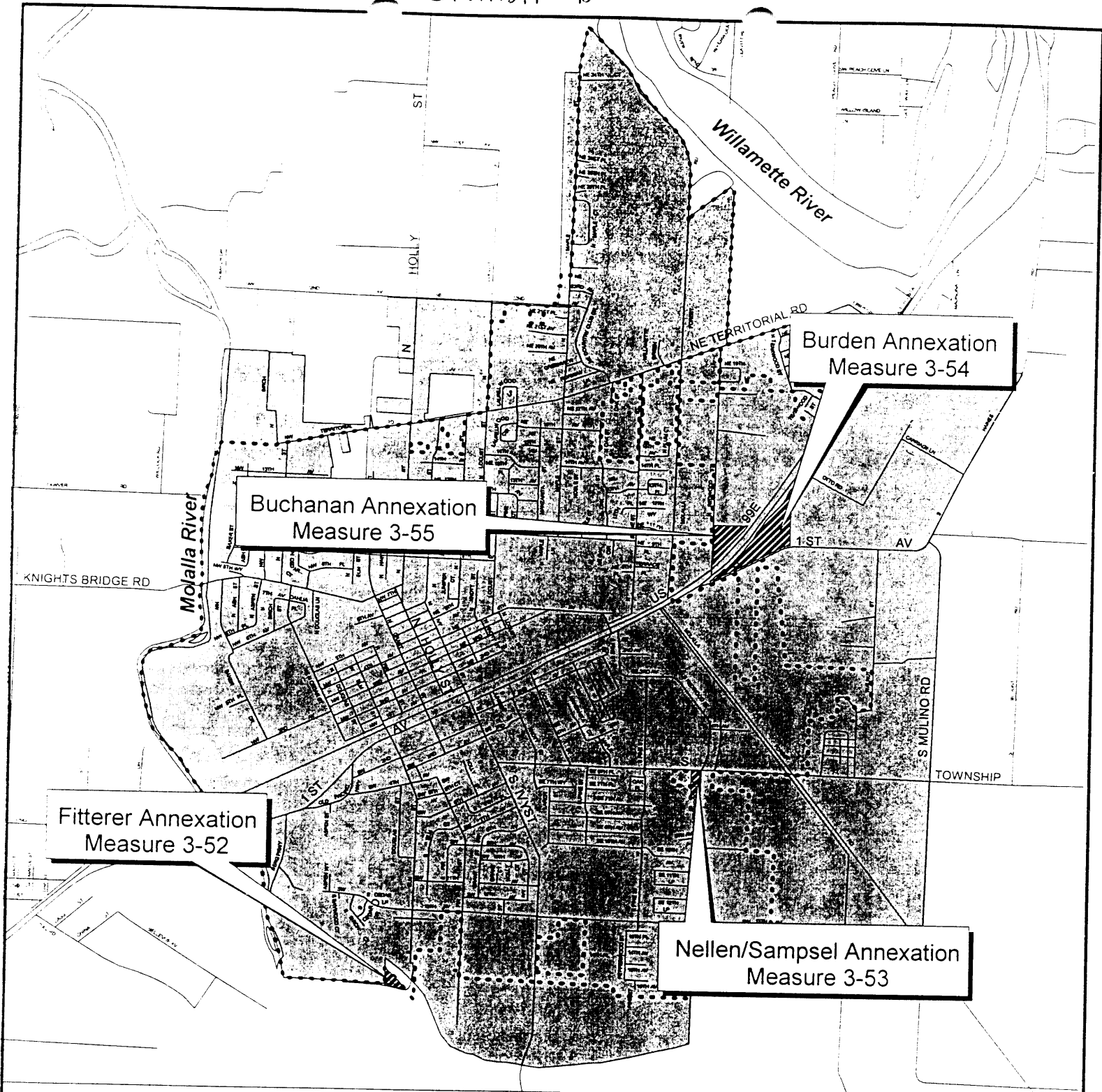

May, 1999
General Election
Canby Annexations

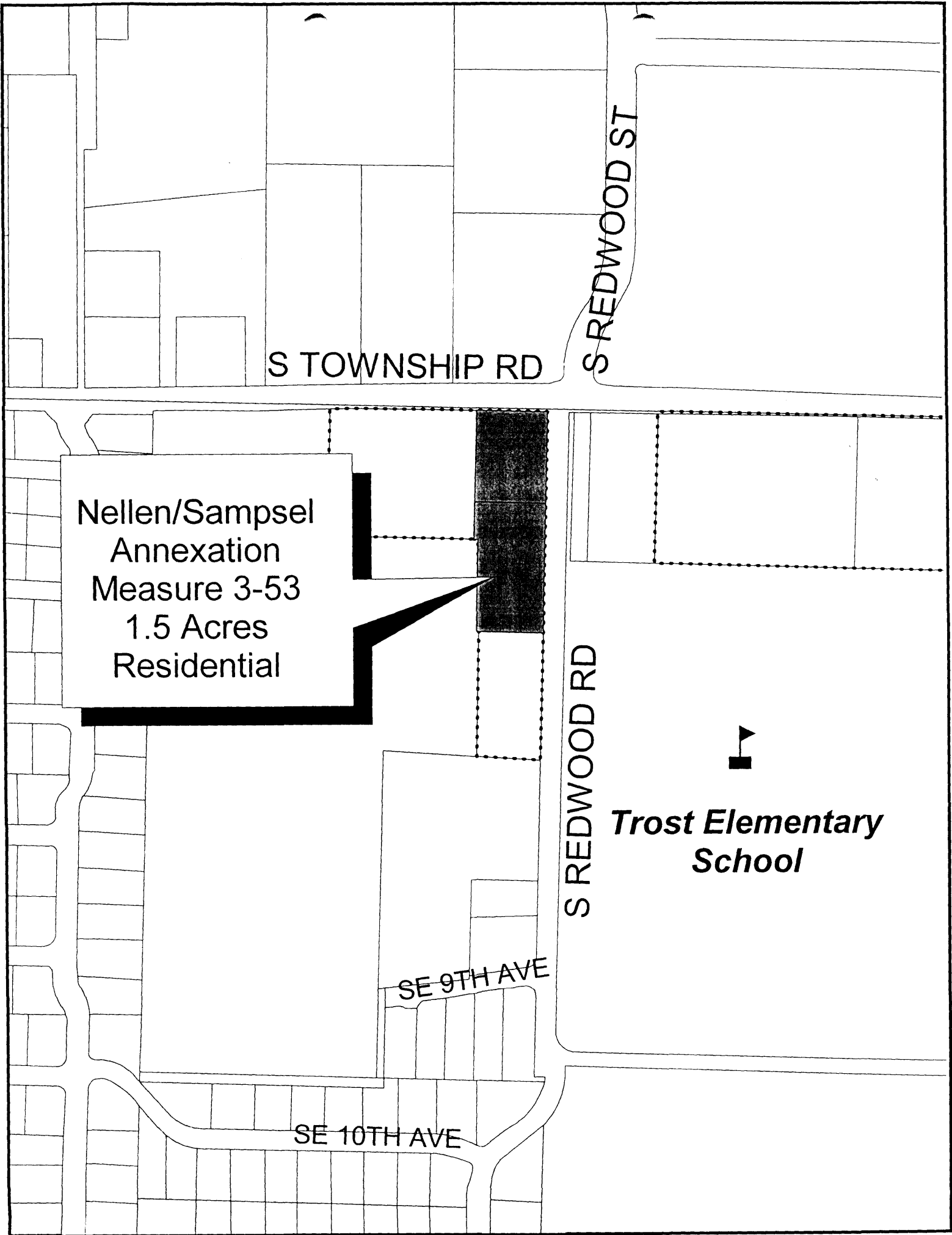

Nellen/Sampsel
Annexation
Measure 3-53
1.5 Acres
Residential

S TOWNSHIP RD

S REDWOOD ST

S REDWOOD RD

SE 9TH AVE

SE 10TH AVE

**Trost Elementary
School**